

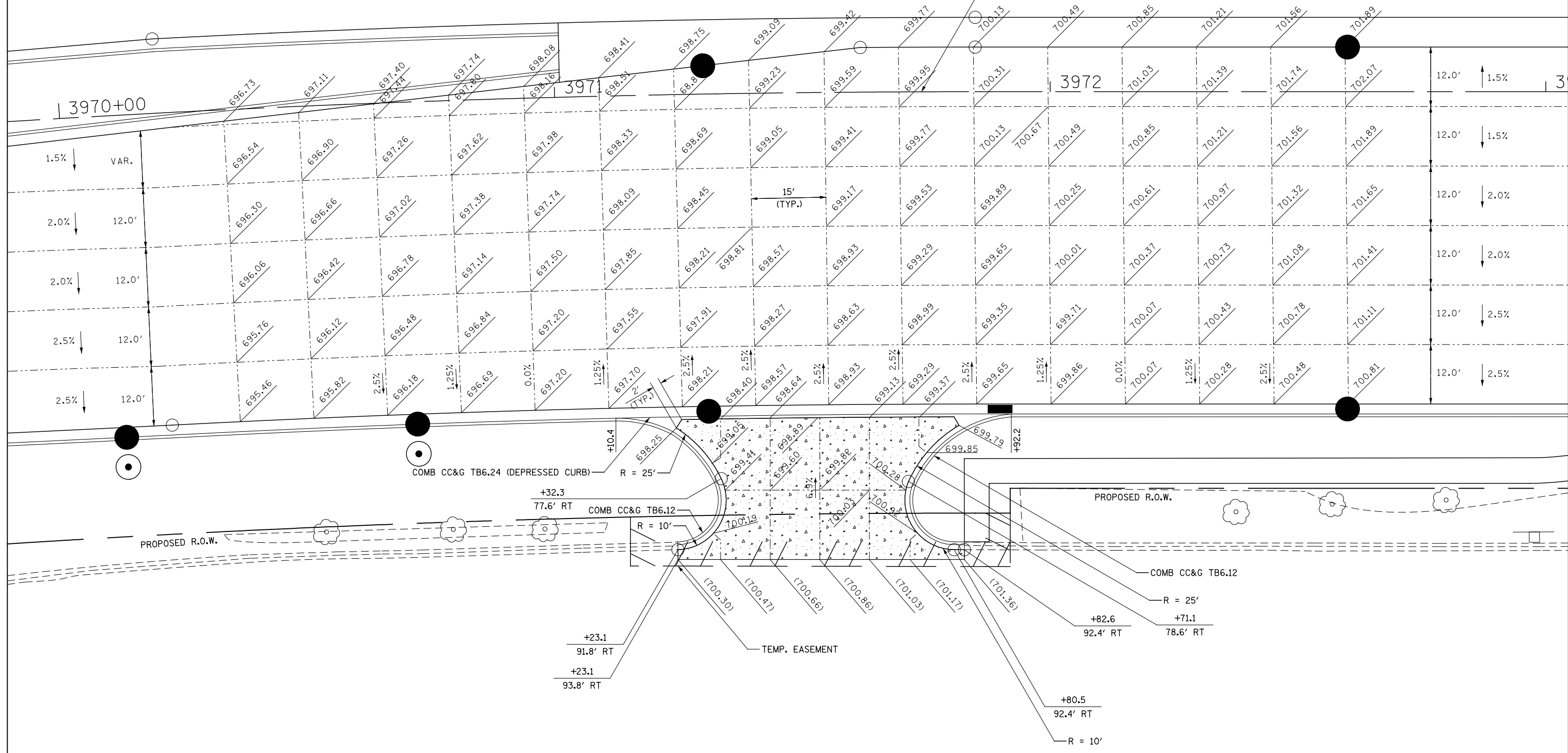

ILLINOIS ROUTE 59

PROPOSED CL ILLINOIS ROUTE 59



LEGEND:

-  PORTLAND CEMENT CONCRETE DRIVEWAY PAVEMENT, 8 INCH SUBBASE GRANULAR MATERIAL, TYPE B 4"

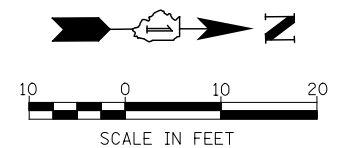

	DESIGNED <i>PJO</i>	REVISED -	STATE OF ILLINOIS DEPARTMENT OF TRANSPORTATION	DRIVEWAY DETAILS ILLINOIS ROUTE 59 - STA 3971 + 52	F.A.P. RTE.	SECTION	COUNTY	TOTAL SHEETS	SHEET NO.	
	DRAWN <i>KES</i>	REVISED -			338	(112 & 113) WRS-7	DUPAGE	1156	385	
	CHECKED <i>JCM</i>	REVISED -			CONTRACT NO. 60R30					
	DATE <i>12/14/2012</i>	REVISED -			ILLINOIS FED. AID PROJECT					
			SCALE: AS SHOWN		SHEET NO. 13 OF 37 SHEETS		STA. TO STA.			