

LEGEND:

-  PORTLAND CEMENT CONCRETE DRIVEWAY PAVEMENT, 8 INCH
SUBBASE GRANULAR MATERIAL, TYPE B 4"
-  HOT-MIX ASPHALT DRIVEWAY PAVEMENT, 10" (SEE NOTE 1)
SUBBASE GRANULAR MATERIAL, TYPE B 4"

NOTES:

1. FOR HMA MATERIAL REQUIREMENTS SEE HMA MIXTURE CHART ON THE GENERAL NOTE SHEET.

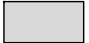
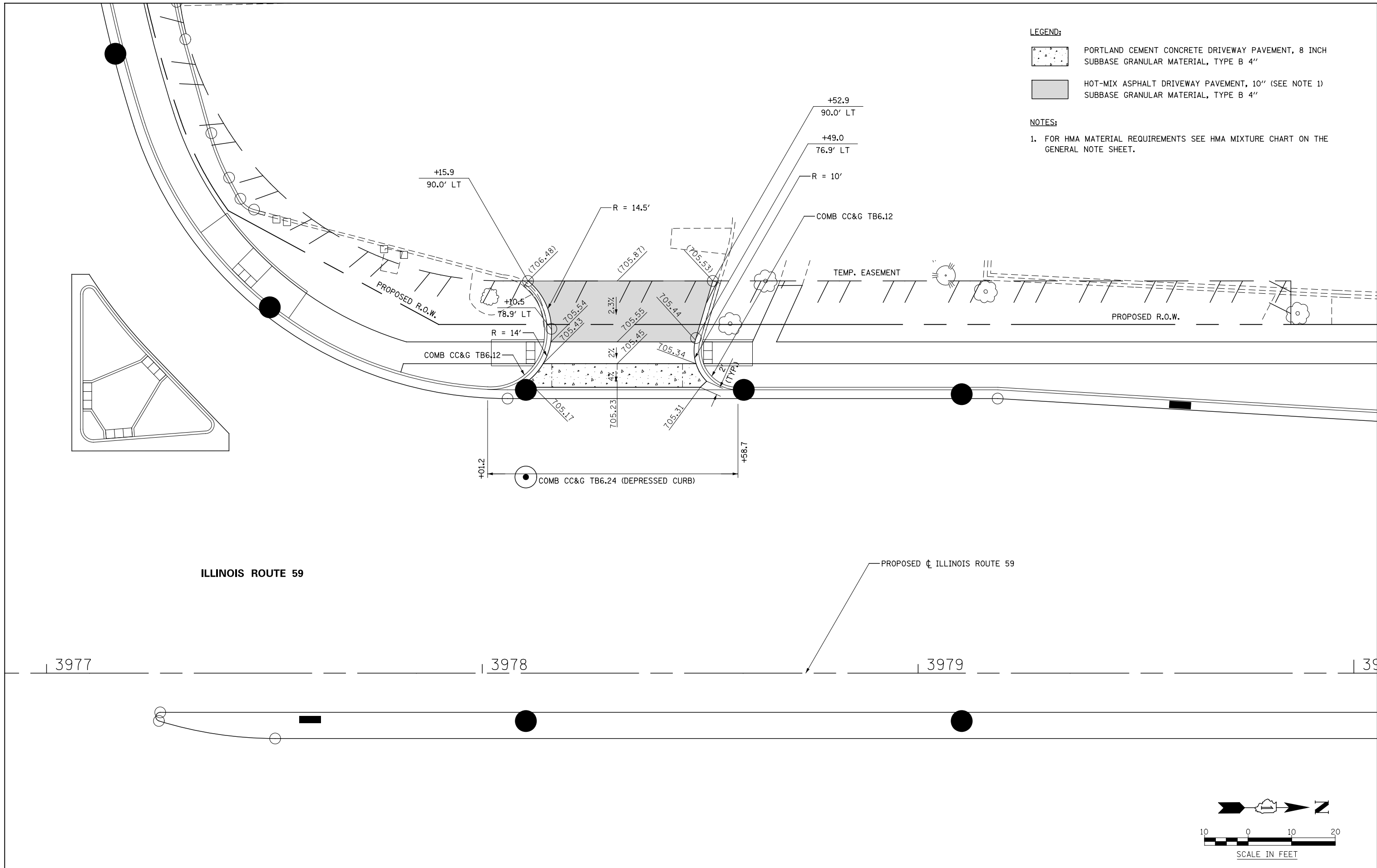

ILLINOIS ROUTE 59

PROPOSED CL ILLINOIS ROUTE 59

3977

3978

3979

3980

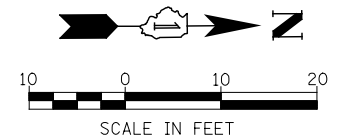

	DESIGNED <i>PJO</i>	REVISED -	STATE OF ILLINOIS DEPARTMENT OF TRANSPORTATION	DRIVEWAY DETAILS ILLINOIS ROUTE 59 - STA 3978 + 32	F.A.P. RTE.	SECTION	COUNTY	TOTAL SHEETS	SHEET NO.	
	DRAWN <i>KES</i>	REVISED -			338	(112 & 113) WRS-7	DUPAGE	1156	386	
	CHECKED <i>JCM</i>	REVISED -			CONTRACT NO. 60R30					
	DATE <i>12/14/2012</i>	REVISED -			ILLINOIS FED. AID PROJECT					
					SCALE: AS SHOWN		SHEET NO. 14 OF 37 SHEETS		STA. TO STA.	