

LEGEND:

- HOT-MIX ASPHALT DRIVEWAY PAVEMENT, 10" (SEE NOTE 1)
- SUBBASE GRANULAR MATERIAL, TYPE B 4"

NOTES:

1. FOR HMA MATERIAL REQUIREMENTS SEE HMA MIXTURE CHART ON THE GENERAL NOTE SHEET.

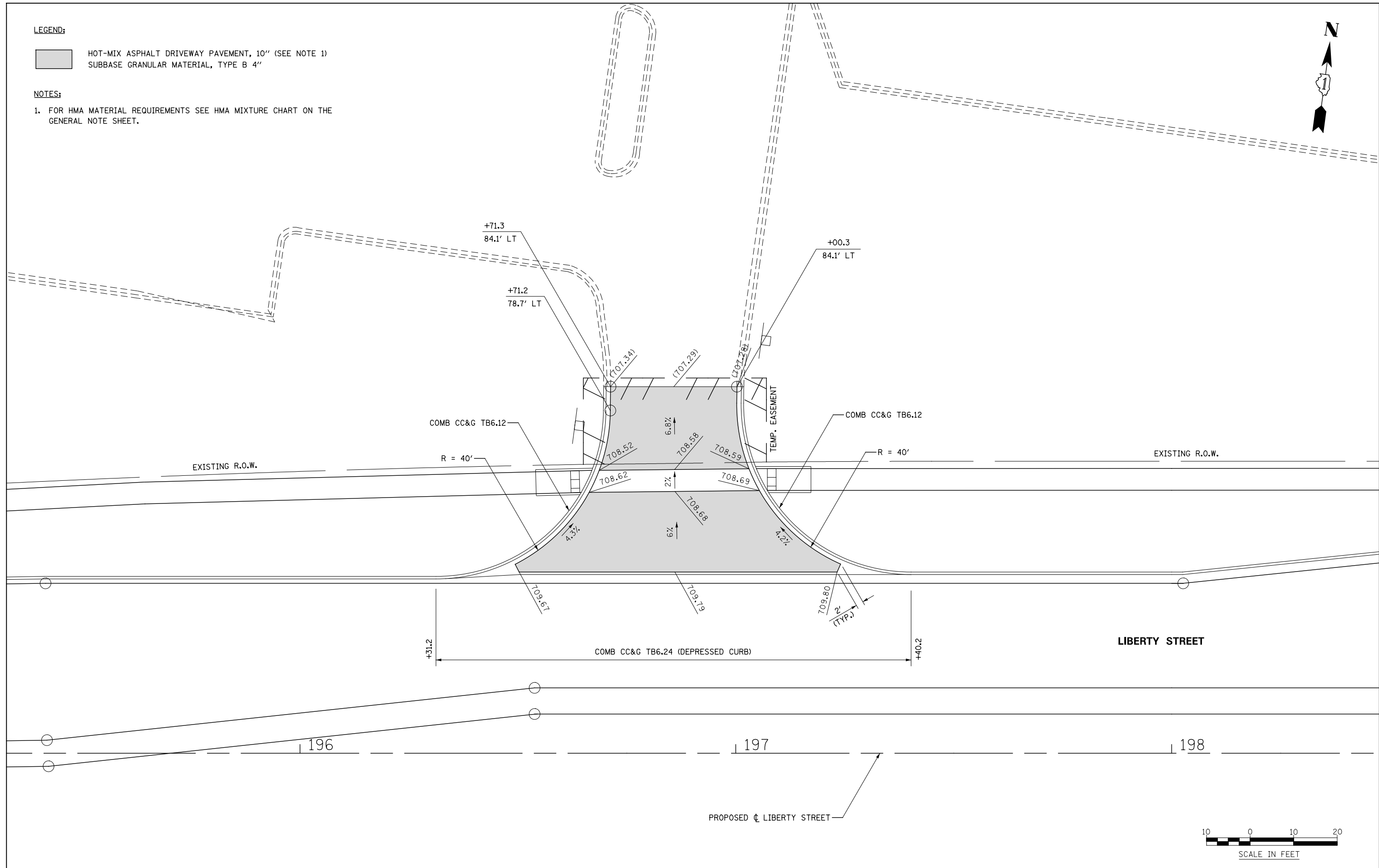

	DESIGNED <i>PJO</i>	REVISED -	STATE OF ILLINOIS DEPARTMENT OF TRANSPORTATION	DRIVEWAY DETAILS LIBERTY STREET - STA 196+86	F.A.P. RTE. 338	SECTION (112 & 113) WRS-7	COUNTY DUPAGE	TOTAL SHEETS 1156	SHEET NO. 394	
	DRAWN <i>KES</i>	REVISED -		SCALE: AS SHOWN	SHEET NO. 22 OF 37 SHEETS	STA.	TO STA.	CONTRACT NO. 60R30		
	CHECKED <i>JCM</i>	REVISED -		ILLINOIS FED. AID PROJECT						
	DATE <i>12/14/2012</i>	REVISED -								