

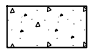

LEGEND:

-  PORTLAND CEMENT CONCRETE DRIVEWAY PAVEMENT, 8 INCH
SUBBASE GRANULAR MATERIAL, TYPE B 4"
-  HOT-MIX ASPHALT DRIVEWAY PAVEMENT, 10" (SEE NOTE 1)
SUBBASE GRANULAR MATERIAL, TYPE B 4"

NOTES:

1. FOR HMA MATERIAL REQUIREMENTS SEE HMA MIXTURE CHART ON THE GENERAL NOTE SHEET.

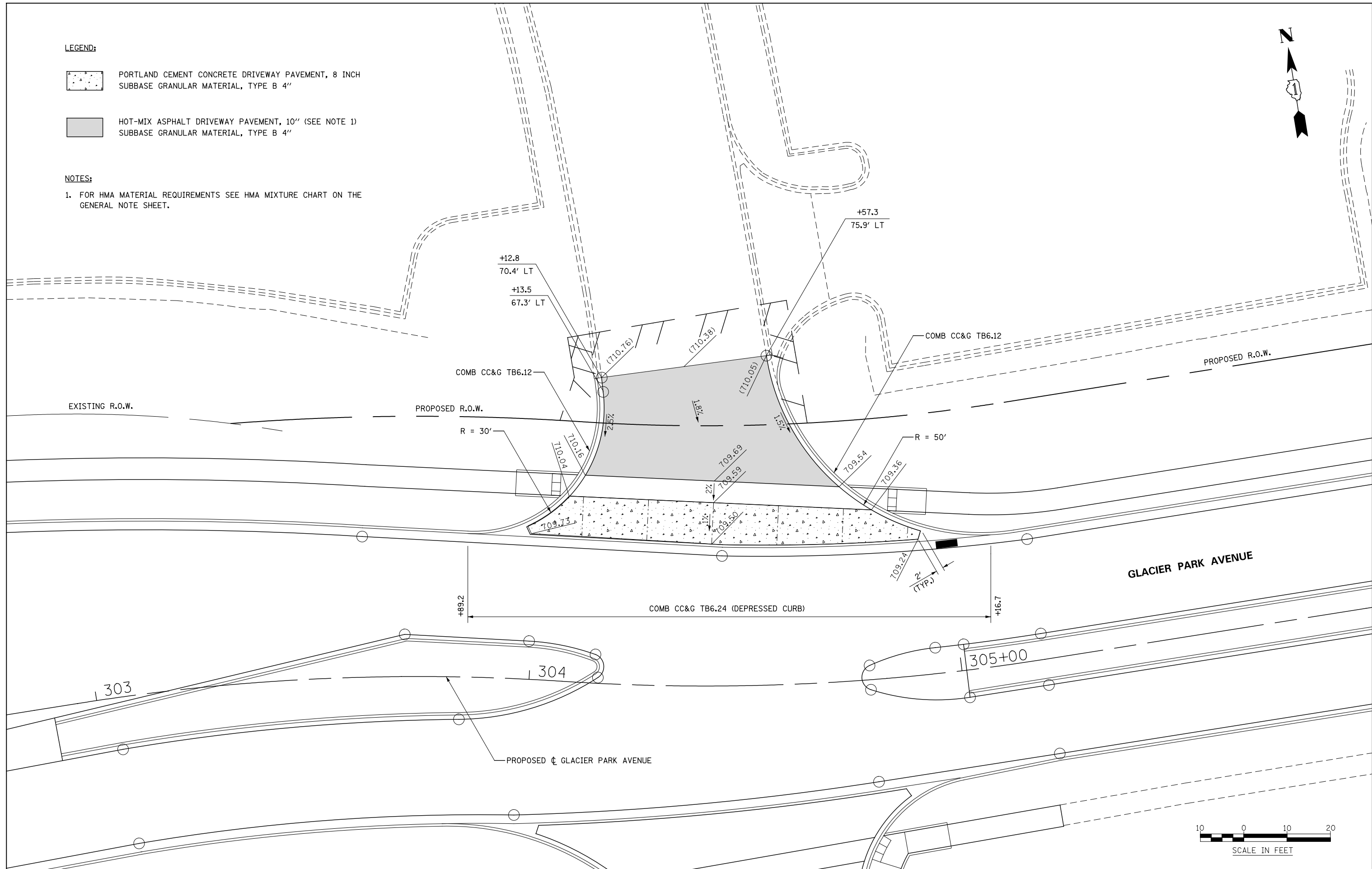

| | | | |
|----------|------------|---------|---|
| DESIGNED | PJO | REVISED | - |
| DRAWN | KES | REVISED | - |
| CHECKED | JCM | REVISED | - |
| DATE | 12/14/2012 | REVISED | - |

**STATE OF ILLINOIS
DEPARTMENT OF TRANSPORTATION**

**DRIVEWAY DETAILS
GLACIER PARK AVENUE - STA 304 + 45**

SCALE: AS SHOWN SHEET NO. 29 OF 37 SHEETS STA. TO STA.

| F.A.P. RTE. | SECTION | COUNTY | TOTAL SHEETS | SHEET NO. |
|---------------------------|-------------------|--------|--------------|-----------|
| 338 | (112 & 113) WRS-7 | DUPAGE | 1156 | 401 |
| CONTRACT NO. 60R30 | | | | |
| ILLINOIS FED. AID PROJECT | | | | |