

PLAN	SURVEYED	BY	DATE
	PLOTTED		
	CHECKED		
	ALIGNED		
	FILED		
	FILE NAME		
	NO.		

PROFILE	SURVEYED	BY	DATE
	GRADES		
	CHECKED		
	STRUCTURE		
	NOTATIONS		
	CHKD		
	NO.		

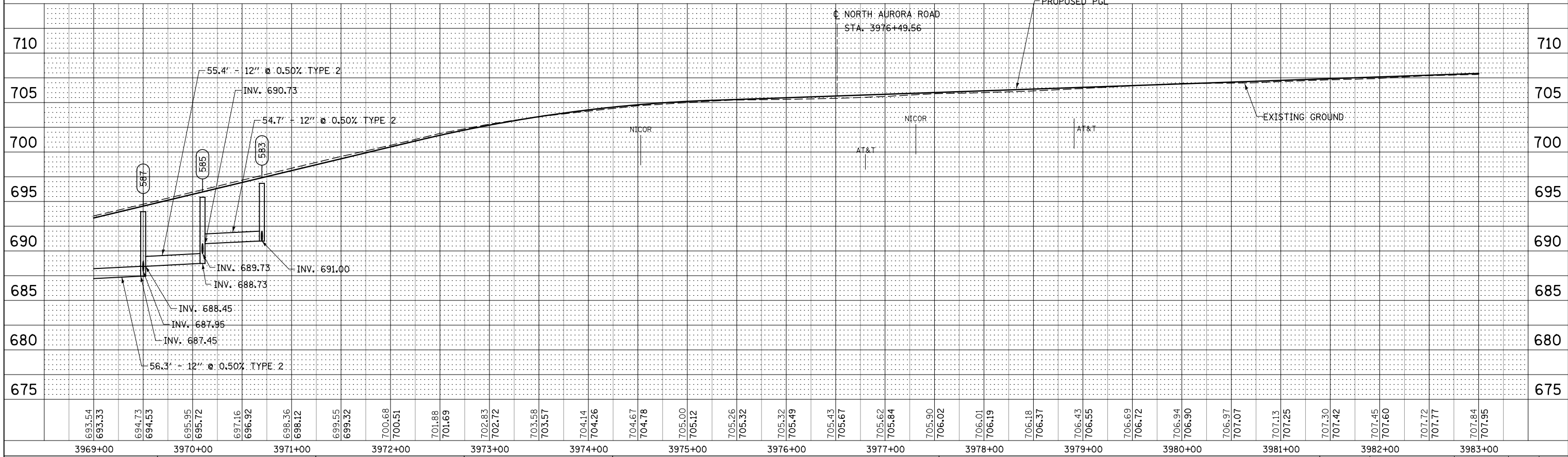
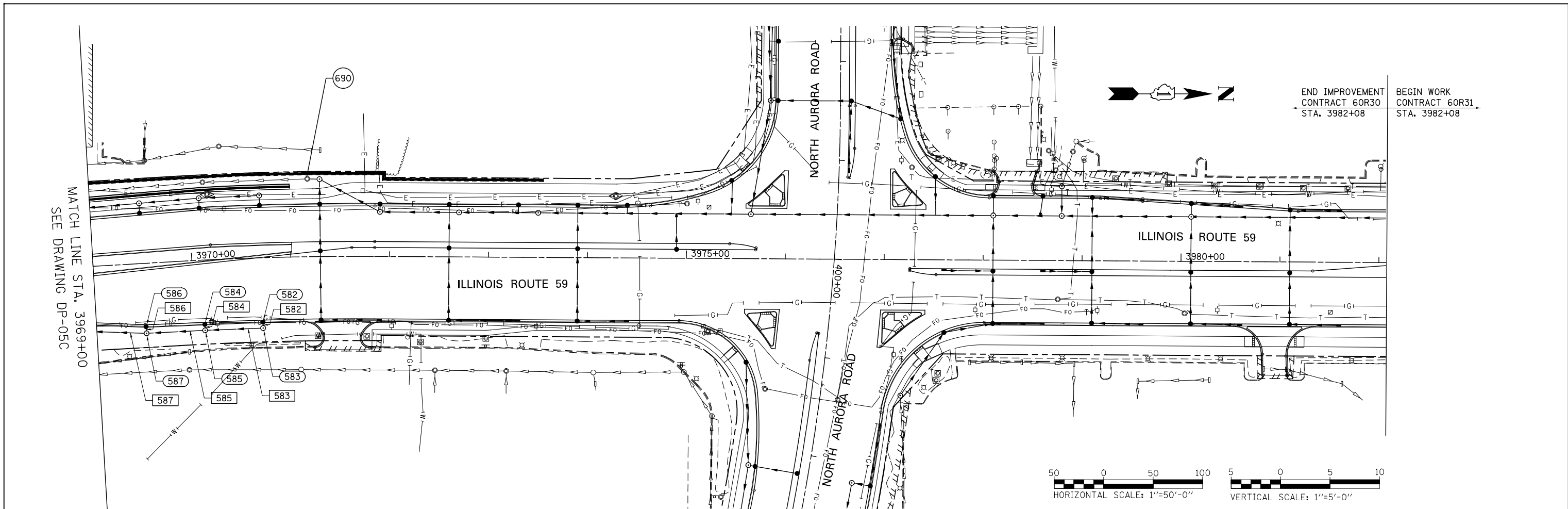

693.54	693.33	694.73	694.53	695.95	695.72	697.16	696.92	698.36	698.12	699.55	699.32	700.68	700.51	701.88	701.69	702.83	702.72	703.58	703.57	704.14	704.26	704.67	704.78	705.00	705.12	705.26	705.32	705.32	705.49	705.43	705.67	705.62	705.84	705.90	706.02	706.01	706.19	706.18	706.37	706.43	706.55	706.69	706.72	706.94	706.90	706.97	707.07	707.13	707.25	707.30	707.42	707.45	707.60	707.72	707.77	707.84	707.95
3969+00		3970+00		3971+00		3972+00		3973+00		3974+00		3975+00		3976+00		3977+00		3978+00		3979+00		3980+00		3981+00		3982+00		3983+00																													

DESIGNED	JWM	REVISED	-
DRAWN	KES	REVISED	-
CHECKED	JRS	REVISED	-
DATE	12/14/2012	REVISED	-

STATE OF ILLINOIS
 DEPARTMENT OF TRANSPORTATION

PROPOSED DRAINAGE PLAN & PROFILE - ILLINOIS ROUTE 59

F.A.P. RTE.	SECTION	COUNTY	TOTAL SHEETS	SHEET NO.
338	(112 & 113) WRS-7	DUPAGE	1156	479
DP-06C		CONTRACT NO. 60R30		
FED. ROAD DIST. NO.	ILLINOIS FED. AID PROJECT			

SCALE: 1"=50' SHEET NO. 13 OF 25 SHEETS STA. 3969+00 TO STA. END