

MATCH LINE STA. 3928+00  
SEE DRAWING DU-02

MATCH LINE STA. 3942+00  
SEE DRAWING DU-04

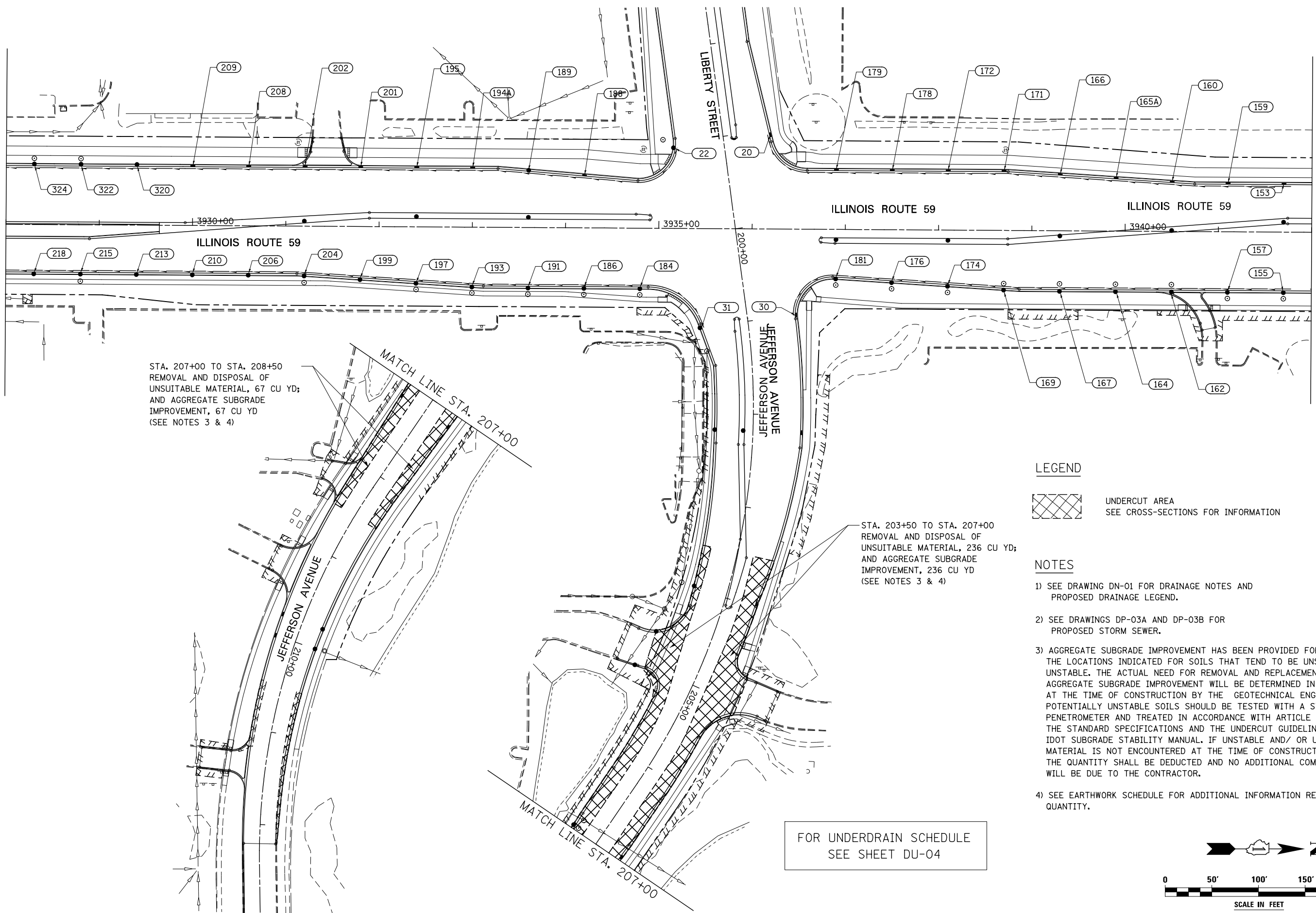

STA. 207+00 TO STA. 208+50  
REMOVAL AND DISPOSAL OF  
UNSUITABLE MATERIAL, 67 CU YD;  
AND AGGREGATE SUBGRADE  
IMPROVEMENT, 67 CU YD  
(SEE NOTES 3 & 4)

STA. 203+50 TO STA. 207+00  
REMOVAL AND DISPOSAL OF  
UNSUITABLE MATERIAL, 236 CU YD;  
AND AGGREGATE SUBGRADE  
IMPROVEMENT, 236 CU YD  
(SEE NOTES 3 & 4)

**LEGEND**

 UNDERCUT AREA  
SEE CROSS-SECTIONS FOR INFORMATION

**NOTES**

- 1) SEE DRAWING DN-01 FOR DRAINAGE NOTES AND PROPOSED DRAINAGE LEGEND.
- 2) SEE DRAWINGS DP-03A AND DP-03B FOR PROPOSED STORM SEWER.
- 3) AGGREGATE SUBGRADE IMPROVEMENT HAS BEEN PROVIDED FOR USE AT THE LOCATIONS INDICATED FOR SOILS THAT TEND TO BE UNSUITABLE OR UNSTABLE. THE ACTUAL NEED FOR REMOVAL AND REPLACEMENT WITH AGGREGATE SUBGRADE IMPROVEMENT WILL BE DETERMINED IN THE FIELD AT THE TIME OF CONSTRUCTION BY THE GEOTECHNICAL ENGINEER. ALL POTENTIALLY UNSTABLE SOILS SHOULD BE TESTED WITH A STATIC CONE PENETROMETER AND TREATED IN ACCORDANCE WITH ARTICLE 301.04 OF THE STANDARD SPECIFICATIONS AND THE UNDERCUT GUIDELINES IN THE IDOT SUBGRADE STABILITY MANUAL. IF UNSTABLE AND/ OR UNSUITABLE MATERIAL IS NOT ENCOUNTERED AT THE TIME OF CONSTRUCTION, THEN THE QUANTITY SHALL BE DEDUCTED AND NO ADDITIONAL COMPENSATION WILL BE DUE TO THE CONTRACTOR.
- 4) SEE EARTHWORK SCHEDULE FOR ADDITIONAL INFORMATION REGARDING QUANTITY.

FOR UNDERDRAIN SCHEDULE  
SEE SHEET DU-04

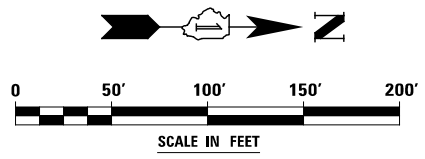

DESIGNED	PJO	REVISED	-
DRAWN	KES	REVISED	-
CHECKED	JCM	REVISED	-
DATE	12/14/2012	REVISED	-

**STATE OF ILLINOIS  
DEPARTMENT OF TRANSPORTATION**

**PIPE UNDERDRAINS AND UNDERCUT PLAN - ILLINOIS ROUTE 59**

SCALE: AS SHOWN | SHEET NO. 3 OF 8 SHEETS | STA. 3928+00 TO STA. 3942+00

F.A.P. RTE.	SECTION	COUNTY	TOTAL SHEETS	SHEET NO.
338	(112 & 113) WRS-7	DUPAGE	1156	494
<b>DU-03</b>		CONTRACT NO. 60R30		
ILLINOIS FED. AID PROJECT				