

SYMBOL LEGEND

- INDICATES SIGN IS MOUNTED TO SIGNAL MAST ARM, SEE SIGNAL PLANS (TYP.)
- INDICATES SIGN IS MOUNTED TO A TRAFFIC SIGNAL POLE (TYP.)
- REGULATORY SIGN (R SERIES)
- WARNING SIGN (W SERIES)
- GUIDE SIGN (D/M SERIES)
- SPECIAL/OTHER SIGNS

PAVEMENT MARKING LEGEND (SEE NOTE 4)

- PAVEMENT MARKING - LINE 4", SOLID WHITE
- PAVEMENT MARKING - LINE 4", WHITE SKIP-DASH (10' LINE - 30' SPACE) WITH RAISED REFLECTIVE PAVEMENT MARKERS, ONE-WAY CRYSTAL (SPACED AT 80' C-C)
- PAVEMENT MARKING - LINE 4", DOUBLE YELLOW WITH RAISED REFLECTIVE PAVEMENT MARKERS, ONE-WAY AMBER (SPACED AT 40' C-C)
- PAVEMENT MARKING - LINE 4", DOUBLE YELLOW WITH RAISED REFLECTIVE PAVEMENT MARKERS, TWO-WAY AMBER (SPACED AT 40' C-C)
- PAVEMENT MARKING - LINE 6", SOLID WHITE WITH RAISED REFLECTIVE PAVEMENT MARKERS, ONE-WAY CRYSTAL (SPACED AT 40' C-C)
- PAVEMENT MARKING - LINE 6", WHITE DOTTED (2' LINE - 6' SPACE, UNLESS OTHERWISE NOTED)
- PAVEMENT MARKING - LINE 6", SOLID WHITE
- PAVEMENT MARKING - LINE 6", SOLID WHITE WITH 12" SOLID WHITE DIAGONALS AT 45°, SPACED AT 2'
- PAVEMENT MARKING - LINE 8", SOLID WHITE
- PAVEMENT MARKING - LINE 12", SOLID WHITE
- PAVEMENT MARKING - LINE 12", SOLID YELLOW
- PAVEMENT MARKING - LINE 24", SOLID WHITE
- PAVEMENT MARKING - LETTERS & SYMBOLS

NOTES

1. PAVEMENT MARKINGS AND RAISED REFLECTIVE PAVEMENT MARKERS SHALL BE PLACED IN ACCORDANCE WITH IDOT DISTRICT 1 DETAILS TC-11 AND TC-13.
2. SIGN LOCATIONS MAY VARY BASED ON FIELD CONDITIONS.
3. ALL POST-MOUNTED SIGNS SHALL BE MOUNTED ON TELESCOPING POLES IN ACCORDANCE WITH HIGHWAY STANDARD 728001 UNLESS OTHERWISE NOTED.
4. ALL PERMANENT PAVEMENT MARKING ON PCC PAVEMENT SHALL BE POLYUREA PAVEMENT MARKING, TYPE I AND ON HMA PAVEMENT SHALL BE THERMOPLASTIC PAVEMENT MARKING OF THE TYPE SPECIFIED IN THE PAVEMENT MARKING LEGEND.

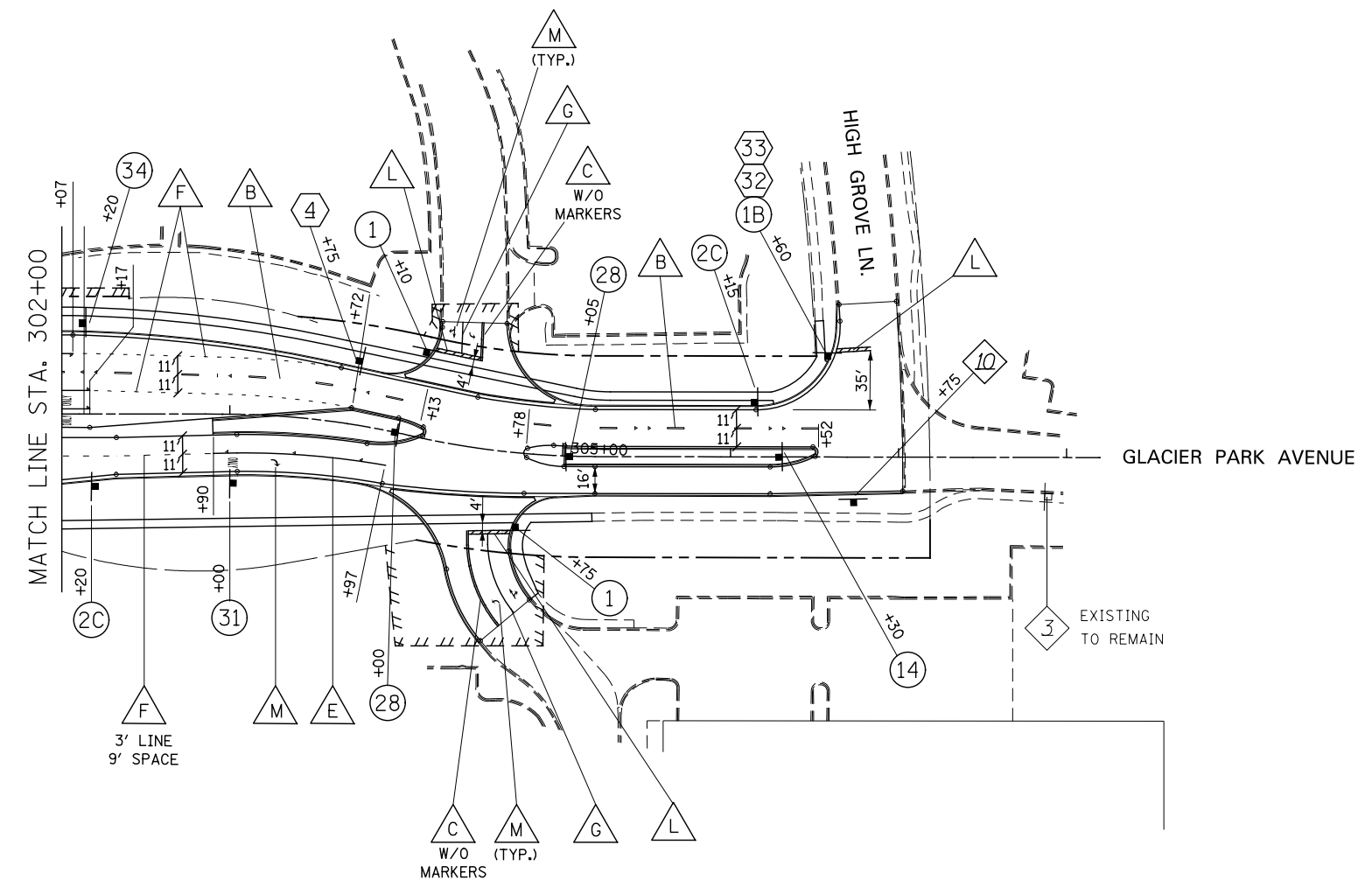

SIGN LEGEND

- STOP R1-1-30
- STOP R1-1-36
- SPEED LIMIT 30 R2-1-3036 (30 MPH)
- R4-7-3036
- R4-7-2430
- R3-4-24
- R3-5R-3036 ONLY
- R3-9dP-3012 END CLASS III TRUCK ROUTE
- R5-1102a-36
- M2-1-3021 JCT ILLINOIS 59
- M1-1100-36
- D3-1-6012 High Grove Ln
- D3-1-6612 Glacier Park Av
- NO OUTLET W14-2-30
- W1-7-4824

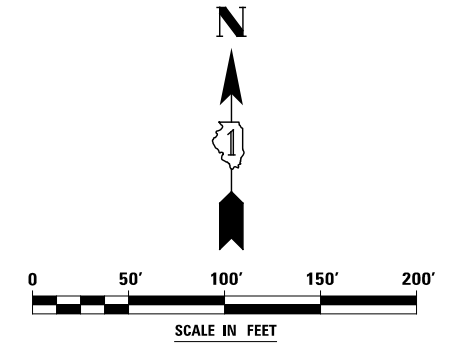

	DESIGNED <i>PJO</i>	REVISED -	STATE OF ILLINOIS DEPARTMENT OF TRANSPORTATION	PAVEMENT MARKING AND SIGNING - GLACIER PARK AVENUE	F.A.P. RTE.	SECTION	COUNTY	TOTAL SHEETS	SHEET NO.	
	DRAWN <i>KES</i>	REVISED -			338	(112 & 113) WRS-7	DUPAGE	1156	583	
	CHECKED <i>JCM</i>	REVISED -			CONTRACT NO. 60R30					
	DATE <i>12/14/2012</i>	REVISED -			ILLINOIS FED. AID PROJECT					
			SCALE: AS SHOWN SHEET NO. 14 OF 21 SHEETS STA. 302+00 TO STA. 307+00							