

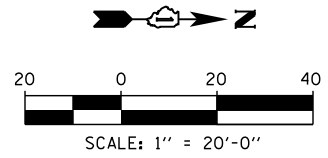

RESTORATION OF WORK AREA. RESTORATION OF THE TRAFFIC SIGNAL WORK AREA SHALL BE INCLUDED IN THE RELATED PAY ITEM SUCH AS FOUNDATION, CONDUIT, HANDHOLE, TRENCH AND BACKFILL, ETC., AND NO EXTRA COMPENSATION SHALL BE ALLOWED. ALL ROADWAY SURFACES SUCH AS SHOULDERS, MEDIAN, SIDEWALKS, PAVEMENT ETC. SHALL BE REPLACED IN KIND. ALL DAMAGE TO MOWED LAWNS SHALL BE REPLACED WITH AN APPROVED SOD, AND ALL DAMAGE TO UNMOWED FIELDS SHALL BE SEEDED IN ACCORDANCE WITH STANDARD SPECIFICATIONS 252 AND 250 RESPECTIVELY.

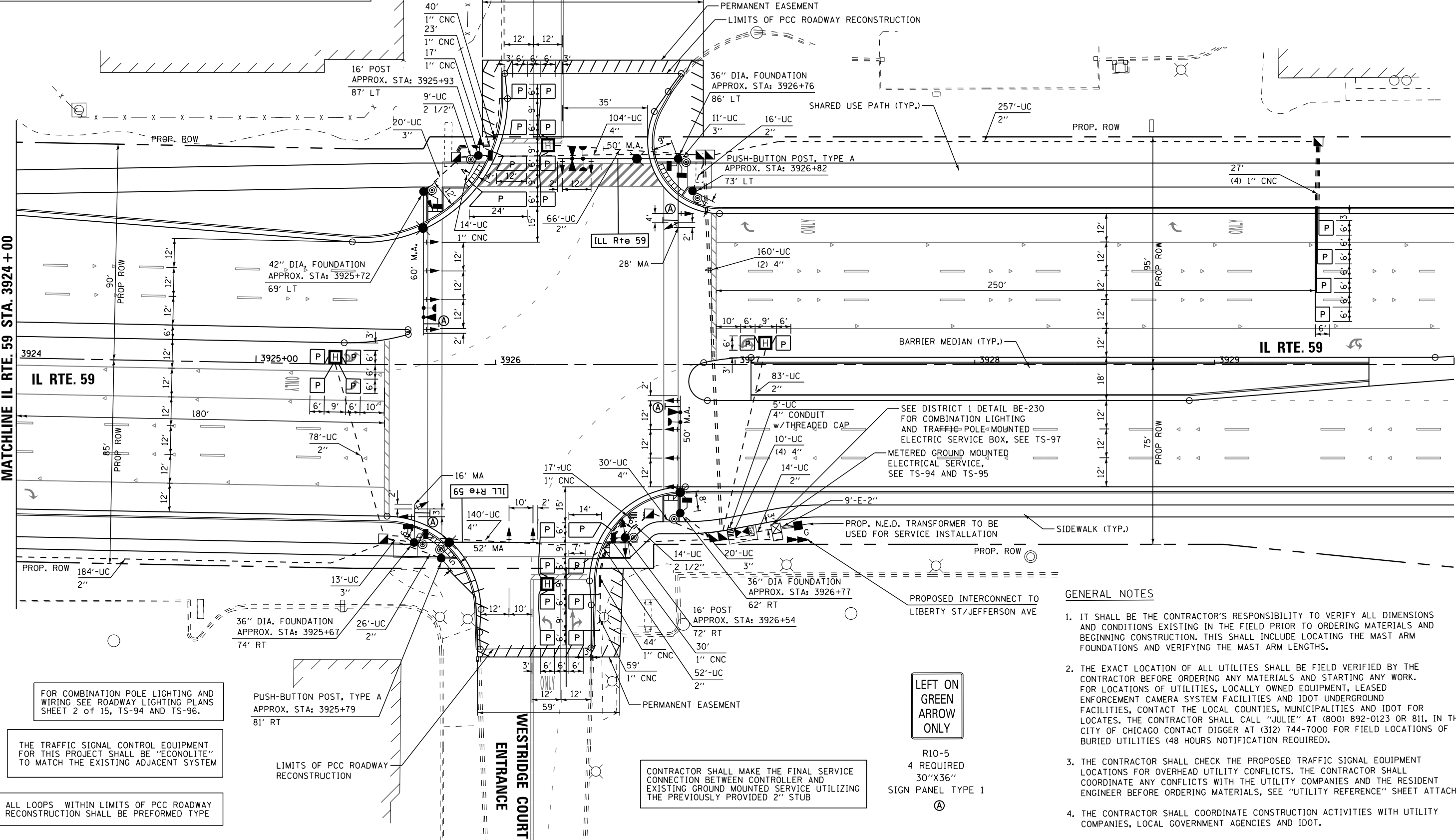

MATCHLINE IL RTE. 59 STA. 3924+00



FOR COMBINATION POLE LIGHTING AND WIRING SEE ROADWAY LIGHTING PLANS SHEET 2 OF 15, TS-94 AND TS-96.

THE TRAFFIC SIGNAL CONTROL EQUIPMENT FOR THIS PROJECT SHALL BE "ECONOLITE" TO MATCH THE EXISTING ADJACENT SYSTEM

ALL LOOPS WITHIN LIMITS OF PCC ROADWAY RECONSTRUCTION SHALL BE PREFORMED TYPE

PUSH-BUTTON POST, TYPE A  
 APPROX. STA: 3925+79  
 81' RT

LIMITS OF PCC ROADWAY RECONSTRUCTION

CONTRACTOR SHALL MAKE THE FINAL SERVICE CONNECTION BETWEEN CONTROLLER AND EXISTING GROUND MOUNTED SERVICE UTILIZING THE PREVIOUSLY PROVIDED 2" STUB

**LEFT ON GREEN ARROW ONLY**

R10-5  
 4 REQUIRED  
 30"X36"  
 SIGN PANEL TYPE 1

PROPOSED INTERCONNECT TO LIBERTY ST/JEFFERSON AVE

**GENERAL NOTES**

- IT SHALL BE THE CONTRACTOR'S RESPONSIBILITY TO VERIFY ALL DIMENSIONS AND CONDITIONS EXISTING IN THE FIELD PRIOR TO ORDERING MATERIALS AND BEGINNING CONSTRUCTION. THIS SHALL INCLUDE LOCATING THE MAJOR FOUNDATIONS AND VERIFYING THE MAJOR ARM LENGTHS.
- THE EXACT LOCATION OF ALL UTILITIES SHALL BE FIELD VERIFIED BY THE CONTRACTOR BEFORE ORDERING ANY MATERIALS AND STARTING ANY WORK. FOR LOCATIONS OF UTILITIES, LOCALLY OWNED EQUIPMENT, LEASED ENFORCEMENT CAMERA SYSTEM FACILITIES AND IDOT UNDERGROUND FACILITIES, CONTACT THE LOCAL COUNTIES, MUNICIPALITIES AND IDOT FOR LOCATES. THE CONTRACTOR SHALL CALL "JULIE" AT (800) 892-0123 OR 811, IN THE CITY OF CHICAGO CONTACT DIGGER AT (312) 744-7000 FOR FIELD LOCATIONS OF BURIED UTILITIES (48 HOURS NOTIFICATION REQUIRED).
- THE CONTRACTOR SHALL CHECK THE PROPOSED TRAFFIC SIGNAL EQUIPMENT LOCATIONS FOR OVERHEAD UTILITY CONFLICTS. THE CONTRACTOR SHALL COORDINATE ANY CONFLICTS WITH THE UTILITY COMPANIES AND THE RESIDENT ENGINEER BEFORE ORDERING MATERIALS, SEE "UTILITY REFERENCE" SHEET ATTACHED.
- THE CONTRACTOR SHALL COORDINATE CONSTRUCTION ACTIVITIES WITH UTILITY COMPANIES, LOCAL GOVERNMENT AGENCIES AND IDOT.

FILE NAME = K:\Projects\090059\Design\Sheet Files\679rwa59prcMRL.dgn	USER NAME = *USER*	DESIGNED - DW	REVISED -	<b>STATE OF ILLINOIS DEPARTMENT OF TRANSPORTATION</b>				<b>TRAFFIC SIGNAL MODERNIZATION PLAN IL RTE 59 AT MEIJER &amp; WESTRIDGE COURT ENTRANCES</b>				F.A. RTE. = 338	SECTION = (112 & 113) WRS-7	COUNTY = DUPAGE	TOTAL SHEETS = 1156	SHEET NO. = 618
PLOT SCALE = *SCALE*	CHECKED - KMM	REVISOR -	DATE -									SCALE: 1"=20'	SHEET NO. 1 OF 2 SHEETS	STA. TO STA.	<b>TS-26</b>	