

TEMPORARY TRAFFIC SIGNAL STAGE 1

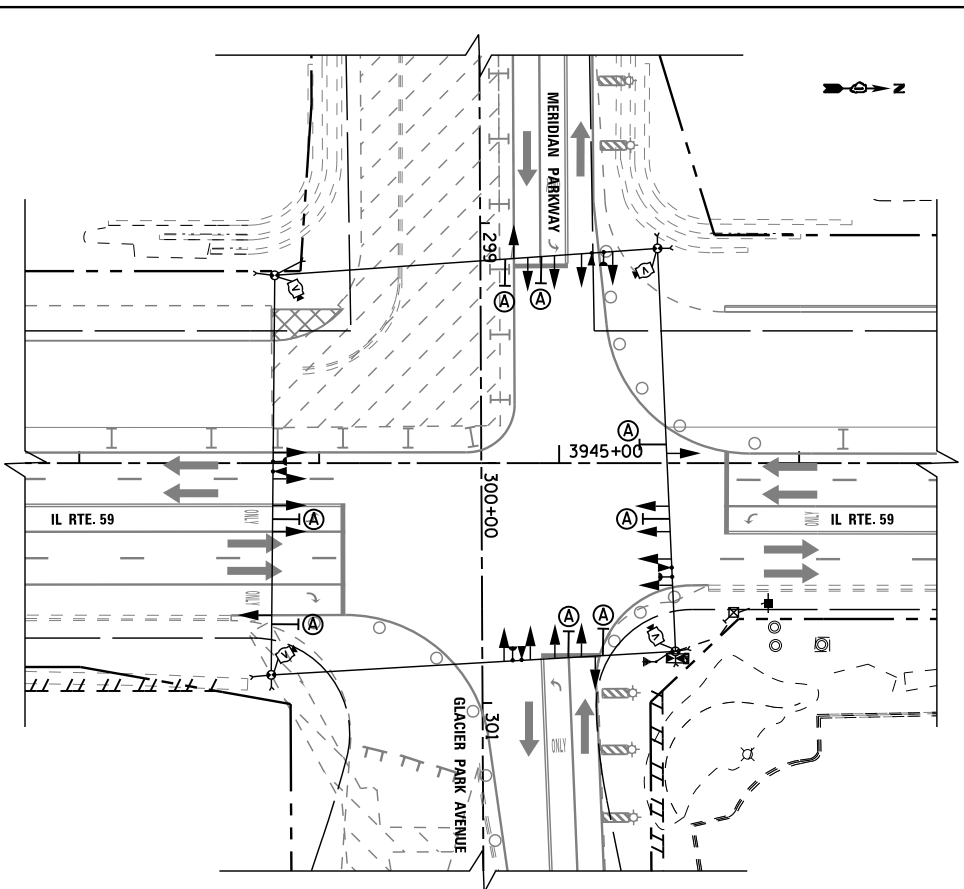

TEMPORARY TRAFFIC SIGNAL STAGE 1A

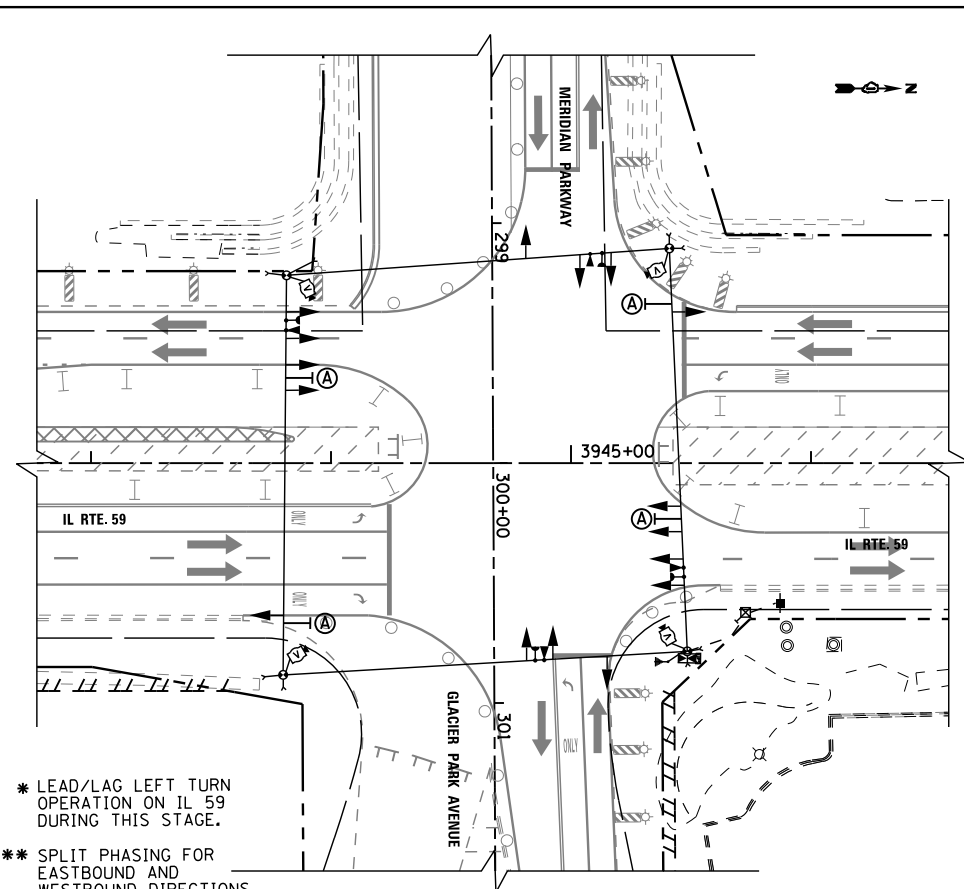

* LEAD/LAG LEFT TURN OPERATION ON IL 59 DURING THIS STAGE.
 ** SPLIT PHASING FOR EASTBOUND AND WESTBOUND DIRECTIONS.

TEMPORARY TRAFFIC SIGNAL STAGE 2

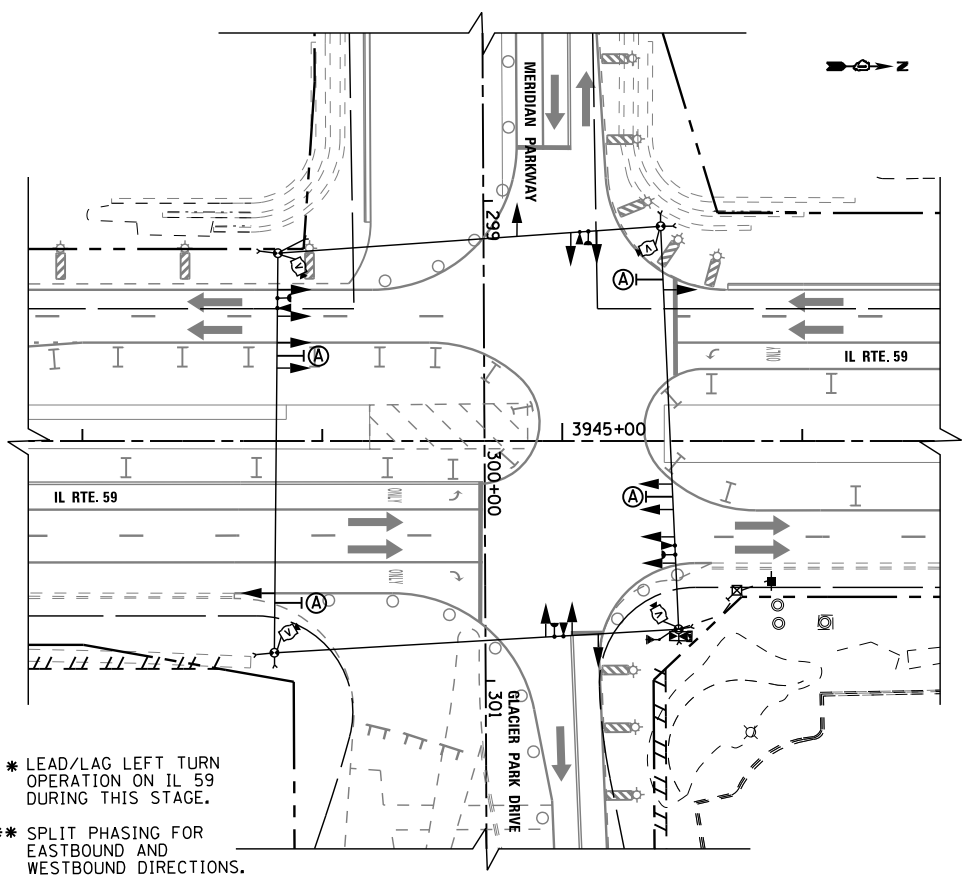

* LEAD/LAG LEFT TURN OPERATION ON IL 59 DURING THIS STAGE.
 ** SPLIT PHASING FOR EASTBOUND AND WESTBOUND DIRECTIONS.

TEMPORARY TRAFFIC SIGNAL STAGE 2A

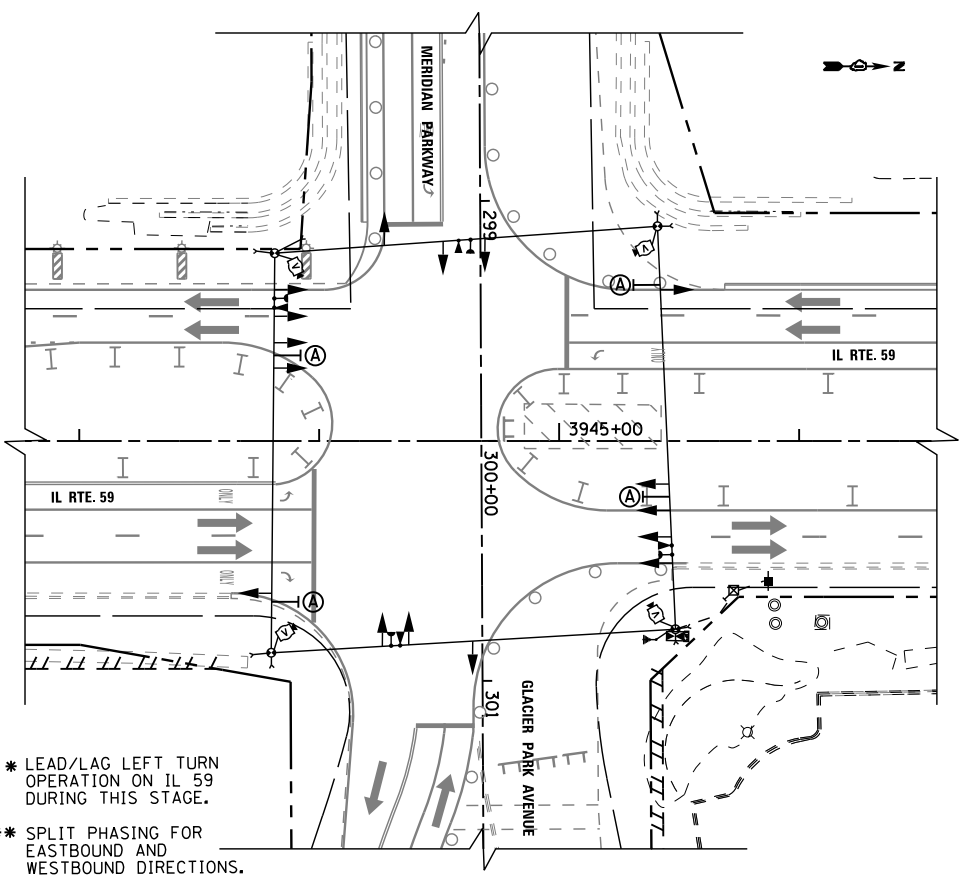

* LEAD/LAG LEFT TURN OPERATION ON IL 59 DURING THIS STAGE.
 ** SPLIT PHASING FOR EASTBOUND AND WESTBOUND DIRECTIONS.

TEMPORARY TRAFFIC SIGNAL STAGE 2B

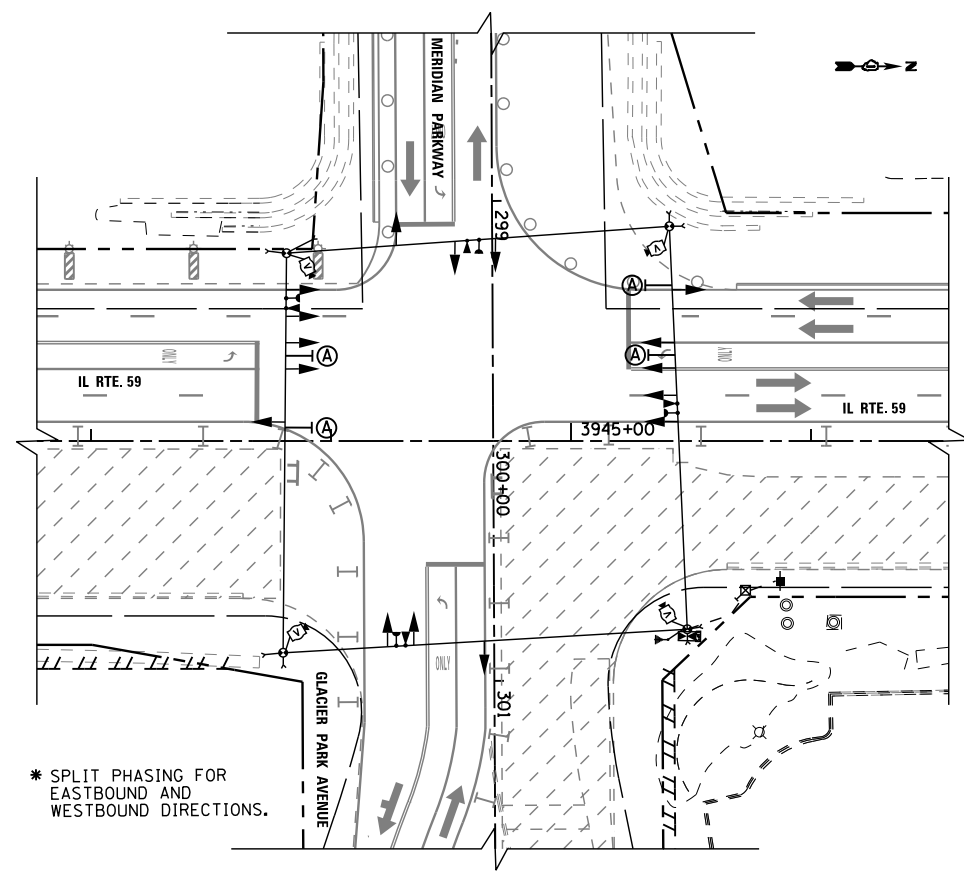

* SPLIT PHASING FOR EASTBOUND AND WESTBOUND DIRECTIONS.

TEMPORARY TRAFFIC SIGNAL STAGE 3

FILE NAME = K:\Projects\090059\Design\Sheet Files\679rwa59tempM2.dgn	USER NAME = *USER*	DESIGNED - DW	REVISED -	STATE OF ILLINOIS DEPARTMENT OF TRANSPORTATION	TEMPORARY TRAFFIC SIGNAL INSTALLATION MOT STAGING PLAN (1 OF 2) IL RTE 59 AT MERIDIAN PKWY / GLACIER PARK AV			F.A. RTE. 338	SECTION (112 & 113) WRS-7	COUNTY DUPAGE	TOTAL SHEETS 1156	SHEET NO. 635
PLOT SCALE = *SCALE*	CHECKED - KMM	REVISIED -	REVISIED -		SCALE: NTS	SHEET NO. 2 OF 3 SHEETS	STA. TO STA.	TS-43		CONTRACT NO. 60R30	ILLINOIS FED. AID PROJECT	
PLOT DATE = 12/6/2012	DATE -	REVISIED -	REVISIED -									