

INTERSECTION AND (SAMPLING)
 (SYSTEM) DETECTORS

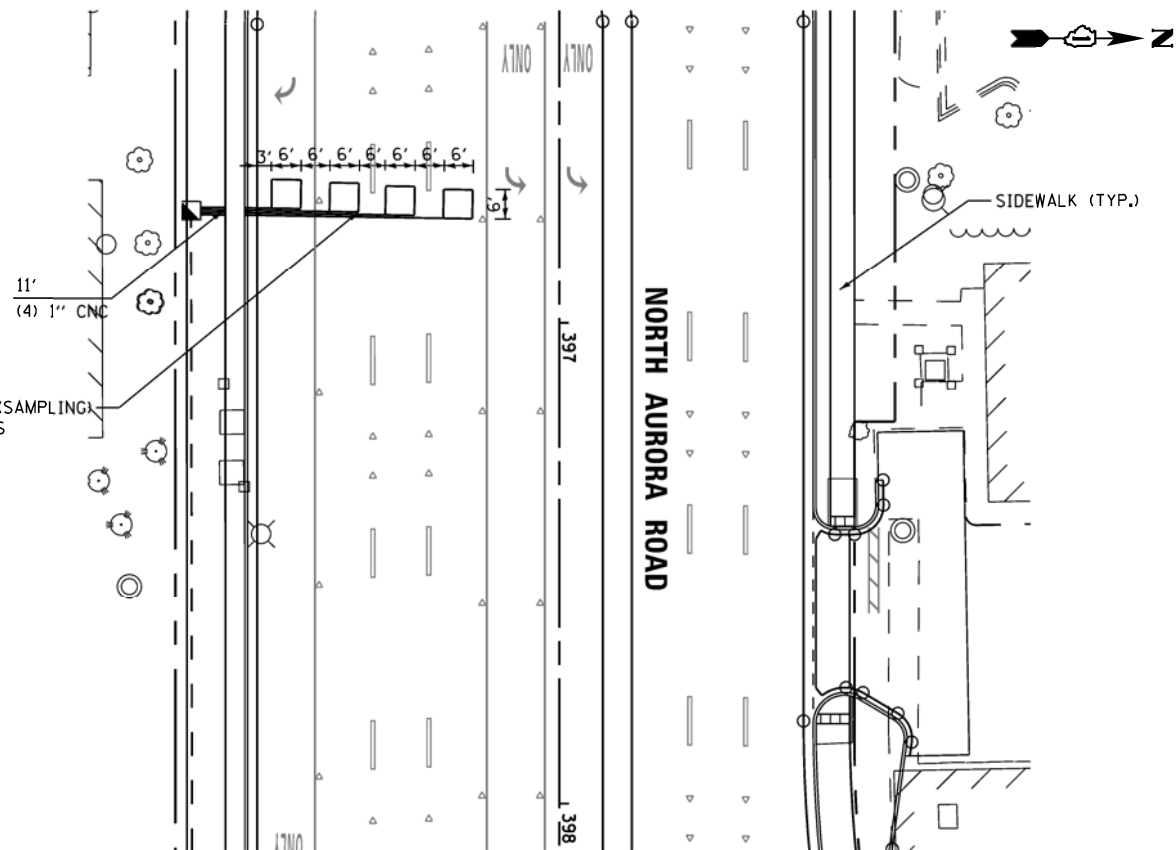

MATCHLINE NORTH AURORA RD STA. 398 + 10

MATCHLINE NORTH AURORA RD STA. 401 + 80

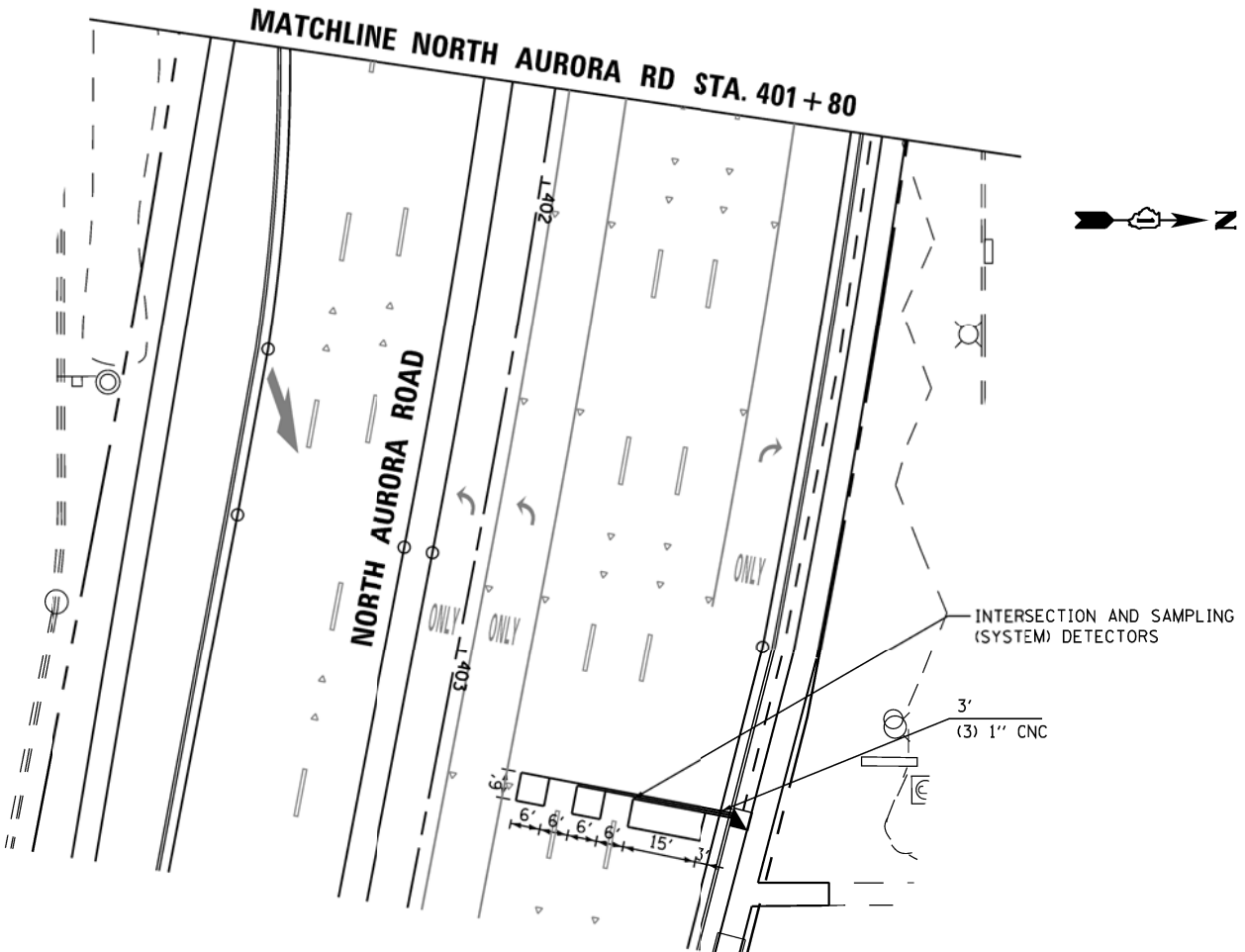

INTERSECTION AND SAMPLING
 (SYSTEM) DETECTORS

INTERSECTION AND (SAMPLING)
 (SYSTEM) DETECTORS

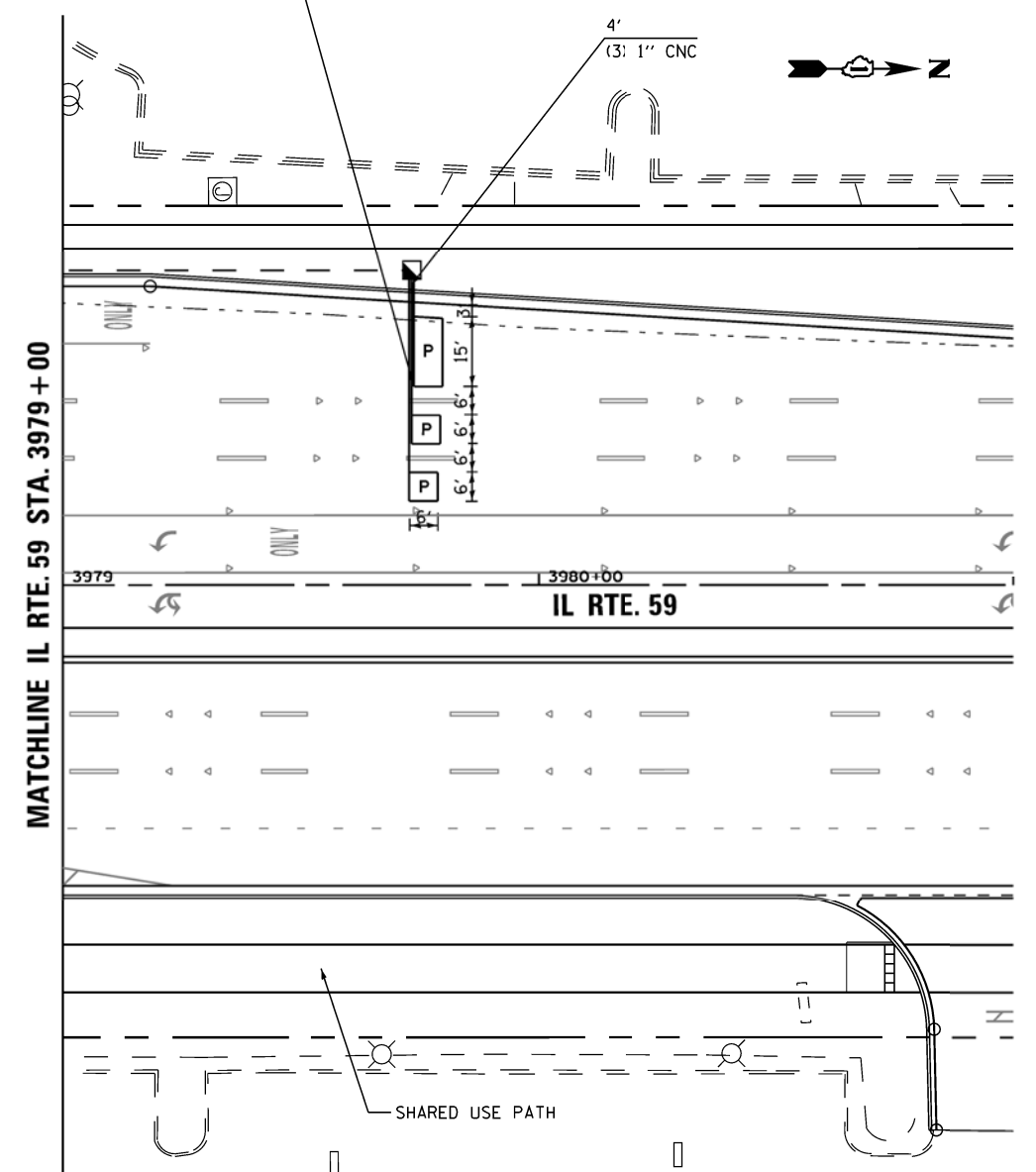

MATCHLINE IL RTE. 59 STA. 3979 + 00

IL RTE. 59

SHARED USE PATH

THE TRAFFIC SIGNAL CONTROL EQUIPMENT
 FOR THIS PROJECT SHALL BE "ECONOLITE"
 TO MATCH THE EXISTING ADJACENT SYSTEM

ALL LOOPS WITHIN LIMITS OF PCC ROADWAY
 RECONSTRUCTION SHALL BE PERFORMED TYPE

RESTORATION OF WORK AREA. RESTORATION OF THE TRAFFIC SIGNAL
 WORK AREA SHALL BE INCLUDED IN THE RELATED PAY ITEM SUCH AS
 FOUNDATION, CONDUIT, HAND-OLE, TRENCH AND BACKFILL, ETC., AND NO
 EXTRA COMPENSATION SHALL BE ALLOWED. ALL ROADWAY SURFACES SUCH
 AS SHOULDERS, MEDIAN, SIDEWALKS, PAVEMENT ETC. SHALL BE REPLACED
 IN KIND. ALL DAMAGE TO MOWED LAWNS SHALL BE REPLACED WITH AN
 APPROVED SOD, AND ALL DAMAGE TO UNMOWED FIELDS SHALL BE SEEDED
 IN ACCORDANCE WITH STANDARD SPECIFICATIONS 252 AND 250 RESPECTIVELY.

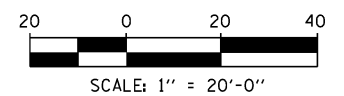

FILE NAME =	USER NAME = #USER#	DESIGNED - DW	REVISED -
K:\Projects\090059\Design\Sheet Files\6799rwa59proNA2.dgn		DRAWN - JDH	REVISED -
	PLOT SCALE = #SCALE#	CHECKED - KMM	REVISED -
	PLOT DATE = 12/6/2012	DATE -	REVISED -

STATE OF ILLINOIS
 DEPARTMENT OF TRANSPORTATION

TRAFFIC SIGNAL MODERNIZATION PLAN
 IL RTE 59 AT NORTH AURORA ROAD (2 OF 3)

SCALE: 1"=20' SHEET NO. 2 OF 3 SHEETS STA. TO STA.

F.A. RTE.	SECTION	COUNTY	TOTAL SHEETS	SHEET NO.
338	(112 & 113) WRS-7	DUPAGE	1156	650
TS-58		CONTRACT NO. 60R30		
ILLINOIS FED. AID PROJECT				