

F.A. RTE. 338/IL 59	SECTION 2011-030	COUNTY DUPAGE	TOTAL SHEETS 4	SHEET NO. 3
STA. TO STA.		FED. ROAD DIST. NO. ILLINOIS CONTRACT 60R30		

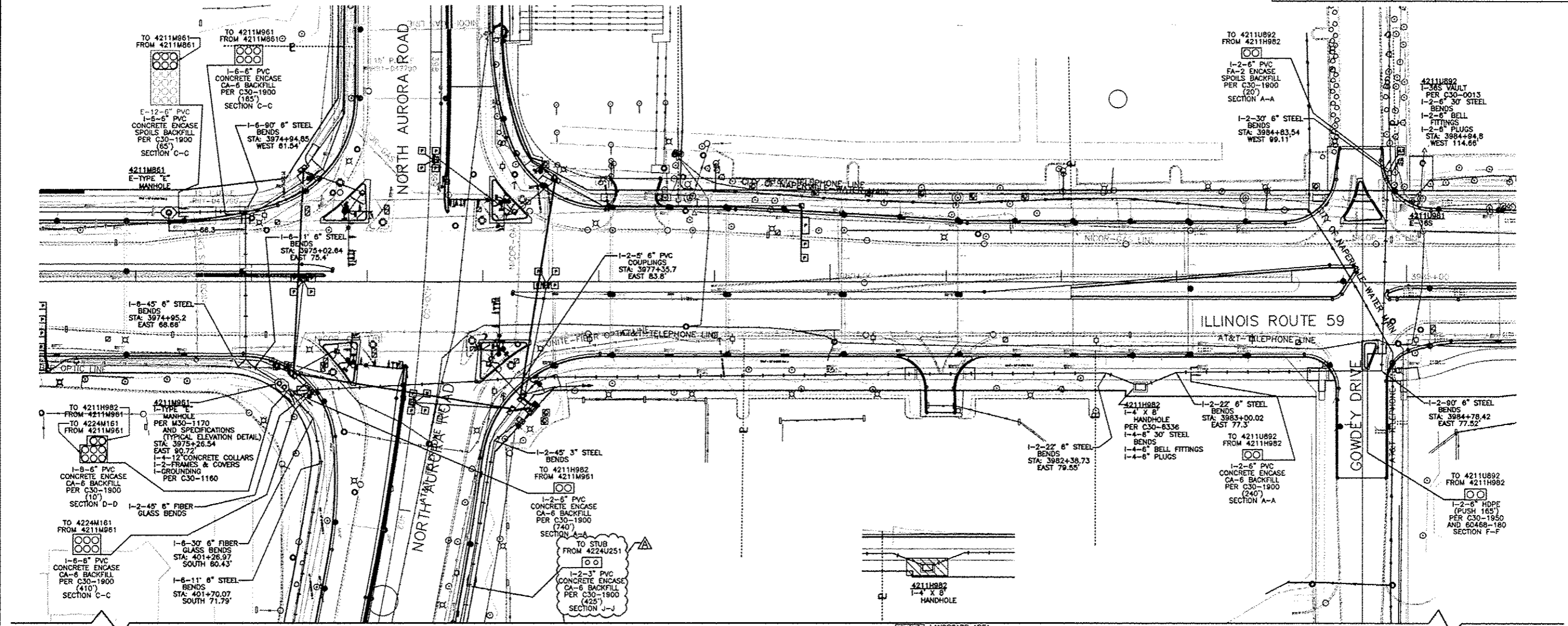

SEE SHEET 4 STA: 403+00 SEE SHEET 4 LANDSCAPE AREA SEED = .012 ACRES

LEGEND

EXISTING		INSTALL	
	E-SW. MOD.		I-TYPE "G" DOUBLE OPENING MANHOLE
	E-TYPE "E" MANHOLE		I-TYPE "E" DOUBLE OPENING MANHOLE
	E-CONDUIT		I-CONDUIT
	E-TYPE "G" MANHOLE		I-SW. VAULT
	E-STEEL TRANSMISSION POLE		I-HANDHOLE PER C30-6336
	E-O.H. 136KV		

CALL JULIE 48 HRS. PRIOR TO CONSTRUCTION
1-800-892-0123 OR CALL 811

NOTES:
 1. THE PROJECT ENGINEER FOR THIS PROJECT IS BRIAN CHAMBERLAIN PHONE NUMBER (630)490-0953.
 2. THE PROJECT COORDINATOR FOR THIS PROJECT IS PAUL MICHALOWSKI PHONE NUMBER (630)305-6227.
 3. CONTRACTOR IS RESPONSIBLE FOR MANHOLE PHOTOS TAKEN OF ALL CLEARLY MARKED CABLE AND ALL WALLS OF MANHOLES. PHOTOS WILL BE GIVEN TO THE GIS GROUP WITH THE AS-BUILTS.

ADDENDUM - 02-20-2013

LOCATION MAP

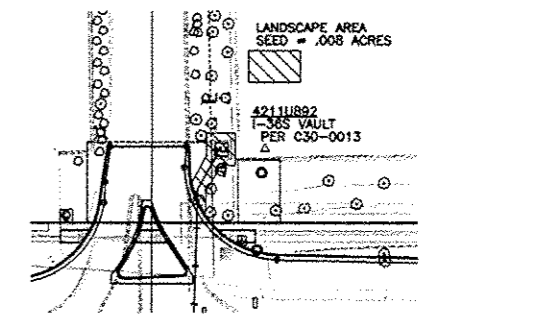

PROJECT TITLE ROUTE 59 ROAD IMPROVEMENTS			
PROJECT DESCRIPTION TO INSTALL NEW FACILITIES AND RELOCATE OLD FACILITIES ALONG WITH ROAD PROJECT			
DESIGNER BCC	DATE 2-07-13	DRAWN BY 4211.4224	SHEET NO. 1 = 40
CHECKED BY DL	APPROVED BY PSM	DATE N/A	PROJECT NO. EU-12
DRAWN BY 008046800103.DWG		SHEET NO. 3 OF 40	
Naperville		Department of Public Utilities Electric Division	
CONTRACT 60R30		SHEET 804 OF 1156	



61123