

FINAL SURVEY	SURVEYED	DATE
NOTE BOOK	PLOTTED	
NO.	TEMPLATE	
	AREAS CHECKED	

ORIGINAL SURVEY	SURVEYED	DATE
NOTE BOOK	PLOTTED	
NO.	TEMPLATE	
	AREAS CHECKED	

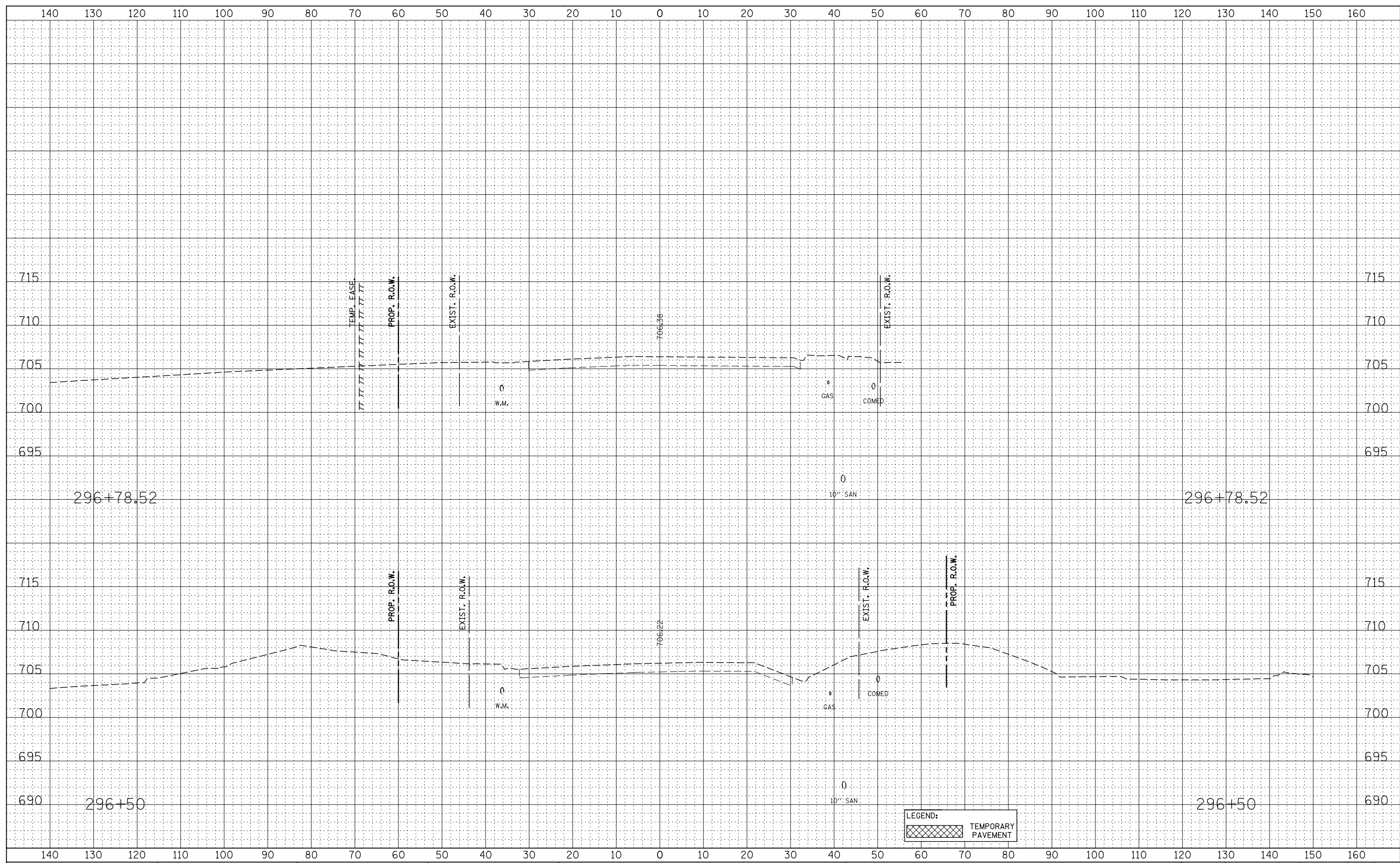
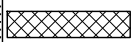

LEGEND:  
 TEMPORARY PAVEMENT

**STATE OF ILLINOIS  
DEPARTMENT OF TRANSPORTATION**

**MERIDIAN PKWY. / GLACIER PARK AVE.  
PRE-STAGE CROSS-SECTIONS**

DESIGNED	- RTA	REVISED	-
DRAWN	- KES	REVISED	-
CHECKED	- PJO	REVISED	-
DATE	- 12/14/2012	REVISED	-

SCALE: SHEET NO. 4 OF 9 SHEETS STA. 296+50 TO STA. 296+78.52

F.A.P. RTE.	SECTION	COUNTY	TOTAL SHEETS	SHEET NO.
338	(112 & 113) WRS-7	DUPAGE	1156	1103
CONTRACT NO. 60R30				
FED. ROAD DIST. NO. ILLINOIS FED. AID PROJECT				