

SEE STANDARD 701400 (SPECIAL) FOR APPROACH LANE CLOSURE SIGNING

WORK ZONE	W2-1115(0)-3618
SPEED LIMIT	R2-1-3648
45	
PHOTO ENFORCED	R10-190P-3618
XXXX FINE MINIMUM	R2-1106-3618

PLAN

SYMBOLS

- ↑ ARROW BOARD
- ▨ WORK AREA
- ⊥ SIGN
- TRAFFIC CONTROL DRUM WITH STEADY BURN MONODIRECTIONAL LIGHT
- FLAGGER
- ▬ TEMPORARY CONCRETE BARRIER
- ◁ MONODIRECTIONAL BARRIER WALL/GUARDRAIL MARKER
- ▩ IMPACT ATTENUATOR

GENERAL NOTES

THIS STANDARD IS USED WHERE AT ANY TIME ANY VEHICLE, EQUIPMENT, WORKERS OR THEIR ACTIVITIES WILL ENCR OACH ON THE PAVEMENT OR ON THE SHOULDER WITHIN 24 INCHES OF THE EDGE OF PAVEMENT FOR DAYLIGHT OPERATION EXCEEDING ONE DAY AND WHERE TEMPORARY CONCRETE BARRIER IS UTILIZED.

THIS STANDARD MUST BE USED IN COMBINATION WITH STANDARD 701400 (SPECIAL).

WHEN WORK IS BEING PERFORMED IN THE LEFT LANE, THE SET UP WOULD BE A MIRROR IMAGE TO WHAT IS SHOWN.

FLAGGER, FLAGGER SIGNS AND SPEED LIMIT SIGNS SHALL BE REQUIRED WHENEVER TEMPORARY CONCRETE BARRIER IS NOT IN PLACE. WHEN TEMPORARY CONCRETE BARRIER IS IN PLACE, THE FLAGGER SIGNS SHALL BE REMOVED OR COVERED AND THE FLAGGER NOT REQUIRED.

TEMPORARY CONCRETE BARRIER SHALL BE ACCORDING TO STANDARD 704001.

- ① TEMPORARY PAVEMENT MARKING
- ② EXISTING PAVEMENT MARKING

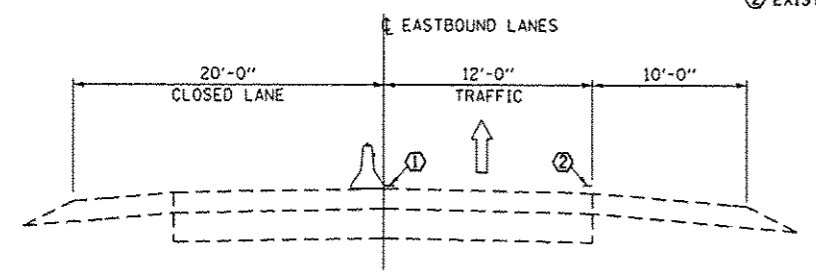

LEFT LANE CLOSURE
LOOKING IN DIRECTION OF TRAFFIC

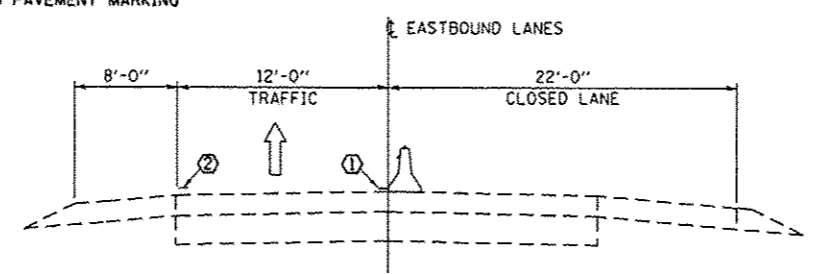

RIGHT LANE CLOSURE
LOOKING IN DIRECTION OF TRAFFIC

NOTE: TRAFFIC CONTROL AND PROTECTION FOR TWO-LANE ROADS SHALL BE ACCORDING TO STANDARD 701201.

- ① TEMPORARY PAVEMENT MARKING
- ② EXISTING PAVEMENT MARKING SHALL BE PLACED THROUGHOUT THE TAPER AND ALONGSIDE THE WORK AREA. THE RIGHT EDGE LINE SHALL BE WHITE AND THE LEFT EDGE LINE SHALL BE YELLOW.
- ③ BARRIER WALL/GUARDRAIL MARKERS AT 25'. MARKERS ON RIGHT SHALL BE CRYSTAL AND MARKERS ON LEFT SHALL BE AMBER. COST INCLUDED WITH TEMPORARY CONCRETE BARRIER.

FILE NAME =	USER NAME = spurlockd	DESIGNED - DBS	REVISED -	STATE OF ILLINOIS DEPARTMENT OF TRANSPORTATION	TRAFFIC CONTROL AND PROTECTION STANDARD 701402 (SPECIAL)				F.A.S. RTE.	SECTION	COUNTY	TOTAL SHEETS	SHEET NO.
a:\p\work\p\pudat\spurlockd\0339518\030	ECT1-shr-details.dgn	DRAWN - DBS	REVISED -		2370	17B-1HB-1BP	PUTNAM	8	5				
Default	PLOT SCALE = 1/8" = 100.0000' / in.	CHECKED -	REVISED -		CONTRACT NO. 66C91								
	PLOT DATE = 3/26/2013	DATE - MAR 2013	REVISED -		ILLINOIS FED. AID PROJECT								