

STA. 1781+99.84
 EXISTING MEDIAN INLET BOX
 EXISTING 36" RCCP
 USFL 70' LT. = 820.28
 DSFL 91' RT. = 815.10

SEC. 28, T20N, R8E, 3RD P.M.

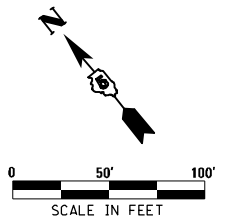

PLAN	SUBMITTED	DATE
NOTE BOOK	ALIGNED	
NO.	FILE NAME	

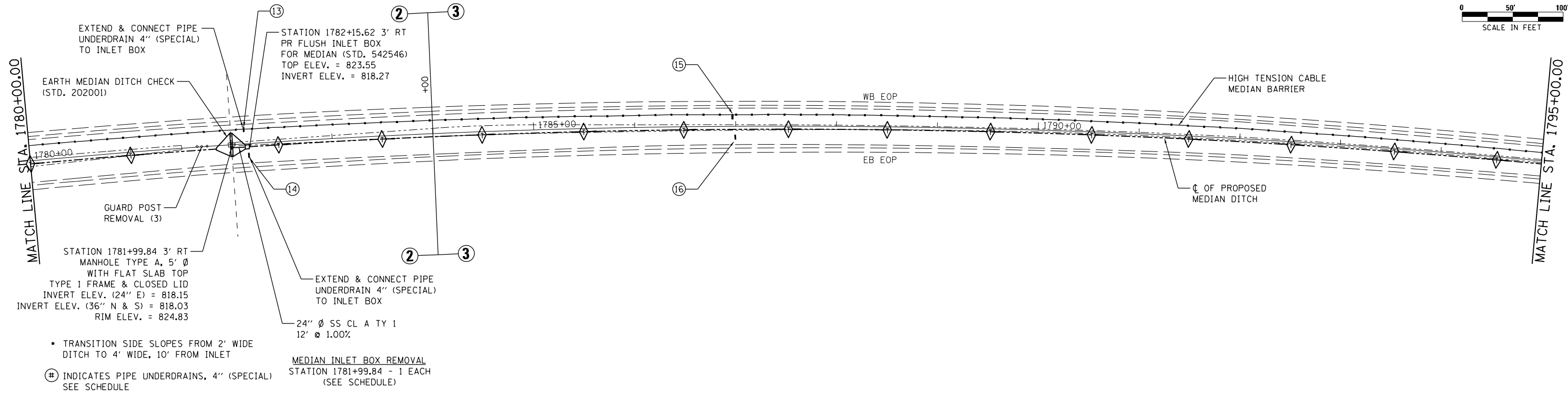

- TRANSITION SIDE SLOPES FROM 2' WIDE DITCH TO 4' WIDE, 10' FROM INLET
- ⊕ INDICATES PIPE UNDERDRAINS, 4" (SPECIAL) SEE SCHEDULE
- ⊕ MEDIAN INLET BOX REMOVAL STATION 1781+99.84 - 1 EACH (SEE SCHEDULE)

PROFILE	SUBMITTED	DATE
NOTE BOOK	GRADES CHECKED	
NO.	STRUCTURE NOTATIONS	OFFNO.

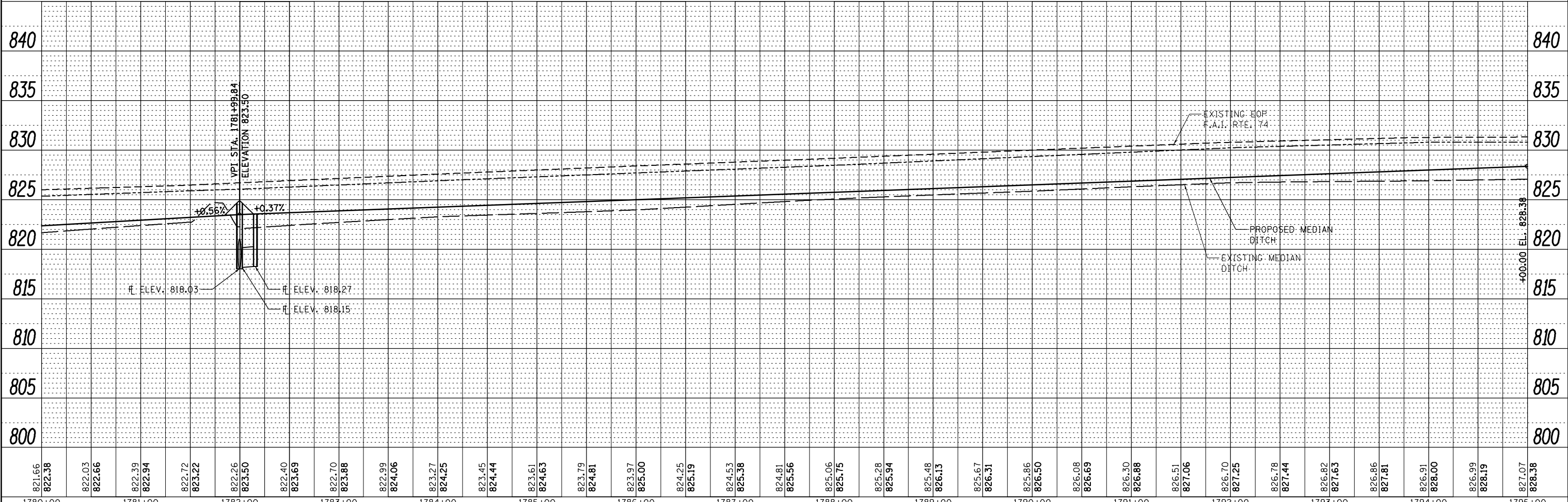

821.66	822.58	822.03	822.66	822.39	822.94	822.72	823.22	822.26	823.50	822.40	823.69	822.70	823.88	822.99	824.06	823.27	824.25	823.45	824.44	823.61	824.63	823.79	824.81	823.97	825.00	824.25	825.19	824.63	825.38	824.81	825.56	825.06	825.75	825.28	825.94	825.48	826.13	825.67	826.31	825.86	826.50	826.08	826.69	826.30	826.88	826.51	827.06	826.70	827.25	826.78	827.44	826.82	827.63	826.86	827.81	826.91	828.00	826.99	828.19	827.07	828.38
1780+00	1781+00	1782+00	1783+00	1784+00	1785+00	1786+00	1787+00	1788+00	1789+00	1790+00	1791+00	1792+00	1793+00	1794+00	1795+00																																														

McDonough-Whitlow, P.C.
 Consulting Engineers & Land Surveyors
 PROFESSIONAL DESIGN NO. 184-002754

USER NAME = Richard Heinke	DESIGNED - JAH	REVISED -
PLOT SCALE = 100.0000' / in.	DRAWN - RNH	REVISED -
PLOT DATE = 3/7/2013	CHECKED - TMM	REVISED -
	DATE -	REVISED -

STATE OF ILLINOIS
 DEPARTMENT OF TRANSPORTATION

SCALE: 1" = 50'	SHEET 4	OF 22 SHEETS	STA. 1780+00.00	TO STA. 1795+00.00
-----------------	---------	--------------	-----------------	--------------------

PLAN & PROFILE
 F.A.I. 74

F.A.I. RTE.	SECTION	COUNTY	TOTAL SHEETS	SHEET NO.
74	MEDIAN CABLE 2013-1	CHAMPAIGN	119	21
CONTRACT NO. 70A00			ILLINOIS FED. AID PROJECT	