

PLAN	SURVEYED	DATE
	PLOTTED	BY
	GRADES CHECKED	
	STRUCTURE NOTATIONS OK'D	
	NOTE BOOK NO.	
	CARD FILE NAME	

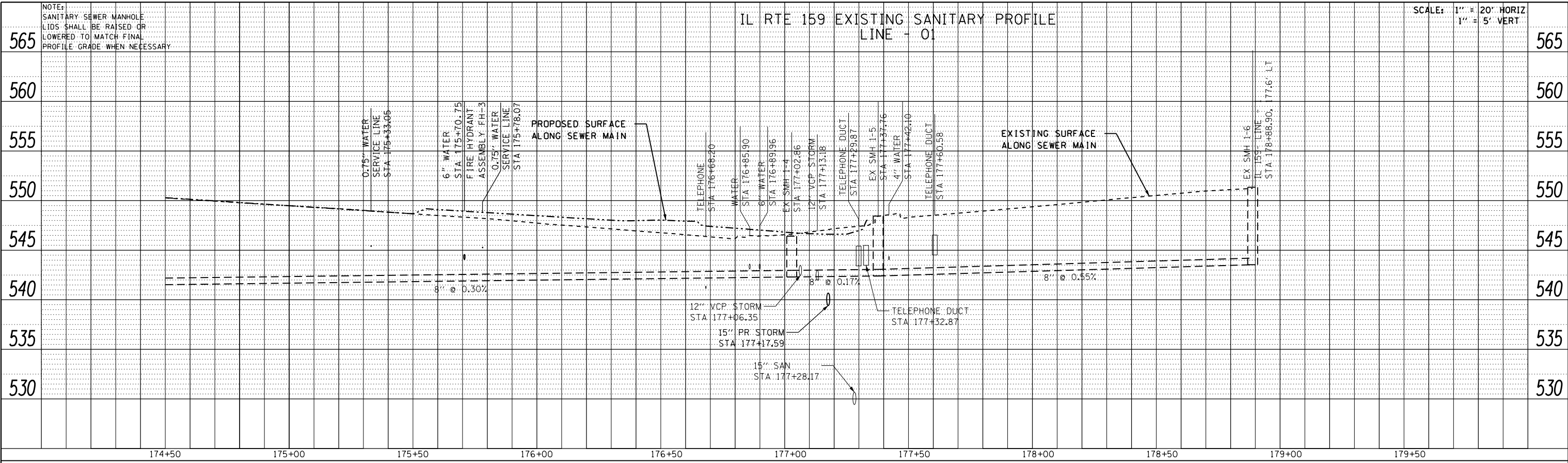

NOTE:  
SANITARY SEWER MANHOLE  
LIDS SHALL BE RAISED OR  
LOWERED TO MATCH FINAL  
PROFILE GRADE WHEN NECESSARY

PROFILE	SURVEYED	DATE
	PLOTTED	BY
	GRADES CHECKED	
	STRUCTURE NOTATIONS OK'D	
	NOTE BOOK NO.	
	CARD FILE NAME	

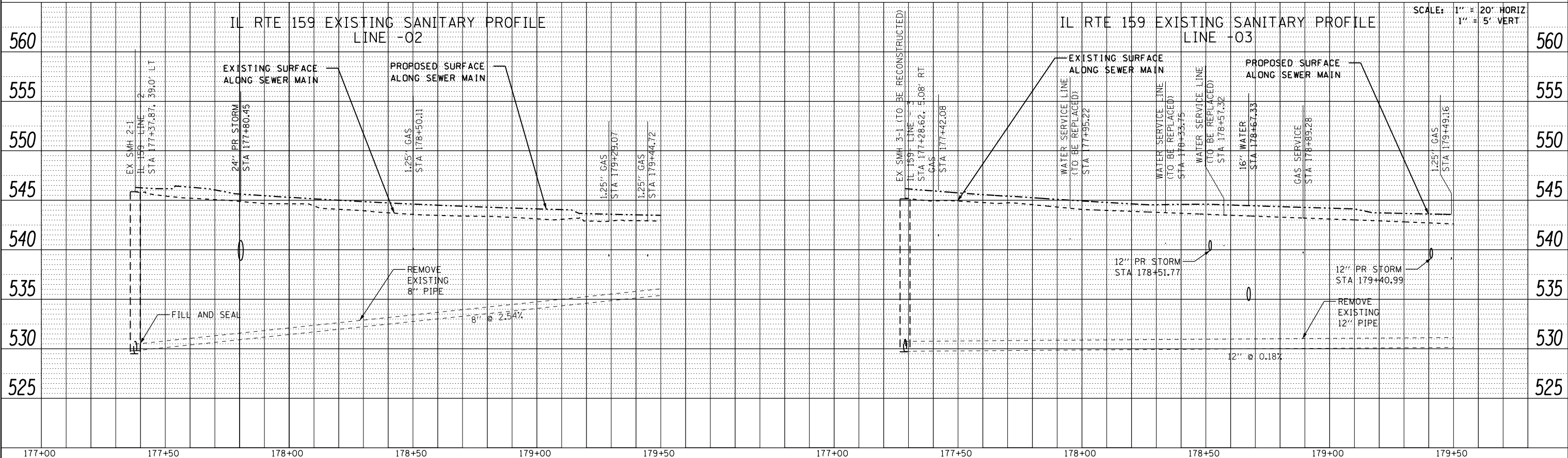

FILE NAME =	USER NAME = default	DESIGNED - DRH	REVISED -	<b>STATE OF ILLINOIS</b> <b>DEPARTMENT OF TRANSPORTATION</b>	<b>DRAINAGE AND UTILITY PROFILE</b> <b>IL ROUTE 159</b>	F.A.P. RTE. = 600	SECTION = 60-(30,31,128)-3	COUNTY = MADISON	TOTAL SHEETS = 529	SHEET NO. = 166	
PLOT SCALE = 40.0000' / in.	CHECKED - VAM	REVISED -	SCALE: N/A			SHEET NO. 13 OF 73 SHEETS	STA. 174+50.00 TO STA. 179+50.00	CONTRACT NO. 76B85			
PLOT DATE = 2/1/2013	DATE = 01/25/2013	REVISED -	ILLINOIS FED. AID PROJECT								