

DATE	
BY	
FINAL SURVEY	SURVEYED
NOTE BOOK	PLOTTED
NO.	TEMPLATE
	AREAS CHECKED

DATE	
BY	
ORIGINAL SURVEY	SURVEYED
NOTE BOOK	PLOTTED
NO.	TEMPLATE
	AREAS CHECKED

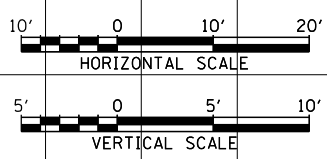
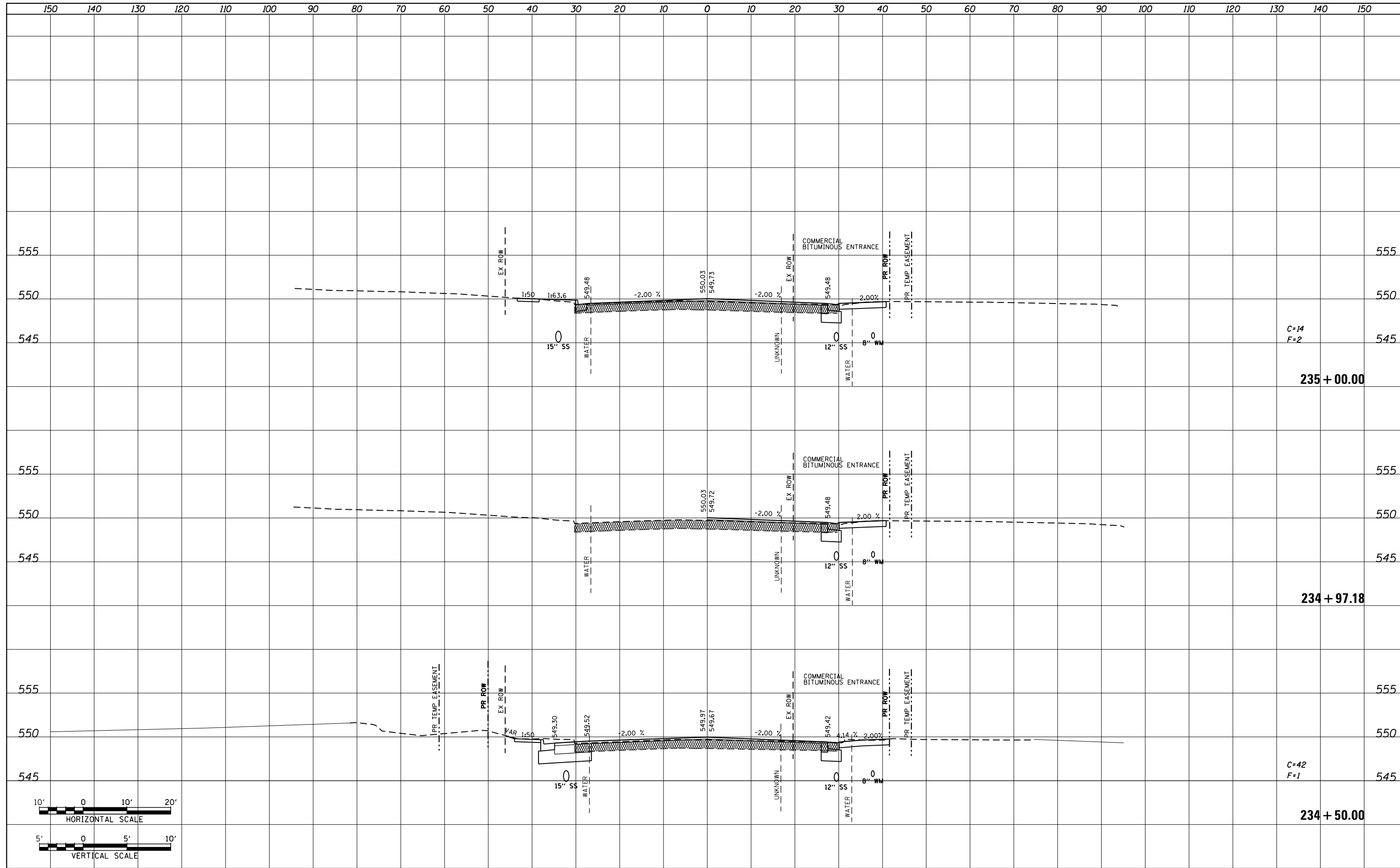

FILE NAME = P:\Projects\513501\CADD\DGN\0876885-sht-xsc-15.dgn	USER NAME = default	DESIGNED - AGF	REVISED -	STATE OF ILLINOIS DEPARTMENT OF TRANSPORTATION	IL ROUTE 159 MAINLINE CROSS SECTIONS			F.A.P. RTE. 600	SECTION 60-(30,31,128)-3	COUNTY MADISON	TOTAL SHEETS 529	SHEET NO. 438
MODELNAME	PLOT SCALE = 20.0000' / in.	CHECKED - CLS	REVISED -		SCALE: H: 1"=10'	SHEET 69 OF 72 SHEETS	STA. 234+50.00 TO STA. 235+00.00	CONTRACT NO. 76885		ILLINOIS FED. AID PROJECT		
	PLOT DATE = 1/25/2013	DATE - 01/25/2013	REVISED -		V: 1"=5'							