

DATE	
BY	
FINAL SURVEY	SURVEYED
NOTE BOOK	PLOTTED
NO.	TEMPLATE
	AREAS CHECKED

DATE	
BY	
ORIGINAL SURVEY	SURVEYED
NOTE BOOK	PLOTTED
NO.	TEMPLATE
	AREAS CHECKED

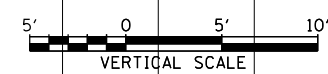
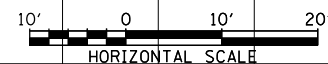
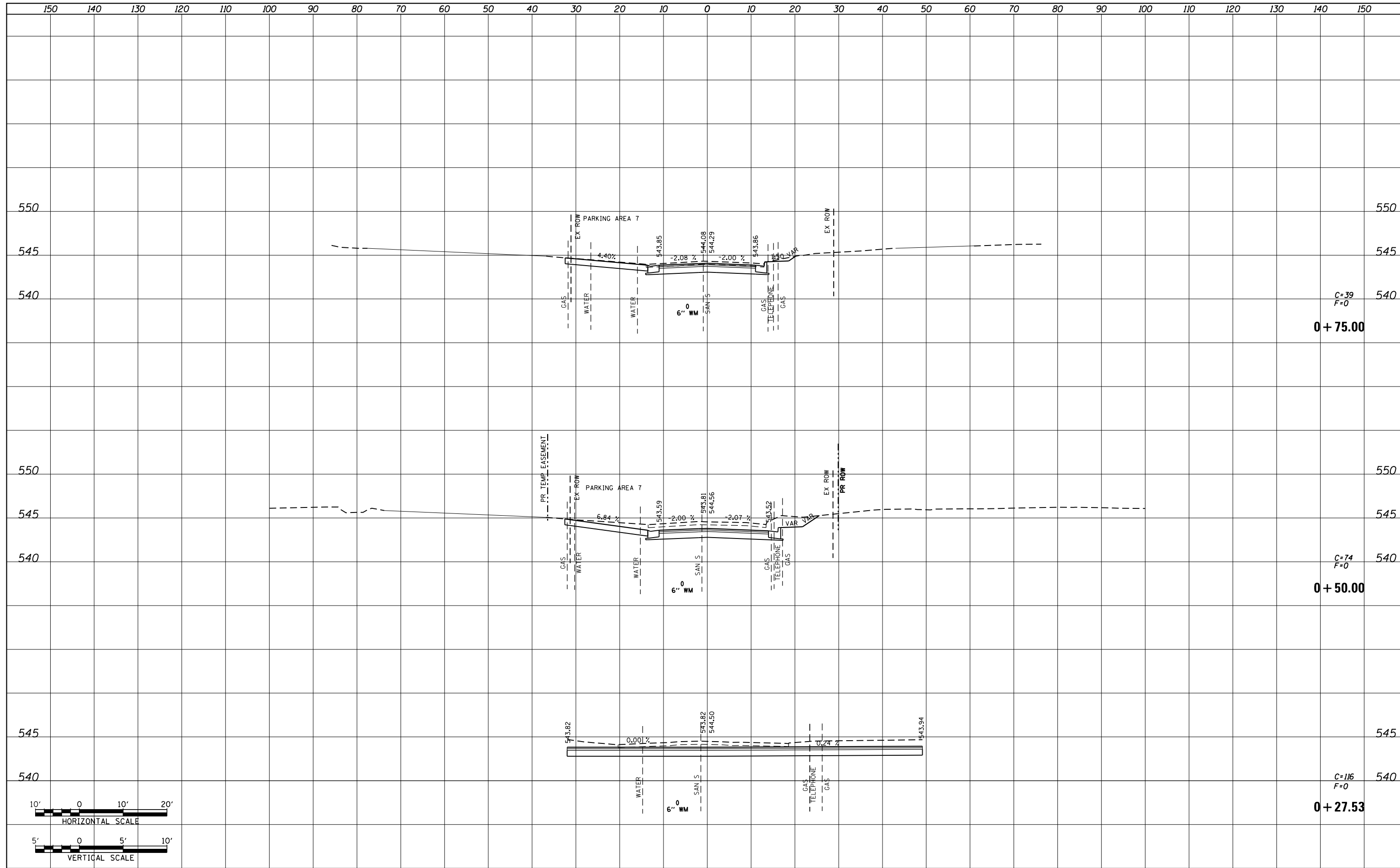

FILE NAME = P:\Projects\513501\CADD\GN\0876885-sht-xsc-rebecca.dgn	USER NAME = default	DESIGNED - AGF	REVISIED -	<b>STATE OF ILLINOIS DEPARTMENT OF TRANSPORTATION</b>	<b>REBECCA AVE SIDE ROAD CROSS SECTIONS</b>			F.A.P. RTE. 600	SECTION 60-(30,31,128)-3	COUNTY MADISON	TOTAL SHEETS 529	SHEET NO. 481
PLOT SCALE = 20.0000' / in.	CHECKED - CLS	REVISIED -	SCALE: H <sub>v</sub> 1"=10' V <sub>v</sub> 1"=5'		SHEET NO. 1 OF 2 SHEETS	STA. 0+27.53	TO STA. 0+75.00	CONTRACT NO. 76885		ILLINOIS FED. AID PROJECT		
PLOT DATE = 1/25/2013	DATE - 01/25/2013	REVISIED -										