

DATE	BY
SURVEYED	
PLOTTED	
TEMPLATE	
AREAS CHECKED	
NO.	

DATE	BY
SURVEYED	
PLOTTED	
TEMPLATE	
AREAS CHECKED	
NO.	

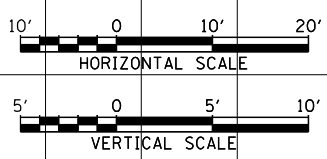
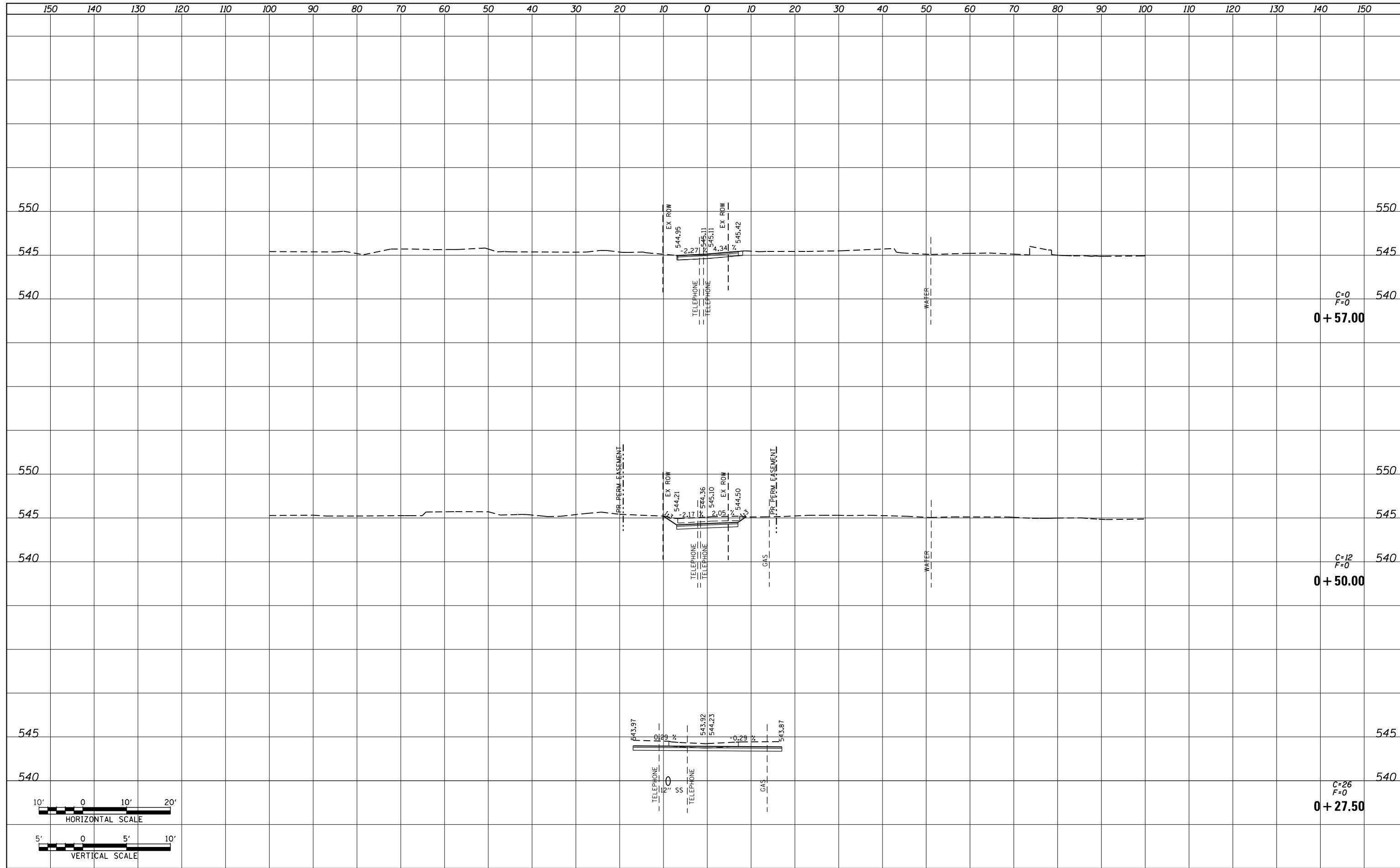

FILE NAME = P:\Projects\513501\CADD\GN\0876885-sht-xsc.dgn	USER NAME = default	DESIGNED - AGF	REVISIED -	STATE OF ILLINOIS DEPARTMENT OF TRANSPORTATION	ALLEY AT 199 + 96 SIDE ROAD CROSS SECTIONS			F.A.P. RTE. 600	SECTION 60-(30,31,128)-3	COUNTY MADISON	TOTAL SHEETS 529	SHEET NO. 483
	PLOT SCALE = 20.0000' / in.	CHECKED - CLS	REVISIED -		SCALE: H _v 1"=10' V _v 1"=5'	SHEET NO. 1 OF 1 SHEETS	STA. 0+27.50	TO STA. 0+57.00	CONTRACT NO. 76885			
	PLOT DATE = 1/25/2013	DATE - 01/25/2013	REVISIED -		ILLINOIS FED. AID PROJECT							