

STATE OF ILLINOIS
DEPARTMENT OF TRANSPORTATION

Note:
For detail A see, sht. 6 of 11.
For cross section thru panels, drilled pile and const. Jt. detail see, sht. 7 of 11.
For Soldier pile data & Bill of Material see, sht. 8 of 11
For Rail Post Details see, sht 9 of 11.

* order $v_1(E)$ & $v_2(E)$ bars full length cut to fit
as per Bar Cutting Diagram shown
on sht. 8 of 11. Use remainder of
bars on the opposite face of the wall.

Min. bar laps

(unless noted otherwise)
5 bar = 1'-8"

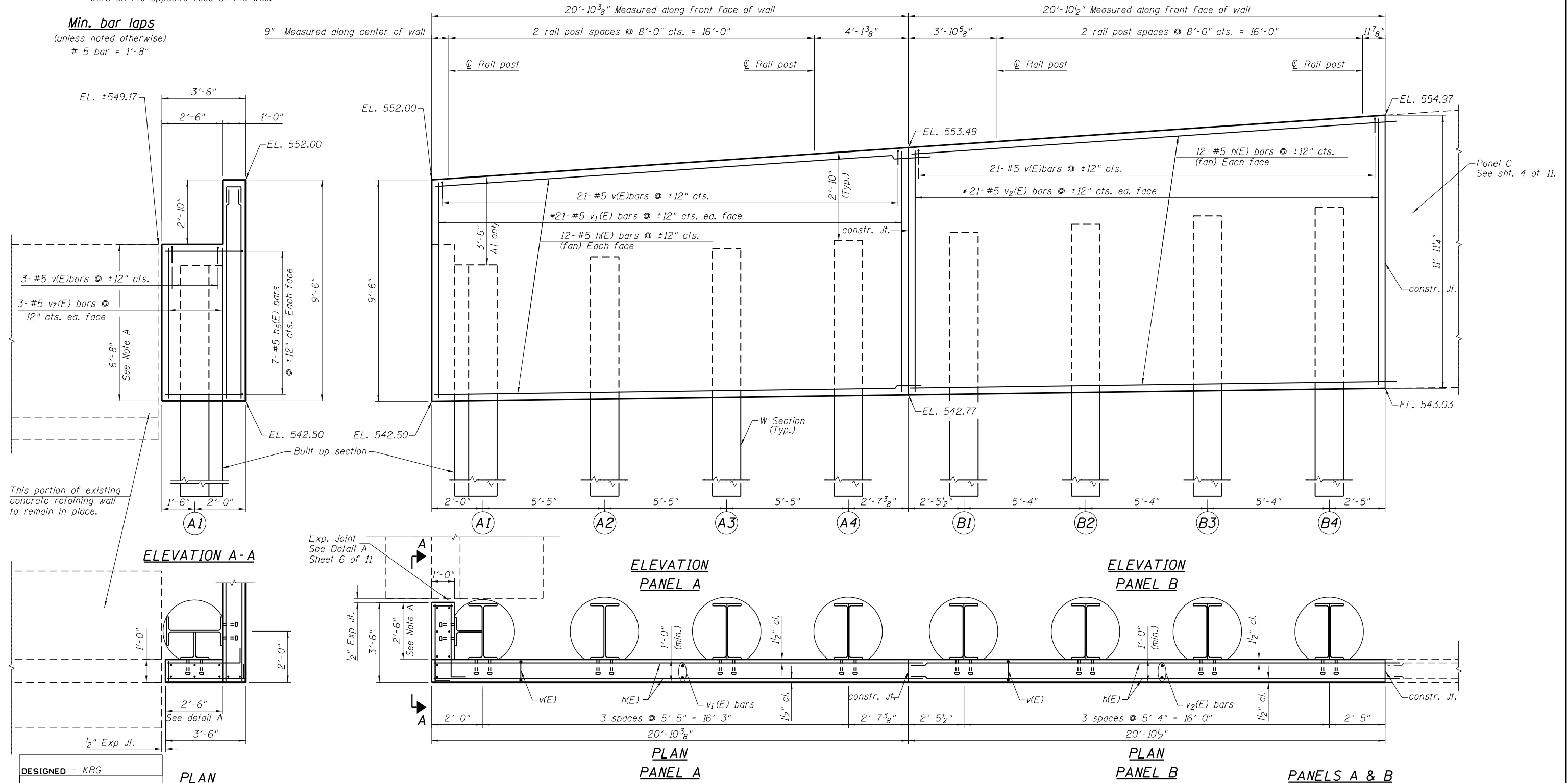

DESIGNED - KRG
CHECKED - MJK
DRAWN - GSJ
CHECKED - MJK

NOTE A : This portion of wall to be built to same height as the existing conc. Retaining wall as existed before partial removal.

MID-AMERICA ENGINEERING SERVICES

SHEET NO. 3 11 SHEETS	F.A.P. RTE.	SECTION	COUNTY	TOTAL SHEETS	SHEET NO.
	600	60-(30,31,128)-3	Madison	529	521
Structure No. 060-W007			CONTRACT NO. 76B85		
FED. ROAD DIST. NO.		ILLINOIS FED. AID PROJECT			