

NOTES

1. LOCATIONS OF MESSAGE BOARDS IN ILLINOIS TO BE COORDINATED WITH THE RESIDENT ENGINEER.
2. LOCATION OF MESSAGE BOARD IN MISSOURI TO BE COORDINATED WITH THE RESIDENT ENGINEER AND APPROVED BY THE MISSOURI DEPARTMENT OF TRANSPORTATION.
3. MESSAGE BOARDS SHALL BE ERECTED 2 WEEKS PRIOR TO CONSTRUCTION.

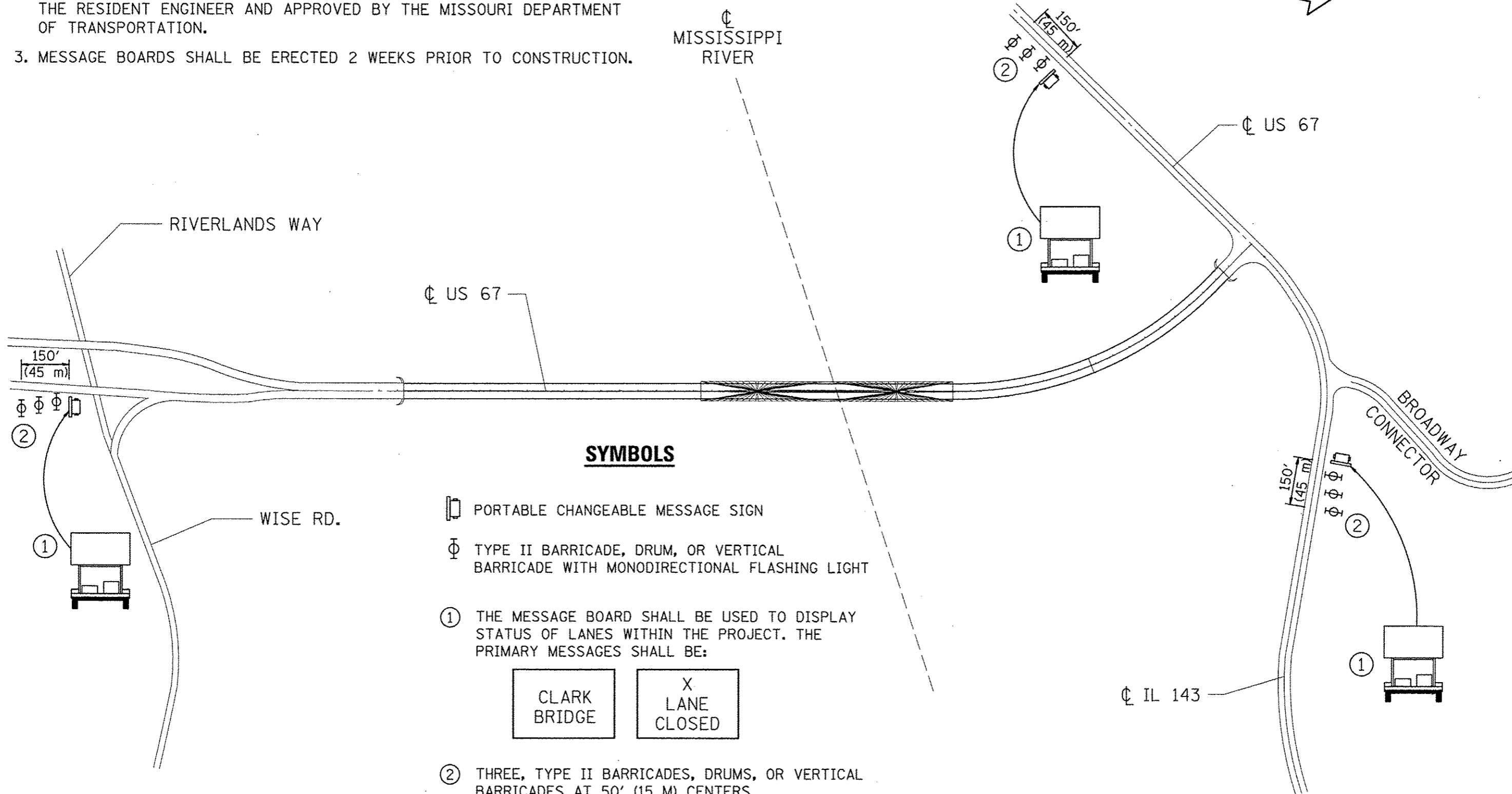
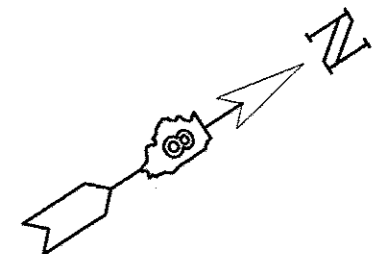

SYMBOLS

- PORTABLE CHANGEABLE MESSAGE SIGN
- TYPE II BARRICADE, DRUM, OR VERTICAL BARRICADE WITH MONODIRECTIONAL FLASHING LIGHT

- ① THE MESSAGE BOARD SHALL BE USED TO DISPLAY STATUS OF LANES WITHIN THE PROJECT. THE PRIMARY MESSAGES SHALL BE:

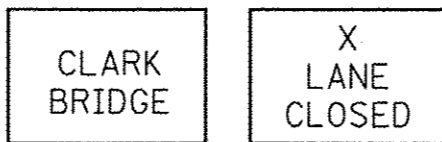

- ② THREE, TYPE II BARRICADES, DRUMS, OR VERTICAL BARRICADES AT 50' (15 M) CENTERS.

FILE NAME : #FILE#	USER NAME : #USER#	DESIGNED - DRAWN -	REVISED - REVISED -	STATE OF ILLINOIS DEPARTMENT OF TRANSPORTATION	TRAFFIC CONTROL AND PROTECTION, SPECIAL	F.A. RTE.	SECTION	COUNTY	TOTAL SHEETS	SHEET NO.
PLOT SCALE : #SCALE#	CHECKED -	REVISED -	100B-1DS-1			58	10A			
PLOT DATE : #DATE#	DATE -	REVISED -	CONTRACT NO. 76E73							
					SCALE:	SHEET NO. 1 OF 1 SHEETS		STA.	TO STA.	
					FED. ROAD DIST. NO.		ILLINOIS FED. AID PROJECT			