

**EXISTING STRUCTURE:**

22-Spans (4 Units) Superstructure w/ 4 lane divided conc. deck, on steel girders. 4620' bk.-bk. w/ 40' clear between parapet curbs. Missouri Approach: 8 span reinf. conc. deck on steel girders on deep water pile supported piers End to End = 1605'. Main Spans: 3 span Cable Stay supported conc. deck on steel girders on pile supported conc. Pylons End to End = 1360'. Illinois Approach: 11 spans 2 units reinf conc deck on steel girders on pile supported piers End to End = 1655'. Str. No. 060-0255

Traffic shall be maintained on structure according to Maintenance of Traffic Plans.

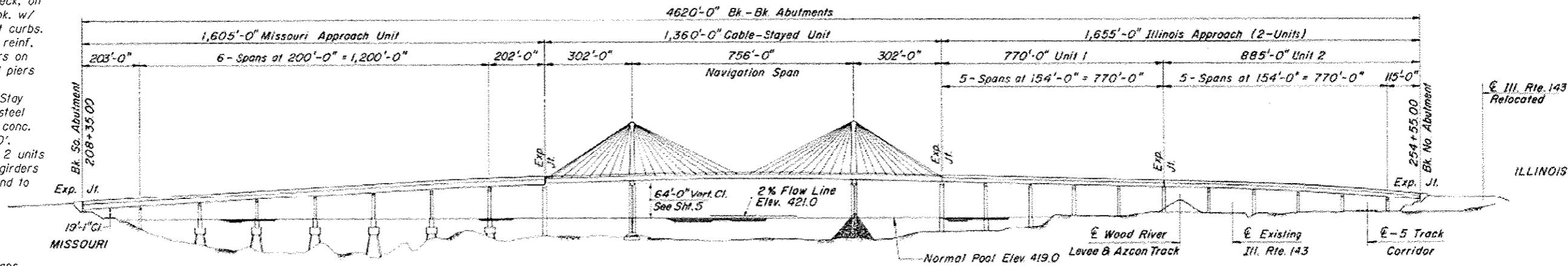

Note:  
Utilizing U.S. Route 67 North as Plan North and C of Roadway, all references to North, South, East or West are from this designated North. Any references to Left or Right are from C U.S. Route 67.

**ELEVATION**  
(From Existing Plans)

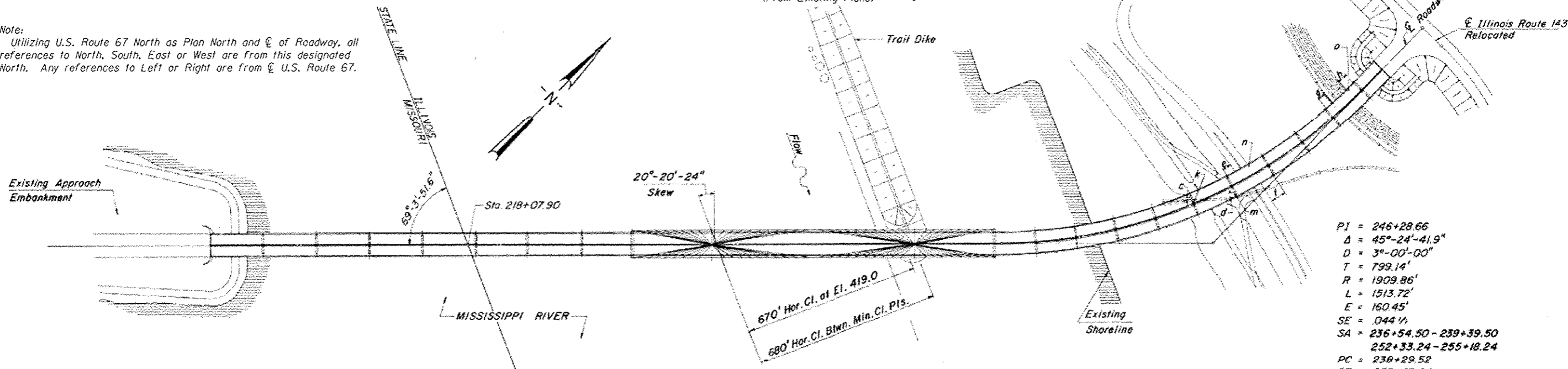

PI = 246+28.66  
 Δ = 45°-24'-41.9"  
 D = 3°-00'-00"  
 T = 799.14'  
 R = 1909.86'  
 L = 1513.72'  
 E = 160.45'  
 SE = .044 1/4  
 SA = 236+54.50 - 239+39.50  
 252+33.24 - 255+18.24  
 PC = 238+29.52  
 PT = 253+43.24

**PLAN**  
(From Existing Plans)

**DESIGN STRESSES**  
FIELD UNITS (New Const.)

f'c = 3,500 psi  
 fy = 36,000 psi (AASHTO M270 Grade 36)

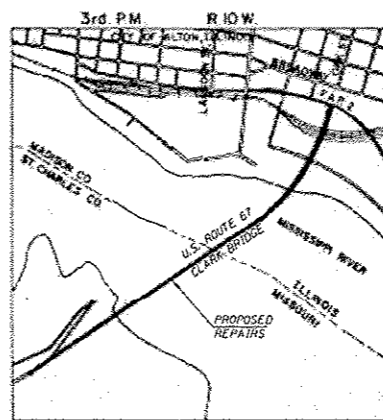

**LOCATION MAP**



Michael N. Mendenhall  
 SIGNATURE  
 01-09-2013  
 DATE  
 LIC. EXP. DATE: 11-30-2014

**GENERAL PLAN & ELEVATION**  
**U.S.ROUTE 67 (F.A.P. 304) over MISSISSIPPI RIVER**  
**SECTION 100B-IDS-1**  
**MADISON COUNTY, ILLINOIS**  
**STATION 231+45.00**  
**STRUCTURE NO. 060-0255**

DESIGNED	EXAMINED	DATE	STATE OF ILLINOIS DEPARTMENT OF TRANSPORTATION	GENERAL PLAN & ELEVATION STRUCTURE NO. 060-0255 SHEET NO. 01 OF 48 SHEETS	F.A.P. RTE. 304	SECTION 100B-IDS-1	COUNTY MADISON	TOTAL SHEETS 58	SHEET NO. 11				
CHECKED	ENGINEER OF STRUCTURAL SERVICES												
DRAWN Rod	PASSED												
CHECKED MNM	ENGINEER OF BRIDGES AND STRUCTURES												
								CONTRACT NO. 76E73					
								ILLINOIS FED. AID PROJECT					



© Copyright Hanson Professional Services Inc. 2013

01-09-2013 01:09:2013 4:32:22 PM  
 S:\Projects\060-0255\060-0255-IDS-1\060-0255-IDS-1-Plan & Elevation.dwg