

FAI RTE.	SECTION	COUNTY	TOTAL SHEETS	SHEET NO.
270	60-5RS-4	MADISON	5	1
		ILLINOIS	CONTRACT NO. 76G03	

INDEX OF SHEETS

1. COVER SHEET
2. GENERAL NOTES
3. SUMMARY OF QUANTITIES
4. TYPICAL SECTION
5. PLAN SHEET

05-24-13 SPECIAL LETTING ITEM 051

STATE OF ILLINOIS

DEPARTMENT OF TRANSPORTATION
DIVISION OF HIGHWAYS

PROPOSED HIGHWAY PLANS

FAI ROUTE 270 (I-270)
SECTION 60-5RS-4

HDF - ROADWAY AND SHOULDER REPAIR
MADISON COUNTY

C-98-095-12

HIGHWAY STANDARDS

- 000001-06
- 642001-02
- 701101-03
- 701400-06
- 701401-07
- 701406-06
- 701901-02
- 780001-03

COMMITMENTS

NONE

FAI 270 ADT

2011 ADT - 21,400 (ACTUAL)
2013 ADT - 21,800 (ESTIMATED)
SU = 2.6% MU = 22.0%

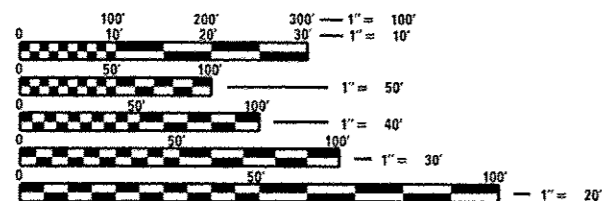

FULL SIZE PLANS HAVE BEEN PREPARED USING STANDARD ENGINEERING SCALES. REDUCED SIZED PLANS WILL NOT CONFORM TO STANDARD SCALES. IN MAKING MEASUREMENTS ON REDUCED PLANS, THE ABOVE SCALES MAY BE USED.

J.U.L.I.E.
JOINT UTILITY LOCATION INFORMATION FOR EXCAVATION
1-800-892-0123
OR 811

PROJECT ENGINEER: TIM PADGETT, (618) 346-3325
PROJECT MANAGER: PHIL COPPERNOLL, (618) 346-3208

CONTRACT NO. 76G03

BEGIN PROJECT STA. 660+85.44 END PROJECT STA. 661+41.44

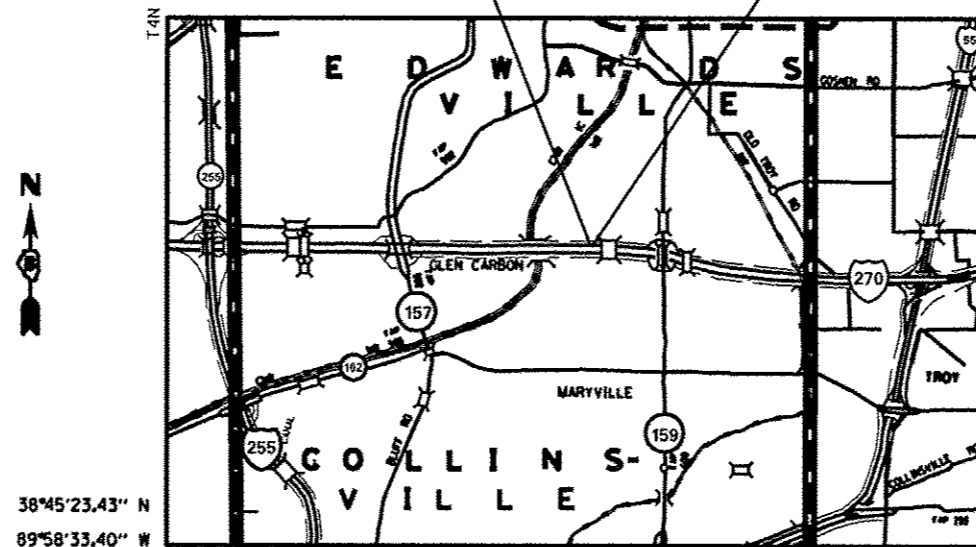

38°45'23.43" N
89°58'33.40" W

GROSS LENGTH = 56.0 FT. = 0.011 MILE
NET LENGTH = 56.0 FT. = 0.011 MILE

D-98-086-12

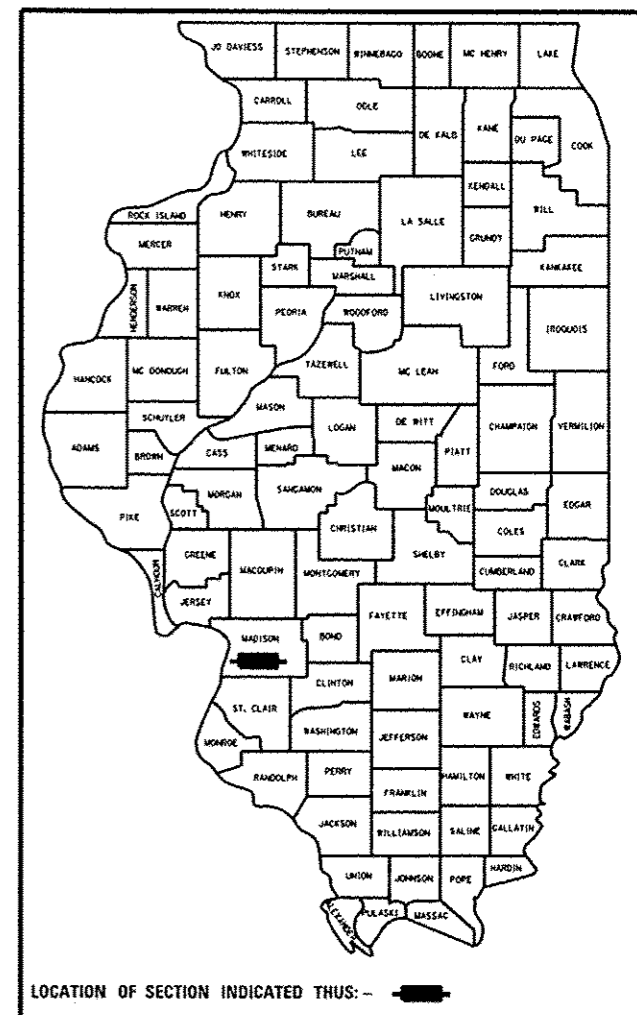

LOCATION OF SECTION INDICATED THUS: - [black rectangle]

STATE OF ILLINOIS
DEPARTMENT OF TRANSPORTATION
DIVISION OF HIGHWAYS

SUBMITTED March 29 2013
Jeffrey L. Keirn
DEPUTY DIRECTOR OF HIGHWAYS, REGION ENGINEER

April 26 2013
John D. Baranzelli, PE, LE
ENGINEER OF DESIGN AND ENVIRONMENT

April 26 2013
Emor Osham, PE/LE
DIRECTOR OF HIGHWAYS, CHIEF ENGINEER

PRINTED BY THE AUTHORITY
OF THE STATE OF ILLINOIS

GENERAL NOTES

1. THE CONTRACTOR SHALL VERIFY ALL DIMENSIONS AND CONDITIONS IN THE FIELD PRIOR TO CONSTRUCTION AND ORDERING MATERIALS.
2. THE CONTRACTOR AND ENGINEER SHALL BE AWARE THAT NO SURVEY WAS PERFORMED FOR THIS PROJECT. THE STATIONING AND TOPO SHOWN IN THE PLANS WAS CREATED USING MICROFILM AND FIELD MEASUREMENTS MADE BY DESIGN PERSONNEL. BOTH SHALL BE ASSUMED TO BE APPROXIMATE.
3. THE THICKNESS OF THE HMA MIXTURE SHOWN ON THE PLANS IS THE NOMINAL THICKNESS. DEVIATIONS FROM THE NOMINAL THICKNESS WILL BE PERMITTED WHEN SUCH DEVIATIONS OCCUR DUE TO IRREGULARITIES IN THE EXISTING SURFACE OR BASE ON WHICH THE HMA MIXTURE IS PLACED.
4. THE PAVEMENT MARKING SHOWN IS APPROXIMATE. THE LOCATION OF THE PROPOSED PAVEMENT MARKINGS SHALL MATCH EXISTING FIELD CONDITIONS.
5. THE FOLLOWING MIXTURE REQUIREMENTS ARE APPLICABLE FOR THIS CONTRACT:

ROUTE	F.A.I. 270
SECTION	60-SRS-4
COUNTY	MADISON
CONTRACT	76G03

ADT (CONSTRUCTION YR)	21800
MUZ	22
SYZ	2.6
20 YR. ESAL'S:	28.92

MIXTURE USE	POLY SURFACE	SHOULDERS $\geq 2 \frac{1}{4}$ "
AC/PG	SBS PG 76-22	PG 64-22
RAP % (MAX)	SEE SPEC.	SEE CONTRACT RAP
DESIGN AIR VOIDS	4.0% @ Ndes=90	SPECIAL PROVISION
MIX COMPOSITION		**2.0% @ Ndes=30
(GRADATION MIXTURE)	IL 12.5/9.5	NMAS $\frac{1}{2}$ "
FRICTION AGG	MIXTURE "E"	

**TOP LIFT SHOULDERS - DESIGN THIS MIX AT 2.0% VOIDS AND ADD ASPHALT TO REDUCE VOIDS TO 1.5%.
 PLAN QUANTITIES FOR BITUMINOUS CONCRETE SURFACE COURSE ITEMS ARE CALCULATED USING A UNIT WEIGHT OF 112 LB/SQ YD/IN (59.8 KG/SQ M/25 MM THICKNESS).

6. ILLINOIS STATE LAW REQUIRES A 48-HOUR NOTICE TO BE GIVEN TO UTILITIES BEFORE DIGGING. FIELD MARKING OF FACILITIES MAY BE OBTAINED BY CONTACTING J.U.L.I.E. OR FOR NON-MEMBERS, THE UTILITY COMPANY DIRECTLY. AGENCIES KNOWN TO HAVE FACILITIES WITHIN THE PROJECT AREA ARE AS FOLLOWS:

UTILITY	ABOVE GROUND	BELOW GROUND
• AMEREN ILLINOIS - GAS AND ELECTRIC	X	X
• AT&T ILLINOIS - COMMUNICATIONS	X	X
• CONSOLIDATED COMMUNICATIONS - COMMUNICATIONS	X	X
• VILLAGE OF GLEN CARBON - WATER & SANITARY SEWER		X
• LEVEL 3 COMMUNICATIONS, LLC - COMMUNICATIONS		X
• CHARTER COMMUNICATIONS, LLC - CABLE TV	X	X
• CENTERPOINT ENERGY - PIPELINE		X

MEMBERS OF J.U.L.I.E. CAN CALL TOLL FREE (800)-892-0123 OR 811 AND ARE INDICATED BY "**". NON-MEMBERS MUST BE NOTIFIED INDIVIDUALLY.

7. THE DEPARTMENT STRONGLY ENCOURAGES THE PRIME CONTRACTOR AND THEIR APPROVED SUB-CONTRACTORS TO HIRE MINORITY, WOMEN AND DISADVANTAGED INDIVIDUALS FROM ITS FEDERALLY FUNDED HIGHWAY CONSTRUCTION CAREERS TRAINING PROGRAM (HCCTP) TO HELP MEET WORKFORCE AND TRAINEE GOALS. THIS PROGRAM IS TRAINING MINORITIES, WOMEN AND DISADVANTAGED INDIVIDUALS IN HIGHWAY CONSTRUCTION-RELATED SKILLS, E.G., MATH FOR THE TRADES, JOB READINESS, TECHNICAL SKILLS COURSEWORK (CARPENTRY, CONCRETE FLATWORK, BLUEPRINT READING, SITE PLANS, SITE WORK, TOOLS USE, ETC.) AND OSHA 10 HOUR CERTIFICATION, TO PREPARE THEM FOR A CAREER IN THE HIGHWAY CONSTRUCTION TRADES. GRADUATES ARE WELL-TRAINED AND READY TO BECOME PRODUCTIVE ENTRY-LEVEL CONSTRUCTION WORKERS. CONTACT THE DISTRICT 8 EEO OFFICE AT 618-346-3360 AND/OR THE HCCTP COORDINATOR AT 618-847-6528 TO LEARN MORE ABOUT THE PROGRAM AND FOR ASSISTANCE IN MEETING WORKFORCE AND TRAINEE GOALS.
8. NO OVERNIGHT LANE CLOSURES WILL BE ALLOWED.
9. THE SHOULDER, LANE, PAVEMENT MARKING, AND RUMBLE STRIP WORK INCLUDED IN THIS CONTRACT SHALL BE COMPLETED PRIOR TO THE MICROSURFACING OVERLAY WORK ASSOCIATED WITH CONTRACT 76F86 AT THIS LOCATION.
10. REMOVAL OF THE TEMPORARY PAVEMENT MARKING AND PLACEMENT OF THE PERMANENT PAVEMENT MARKING AT THIS LOCATION WILL BE INCLUDED WITH CONTRACT 76F86.
11. ALL TEMPORARY PAVEMENT MARKINGS WILL BE PLACED IN SUCH A MANNER SO AS NOT TO INTERFERE WITH THE PLACEMENT OF PERMANENT PAVEMENT MARKINGS.

COMMITMENTS: NONE

FILE NAME =	USER NAME = coppernolpe	DESIGNED -	REVISED -	STATE OF ILLINOIS DEPARTMENT OF TRANSPORTATION	GENERAL NOTES			F.A.I. RTE.	SECTION	COUNTY	TOTAL SHEETS	SHEET NO.
c:\pwork\pvidot\coppernolpe\td0311321	6076g03-shs-plan.dgn	DRAWN -	REVISED -		270	60-SRS-4	MADISON	5	2			
	PLOT SCALE = 1/8"=1'-0"	CHECKED -	REVISED -		CONTRACT NO. 76G03			FED. ROAD DIST. NO. ILLINOIS FED. AID PROJECT				
	PLOT DATE = 3/29/2013	DATE -	REVISED -		SCALE:	SHEET NO. 1 OF 1 SHEETS	STA.	TO STA.				

CODE NO.	ITEM	UNIT	TOTAL QUANTITY	URBAN	
				CONSTR. CODE	100% STATE MCHD ROADWAY 0005 URBAN
21400100	GRADING AND SHAPING DITCHES	FOOT	56		56
40600200	BITUMINOUS MATERIALS (PRIME COAT)	TON	0.1		0.1
40600300	AGGREGATE (PRIME COAT)	TON	0.1		0.1
40603570	POLYMERIZED HOT-MIX ASPHALT SURFACE COURSE, MIX "E", N90	TON	2		2
44000159	HOT-MIX ASPHALT SURFACE REMOVAL, 2 1/2"	SQ YD	45		45
48203100	HOT-MIX ASPHALT SHOULDERS	TON	4		4
64200116	SHOULDER RUMBLE STRIPS, 16 INCH	FOOT	28		28
67100100	MOBILIZATION	L SUM	1		1
70100700	TRAFFIC CONTROL AND PROTECTION, STANDARD 701406	L SUM	1		1
70100800	TRAFFIC CONTROL AND PROTECTION, STANDARD 701401	L SUM	1		1

FILE NAME *	USER NAME * copperrillpe	DESIGNED -	REVISED -	STATE OF ILLINOIS DEPARTMENT OF TRANSPORTATION	SUMMARY OF QUANTITIES				F.A.I. RTE.	SECTION	COUNTY	TOTAL SHEETS	SHEET NO.
c:\pvc_work\pvidot\copperillpe\0311321\076g03-shr-plan.dgn	DRAWN -	REVISED -	REVISED -						270	60-SRS-4	MADISON	9	3
PLOT SCALE * 1/8"=1'-0"	CHECKED -	REVISED -	REVISED -		SCALE:		SHEET NO. 1 OF 1 SHEETS		STA.	TO STA.	FED. ROAD DIST. NO. ILLINOIS FED. AID PROJECT		
PLOT DATE * 3/29/2013	DATE -	REVISED -	REVISED -		CONTRACT NO. 76G03								

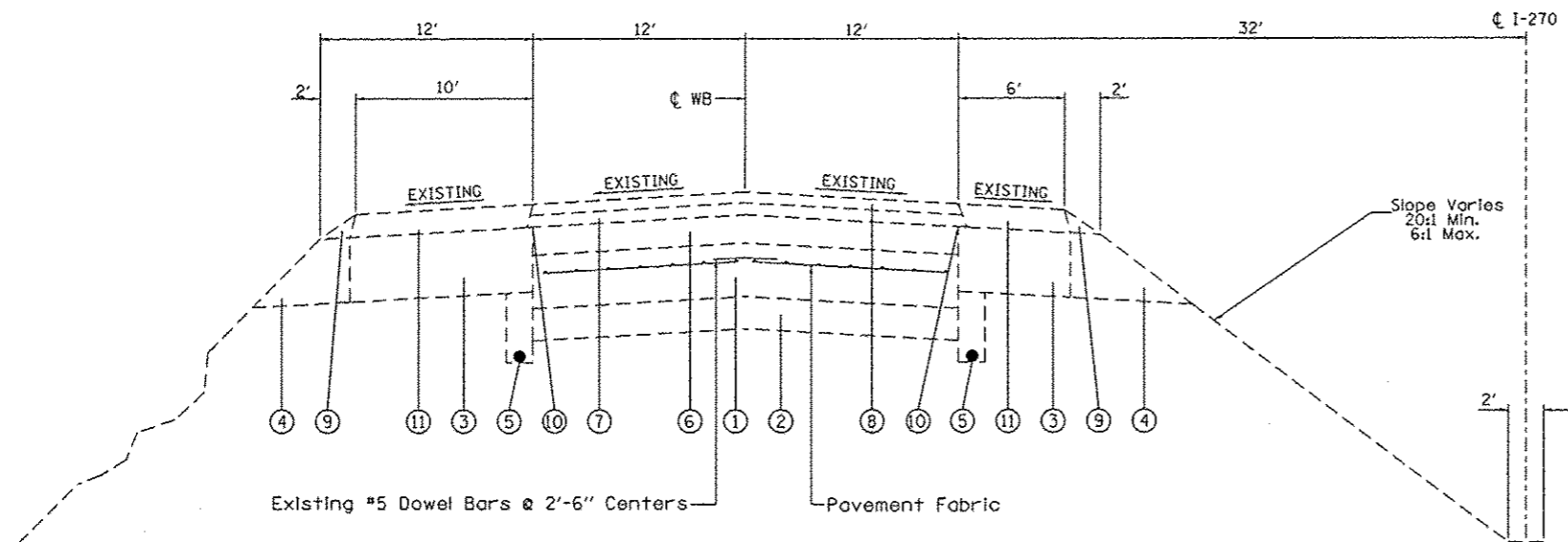

EXISTING TYPICAL SECTION
 MAINLINE FAI RTE. 270 WB
 MCHDF REPAIR
 STATION 660+85.44 TO STATION 661+41.44 WB

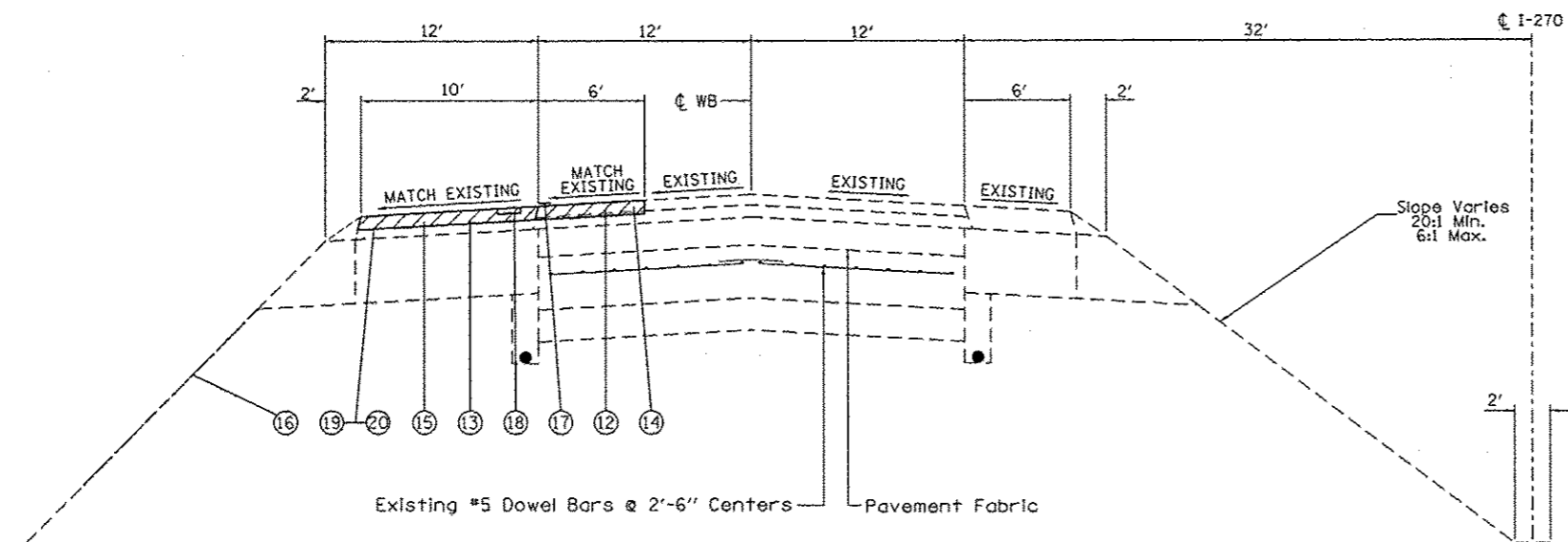

PROPOSED TYPICAL SECTION
 MAINLINE FAI RTE. 270 WB
 MCHDF REPAIR
 STATION 660+85.44 TO STATION 661+41.44 WB

LEGEND

- ① EXISTING PAVEMENT (10" JOINTED PCC)
- ② EXISTING 6" GRANULAR SUB-BASE
- ③ EXISTING BITUMINOUS SHOULDERS (INSIDE DEPTH 7"-15", OUTSIDE 14" - 17 1/4")
- ④ EXISTING AGGREGATE SHOULDERS, TYPE B
- ⑤ EXISTING PIPE UNDERDRAIN
- ⑥ EXISTING RESURFACING (3 5/8" - 5 1/4")
- ⑦ EXISTING BITUMINOUS CONCRETE BINDER COURSE, SUPERPAVE, IL-19.0 N105 2 1/4"
- ⑧ EXISTING POLYMERIZED BITUMINOUS CONCRETE SURFACE COURSE, STONE MATRIX ASPHALT, SUPERPAVE 2"
- ⑨ EXISTING AGGREGATE SHOULDERS, TYPE B
- ⑩ EXISTING STRIP REFLECTIVE CRACK CONTROL
- ⑪ EXISTING BITUMINOUS SHOULDER, SUPERPAVE
- ⑫ PROPOSED HOT-MIX ASPHALT SURFACE REMOVAL, 2 1/2" (INCLUDES REMOVAL OF 2" OF SURFACE COURSE AND 1/2" OF BINDER COURSE)
- ⑬ PROPOSED HOT-MIX ASPHALT SURFACE REMOVAL, 2 1/2" (2 1/2" OF BITUMINOUS SHOULDER REMOVAL)
- ⑭ PROPOSED POLYMERIZED HOT-MIX ASPHALT SURFACE COURSE, 2 1/2"
- ⑮ PROPOSED HOT-MIX ASPHALT SHOULDERS, 2 1/2"
- ⑯ PROPOSED GRADING AND SHAPING DITCHES
- ⑰ SHORT TERM PAVEMENT MARKING
- ⑱ PROPOSED RUMBLE STRIP, 16"
- ⑲ PROPOSED BITUMINOUS MATERIALS (PRIME COAT)
- ⑳ PROPOSED AGGREGATE (PRIME COAT)

FILE NAME =	USER NAME = copperrnolpe	DESIGNED -	REVISED -
c:\pwork\pwork\copperrnolpe\0311321\07803.sht-plan.dgn		DRAWN -	REVISED -
		CHECKED -	REVISED -
		DATE -	REVISED -

STATE OF ILLINOIS
 DEPARTMENT OF TRANSPORTATION

TYPICAL SECTIONS

SCALE: SHEET NO. 1 OF 1 SHEETS STA. TO STA.

F.A.I. RTE.	SECTION	COUNTY	TOTAL SHEETS	SHEET NO.
270	60-SRS-4	MADISON	5	4
FED. ROAD DIST. NO. ILLINOIS FED. AID PROJECT			CONTRACT NO. 76G03	

• 0.02 ACRES OF PROPOSED SEEDING, CLASS 2, 0.02 ACRES OF PROPOSED MULCH, METHOD 2, 1.5 LB OF PROPOSED NITROGEN FERTILIZER NUTRIENT, 1.5 LB OF PROPOSED PHOSPHORUS FERTILIZER NUTRIENT, AND 1.5 LB OF PROPOSED POTASSIUM FERTILIZER NUTRIENT ARE INCLUDED IN THE COST OF SHAPING AND GRADING DITCHES. SEEDING, CLASS 2, NITROGEN FERTILIZER NUTRIENT, PHOSPHORUS FERTILIZER NUTRIENT, AND POTASSIUM FERTILIZER NUTRIENT SHALL BE ACCORDING TO SECTION 250 OF THE STANDARD SPECIFICATIONS. MULCH, METHOD 2 SHALL BE ACCORDING TO SECTION 251 OF THE STANDARD SPECIFICATIONS.

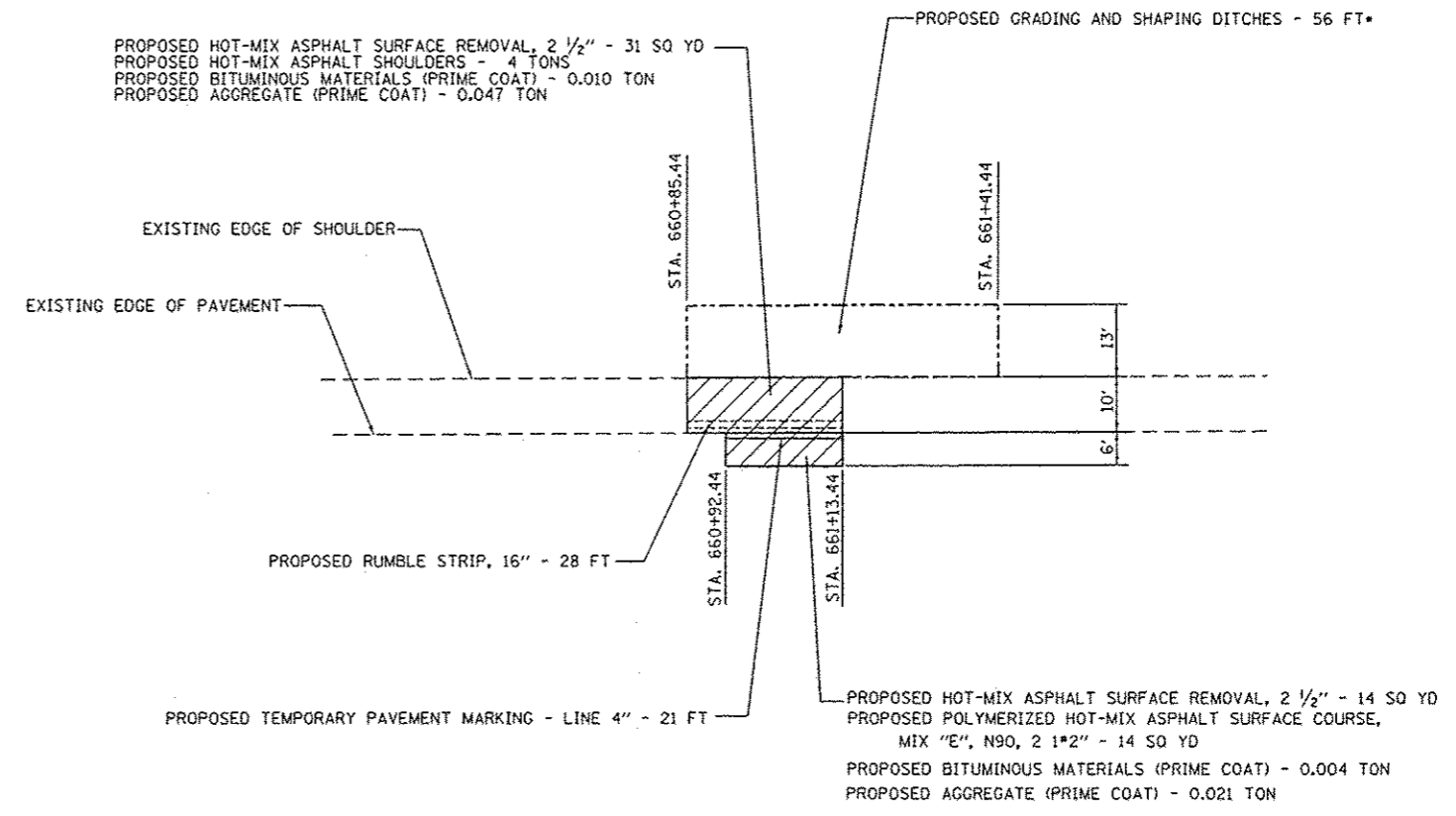

DETAIL "A"
(NOT TO SCALE)

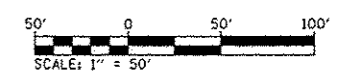
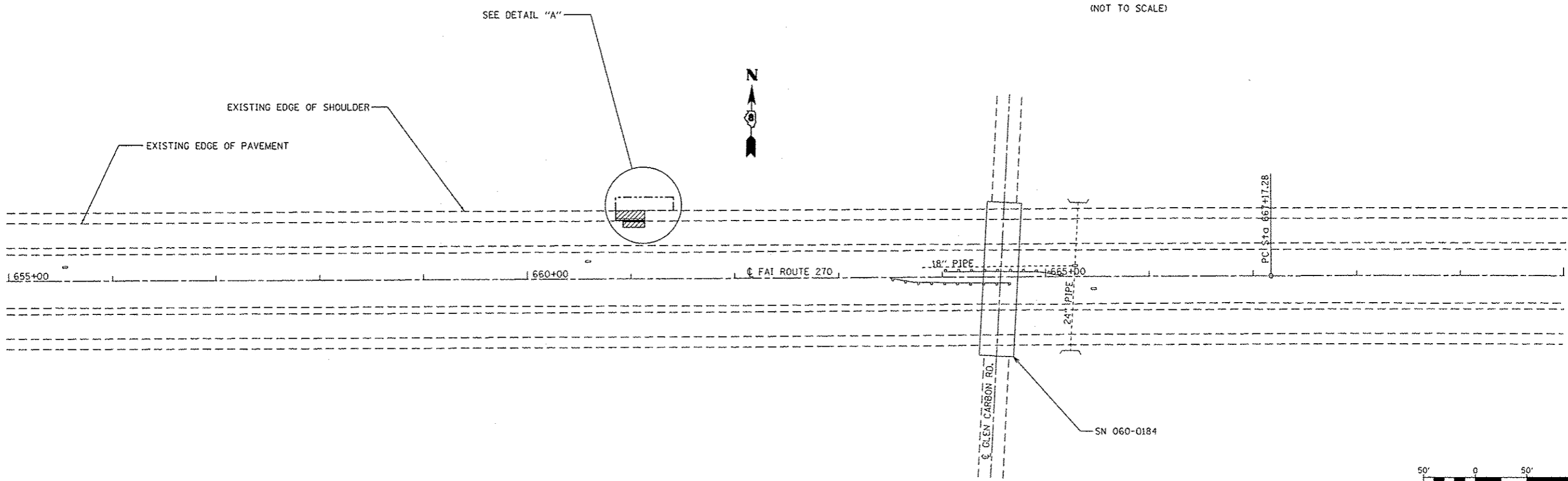

FILE NAME =	USER NAME = copperrillpe	DESIGNED -	REVISED -	STATE OF ILLINOIS DEPARTMENT OF TRANSPORTATION	PLAN	F.A.I. RTE.	SECTION	COUNTY	TOTAL SHEETS	SHEET NO.
cr:\pw\work\p\ridot\copperrillpe\d0311321\876g03-ahs-plan.dgn	DRAWN -	REVISED -	270			60-SRS-4	MADISON	5	5	
#MODELNAME#	PLOT SCALE = 100.0000 ' / in.	CHECKED -	REVISED -			CONTRACT NO. 76G03		ILLINOIS FED. AID PROJECT		
	PLOT DATE = 3/29/2013	DATE -	REVISED -			SCALE: 1" = 50'	SHEET 1 OF 1 SHEETS	STA. 655+00 TO STA. 670+00		