

STATE OF ILLINOIS  
DEPARTMENT OF TRANSPORTATION  
DIVISION OF HIGHWAYS

**PROPOSED  
HIGHWAY PLANS**

FAP ROUTE 329 (IL 154)  
SECTION (19,18,17,103)RS-4  
PROJECT F-0329(014)  
RESURFACING & PATCHING  
PERRY COUNTY

C-99-021-13

F.A.P. RTE.	SECTION	COUNTY	TOTAL SHEETS	SHEET NO.
329	(19,18,17,103)RS-4	PERRY	34	1
		ILLINOIS	CONTRACT NO. 78351	

D-99-019-13

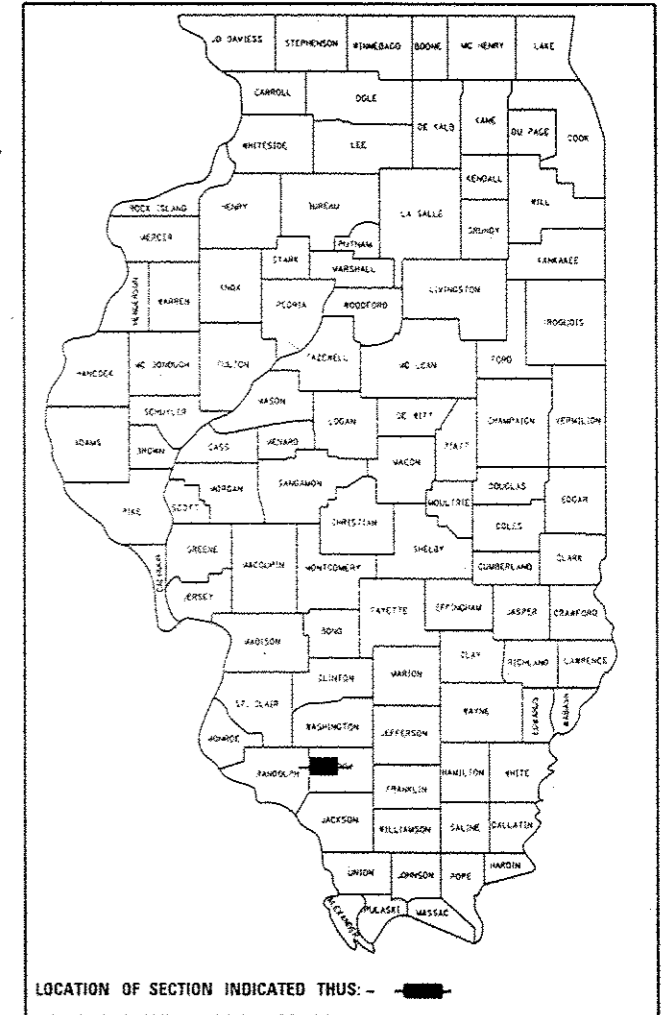

FOR INDEX OF SHEETS, SEE SHEET NO. 3

ADT 2200 (2013)  
PV = 1770  
MU = 300  
SU = 130  
TRUCKS = 19.5%

EQUATION STATIONS

EQ. STA. 351+08.2 (BK.) = STA. 349+00 (AH.)  
EQ. STA. 609+17.2 (BK.) = STA. 608+76.2 (AH.)  
EQ. STA. 747+58.7 (BK.) = STA. 165+21 (AH.)  
EQ. STA. 22+04.5 (BK.) = STA. 1343+13.9 (BK.)  
STATIONING IS DECREASING FROM THIS POINT  
EQ. STA. 1340+76.5 (BK.) = STA. 1340+71.7 (AH.)  
EQ. STA. 1317+95.9 (BK.) = STA. 1317+74.2 (AH.)

PROP. PROJECT BEGINS  
FAP 329 (IL. 154)  
STA. 345+54

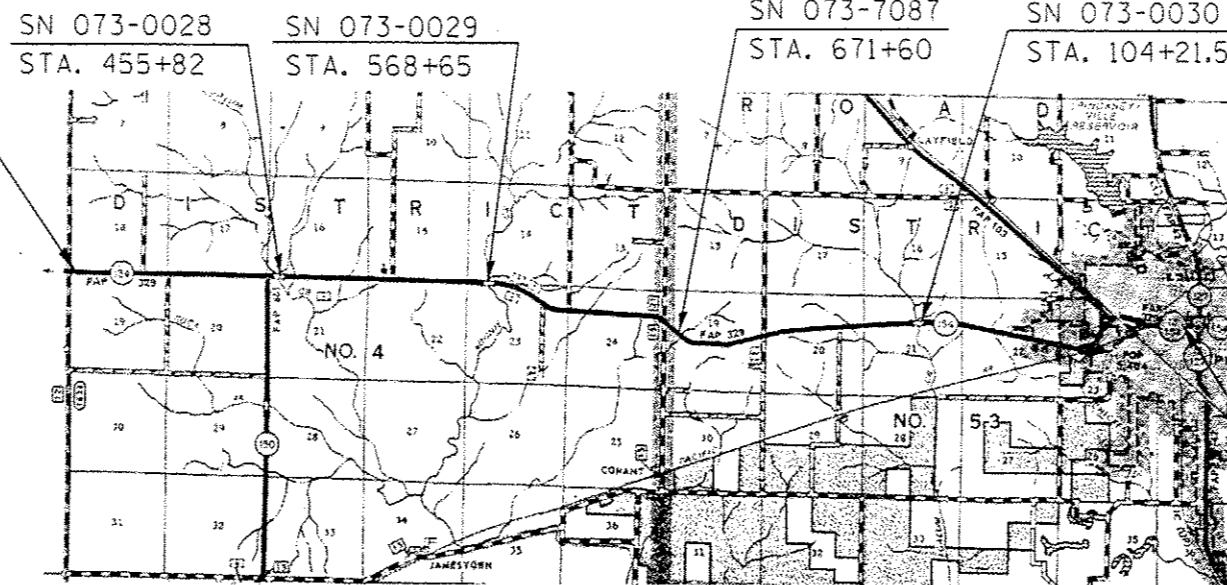

TOWNSHIPS:  
PERCY & PINCKNEYVILLE

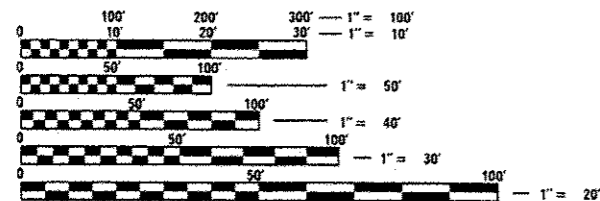

FULL SIZE PLANS HAVE BEEN PREPARED USING STANDARD ENGINEERING SCALES. REDUCED SIZED PLANS WILL NOT CONFORM TO STANDARD SCALES. IN MAKING MEASUREMENTS ON REDUCED PLANS, THE ABOVE SCALES MAY BE USED.

J.U.L.I.E.  
JOINT UTILITY LOCATION INFORMATION FOR EXCAVATION  
1-800-892-0123  
OR 811

PROJECT ENGINEER: CHARLES STEIN (618)351-5210  
PROJECT MANAGER: KATHI MCCORD (618)351-5319

CONTRACT NO. 78351

GROSS LENGTH = 61,727.8 FT. = 11.7 MILE  
NET LENGTH = 62,207.8 FT. = 11.8 MILE

PROP. PROJECT ENDS  
FAP 329 (IL. 154)  
STA. 1268+16

STATE OF ILLINOIS  
DEPARTMENT OF TRANSPORTATION  
DIVISION OF HIGHWAYS

SUBMITTED March 21, 2013  
Jeffrey Z. Keim  
DEPUTY DIRECTOR OF HIGHWAYS, REGION ENGINEER

April 26, 2013  
John D. Baranzoni, P.E.  
ENGINEER OF DESIGN AND ENVIRONMENT

April 26, 2013  
Omer Osman, P.E.  
DIRECTOR OF HIGHWAYS, CHIEF ENGINEER

PRINTED BY THE AUTHORITY  
OF THE STATE OF ILLINOIS