



SN 073-7046  
 STA. 488+99  
 6' X 11' BOX  
 USE STD. 630101

**NOTES**

NOTE 1: THE CONTRACTOR SHALL AVOID, TO THE GREATEST EXTENT POSSIBLE, ATTACHING NEW GUARDRAIL POSTS TO ANY HEADWALL AREA THAT IS NOT SOUND OR THAT HAS BEEN REPAIRED BY "STRUCTURAL REPAIR OF CONCRETE".

NOTE 2: THE BACK OF THE EXISTING HEADWALL IS 3' FROM THE EDGE OF PAVEMENT ON ALL LOCATIONS, EXCEPT WHERE NOTED.

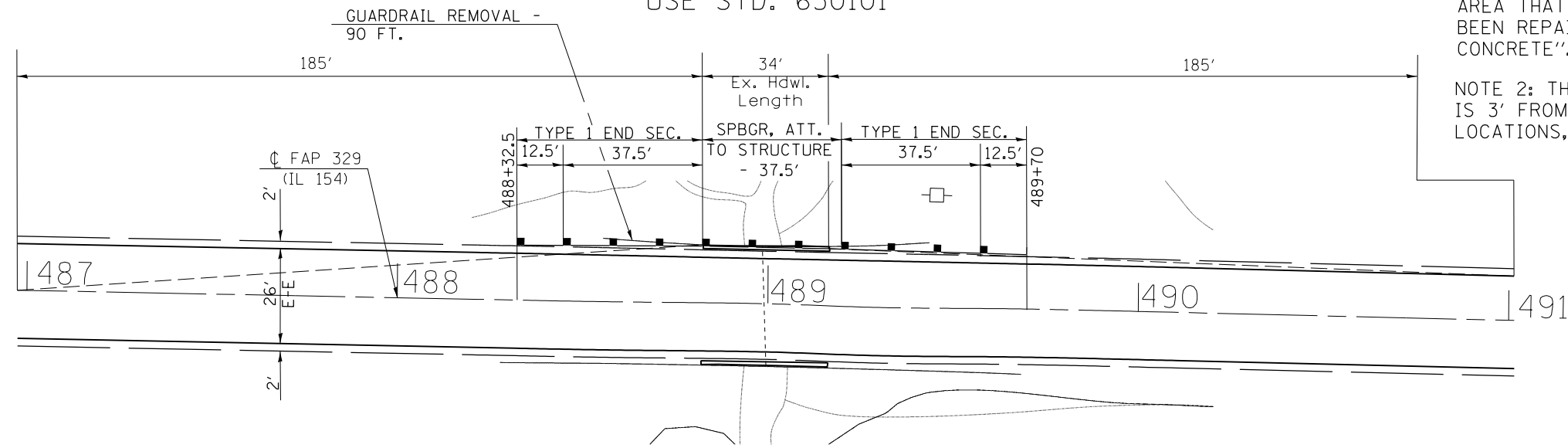

SN 073-7048  
 STA. 530+87  
 6.5' X 10' BOX  
 USE STD. 630101

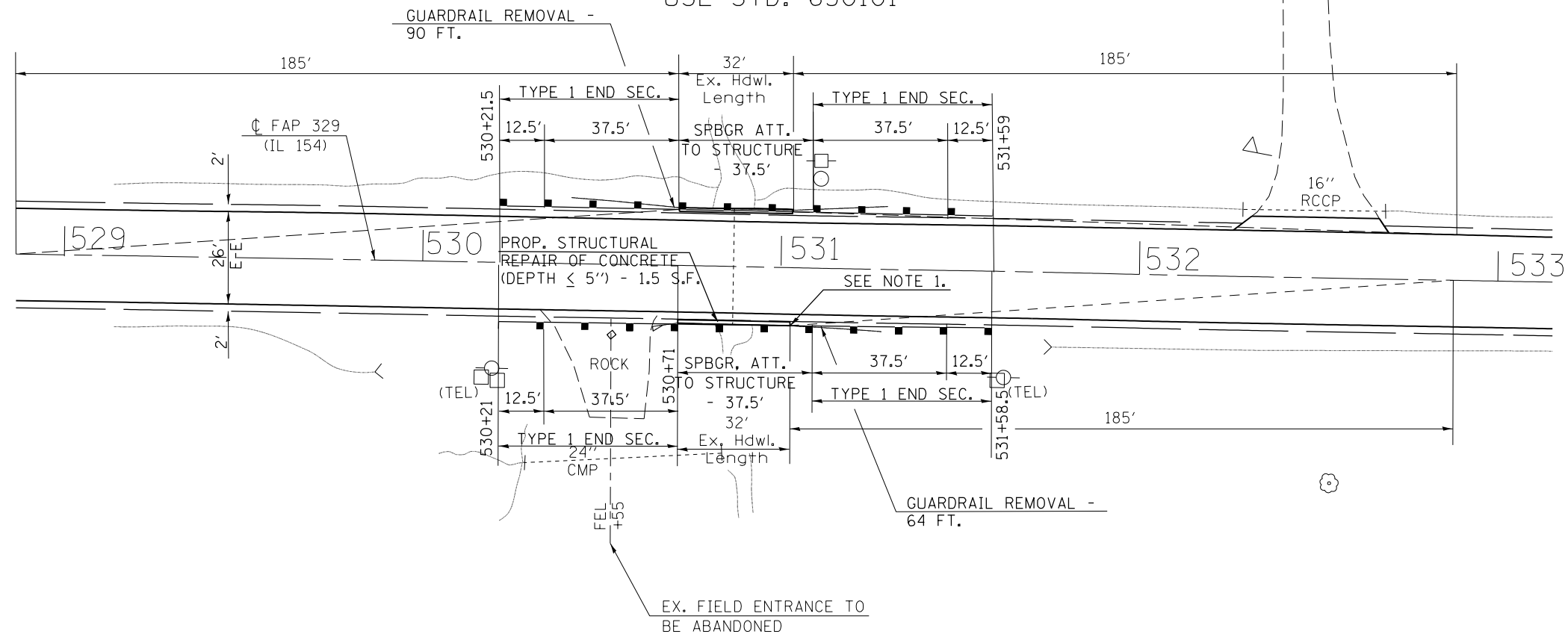

FILE NAME =	USER NAME = \$USER\$	DESIGNED -	REVISED -
ct:\pw\work\p1dot\mccordkr\ad033289\178351-sht-plan.dgn		DRAWN -	REVISED -
	PLOT SCALE = 40.0000' / in.	CHECKED -	REVISED -
\$MODELNAME\$	PLOT DATE = 3/22/2013	DATE -	REVISED -

STATE OF ILLINOIS  
 DEPARTMENT OF TRANSPORTATION

GAURDRAIL DETAILS  
 S.N. 073-7046 AND S.N. 073-7048

SCALE: SHEET OF SHEETS STA. TO STA.

F.A.P. RTE.	SECTION	COUNTY	TOTAL SHEETS	SHEET NO.
329	(19,18,17,103)RS-4	PERRY	34	30
				CONTRACT NO. 78351
ILLINOIS FED. AID PROJECT				