

CONTRACT NO. 99394

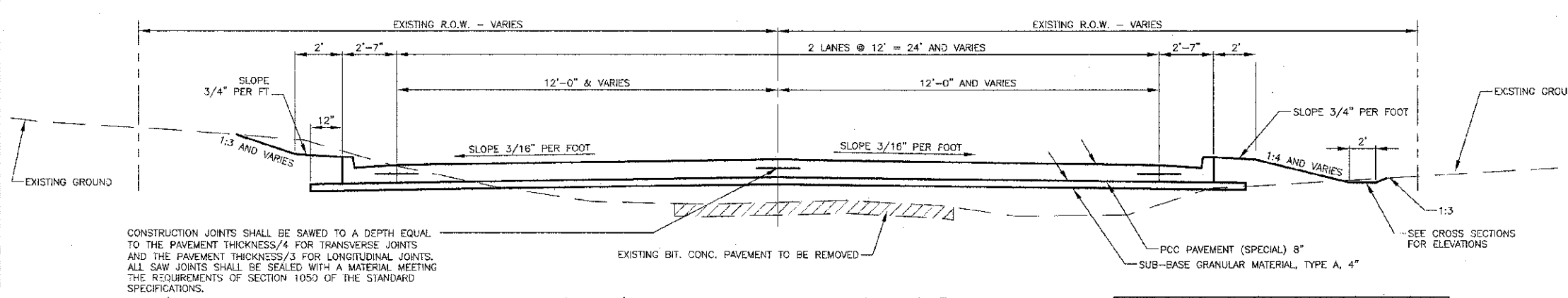
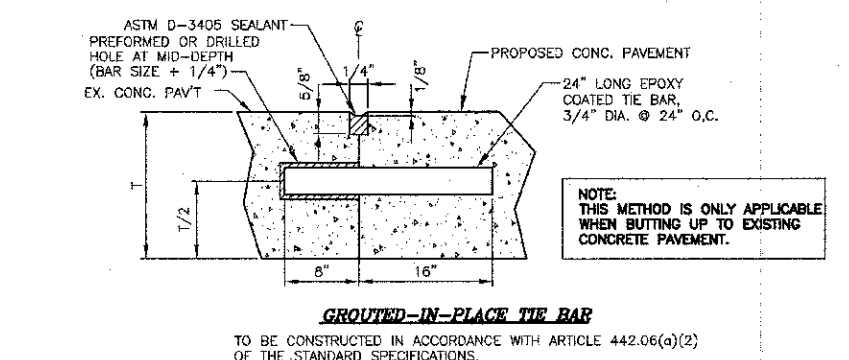
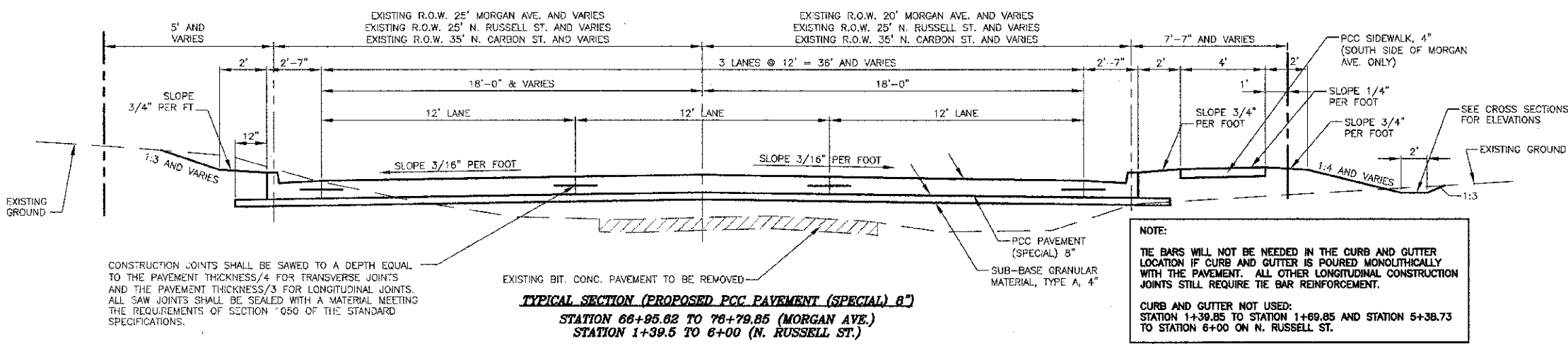
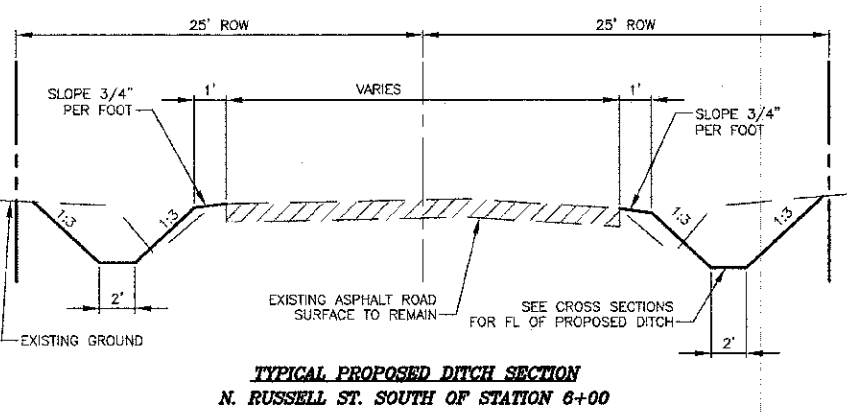
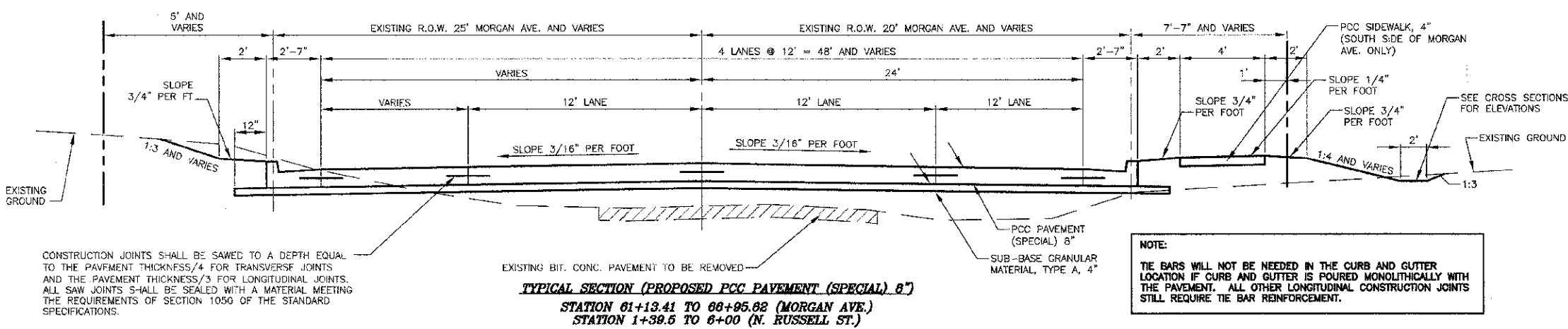
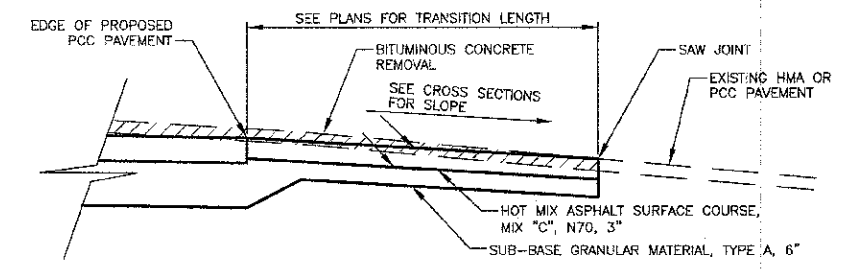
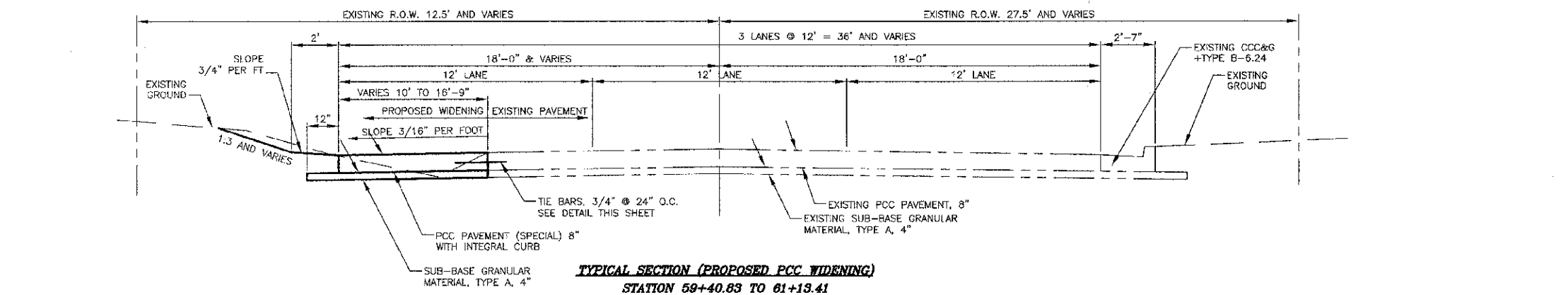

STATE OF ILLINOIS PROFESSIONAL DESIGN FIRM LICENSE NO. 184-004515

© 2013 ALL RIGHTS RESERVED

CLARIDA & ZIEGLER ENGINEERING CO.
308 South Court St, P.O. Box 937
Marion, Illinois 62959
Phone - (618)993-6411, Fax - (618)993-6750

TYPICAL SECTIONS - PCC PAVEMENT
MORGAN AVE. IMPROVEMENTS
MARION, ILLINOIS

REVISIONS	DATE	NO.

Date: 2/27/13 DR. By: TW CK'D By: HGC
Scale: NONE Job No: 08155 Sheet No: 04 of 45