

RTE.	SECTION	COUNTY	TOTAL SHEETS	SHEET NO.
FAS 1872	11-00182-00-RS	FRANKLIN	6	1

ROAD CLASSIFICATION: MAJOR COLLECTOR  
DESIGN SPEED: 50 M.P.H.

STATE OF ILLINOIS  
DEPARTMENT OF TRANSPORTATION  
DIVISION OF HIGHWAYS

PLANS FOR PROPOSED ROADWAY IMPROVEMENTS

FAS 1872  
Franklin County, Illinois  
Section 11-00182-00-RS  
Project RS-1872(105)  
JOB C-99-517-12

ADT:  
(2012) = 375  
(2027) = 435  
PC = 383  
SU = 30  
MU = 22  
DHV<sub>15</sub> = 44

JOINT UTILITY LOCATING INFORMATION  
FOR EXCAVATIONS (J.U.L.I.E.)  
PHONE 1-800-892-0123

SHEET NO.	TITLE
1	COVER SHEET AND SUMMARY OF QUANTITIES
2	MISCELLANEOUS DETAILS
3	TYPICAL SECTIONS AND MISCELLANEOUS DETAILS
4-6	PLAN

- STANDARDS
- 701006-04
  - 701201-04
  - 701301-04
  - 701306-03
  - 701311-03
  - 701901-02
  - 780001-03
  - BLR 24-2

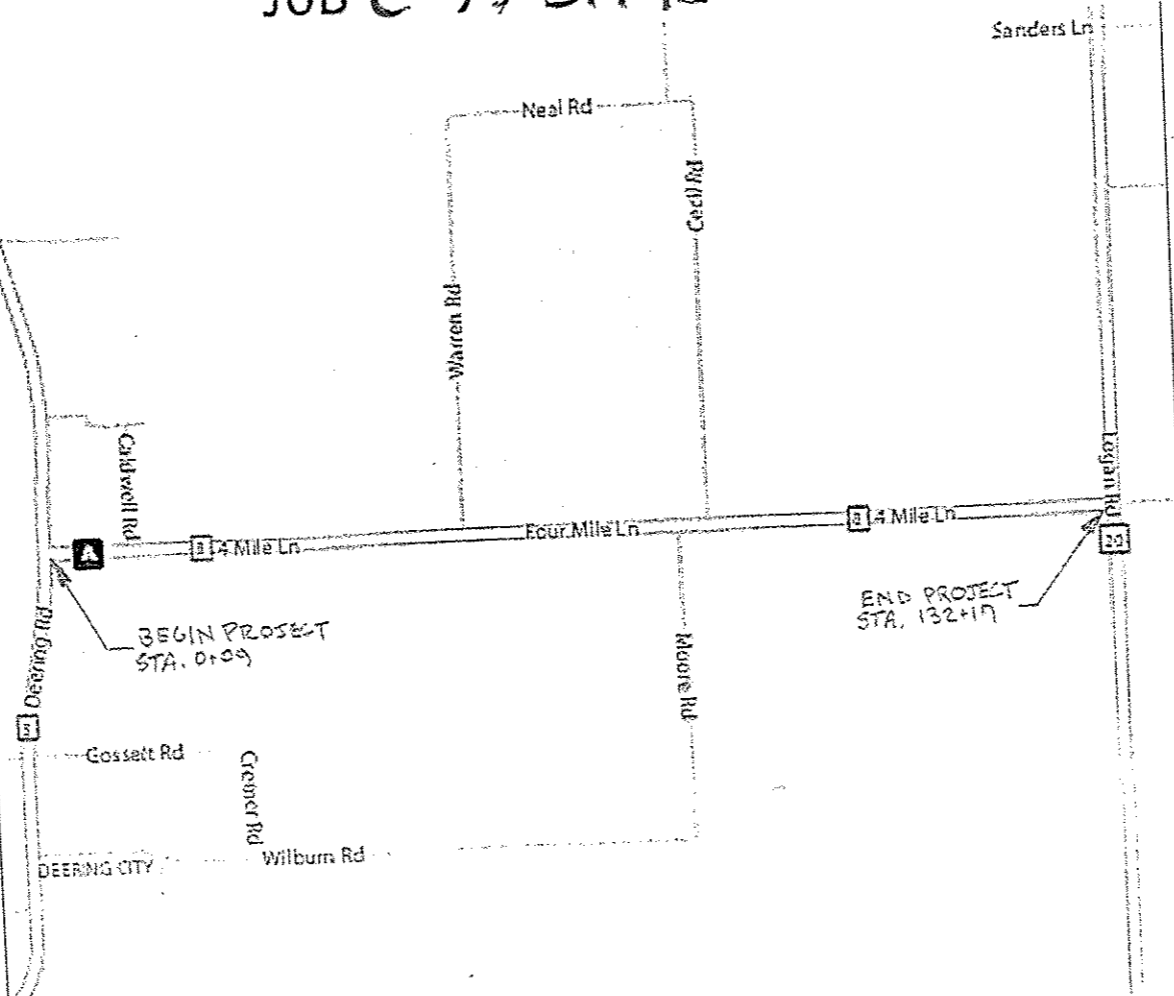
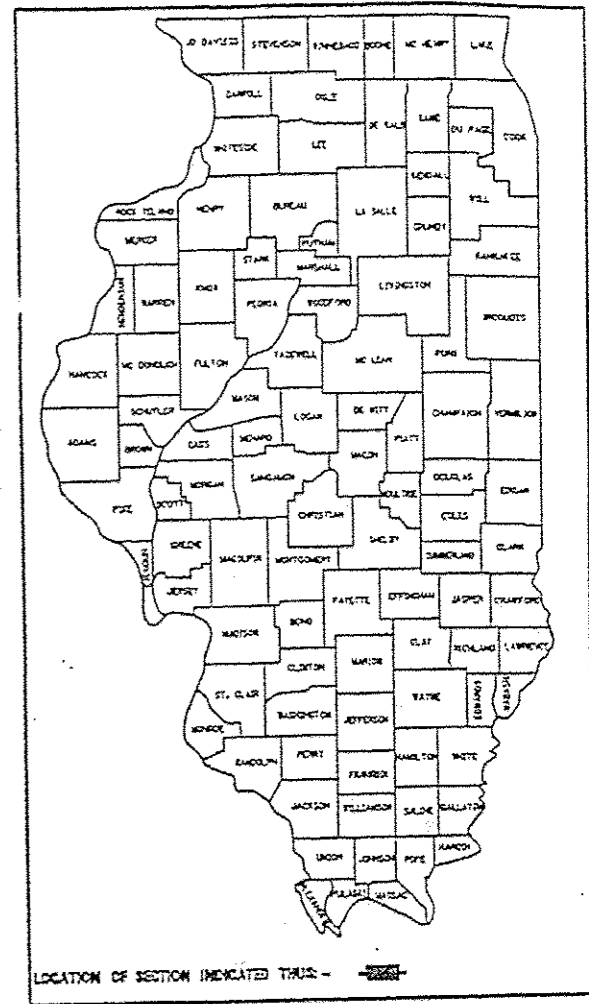

SUMMARY OF QUANTITIES			
CODE NO.	PAY ITEM	UNIT	TOTAL
40200800	AGGREGATE SURFACE COURSE, TYPE B	TON	116
40600100	BITUMINOUS MATERIALS (PRIME COAT)	GALLON	142
40600982	HOT-MIX ASPHALT SURFACE REMOVAL	SQ YD	496
	-BUTT JOINT		
40603085	HOT-MIX ASPHALT BINDER COURSE,	TON	3,646
	IL 19.0, N70		
40603315	HOT-MIX ASPHALT SURFACE COURSE,	TON	2,827
	MIX "C", N70		
48100100	AGGREGATE SHOULDERS, TYPE A	TON	1,873
67100100	MOBILIZATION	L SUM	1
70300100	SHORT TERM PAVEMENT MARKING	FOOT	1,321
Δ78001110	PAINT PAVEMENT MARKING - LINE 4"	FOOT	30,123

Δ SPECIALTY ITEMS  
\* SEE SPECIAL PROVISIONS

LOCATION MAP  
NET LENGTH: 13,208 FEET (2.50 MILES)

STATE OF ILLINOIS  
DEPARTMENT OF TRANSPORTATION

APPROVED 3/6/13  
*[Signature]*  
FRANKLIN COUNTY HIGHWAY ENGINEER

PASSED 3/25/2013  
*Dennis W. Hill*  
DISTRICT 9 ENGINEER OF LOCAL ROADS & STREETS

RELEASING FOR BID  
BASED ON LIMITED  
REVIEW 3/25/2013  
*Jeffrey L. Kevin*  
DEPUTY DIRECTOR OF HIGHWAYS, REGION 5 ENGINEER

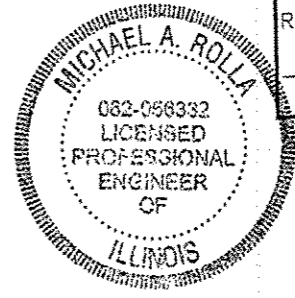

*[Signature]*  
MICHAEL A. ROLLA  
ILLINOIS REGISTERED PROFESSIONAL ENGINEER  
#062-056332  
LIC. EXPIRES NOVEMBER 30,

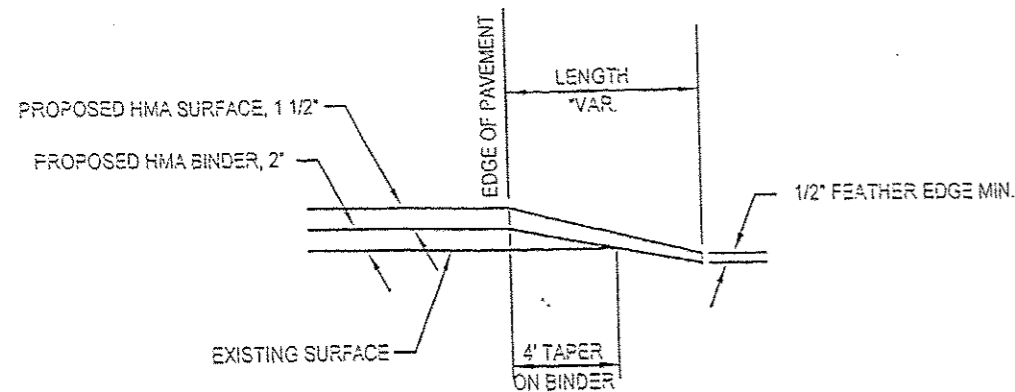
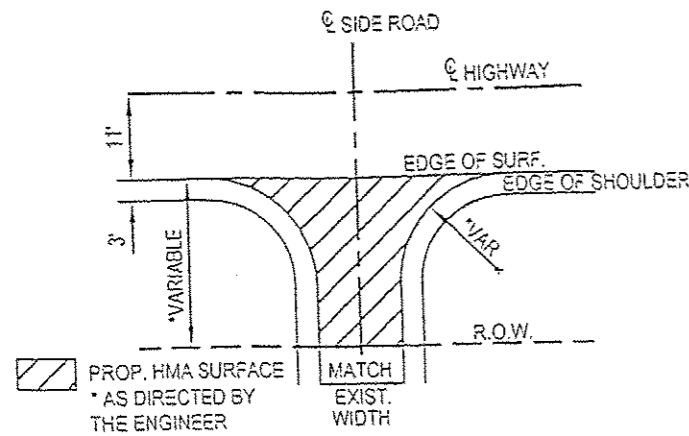

SIDEROAD DETAILS

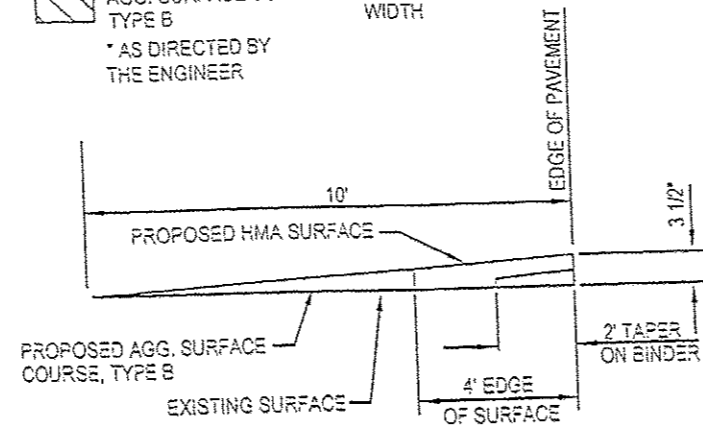
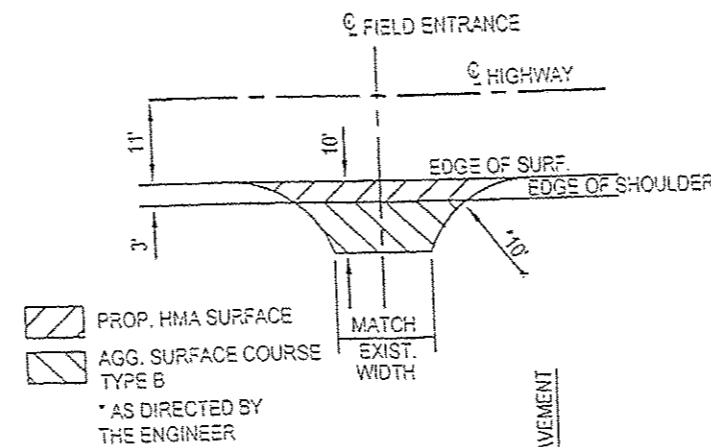

FIELD ENTRANCE DETAILS

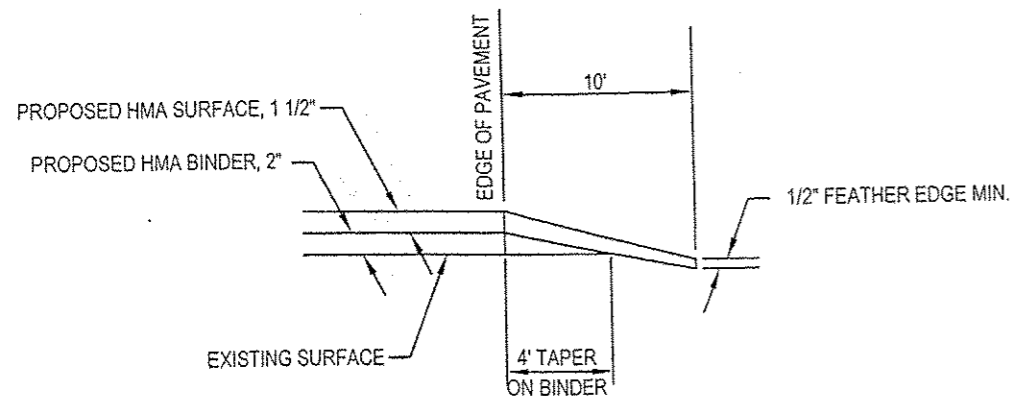
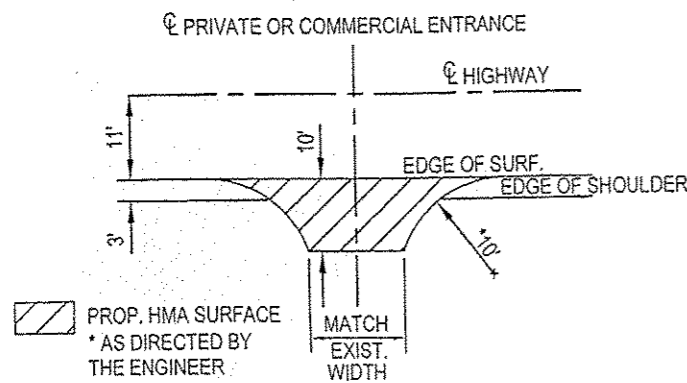

PRIVATE AND COMMERCIAL ENTRANCE DETAILS

SIDEROAD ENTRANCE QUANTITIES	
LOCATION	HOT MIX ASPHALT SURFACE COURSE, MIX "C", N70, TON
STA. 51+73 LT	11.97
STA. 78+25 RT	11.84
STA. 81+94 LT	8.29
TOTAL = 3 SIDEROADS	32.10

FIELD ENTRANCE QUANTITIES		
ENTRANCES	AGGREGATE SURFACE COURSE TYPE B, TON	HOT MIX ASPHALT SURFACE COURSE, MIX "C", N70, TON
ONE (1) ENTRANCE	4	1
TOTAL = 29 ENTRANCES	116	29

MAILBOX TURNOUT QUANTITIES		
TURNOUT	BITUMINOUS MATERIALS (PRIME COAT) GALLON	HOT MIX ASPHALT SURFACE COURSE, MIX "C", N70, TON
ONE (1) TURNOUT	4	1
TOTAL = 8 TURNOUTS	32	8

PRIVATE ENTRANCE QUANTITIES		
ENTRANCES	BITUMINOUS MATERIALS (PRIME COAT) GALLON	HOT MIX ASPHALT SURFACE COURSE, MIX "C", N70, TON
ONE (1) ENTRANCE	9	3
TOTAL = 10 ENTRANCES	90	30

COMMERCIAL ENTRANCE QUANTITIES		
ENTRANCES	BITUMINOUS MATERIALS (PRIME COAT) GALLON	HOT MIX ASPHALT SURFACE COURSE, MIX "C", N70, TON
ONE (1) ENTRANCE	10	2
TOTAL = 2 ENTRANCES	20	4

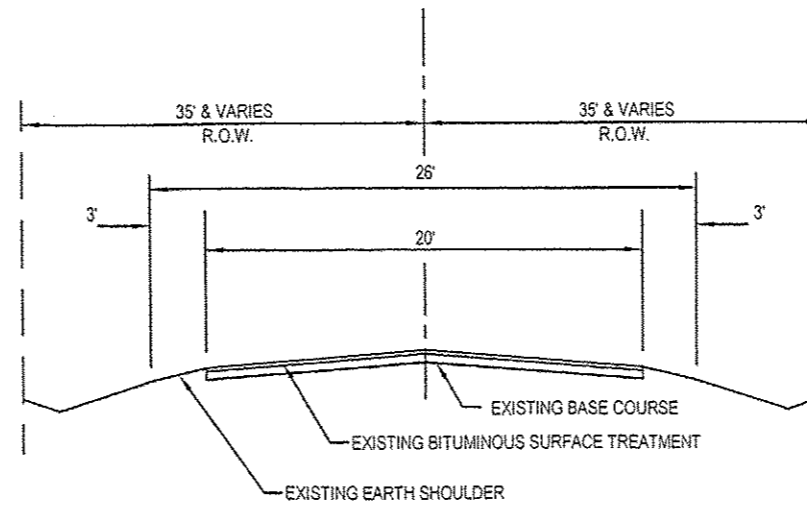

TYPICAL EXISTING SECTION

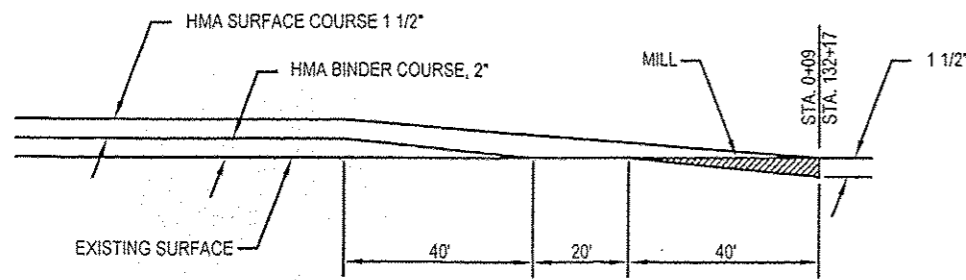

BUTT JOINT

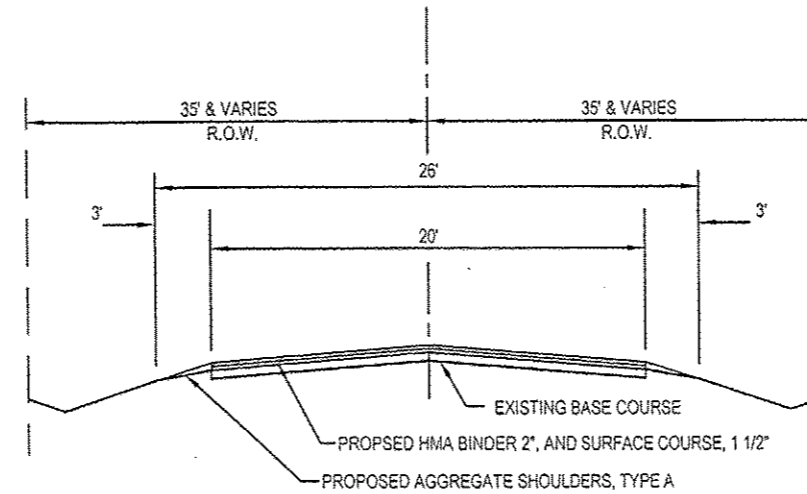

TYPICAL PROPOSED SECTION

MILLING SCHEDULE

LOCATION	COLD MILLING
STA. 0+09 TO 0+49	256
STA 131+77 TO 132+17	240
TOTAL	496

SCHEDULE OF PAVEMENT MARKING LINE, 4"

EASTBOUND LANE			WESTBOUND LANE			STATION	EDGE LINE (WHITE SOLID)
STATION	NO PASSING (YELLOW SOLID)	CENTERLINE (YELLOW DASHED)	STATION	NO PASSING (YELLOW SOLID)	CENTERLINE (YELLOW DASHED)		
0+09 TO 2+95	286	72	8+43 TO 11+95	352		0+09 TO 132+17	26182
2+95 TO 132+17		3231					
TOTALS	286	3303		352		TOTALS	26182

SCALE: 1" = 200'

ROUTE	SECTION	COUNTY	TOTAL SHEETS	SHEET NO.
FAS 1872	11 - 00182-00-PE	FRANKLIN	6	4
CONTRACT No.: 99498				

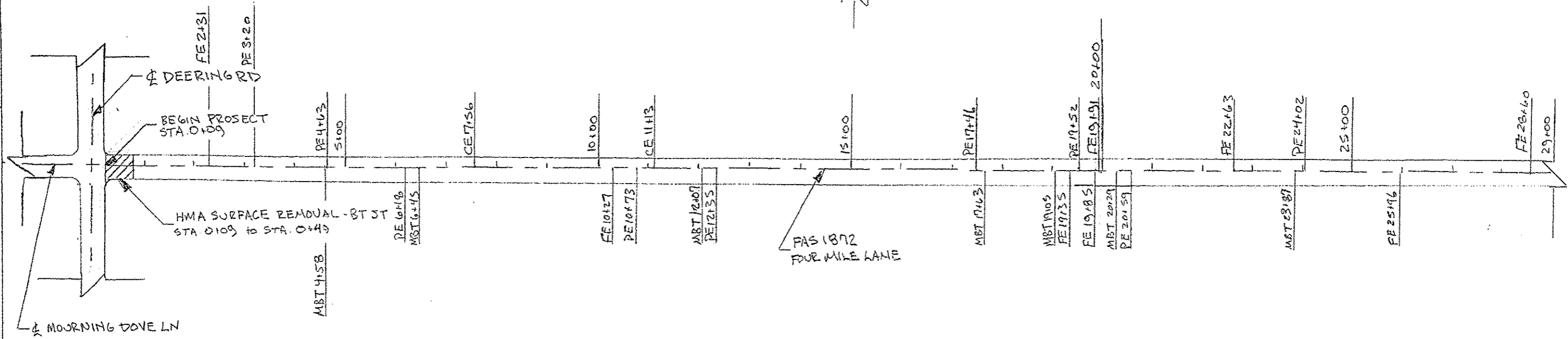

SCALE: 1" = 200'

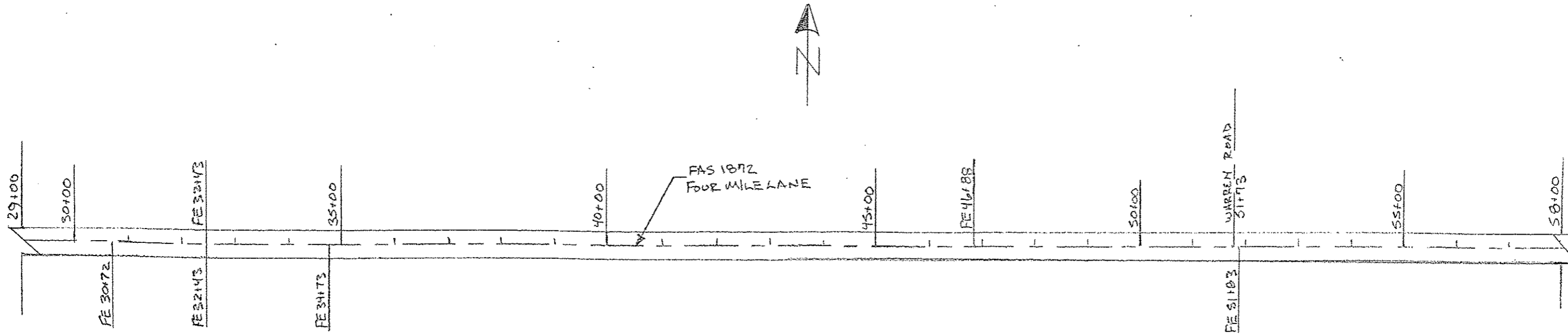

PLAN  
STATION 0+09 TO 58+00

SCALE: 1"=200'

ROUTE	SECTION	COUNTY	TOTAL SHEETS	SHEET NO.
FAS 1872	11-00182-00-RE	FRANKLIN	6	5
CONTRACT No.:				99498

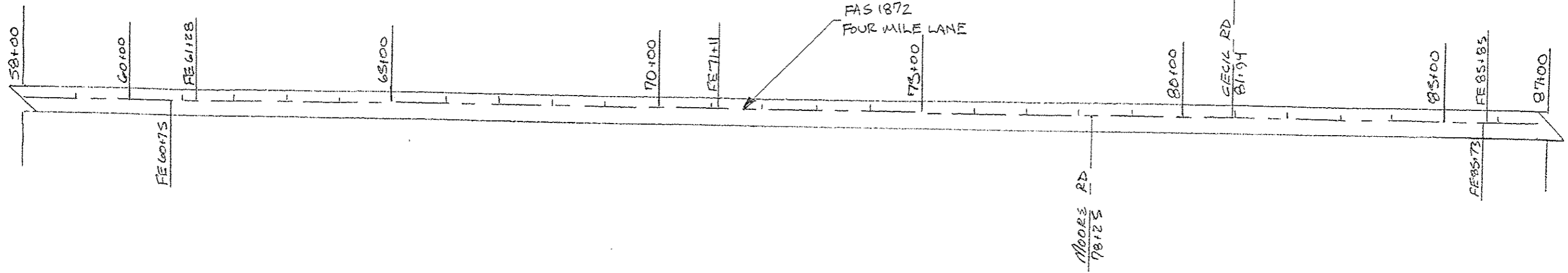

SCALE: 1"=200'

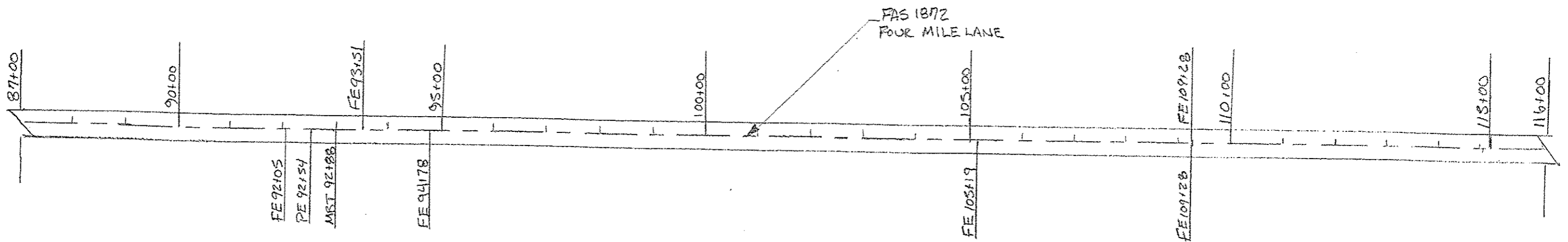

PLAN  
STATION 58+00 TO 116+00

ROUTE	SECTION	COUNTY	TOTAL SHEETS	SHEET NO.
FAS 1872	11-00182-00-RS	FRANKLIN	6	6
CONTRACT No.:				99498

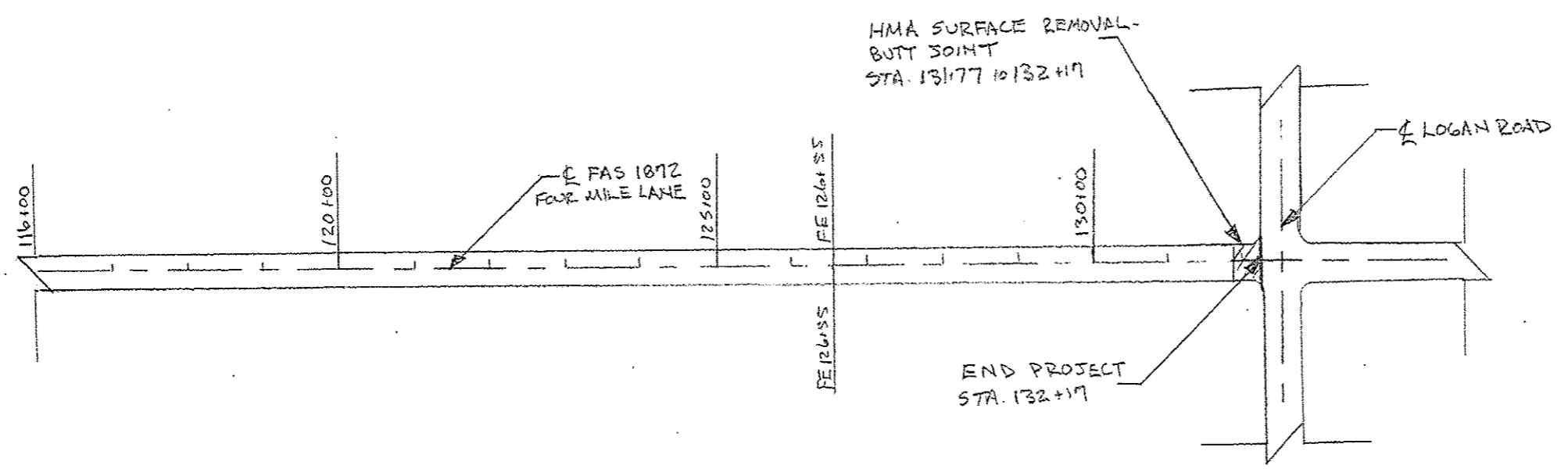

PLAN  
STATION 116+00 TO 132+17