

F.A.I. RTE.	SECTION	COUNTY	TOTAL SHEETS	SHEET NO.
55	99(1&2) I-10	WILL	52	31
STA.		TO STA.		
FED. ROAD DIST. NO.		ILLINOIS	FED. AID PROJECT	

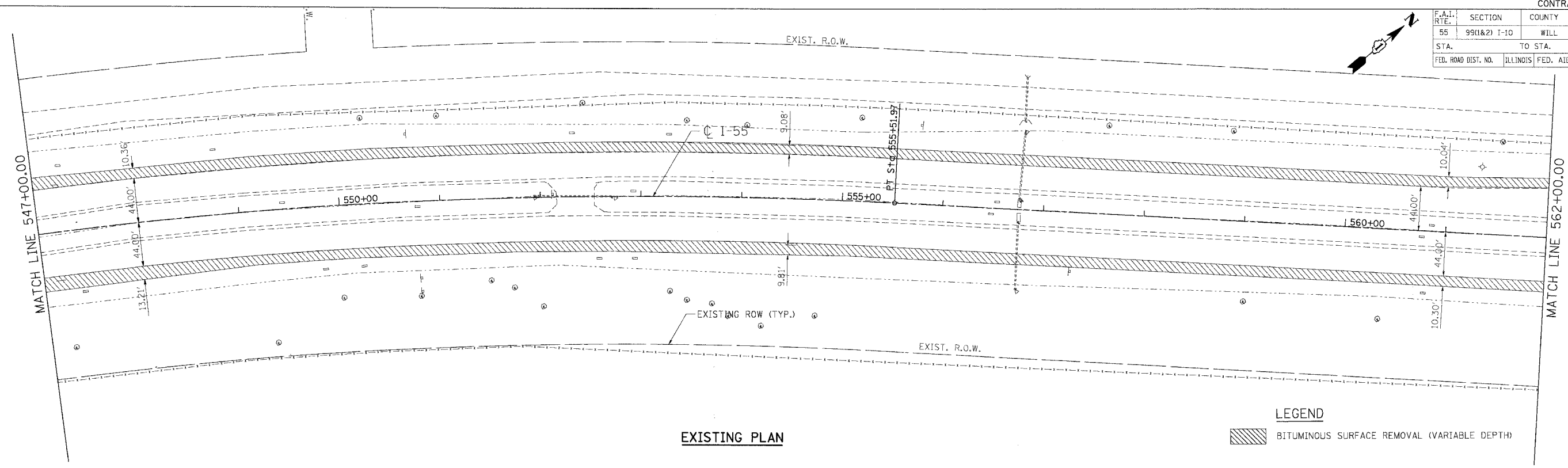

EXISTING PLAN

**LEGEND**  
 BITUMINOUS SURFACE REMOVAL (VARIABLE DEPTH)

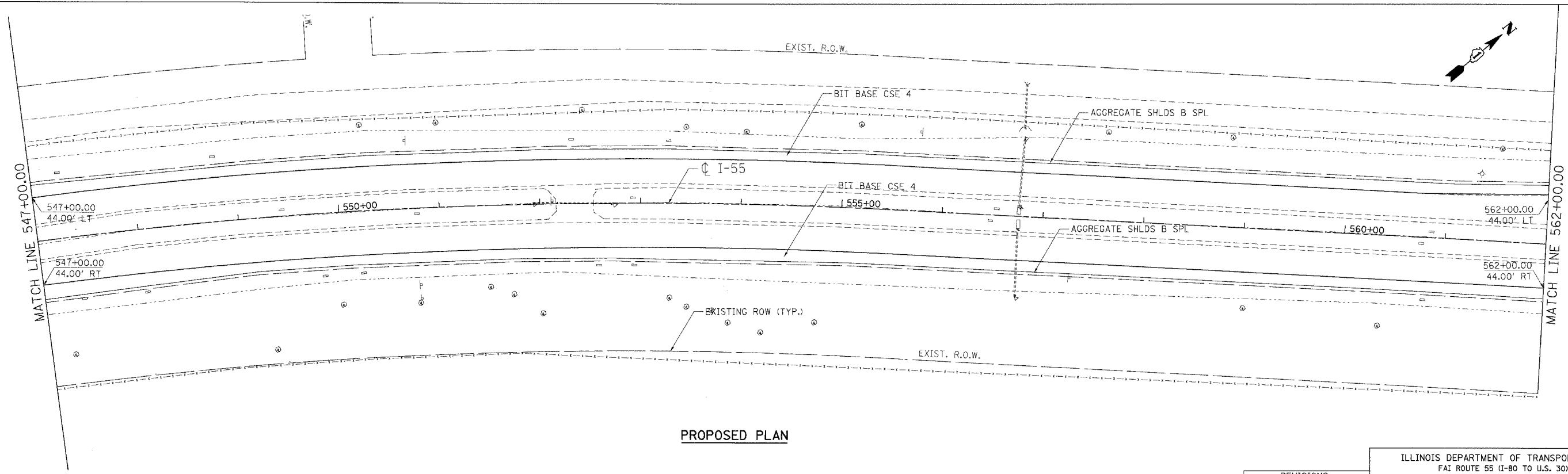

PROPOSED PLAN

PLOT DATE = 03/15/06  
 PLOT SCALE = 1"=50'  
 USER NAME = MUSER

REVISIONS	
NAME	DATE

ILLINOIS DEPARTMENT OF TRANSPORTATION  
 FAI ROUTE 55 (I-80 TO U.S. 30)  
 SHOULDER MILLING AND RESURFACING

**ROADWAY PLAN**  
 FAI 55  
 STA. 547+00.00 TO STA. 562+00.00

SCALE: 1"=50'  
 DATE: 03/15/06

DRAWN BY: OP  
 CHECKED BY: DDH

**TENG** TENG & ASSOCIATES, INC.  
 ENGINEERS/ARCHITECTS/PLANNERS  
 CHICAGO, ILLINOIS