

F.A.I. RTE.	SECTION	COUNTY	TOTAL SHEETS	SHEET NO.
55	99(1&2) I-10	WILL	52	35
STA. TO STA.		FED. ROAD DIST. NO. ILLINOIS FED. AID PROJECT		

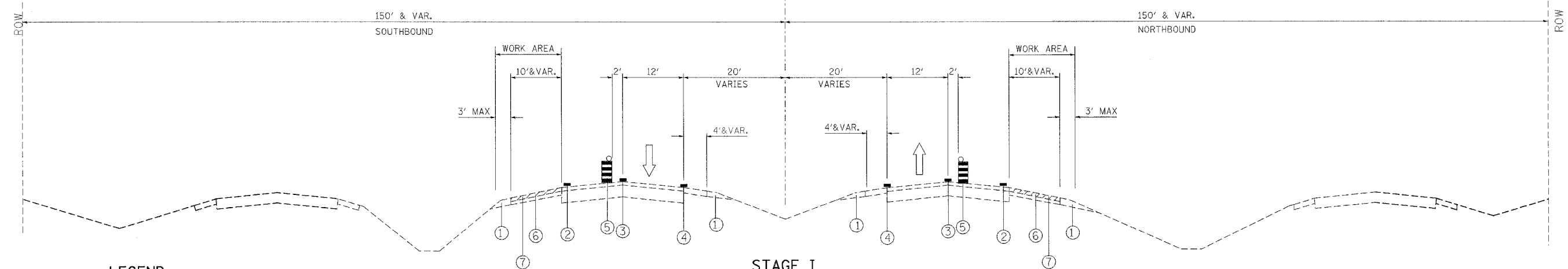

- LEGEND**
- ① EXIST AGGREGATE SHOULDER
  - ② PVT MARKING TYPE, TYPE III 4" (WHITE)
  - ③ EXIST SKIP-DASH PVT MARKING (WHITE)
  - ④ EXIST SOLID PVT MARKING (YELLOW)
  - ⑤ DRUMS W/ STEADY BURN LIGHTS AT 50' C-C
  - ⑥ BIT SURFACE REMOVAL, 4" (VARIABLE DEPTH)
  - ⑦ BIT BASE COURSE, 4"

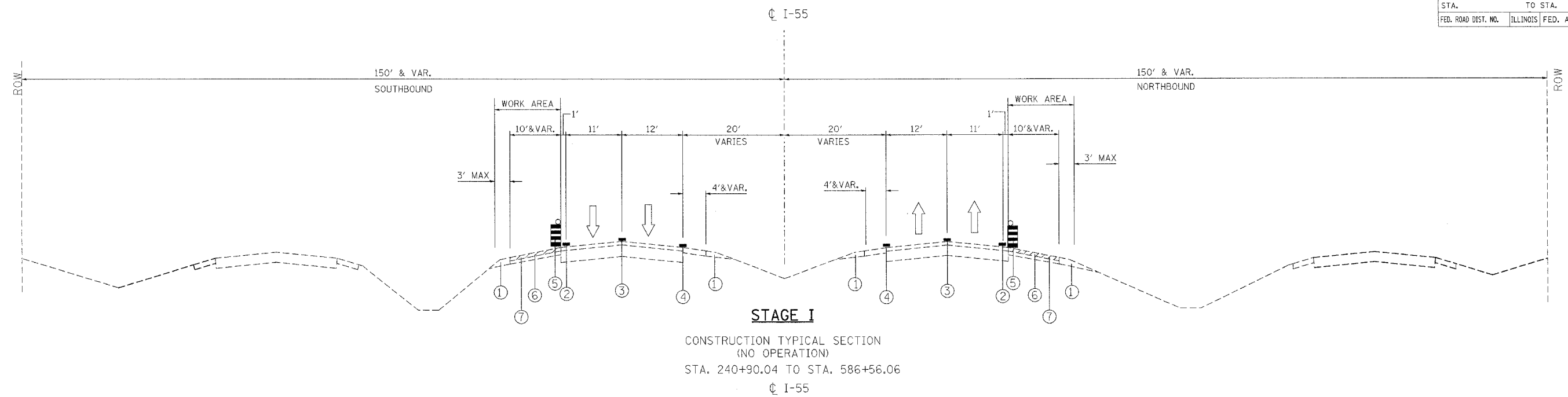
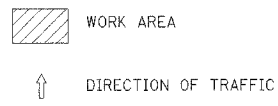

REVISIONS	
NAME	DATE

ILLINOIS DEPARTMENT OF TRANSPORTATION  
FAI ROUTE 55 (I-80 TO U.S. 30)  
SHOULDER MILLING AND RESURFACING

**STAGING AND TRAFFIC CONTROL  
TYPICAL SECTIONS**

SCALE: N.T.S.      DRAWN BY OP  
DATE 05/01/06      CHECKED BY DDH

**TENG**      TENG & ASSOCIATES, INC.  
ENGINEERS/ARCHITECTS/PLANNERS  
CHICAGO, ILLINOIS

PLOT DATE = #DATE#    FILE NAME = #FILE#    PLOT SCALE = #SCALE#    USER NAME = #USER#  
 CHALLOUAF    S:\DOCUMENT\02361801\CIVIL\CON\MT0514082.DWG    5/01/2006 10:33:03