

F.A.I. RTE.	SECTION	COUNTY	TOTAL SHEETS	SHEET NO.
94	1818 R-3	COOK	265	34
STA. 2316+00		TO STA. 2367+00		
FED. ROAD DIST. NO.		ILLINOIS FED. AID PROJECT		

60B17

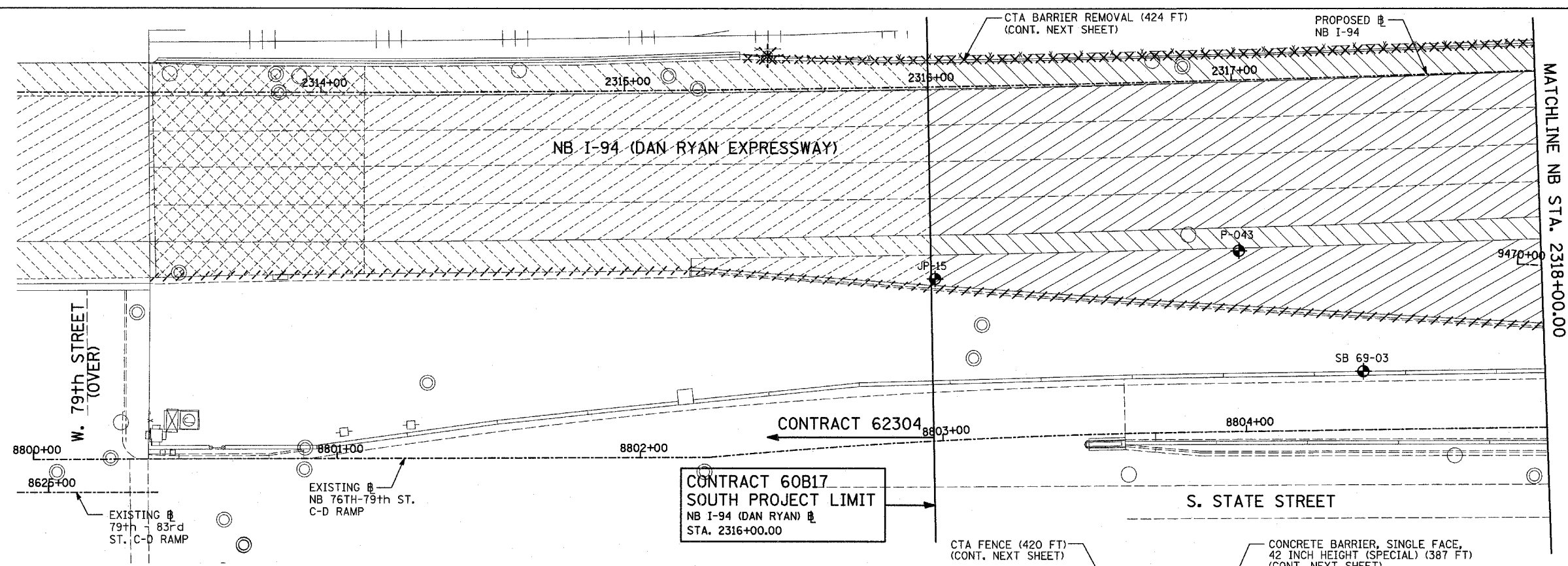

EXISTING CONDITIONS
PROPOSED IMPROVEMENTS

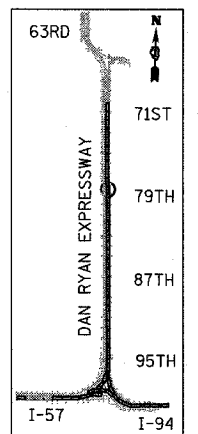
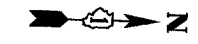
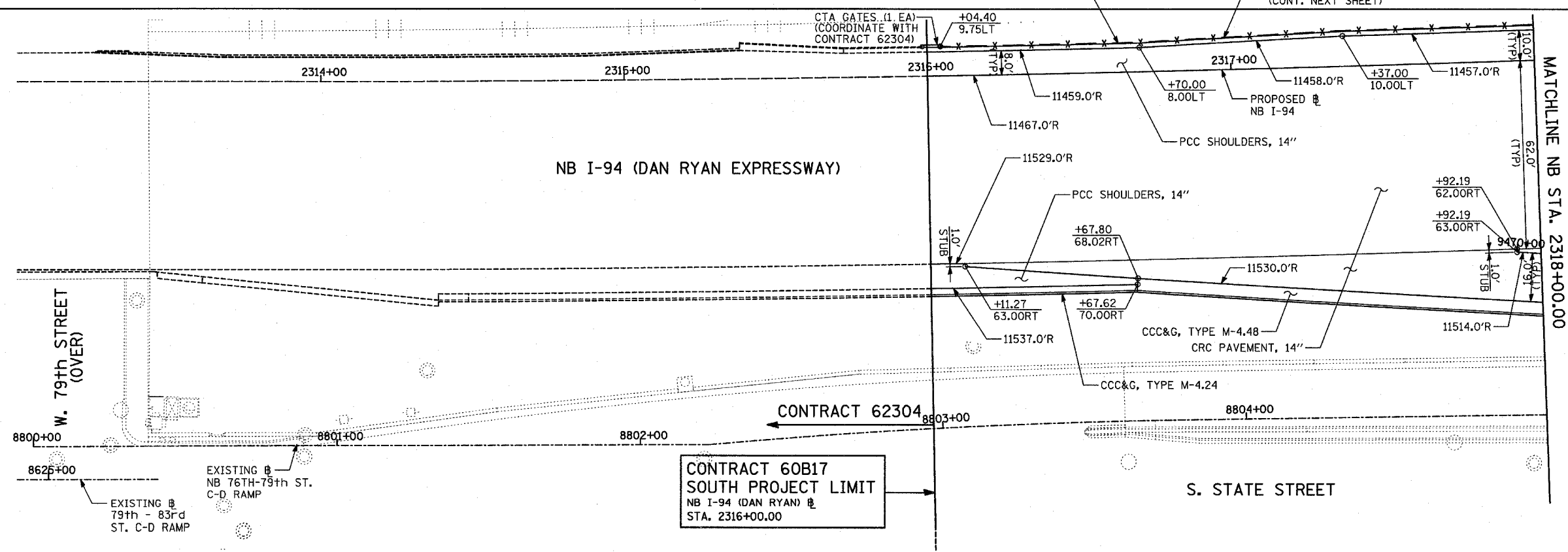

LOCATION MAP

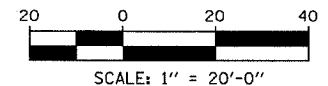

LEGEND:

	COMB CONC CURB & GUTTER REMOVAL		PAVEMENT REMOVAL
	CHAIN LINK FENCE REMOVAL		PAVED SHOULDER REMOVAL
	CONCRETE BARRIER/GUARDRAIL REMOVAL		PAVEMENT/SHOULDER REMOVAL, SPECIAL
	TREE REMOVAL (UNITS) (NO UNIT SHOWN = 6)		BITUMINOUS SURFACE REMOVAL, 4"
	SOIL BORING LOCATIONS		BITUMINOUS SURFACE REMOVAL, 1/2" OR 1 3/4" (SEE CALLOUT)

LIGHT POLE FOUNDATION REMOVAL (SEE ROADWAY LIGHTING & SURVEILLANCE PLANS)

+XX.XX MAINLINE #
XX.XXRT STATION/OFFSET

PLAN NOTES:

- ALL STATION/OFFSET/RADIUS CALLOUTS MEASURED TO EDGE OF PAVEMENT UNLESS OTHERWISE NOTED.
- EXACT LOCATIONS OF EXISTING PIERS/ABUTMENTS TO BE FIELD VERIFIED

REVISIONS	
NAME	DATE

ILLINOIS DEPARTMENT OF TRANSPORTATION
F.A.I. 94 (DAN RYAN EXPRESSWAY)
EXISTING AND PROPOSED PLAN
NB I-94 (DAN RYAN EXPRESSWAY)
NB I-94 STA. 2313+00.00 TO 2318+00.00

SCALE: 1"=20'
DATE: MARCH 7, 2006

DRAWN BY: RTM
CHECKED BY: MPG

TYLIN INTERNATIONAL