

F.A.I. RTE.	SECTION	COUNTY	TOTAL SHEETS	SHEET NO.
94	1818 R-3	COOK	265	84
STA. 2316+00		TO STA. 2367+00		
FED. ROAD DIST. NO.	ILLINOIS	FED. AID PROJECT		

60B17

MATCHLINE NB I-94 STA. 2340+00.00 (PREV. SHEET)

MATCHLINE NB I-94 STA. 2355+00.00 (BELOW)

MATCHLINE NB I-94 STA. 2355+00.00 (ABOVE)

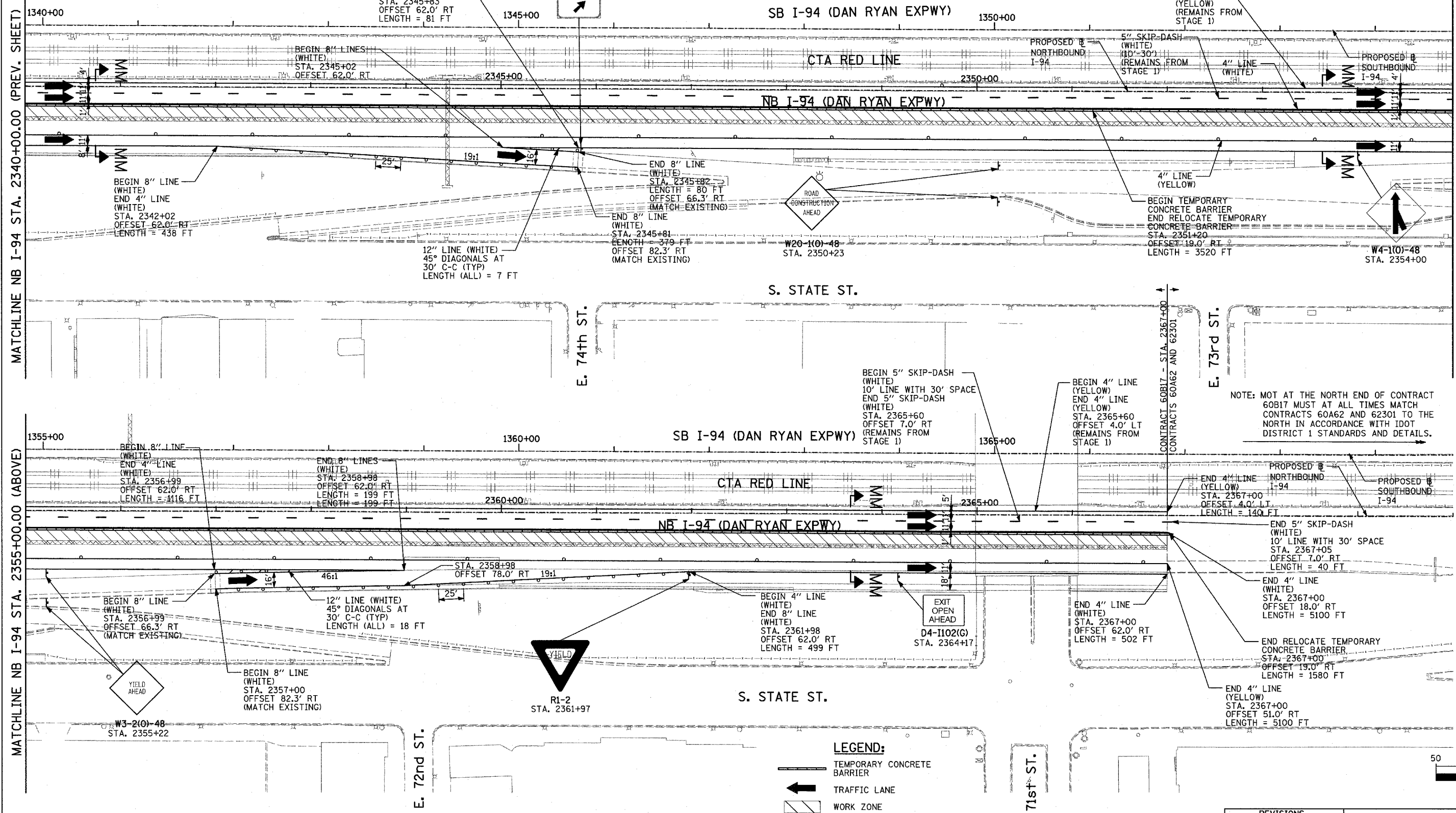

NOTE: MOT AT THE NORTH END OF CONTRACT 60B17 MUST AT ALL TIMES MATCH CONTRACTS 60A62 AND 62301 TO THE NORTH IN ACCORDANCE WITH IDOT DISTRICT 1 STANDARDS AND DETAILS.

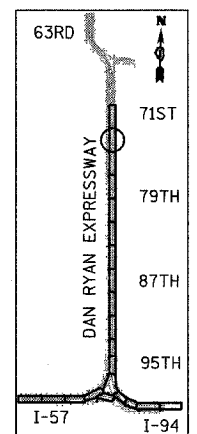

LOCATION MAP

- LEGEND:**
- TEMPORARY CONCRETE BARRIER
 - TRAFFIC LANE
 - WORK ZONE
 - BARRICADE, TYPE III
 - DRUM WITH MONO-DIRECTIONAL STEADY BURNING LIGHT
 - ARROW BOARD
 - TEMPORARY PAVEMENT

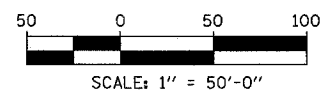

REVISIONS	
NAME	DATE

ILLINOIS DEPARTMENT OF TRANSPORTATION
 F.A.I. 94 (DAN RYAN EXPRESSWAY)
 MAINTENANCE OF TRAFFIC PLAN
 STAGE 2 - NB I-94
 NB I-94 STA. 2340+00 TO 2370+00
 SHEET 2 OF 2
 SCALE: 1"=50'-0"
 DATE: MARCH 7, 2006
 DRAWN BY: RTM
 CHECKED BY: JDF

TYLIN INTERNATIONAL