

| F.A.I. RTE. | SECTION | COUNTY | TOTAL SHEETS | SHEET NO. |
|---------------------|----------|------------------|--------------|-----------|
| 94 | 1818 R-3 | COOK | 265 | 90 |
| STA. 2316+00 | | TO STA. 2367+00 | | |
| FED. ROAD DIST. NO. | ILLINOIS | FED. AID PROJECT | | |

60B17

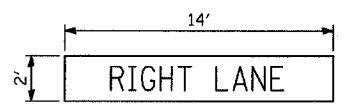

LEGEND - WHITE
BACKGROUND - GREEN
10" E LETTERS
STA. 2332+18
TEMPORARY INFORMATION
SIGNING - 28 SF

SIGNING LEGEND:

- EXISTING GROUND MOUNTED SIGN
- EXISTING OVERHEAD TRUSS MOUNTED SIGN
- EXISTING OVERHEAD SIGN STRUCTURE-BRIDGE MOUNTED
- EXISTING OVERHEAD CANTILEVER MOUNTED SIGN
- PROPOSED GROUND MOUNTED SIGN
- PROPOSED OVERHEAD SIGN STRUCTURE - TRUSS
- CONSTRUCTION ZONE
- EXISTING SIGN
- EXISTING SIGN TO BE REMOVED
- PROPOSED SIGN

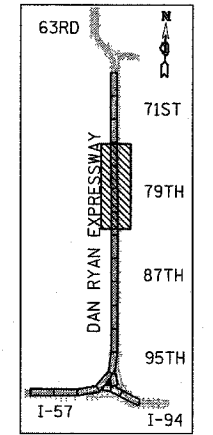
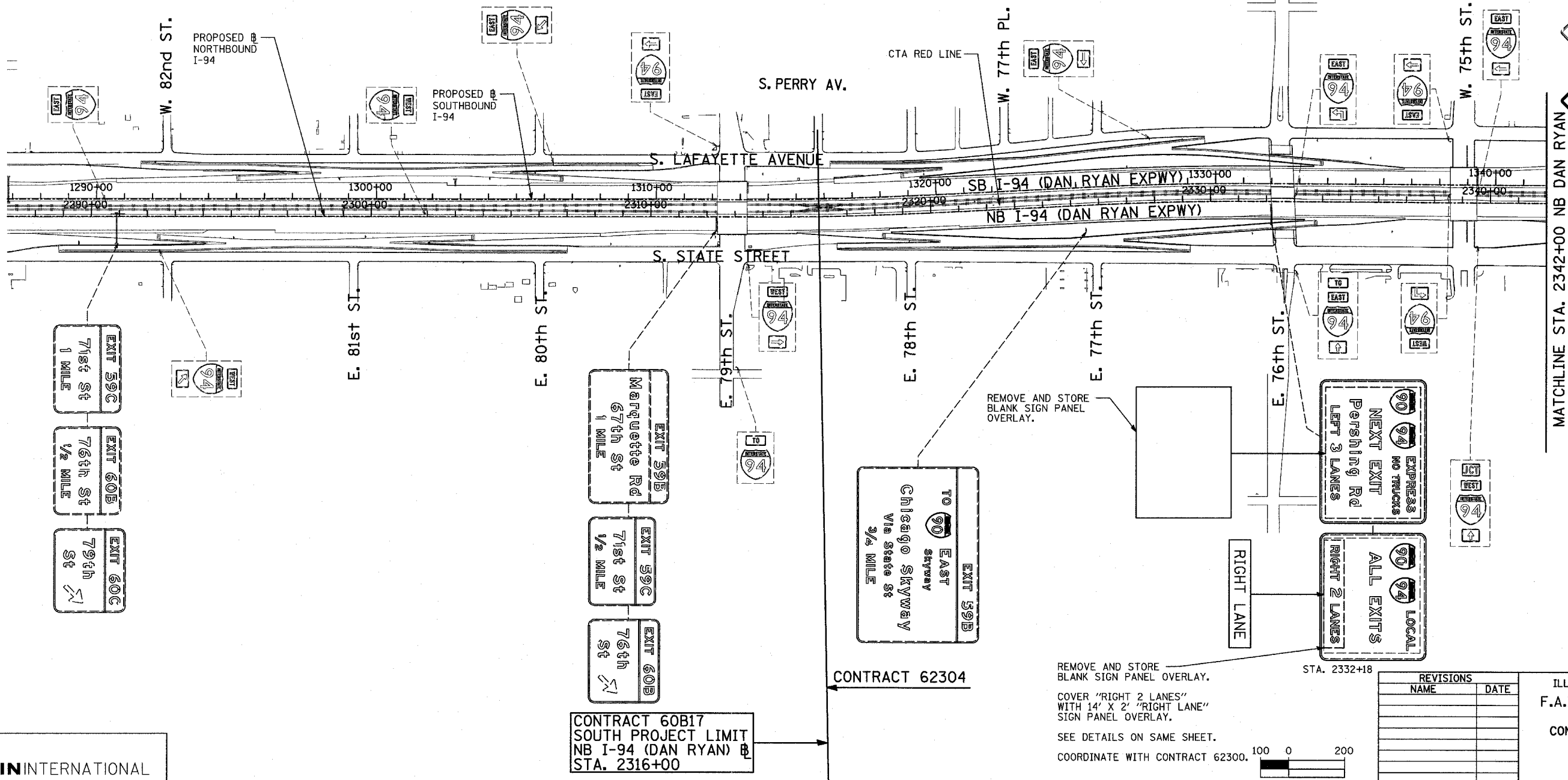

LOCATION MAP

TYLIN INTERNATIONAL

CONTRACT 60B17
SOUTH PROJECT LIMIT
NB I-94 (DAN RYAN) @
STA. 2316+00

CONTRACT 62304

REMOVE AND STORE
BLANK SIGN PANEL
OVERLAY.
COVER "RIGHT 2 LANES"
WITH 14' X 2' "RIGHT LANE"
SIGN PANEL OVERLAY.
SEE DETAILS ON SAME SHEET.
COORDINATE WITH CONTRACT 62304.

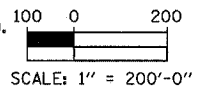

| REVISIONS | |
|-----------|------|
| NAME | DATE |
| | |
| | |
| | |
| | |
| | |
| | |
| | |
| | |
| | |
| | |

ILLINOIS DEPARTMENT OF TRANSPORTATION
F.A.I. 94 (DAN RYAN EXPRESSWAY)

CONSTRUCTION SIGNING-STAGE WINTER
STA. 2287+00 TO STA 2342+00
SHEET 1 OF 2

SCALE: 1" = 200'
DATE: MARCH 7, 2006
DRAWN BY: AMB
CHECKED BY: TGB