

F.A.I. RTE.	SECTION	COUNTY	TOTAL SHEETS	SHEET NO.
94	1818 R-3	COOK	265	161
STA. 2316+00		TO STA. 2367+00		
FED. ROAD DIST. NO.	ILLINOIS	FED. AID PROJECT	60B17	

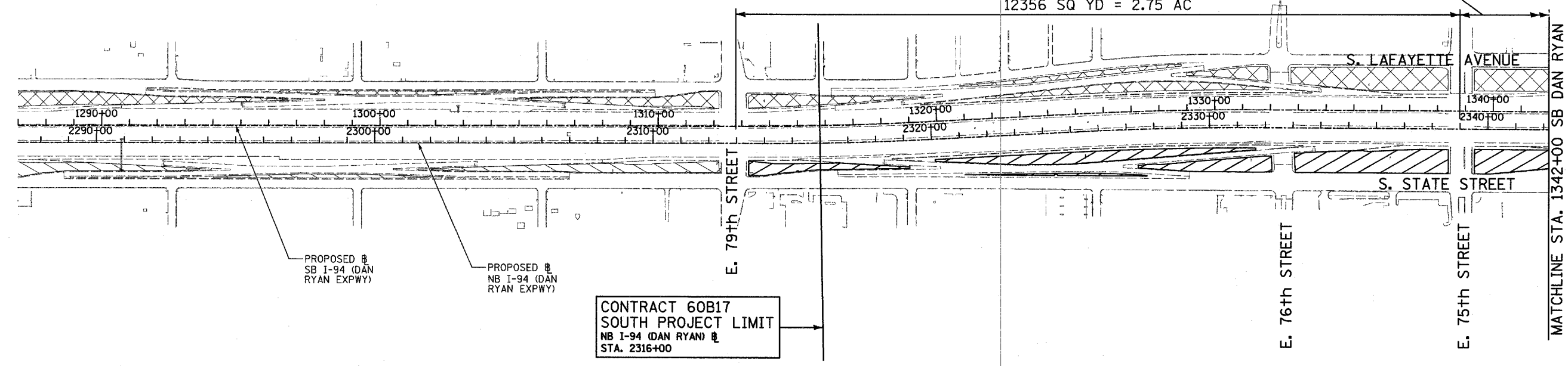

15031 SQ YD =
3.25 AC (CONT. BELOW)

12356 SQ YD = 2.75 AC

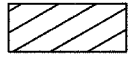

CONTRACT 60B17
SOUTH PROJECT LIMIT
NB I-94 (DAN RYAN) @
STA. 2316+00

LEGEND

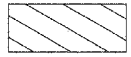
-  MOWING AREAS THIS CONTRACT
-  MOWING AREAS CONTRACTS 62593 & 60B18
-  MOWING AREAS CONTRACT 62304

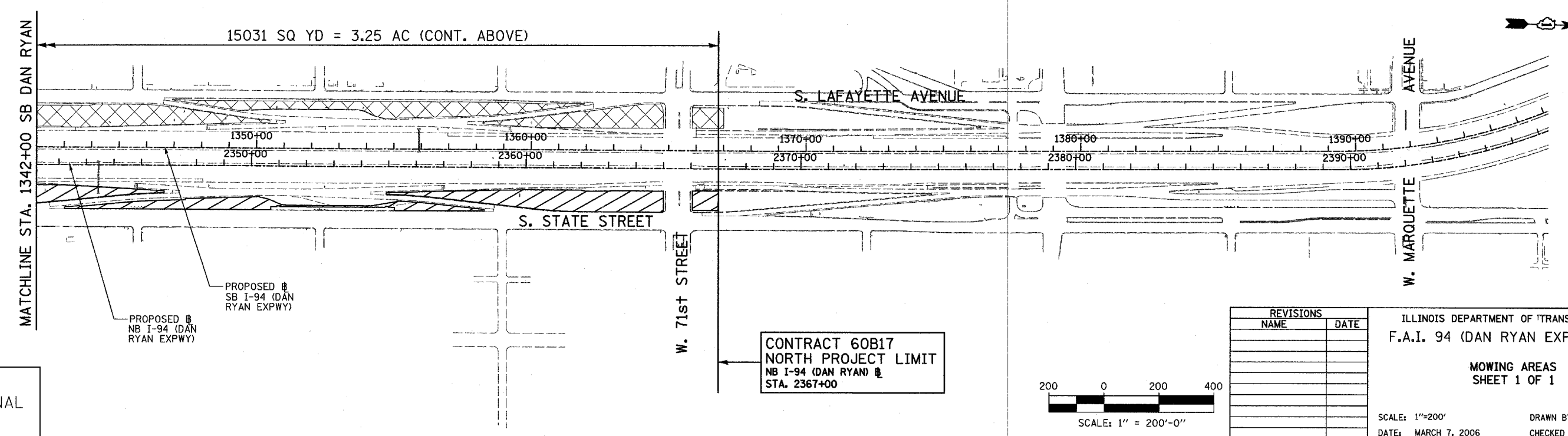

CONTRACT 60B17
NORTH PROJECT LIMIT
NB I-94 (DAN RYAN) @
STA. 2367+00

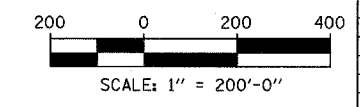

REVISIONS	
NAME	DATE

ILLINOIS DEPARTMENT OF TRANSPORTATION
F.A.I. 94 (DAN RYAN EXPRESSWAY)

**MOWING AREAS
SHEET 1 OF 1**

SCALE: 1"=200'
DATE: MARCH 7, 2006

DRAWN BY: RTM
CHECKED BY: MPG