

INDEX OF SHEETS

FOR INDEX OF SHEETS, SEE SHEET NO. 2

PROJECT LOCATED IN THE CITY OF CHICAGO

| DAN RYAN EXPRESSWAY: | ADT (2010) | DESIGN SPEED | POSTED SPEED |
|----------------------------------|------------|--------------|--------------|
| SB I-94 (DAN RYAN) | 140,500 | 60 MPH | 55 MPH |
| SB I-94 (BISHOP FORD) | 87,600 | 60 MPH | 55 MPH |
| SB I-57 | 65,800 | 60 MPH | 55 MPH |
| SB 71ST STREET C-D ENTRANCE RAMP | 9,200 | 45 MPH | 40 MPH |
| SB 75TH STREET C-D EXIT RAMP | 8,000 | 45 MPH | 40 MPH |
| SB 76TH STREET C-D ENTRANCE RAMP | 8,000 | 45 MPH | 40 MPH |
| SB 79TH STREET C-D EXIT RAMP | 7,300 | 45 MPH | 40 MPH |

PROJECT DESCRIPTION

THE PROPOSED IMPROVEMENT CONSISTS OF PAVEMENT AND CTA BARRIER WALL RECONSTRUCTION, WIDENING, RAMP TERMINALS, SHOULDERS, AND DRAINAGE MODIFICATIONS ALONG SB I-94 (DAN RYAN EXPRESSWAY)

FULL SIZE PLANS HAVE BEEN PREPARED USING STANDARD ENGINEERING SCALES; REDUCED SIZED PLANS WILL NOT CONFORM TO STANDARD SCALES. IN MAKING MEASUREMENTS ON REDUCED PLANS, THE ABOVE SCALES MAY BE USED

DIGGER:
CHICAGO UTILITY ALERT NETWORK
(312) 744-7000

CTA CONTACT:
MARVIN A. WATSON,
GENERAL MANAGER, CONSTRUCTION
(312) 681-3860

CONTRACT NO. 60B18

STATE OF ILLINOIS
DEPARTMENT OF TRANSPORTATION
DIVISION OF HIGHWAYS

PROPOSED HIGHWAY PLANS

F.A.I. ROUTE 94 (DAN RYAN EXPRESSWAY)
SECTION 1818 R-6
PROJECT NO.: IM-94-3(404)060
79TH STREET TO 71ST STREET
SB LANES 1 - 5, SHOULDERS & CTA BARRIER WALL
COOK COUNTY
C-91-293-06

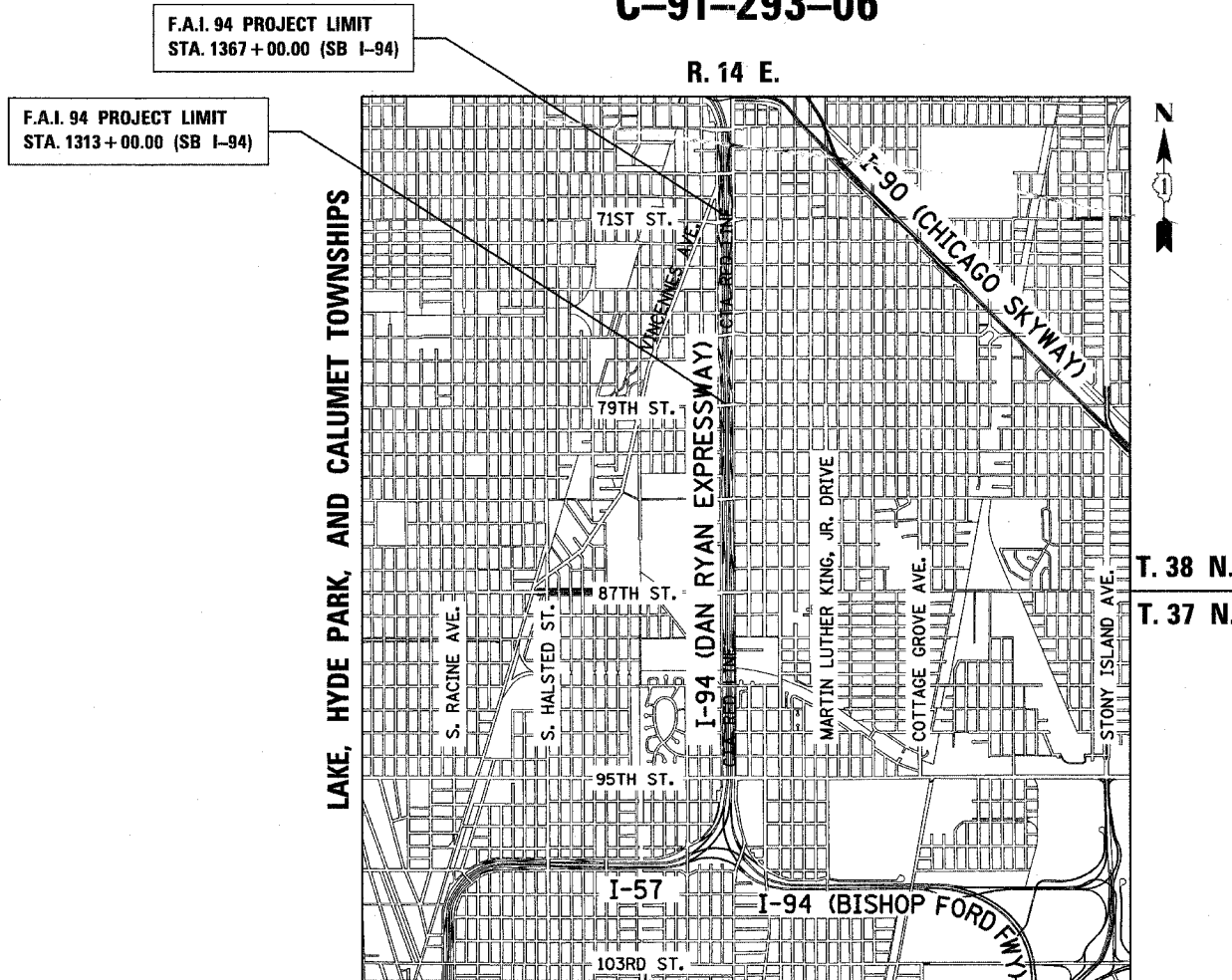

LOCATION MAP

0 1/2 MILE 1 MILE
MAP SCALE: 1" = 1/2 MILE
GROSS LENGTH OF PROJECT = 5,400.0 FT. = 1.023 MI.
NET LENGTH OF PROJECT = 5,400.0 FT. = 1.023 MI.

| | | | | |
|------------------------------|------------------|-------------|------------------|-------------|
| F.A.I. RTE. 94 | SECTION 1818 R-6 | COUNTY COOK | TOTAL SHEETS 291 | SHEET NO. 1 |
| FED. ROAD DIST. NO. ILLINOIS | | | FED. AID PROJECT | |

* 290
288
291
C-91-421-01
60B18

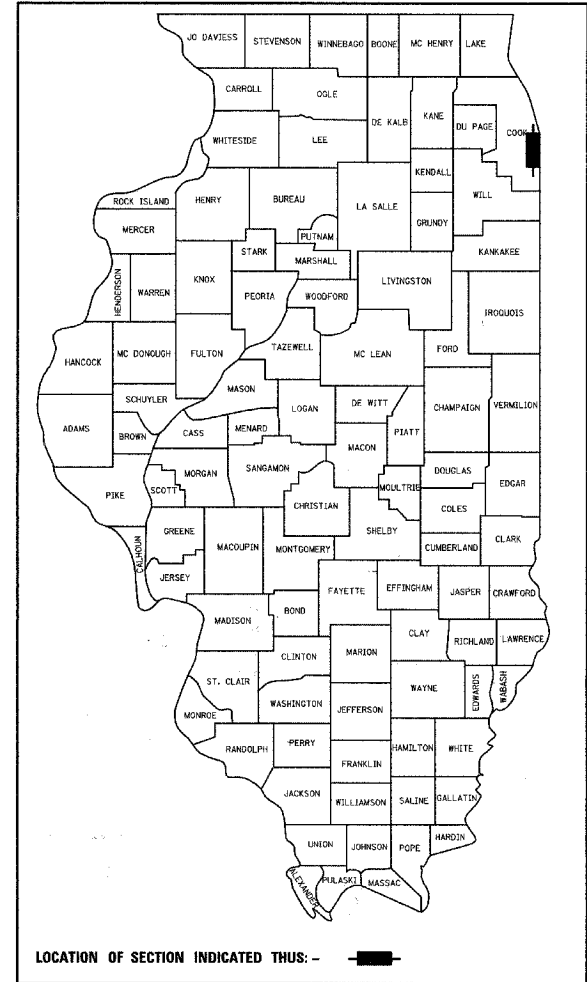

STATE OF ILLINOIS
DEPARTMENT OF TRANSPORTATION
DIVISION OF HIGHWAYS

SUBMITTED March 2, 2006
Diane M. O'Kaffe / CD
DISTRICT ENGINEER

March 24, 2006
Mike Hine / CD
ENGINEER OF DESIGN AND ENVIRONMENT

March 24, 2006
Milton P. Seo, P.E. / CD
DIRECTOR, DIVISION OF HIGHWAYS

CONTRACT 23C

DEAN A. KIESLING
32957
REGISTERED PROFESSIONAL ENGINEER OF ILLINOIS
Signed Dean A. Kiesling, P.E., Il. Lic. No. 32957
Expires 11-30-2007.
Date March 1, 2006

THOMAS MIKOLAJEWSKI
062-056151
LICENSED PROFESSIONAL ENGINEER OF ILLINOIS
Signed Thomas Mikolajewski, P.E., Il. Lic. No. 062-056151
Expires 11-30-2007.
Date March 1, 2006
For Electrical Drawings 185-202

PHILLIP D. FREY
081-004826
REGISTERED PROFESSIONAL ENGINEER OF ILLINOIS
Signed Phillip D. Frey, S.E., Il. Lic. No. 081-004826
Expires 11-30-2006.
Date 3/1/06
For Structural Drawings 208-215
Rev. 5-10-06

TYLIN INTERNATIONAL
PRINTED BY THE AUTHORITY OF THE STATE OF ILLINOIS

DISTRICT ONE DESIGN / PROJECT MANAGER:
BRIAN KUTTAB (847) 705 - 4431

SUMMARY OF QUANTITIES

| CODE NUMBER | ITEM DESCRIPTION | UNIT | TOTAL | URBAN - 90% FEDERAL, 10% STATE | | |
|-------------|---|-------|-------|--------------------------------|---------------------|--------------------|
| | | | | PCC PAVEMENT J000-2A | EM LIGHTING Y030-1E | IM SIGNING Y002-1C |
| 20100110 | TREE REMOVAL (6-15 UNITS DIAMETER) | UNIT | 25 | 25 | | |
| 20101000 | TEMPORARY FENCE | FOOT | 720 | 720 | | |
| 20200100 | EARTH EXCAVATION | CU YD | 41749 | 35,689 | | 6060 |
| 20201200 | REMOVAL AND DISPOSAL OF UNSUITABLE MATERIAL | CU YD | 2010 | 2010 | | |
| 20700420 | POROUS GRANULAR EMBANKMENT, SUBGRADE | CU YD | 944 | 944 | | |
| 20800150 | TRENCH BACKFILL | CU YD | 831 | 831 | | |
| 21001000 | GEOTECHNICAL FABRIC FOR GROUND STABILIZATION | SQ YD | 52950 | 44,550 | | 8400 |
| * 21101615 | TOPSOIL FURNISH AND PLACE, 4" | SQ YD | 13332 | 13332 | | |
| * 21101645 | TOPSOIL FURNISH AND PLACE, 12" | SQ YD | 2858 | 2858 | | |
| * 21101825 | COMPOST FURNISH AND PLACE, 6" | SQ YD | 2858 | 2858 | | |
| * 25000210 | SEEDING, CLASS 2A | ACRE | 3.00 | 3.00 | | |
| * 25000400 | NITROGEN FERTILIZER NUTRIENT | POUND | 272 | 272 | | |
| * 25000500 | PHOSPHORUS FERTILIZER NUTRIENT | POUND | 271 | 271 | | |
| * 25000600 | POTASSIUM FERTILIZER NUTRIENT | POUND | 271 | 271 | | |
| * 25000750 | MOWING | ACRE | 6.50 | 6.50 | | |
| * 25001800 | SEEDING, CLASS 4 (MODIFIED) | ACRE | 0.50 | 0.50 | | |
| * 25100630 | EROSION CONTROL BLANKET | SQ YD | 16126 | 16126 | | |
| * 25200200 | SUPPLEMENTAL WATERING | UNIT | 850 | 850 | | |
| * 28000200 | EARTH EXCAVATION FOR EROSION CONTROL | CU YD | 15 | 15 | | |
| * 28000250 | TEMPORARY EROSION CONTROL SEEDING | POUND | 230 | 230 | | |
| * 28000300 | TEMPORARY DITCH CHECKS | EACH | 14 | 14 | | |
| * 28000510 | INLET FILTERS | EACH | 13 | 13 | | |
| 28001000 | AGGREGATE (EROSION CONTROL) | TON | 1 | 1 | | |
| 31101860 | SUB-BASE GRANULAR MATERIAL, TYPE B 24" | SQ YD | 54150 | 45,750 | | 8400 |
| 42001300 | PROTECTIVE COAT | SQ YD | 56018 | 56018 | | |
| 42100380 | CONTINUOUSLY REINFORCED PORTLAND CEMENT CONCRETE PAVEMENT 14" | SQ YD | 39810 | 31,410 | | 8400 |
| 44000004 | BITUMINOUS SURFACE REMOVAL 1" | SQ YD | 7200 | 7200 | | |
| 44000006 | BITUMINOUS SURFACE REMOVAL 1 1/2" | SQ YD | 88 | 88 | | |
| 44000100 | PAVEMENT REMOVAL | SQ YD | 38721 | 38721 | | |
| 44000500 | COMBINATION CURB AND GUTTER REMOVAL | FOOT | 3571 | 3571 | | |
| 44001980 | CONCRETE BARRIER REMOVAL | FOOT | 751 | 751 | | |
| 44004250 | PAVED SHOULDER REMOVAL | SQ YD | 8529 | 5119 | | 3410 |

- * - SPECIALTY ITEM
- - IDOT PAY CODE SFTY-3N
- △ - IDOT PAY CODE Y080.
- - NON-PARTICIPATING

TYLIN INTERNATIONAL

| REVISIONS | |
|-----------|------|
| NAME | DATE |
| | |
| | |
| | |
| | |
| | |
| | |
| | |
| | |
| | |
| | |

ILLINOIS DEPARTMENT OF TRANSPORTATION
 F.A.I. 94 (DAN RYAN EXPRESSWAY)

SUMMARY OF QUANTITIES
 SHEET 1 OF 5

SCALE: NONE
 DATE: MARCH 1, 2006

DRAWN BY: MPG
 CHECKED BY: TGB

Rev. 5-10-06

SUMMARY OF QUANTITIES

| CODE NUMBER | ITEM DESCRIPTION | UNIT | TOTAL | URBAN - 90% FEDERAL, 10% STATE | | | |
|-------------|--|-------|-------|--------------------------------|------------------|----------------|-----------------|
| | | | | PCC PAVEMENT J000-2A | LIGHTING Y030-1E | I.T.S. Y032-1F | SIGNING Y002-1C |
| 44004260 | PAVED SHOULDER REMOVAL (SPECIAL) | SQ YD | 406 | 406 | | | |
| 44004400 | PAVEMENT REMOVAL (SPECIAL) | SQ YD | 1435 | 1435 | | | |
| 50200100 | STRUCTURE EXCAVATION | CU YD | 455 | 455 | | | |
| 50300225 | CONCRETE STRUCTURES | CU YD | 196 | 196 | | | |
| 50800205 | REINFORCEMENT BARS, EPOXY COATED | POUND | 47570 | 47570 | | | |
| 550A0340 | STORM SEWERS, CLASS A, TYPE 2 12" | FOOT | 2144 | 2144 | | | |
| 550A0360 | STORM SEWERS, CLASS A, TYPE 2 15" | FOOT | 343 | 343 | | | |
| 550A0380 | STORM SEWERS, CLASS A, TYPE 2 18" | FOOT | 335 | 335 | | | |
| 550A0410 | STORM SEWERS, CLASS A, TYPE 2 24" | FOOT | 433 | 433 | | | |
| 550A0680 | STORM SEWERS, CLASS A, TYPE 3 18" | FOOT | 162 | 162 | | | |
| 550A0710 | STORM SEWERS, CLASS A, TYPE 3 24" | FOOT | 60 | 60 | | | |
| 55100400 | STORM SEWER REMOVAL 10" | FOOT | 869 | 869 | | | |
| 55100500 | STORM SEWER REMOVAL 12" | FOOT | 1957 | 1957 | | | △ |
| 55100700 | STORM SEWER REMOVAL 15" | FOOT | 147 | 147 | | | |
| 60107700 | PIPE UNDERDRAINS 6" | FOOT | 9668 | 9668 | | | |
| 60108200 | PIPE UNDERDRAINS 6" (SPECIAL) | FOOT | 210 | 210 | | | |
| 60200105 | CATCH BASINS, TYPE A, 4'-DIAMETER, TYPE 1 FRAME, OPEN LID | EACH | 1 | 1 | | | |
| 60201310 | CATCH BASINS, TYPE A, 4'-DIAMETER, TYPE 20 FRAME AND GRATE | EACH | 52 | 52 | | | |
| 60206905 | CATCH BASINS, TYPE C, TYPE 1 FRAME, OPEN LID | EACH | 6 | 6 | | | |
| 60218400 | MANHOLES, TYPE A, 4'-DIAMETER, TYPE 1 FRAME, CLOSED LID | EACH | 3 | 3 | | | |
| 60221100 | MANHOLES, TYPE A, 5'-DIAMETER, TYPE 1 FRAME, CLOSED LID | EACH | 4 | 4 | | | |
| 60250200 | CATCH BASINS TO BE ADJUSTED | EACH | 27 | 27 | | | |
| 60252800 | CATCH BASINS TO BE RECONSTRUCTED | EACH | 2 | 2 | | | |
| 60255500 | MANHOLES TO BE ADJUSTED | EACH | 21 | 21 | | | |
| 60257900 | MANHOLES TO BE RECONSTRUCTED | EACH | 3 | 3 | | | |
| 60260100 | INLETS TO BE ADJUSTED | EACH | 2 | 2 | | | |
| 60500040 | REMOVING MANHOLES | EACH | 6 | 6 | | | |
| 60500050 | REMOVING CATCH BASINS | EACH | 54 | 54 | | | △ |
| 60500060 | REMOVING INLETS | EACH | 2 | 2 | | | |
| 60608521 | COMBINATION CONCRETE CURB AND GUTTER, TYPE M-2.24 | FOOT | 56.5 | 56.5 | | | |
| 60618324 | CONCRETE MEDIAN SURFACE, 6 INCH (SPECIAL) | SQ FT | 1108 | 1108 | | | |
| * 63100085 | TRAFFIC BARRIER TERMINAL, TYPE 6 | EACH | 2 | 2 | | | |

- * - SPECIALTY ITEM
- - IDOT PAY CODE SFTY-3N
- △ - IDOT PAY CODE Y080.
- - NON-PARTICIPATING

TYLIN INTERNATIONAL

| REVISIONS | |
|-----------|------|
| NAME | DATE |
| | |
| | |
| | |
| | |
| | |
| | |
| | |
| | |
| | |
| | |

ILLINOIS DEPARTMENT OF TRANSPORTATION
 F.A.I. 94 (DAN RYAN EXPRESSWAY)
 SUMMARY OF QUANTITIES
 SHEET 2 OF 5
 SCALE: NONE
 DATE: MARCH 1, 2006
 DRAWN BY: MPG
 CHECKED BY: TGB

△ Rev. 5-10-06

03/08/2006 12:45:31 PM

SUMMARY OF QUANTITIES

| CODE NUMBER | ITEM DESCRIPTION | UNIT | TOTAL | URBAN - 90% FEDERAL, 10% STATE | | | |
|-------------|---|-------|--------|--------------------------------|------------------|----------------|-----------------|
| | | | | PCC PAVEMENT J000-2A | LIGHTING Y030-1E | I.T.S. Y032-1F | SIGNING Y002-1C |
| * 63100167 | TRAFFIC BARRIER TERMINAL, TYPE 1, SPECIAL (TANGENT) | EACH | 2 | 2 | | | |
| 63200310 | GUARDRAIL REMOVAL | FOOT | 199 | 199 | | | |
| 63700805 | CONCRETE BARRIER TRANSITION | FOOT | 256 | 256 | | | |
| 64200105 | SHOULDER RUMBLE STRIP | FOOT | 9276 | 9276 | | | |
| * 66400560 | CHAIN LINK FENCE, 6' (SPECIAL) | FOOT | 5400 | 5400 | | | |
| * 66402900 | CHAIN LINK GATE, 6' X 6' SINGLE | EACH | 6 | 6 | | | |
| 66410300 | CHAIN LINK FENCE REMOVAL | FOOT | 72 | 72 | | | |
| * 66900200 | NON-SPECIAL WASTE DISPOSAL | CU YD | 11,600 | 11,600 | | | |
| * 66900450 | SPECIAL WASTE PLANS AND REPORTS | L SUM | 1 | 1 | | | |
| * 66900530 | SOIL DISPOSAL ANALYSIS | EACH | 2 | 2 | | | |
| 67100100 | MOBILIZATION | L SUM | 1 | 1 | | | |
| 70300240 | TEMPORARY PAVEMENT MARKING - LINE 6" | FOOT | 12540 | 12540 | | | |
| 70300520 | PAVEMENT MARKING TAPE, TYPE III, 4" | FOOT | 15556 | 15556 | | | |
| 70300530 | PAVEMENT MARKING TAPE, TYPE III, 5" | FOOT | 3795 | 3795 | | | |
| 70300550 | PAVEMENT MARKING TAPE, TYPE III, 8" | FOOT | 7510 | 7510 | | | |
| 70300560 | PAVEMENT MARKING TAPE, TYPE III, 12" | FOOT | 1028 | 1028 | | | |
| 70301000 | WORK ZONE PAVEMENT MARKING REMOVAL | SQ FT | 28397 | 28397 | | | |
| 70400100 | TEMPORARY CONCRETE BARRIER | FOOT | 6970 | 6970 | | | |
| 70400200 | RELOCATE TEMPORARY CONCRETE BARRIER | FOOT | 13030 | 13030 | | | |
| * 72000100 | SIGN PANEL - TYPE 1 | SQ FT | 20 | | | | 20 |
| * 72000200 | SIGN PANEL - TYPE 2 | SQ FT | 32 | | | | 32 |
| * 72000300 | SIGN PANEL - TYPE 3 | SQ FT | 75 | | | | 75 |
| * 72400720 | RELOCATE SIGN PANEL - TYPE 2 | SQ FT | 12 | | | | 12 |
| * 72800100 | TELESCOPING STEEL SIGN SUPPORT | FOOT | 14 | | | | 14 |
| * 73000100 | WOOD SIGN SUPPORT | FOOT | 120 | | | | 120 |
| * 73700300 | REMOVE CONCRETE FOUNDATION - OVERHEAD | EACH | 2 | | | | 2 |
| * 78005110 | EPOXY PAVEMENT MARKING - LINE 4" | FOOT | 18934 | 18934 | | | |
| * 78005120 | EPOXY PAVEMENT MARKING - LINE 5" | FOOT | 4424 | 4424 | | | |
| * 78005140 | EPOXY PAVEMENT MARKING - LINE 8" | FOOT | 8749 | 8749 | | | |
| * 78005150 | EPOXY PAVEMENT MARKING - LINE 12" | FOOT | 1608 | 1608 | | | |
| * 78008210 | POLYUREA PAVEMENT MARKING TYPE I - LINE 4" | FOOT | 9399 | 9399 | | | |
| * 78008220 | POLYUREA PAVEMENT MARKING TYPE I - LINE 5" | FOOT | 6649 | 6649 | | | |

- * - SPECIALTY ITEM
- - IDOT PAY CODE SFTY-3N
- △ - IDOT PAY CODE Y080.
- - NON-PARTICIPATING

TYLIN INTERNATIONAL

| REVISIONS | |
|-----------|------|
| NAME | DATE |
| | |
| | |
| | |
| | |
| | |
| | |
| | |
| | |
| | |
| | |

ILLINOIS DEPARTMENT OF TRANSPORTATION
 F.A.I. 94 (DAN RYAN EXPRESSWAY)

SUMMARY OF QUANTITIES
 SHEET 3 OF 5

SCALE: NONE
 DATE: MARCH 1, 2006

DRAWN BY: MPG
 CHECKED BY: TGB

Rev. 5-10-06

SUMMARY OF QUANTITIES

| CODE NUMBER | ITEM DESCRIPTION | UNIT | TOTAL | URBAN - 90% FEDERAL, 10% STATE | | |
|-----------------------------------|---|-----------------|-------------------|--------------------------------|---------------------|--------------------|
| | | | | IM FCC PAVEMENT J000-2A | IM LIGHTING Y030-1E | IM SIGNING Y002-1C |
| * X0325084 | CTA GATES | EACH | 6 | 6 | | |
| * X0325130 | TUBULAR TRAFFIC SIGN POST | EACH | 1 | | | 1 |
| X0712400 | TEMPORARY PAVEMENT | SQ YD | 2400 | 2400 | | |
| X4066426 | BITUMINOUS CONCRETE SURFACE COURSE, SUPERPAVE, MIX "D", N70 | TON | 8 | 8 | | |
| X4834090 | PORTLAND CEMENT CONCRETE SHOULDERS 14" | SQ YD | 9965 | 9965 | | |
| X6061001 | COMBINATION CONCRETE CURB AND GUTTER, TYPE M-4.48 | FOOT | 675.5 | 675.5 | | |
| X6063600 | COMBINATION CONCRETE CURB AND GUTTER, TYPE M-4.24 | FOOT | 1676.0 | 1676.0 | | |
| X6370910 | CONCRETE BARRIER, SINGLE FACE, 32 INCH HEIGHT | FOOT | 1249 | 1249 | | |
| X6370925 | CONCRETE BARRIER, SINGLE FACE, 42" (SPECIAL) | FOOT | 4846 | 4846 | | |
| X6640210 | TEMPORARY CHAIN LINK FENCE (PORTABLE) | FOOT | 775 | 775 | | |
| X7011015 | TRAFFIC CONTROL AND PROTECTION (EXPRESSWAYS) | L SUM | 1 | 1 | | |
| X7013820 | TRAFFIC CONTROL SURVEILLANCE, EXPRESSWAYS | CAL DA | 457 | 457 | | |
| X7015000 | CHANGEABLE MESSAGE SIGN | CAL MO | 64 | 64 | | |
| XX001854 | STABILIZED SUB-BASE, 6" | SQ YD | 52950 | 44,550 | | 8400 |
| XX004201 | PAVEMENT REINFORCEMENT 14" | SQ YD | 39810 | 31,410 | | 8400 |
| Z0002400 | BALLAST | TON | 1160 | 1160 | | |
| Z0013798 | CONSTRUCTION LAYOUT | L SUM | 1 | 1 | | |
| Z0013825 | CONTROLLED LOW-STRENGTH MATERIAL | CU YD | 7 | 7 | | |
| <input type="checkbox"/> Z0030250 | IMPACT ATTENUATORS, TEMPORARY (NON-REDIRECTIVE), TEST LEVEL 3 | EACH | 5 | 5 | | |
| <input type="checkbox"/> Z0030350 | IMPACT ATTENUATORS, RELOCATE (NON-REDIRECTIVE), TEST LEVEL 3 | EACH | 10 | 10 | | |
| Z0040590 | PIPE UNDERDRAIN REMOVAL | FOOT | 10,800 | 10,800 | | |
| Z0048665 | RAILROAD PROTECTIVE LIABILITY INSURANCE | L SUM | 1 | 1 | | |
| <input type="checkbox"/> Z0076600 | TRAINEES | HOUR | 2000 | 2000 | | |

- * - SPECIALTY ITEM
- IDOT PAY CODE SFTY-3N
- IDOT PAY CODE Y080.
- NON-PARTICIPATING

TYLIN INTERNATIONAL

| REVISIONS | |
|-----------|------|
| NAME | DATE |
| | |
| | |
| | |
| | |
| | |
| | |
| | |
| | |
| | |
| | |

ILLINOIS DEPARTMENT OF TRANSPORTATION
 F.A.I. 94 (DAN RYAN EXPRESSWAY)

SUMMARY OF QUANTITIES
 SHEET 5 OF 5

SCALE: NONE
 DATE: MARCH 1, 2006

DRAWN BY: MPG
 CHECKED BY: TGB

Rev. 5-10-06 Rev.

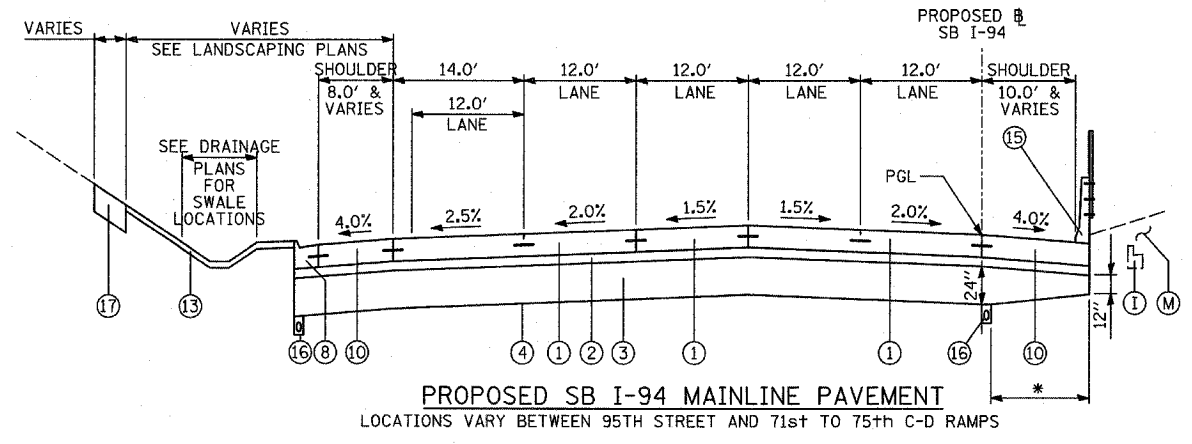
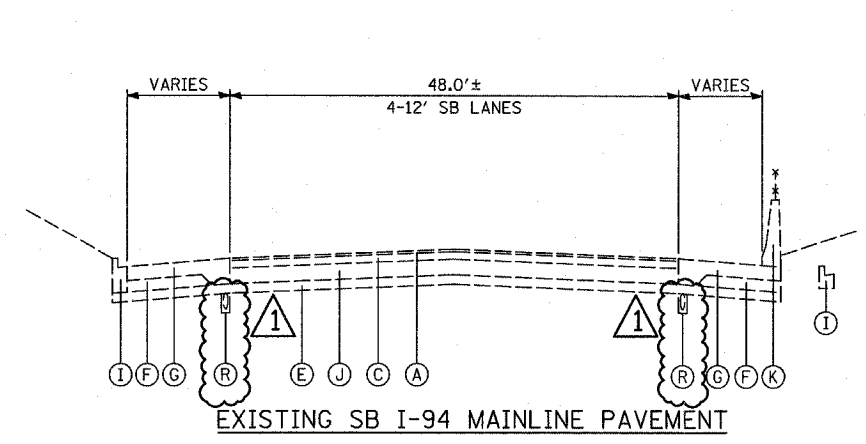

- ### PROPOSED LEGEND
- ① CONTINUOUSLY REINFORCED PORTLAND CEMENT CONCRETE PAVEMENT 14"; & PAVEMENT REINFORCEMENT, 14"
 - ② STABILIZED SUB-BASE, 6" (BITUMINOUS AGGREGATE MIXTURE)
 - ③ SUB-BASE GRANULAR MATERIAL, TYPE B 24"
 - ④ GEOTECHNICAL FABRIC FOR GROUND STABILIZATION
 - ⑤ CONCRETE MEDIAN SURFACE, 6 INCH (SPECIAL)
 - ⑥ CONCRETE MEDIAN SURFACE, 6 INCH (SPECIAL) (WITHOUT STAMPED PATTERN)
 - ⑦ COMBINATION CONCRETE CURB AND GUTTER, TYPE M-2.24
 - ⑧ COMBINATION CONCRETE CURB AND GUTTER, TYPE M-4.24
 - ⑨ COMBINATION CONCRETE CURB AND GUTTER, TYPE M-4.48
 - ⑩ PORTLAND CEMENT CONCRETE SHOULDERS 14"
 - ⑪ CONCRETE BARRIER, SINGLE FACE, 32 INCH HEIGHT; BARRIER BASE; BARRIER WALL MARKERS (PER IDOT STD. 635001 & 635006)
 - ⑫ TRAFFIC BARRIER TERMINAL, TYPE VARIES
 - ⑬ TOPSOIL FURNISH AND PLACE, 4"; SEEDING, CLASS 2A; EROSION CONTROL BLANKET
 - ⑭ AGGREGATE FILL (INCLUDED IN THE COST OF "CONCRETE MEDIAN SURFACE, 6" (SPECIAL)") (MATCH DEPTH TO ADJACENT CURB & GUTTER)
 - ⑮ CONCRETE BARRIER, SINGLE FACE, 42 INCH HEIGHT (SPECIAL); BARRIER BASE; CTA FENCE (SEE DETAILS); BARRIER WALL MARKERS (PER IDOT STD. 635001 & 635006)
 - ⑯ PIPE UNDERDRAIN, 6" (SEE DETAILS)
 - ⑰ TOPSOIL FURNISH AND PLACE, 12"; COMPOST FURNISH AND PLACE, 6"; EROSION CONTROL BLANKET; SEEDING (SEE PLAN FOR CLASS)
 - ⑱ ELECTRICAL DUCTBANK (SEE ELECTRICAL INFRASTRUCTURE PLANS)
 - ⑲ CONCRETE BARRIER, SINGLE FACE, 32 INCH HEIGHT (MODIFIED); BARRIER BASE; BARRIER WALL MARKERS (PER IDOT STD. 635001 & 635006)
 - ⑳ PORTLAND CEMENT CONCRETE SHOULDERS 9"
 - ㉑ 1 1/2" SHOULDER RESURFACING; BITUMINOUS CONCRETE SURFACE COURSE, SUPERPAVE, MIX "D", N70, 1 1/2"
 - ㉒ 1 3/4" SHOULDER RESURFACING; BITUMINOUS CONCRETE SURFACE COURSE, SUPERPAVE, MIX "D", N70, 1 3/4"
 - ㉓ 1 3/4" MAINLINE RESURFACING; POLYMERIZED BITUMINOUS CONCRETE SURFACE COURSE, SUPERPAVE, MIX "F", N105, 1 3/4"
 - ㉔ 4" MAINLINE RESURFACING; POLYMERIZED BITUMINOUS CONCRETE SURFACE COURSE, SUPERPAVE, MIX "F", N105, 1 3/4"; POLYMERIZED BITUMINOUS CONCRETE BINDER COURSE, SUPERPAVE, IL-19, N105, 2 1/4"
 - ㉕ PORTLAND CEMENT CONCRETE PAVEMENT, 14" (JOINTED)

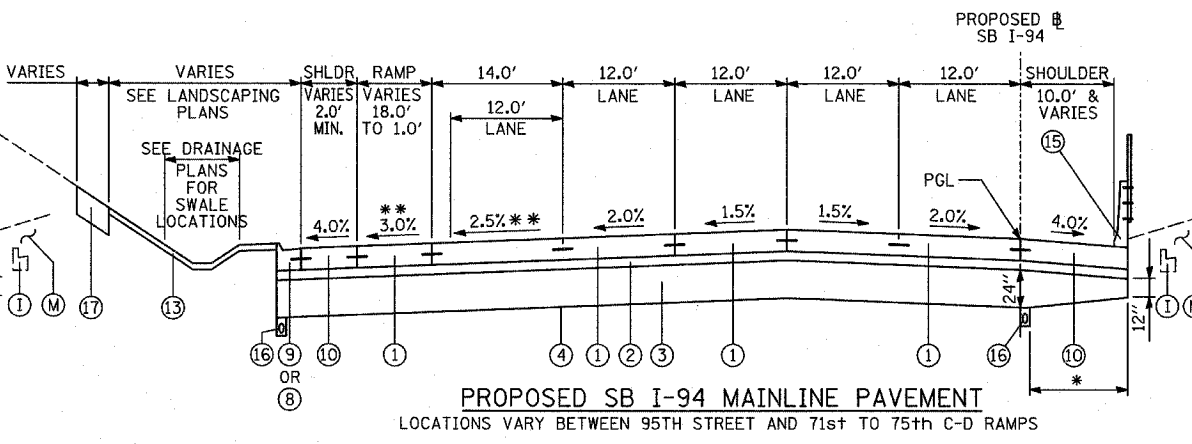
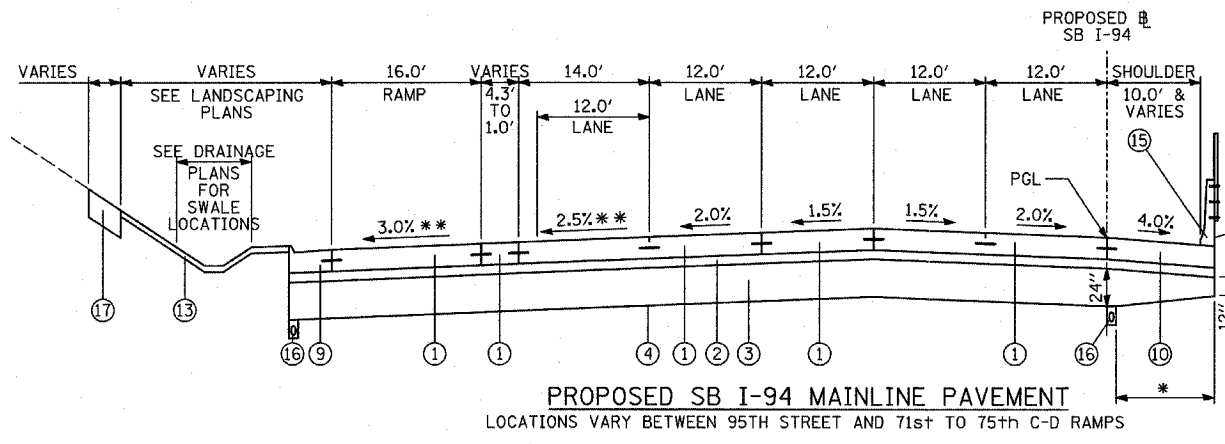
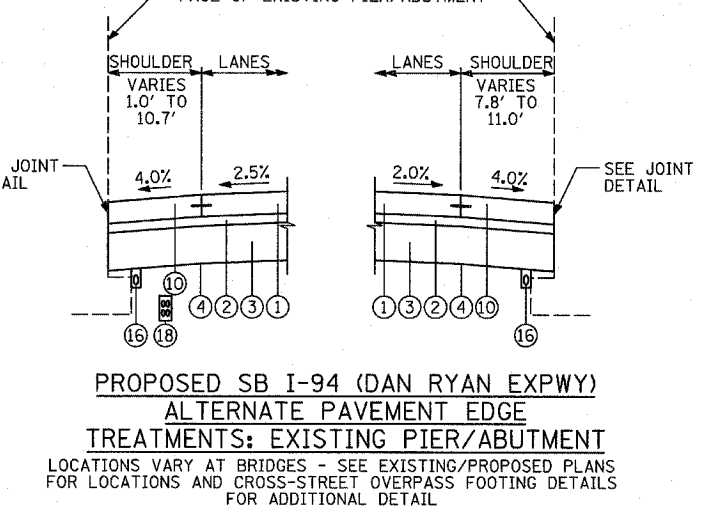
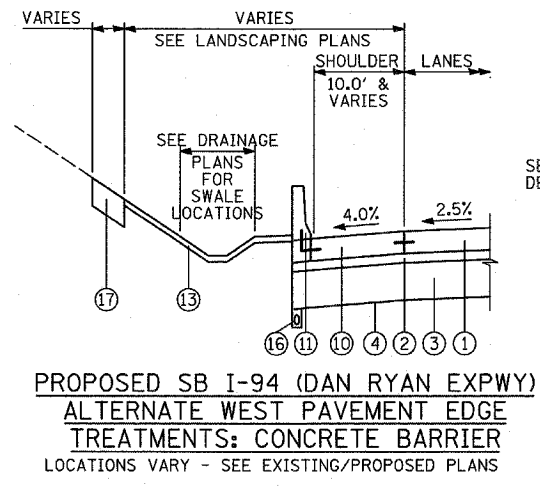
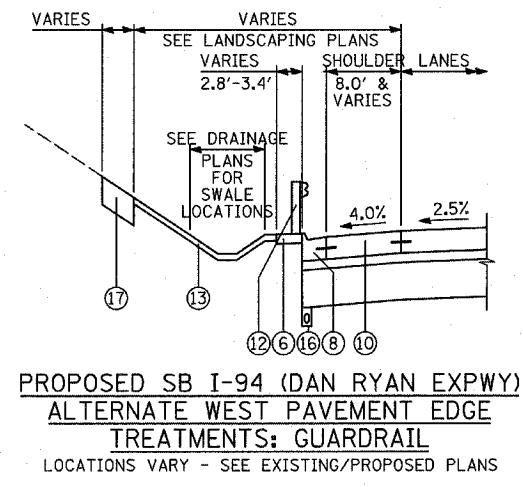

- ### EXISTING LEGEND
- ALL EXISTING PAVEMENT DEPTHS ARE FROM AS-BUILT PLANS AND ARE SUBJECT TO CHANGE
- (A) BIT CONC SURFACE COURSE, 1 1/2" ±
 - (B) BIT CONC BINDER COURSE, 1 1/2" ±
 - (C) BIT CONC BINDER COURSE, 3/4" ±
 - (D) SUB-BASE GRANULAR MATERIAL, 4" ±
 - (E) SUB-BASE GRANULAR MATERIAL, 6" ±
 - (F) CRUSHED STONE, 5" ±
 - (G) PCC SHOULDERS, 9" ±
 - (H) PCC BASE COURSE, 9" ±
 - (I) COMB CONC CURB & GUTTER
 - (J) PCC PAVEMENT, 10" ± (W/ PAVEMENT FABRIC, 80 LBS ±/100 SF)
 - (K) CONCRETE BARRIER WALL
 - (L) PCC SHOULDERS, 11" ±
 - (M) CTA BALLAST STONE; REGRADE AS NECESSARY (INCLUDE REGRADING IN THE COST OF "CONCRETE BARRIER, SINGLE FACE, 42 INCH HEIGHT (SPECIAL)")
 - (N) JOINTED PCC PAVEMENT, 11" ±
 - (O) STABILIZED SUB-BASE, 4" ±
 - (P) SUB-BASE GRANULAR MATERIAL, 24" ±
 - (Q) SUB-BASE GRANULAR MATERIAL, 12" ±

NOTES:

1. REFER TO PAVEMENT JOINTING AND ELEVATION PLANS FOR DESCRIPTIONS AND DETAILS OF PAVEMENT JOINTS.
- * - VARYING DEPTH PAID FOR AS "SUB-BASE GRANULAR MATERIAL, TYPE B 24"
- ** - CROSS-SLOPES VARY AT 87TH STREET ENTRANCE RAMP

| REVISIONS | |
|-----------|------|
| NAME | DATE |
| | |
| | |
| | |
| | |
| | |
| | |

ILLINOIS DEPARTMENT OF TRANSPORTATION
F.A.I. 94 (DAN RYAN EXPRESSWAY)
EXISTING & PROPOSED TYPICAL SECTIONS
SB I-94 (DAN RYAN EXPRESSWAY)
(SHEET 1 OF 2)

SCALE: NONE DRAWN BY: MPG
DATE: MARCH 1, 2006 CHECKED BY: TGB

TYLIN INTERNATIONAL

| F.A.I. RTE. | SECTION | COUNTY | TOTAL SHEETS | SHEET NO. |
|---------------------|----------|---------------------------|--------------|-----------|
| 94 | 1818 R-6 | COOK | 290 | 13 |
| STA. 1313+00 | | TO STA. 1367+00 | | |
| FED. ROAD DIST. NO. | | ILLINOIS FED. AID PROJECT | | 60B18 |

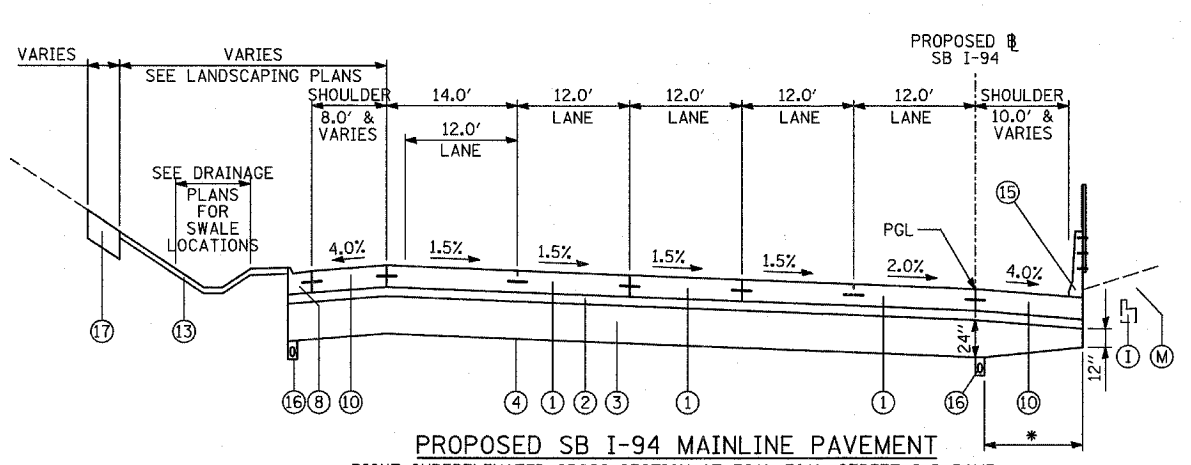
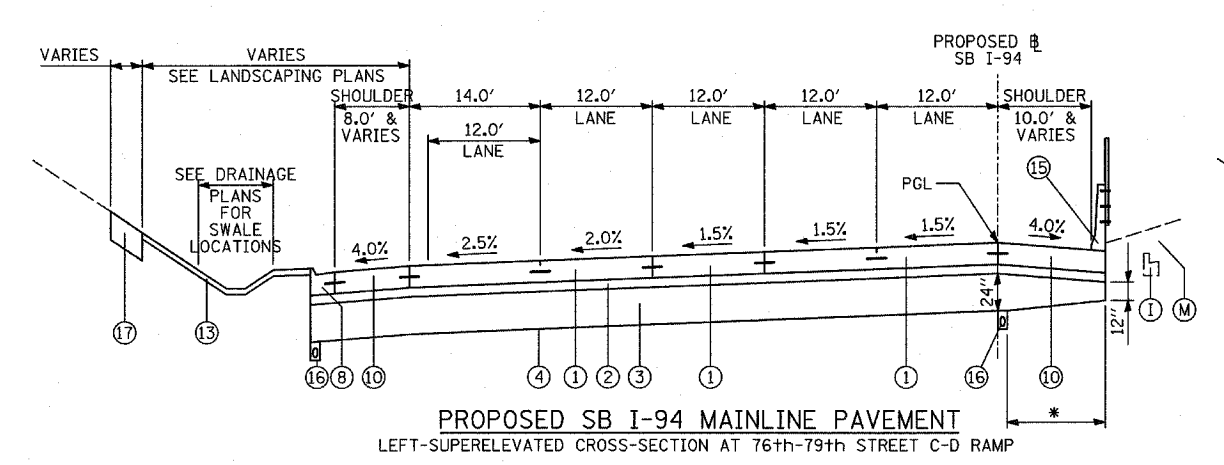
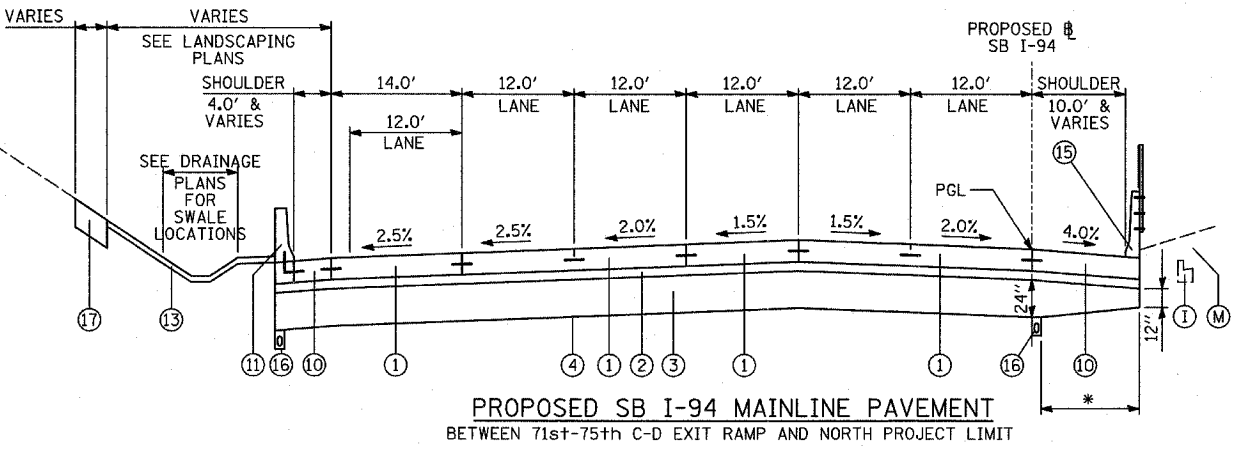
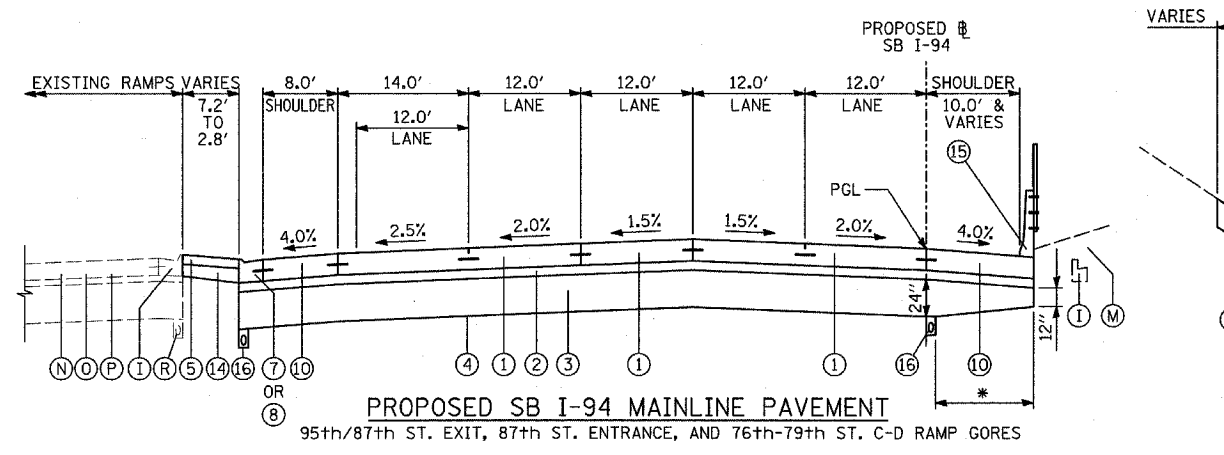
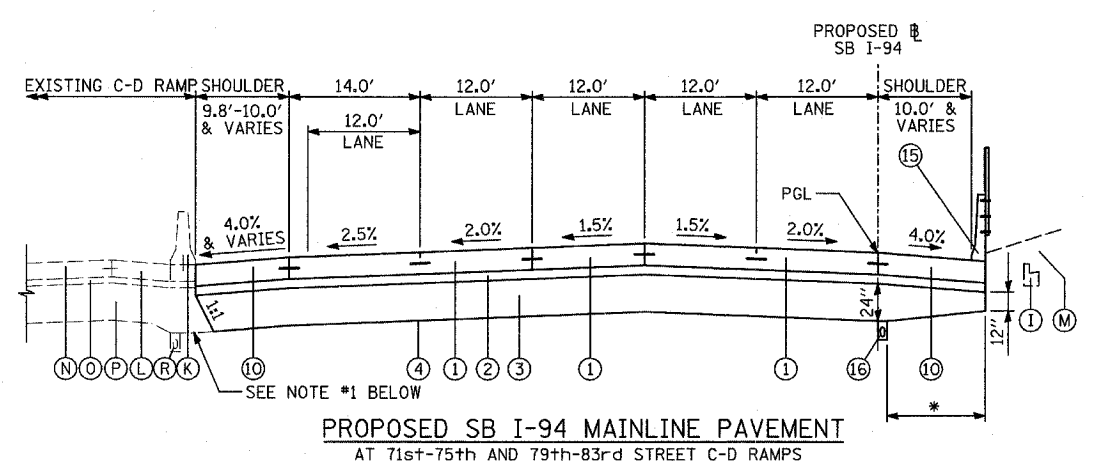
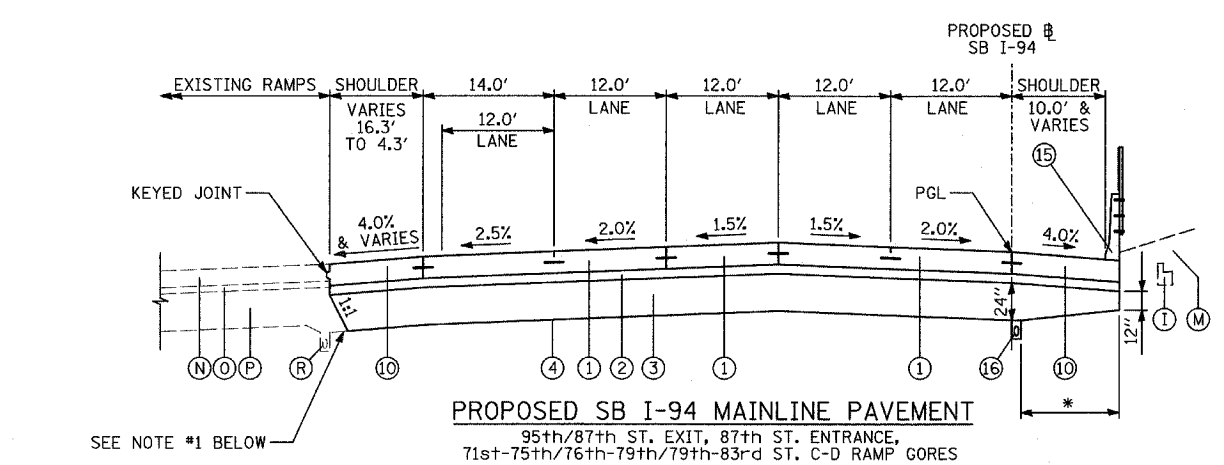

PROPOSED LEGEND

- 1 CONTINUOUSLY REINFORCED PORTLAND CEMENT CONCRETE PAVEMENT 14" & PAVEMENT REINFORCEMENT, 14"
- 2 STABILIZED SUB-BASE, 6" (BITUMINOUS AGGREGATE MIXTURE)
- 3 SUB-BASE GRANULAR MATERIAL, TYPE B 24"
- 4 GEOTECHNICAL FABRIC FOR GROUND STABILIZATION
- 5 CONCRETE MEDIAN SURFACE, 6 INCH (SPECIAL)
- 6 CONCRETE MEDIAN SURFACE, 6 INCH (SPECIAL) (WITHOUT STAMPED PATTERN)
- 7 COMBINATION CONCRETE CURB AND GUTTER, TYPE M-2.24
- 8 COMBINATION CONCRETE CURB AND GUTTER, TYPE M-4.24
- 9 COMBINATION CONCRETE CURB AND GUTTER, TYPE M-4.48
- 10 PORTLAND CEMENT CONCRETE SHOULDERS 14"
- 11 CONCRETE BARRIER, SINGLE FACE, 32 INCH HEIGHT; BARRIER BASE; BARRIER WALL MARKERS (PER IDOT STD. 635001 & 635006)
- 12 TRAFFIC BARRIER TERMINAL, TYPE VARIES
- 13 TOPSOIL FURNISH AND PLACE, 4"; SEEDING, CLASS 2A; EROSION CONTROL BLANKET
- 14 AGGREGATE FILL (INCLUDED IN THE COST OF "CONCRETE MEDIAN SURFACE, 6" (SPECIAL)") (MATCH DEPTH TO ADJACENT CURB & GUTTER)
- 15 CONCRETE BARRIER, SINGLE FACE, 42 INCH HEIGHT (SPECIAL); BARRIER BASE; CTA FENCE (SEE DETAILS); BARRIER WALL MARKERS (PER IDOT STD. 635001 & 635006)
- 16 PIPE UNDERDRAIN, 6" (SEE DETAILS)
- 17 TOPSOIL FURNISH AND PLACE, 12"; COMPOST FURNISH AND PLACE, 6"; EROSION CONTROL BLANKET; SEEDING (SEE PLAN FOR CLASS)
- 18 ELECTRICAL DUCTBANK (SEE ELECTRICAL INFRASTRUCTURE PLANS)
- 19 CONCRETE BARRIER, SINGLE FACE, 32 INCH HEIGHT (MODIFIED); BARRIER BASE; BARRIER WALL MARKERS (PER IDOT STD. 635001 & 635006)
- 20 PORTLAND CEMENT CONCRETE SHOULDERS 9"
- 21 1/2" SHOULDER RESURFACING: BITUMINOUS CONCRETE SURFACE COURSE, SUPERPAVE, MIX "D", N70, 1/2"
- 22 1 3/4" SHOULDER RESURFACING: BITUMINOUS CONCRETE SURFACE COURSE, SUPERPAVE, MIX "D", N70, 1 3/4"
- 23 1 3/4" MAINLINE RESURFACING: POLYMERIZED BITUMINOUS CONCRETE SURFACE COURSE, SUPERPAVE, MIX "E", N105, 1 3/4"
- 24 4" MAINLINE RESURFACING: POLYMERIZED BITUMINOUS CONCRETE SURFACE COURSE, SUPERPAVE, MIX "F", N105, 1 3/4"; POLYMERIZED BITUMINOUS CONCRETE BINDER COURSE, SUPERPAVE, IL-19, N105, 2 1/4"
- 25 PORTLAND CEMENT CONCRETE PAVEMENT, 14" (JOINTED)

EXISTING LEGEND ALL EXISTING PAVEMENT DEPTHS ARE FROM AS-BUILT PLANS AND ARE SUBJECT TO CHANGE

- (A) BIT CONC SURFACE COURSE, 1 1/2"±
- (B) BIT CONC BINDER COURSE, 1 1/2"±
- (C) BIT CONC BINDER COURSE, 4 3/4"±
- (D) SUB-BASE GRANULAR MATERIAL, 4"±
- (E) SUB-BASE GRANULAR MATERIAL, 6"±
- (F) CRUSHED STONE, 5"±
- (G) PCC SHOULDERS, 9"±
- (H) PCC BASE COURSE, 9"±
- (I) COMB CONC CURB & GUTTER
- (J) PCC PAVEMENT, 10"± (W/ PAVEMENT FABRIC, 80 LBS±/100 SF)
- (K) CONCRETE BARRIER WALL
- (L) PCC SHOULDERS, 11"±
- (M) CTA BALLAST STONE; REGRADE AS NECESSARY (INCLUDE REGADING IN THE COST OF "CONCRETE BARRIER, SINGLE FACE, 42 INCH HEIGHT (SPECIAL)")
- (N) JOINTED PCC PAVEMENT, 11"±
- (O) STABILIZED SUB-BASE, 4"±
- (P) SUB-BASE GRANULAR MATERIAL, 24"±
- (Q) SUB-BASE GRANULAR MATERIAL, 12"±

NOTES:

1. REFER TO PAVEMENT JOINTING AND ELEVATION PLANS FOR DESCRIPTIONS AND DETAILS OF PAVEMENT JOINTS.
 2. ANY REQUIRED REGADING OF EXISTING ADJACENT SUB-BASE GRANULAR MATERIAL SHALL BE INCLUDED IN THE COST OF "SUB-BASE GRANULAR MATERIAL, TYPE B 24"
- * - VARYING DEPTH PAID FOR AS "SUB-BASE GRANULAR MATERIAL, TYPE B 24"

| REVISIONS | |
|-----------|------|
| NAME | DATE |
| | |
| | |
| | |
| | |
| | |
| | |
| | |

ILLINOIS DEPARTMENT OF TRANSPORTATION
F.A.I. 94 (DAN RYAN EXPRESSWAY)

PROPOSED TYPICAL SECTIONS
SB I-94 (DAN RYAN EXPRESSWAY)
(SHEET 2 OF 2)

SCALE: NONE
DRAWN BY: MPG
DATE: MARCH 1, 2006
CHECKED BY: TGB

TYLIN INTERNATIONAL

| F.A.I. RTE. | SECTION | COUNTY | TOTAL SHEETS | SHEET NO. |
|---------------------|----------|------------------|--------------|-----------|
| 94 | 1818 R-6 | COOK | 290 | 85 |
| STA. 1313+00 | | TO STA. 1367+00 | | |
| FED. ROAD DIST. NO. | ILLINOIS | FED. AID PROJECT | | |

60B18

GENERAL NOTES:

SEE SPECIAL PROVISION TITLED TRAFFIC CONTROL AND PROTECTION (EXPRESSWAYS)
A WORK ZONE SPEED LIMIT OF 45 M.P.H. MUST BE MAINTAINED AT ALL TIMES.
QUANTITY FOR TEMPORARY PAVEMENT MARKING - LINE 6" WAS ASSUMED EQUAL TO THE LENGTH OF TEMPORARY CONCRETE BARRIER, UTILIZED WHEN THE BARRIER IS LOCATED ONE FOOT OR LESS FROM THE EDGE OF TRAVELED WAY.
ALL TEMPORARY PAVEMENT MARKINGS PLACED DURING THE WINTER LANE CONFIGURATION OR ON EXISTING PAVEMENT SHALL BE PAID FOR AS EPOXY PAVEMENT MARKING OF THE LINE TYPE AND WIDTH SPECIFIED.
ALL TEMPORARY PAVEMENT MARKINGS PLACED ON NEW PAVEMENT SHALL BE PAID FOR AS PAVEMENT MARKING TAPE, TYPE III OF THE LINE TYPE AND WIDTH SPECIFIED EXCEPT WHEN DIRECTED OTHERWISE.
A TOTAL OF 4 CHANGEABLE MESSAGE SIGNS SHALL BE LOCATED ALONG THE MAINLINE AND NEAR RAMP CLOSURES FOR THE DURATION OF THIS CONTRACT. EXACT PLACEMENT OF THE SIGNS SHALL BE DETERMINED BY THE RESIDENT ENGINEER.
ANY RAISED REFLECTIVE PAVEMENT MARKERS THAT CONFLICT WITH THE TEMPORARY TRAFFIC LANES MUST HAVE THE REFLECTIVE LENSES REMOVED AS DIRECTED BY THE RESIDENT ENGINEER. MEASURE OF PAYMENT FOR REMOVAL OF REFLECTORS IS INCLUDED IN THE CONTRACT UNIT PRICE FOR TRAFFIC CONTROL AND PROTECTION (EXPRESSWAYS).
ALL CONSTRUCTION VEHICLES MUST STAY WITHIN THE HAUL ROAD. CROSSING EXIT RAMP TRAFFIC IS PROHIBITED.
THE CONTRACTOR SHALL BE RESPONSIBLE TO DIFFERENTIATE BETWEEN THE RAMP EXIT AND HAUL ROAD ENTRANCE.
THE CONTRACTOR SHALL UTILIZE EITHER THE A.I.S. OR C-D ROADWAY TO MERGE HAUL ROAD AND RAMP TRAFFIC AT ALL EXIT RAMP LOCATIONS. A STOP SIGN SHALL BE PLACED AT THE UPSTREAM END OF THE C-D ROADWAY TO STOP TRAFFIC ON THE RAMP FROM THE FRONTAGE ROAD.
ALL SIGNING FROM DISTRICT 1 DETAIL TC-18 SHALL BE APPLIED TO ALL WORK ZONE ACCESS OPTIONS WHICH MAY BE USED BY THE CONTRACTOR.
FOR ACCESS CONTROL, THE CONTRACTOR IS REQUIRED TO PLACE CHAIN LINK FENCE 6' (SPECIAL), 7'-2" CLEAR FROM THE CENTERLINE OF CTA TRACK, PRIOR TO REMOVING EXISTING CTA CHAIN LINK FENCE AND BARRIER WALL. THE CONTRACTOR MUST ALSO PLACE CHAIN LINK GATES, 6' X 6' SINGLE AT ALL LOCATIONS WHERE THERE ARE EXISTING CTA FENCE GATES. THE CHAIN LINK FENCE 6' (SPECIAL) MUST REMAIN IN PLACE UNTIL THE NEW PERMANENT CTA FENCE IS COMPLETED.
SEE MISCELLANEOUS DETAILS FOR MAINLINE TEMPORARY PAVEMENT AND MILLING OPERATIONS FOR THE POST-STAGE 1 WINTER LANE CONFIGURATION.
THE RESIDENT ENGINEER SHALL ASSESS THE EXISTING CONDITION OF THE PAVEMENT LOCATED ALONG THE INSIDE SHOULDER. DAMAGED AREAS WILL REQUIRE SHOULDER REHABILITATION INCLUDING MILLING AND RESURFACING. ADDITIONAL QUANTITIES OF 88 SQ YD FOR BITUMINOUS SURFACE REMOVAL 1 1/2" AND 8.0 TONS FOR BITUMINOUS CONCRETE SURFACE COURSE, SUPERPAVE, MIX "D", N70 HAVE BEEN INCLUDED IN THE PLANS.

CONSTRUCTION STAGING NOTES

PRE STAGE 1 - NIGHT TIME OPERATIONS

INSTALL RAMP CLOSURE ADVANCE INFORMATION SIGNS ON STAGE 1 RAMP CLOSURES A MINIMUM OF 2 WEEKS IN ADVANCE OF THE CLOSURE. SEE STAGE 1 RAMP CLOSURE GUIDELINES IN THE SPECIAL PROVISIONS.
COORDINATE 3 LANES OF TRAFFIC AT SB I-94 (DAN RYAN) STA. 1313+00 WITH CONTRACT #62593 IN ORDER TO MAINTAIN TRAFFIC FLOW.
COORDINATE MULTI-LANE WEAVE AT SB I-94 (DAN RYAN) STA. 1367+00 WITH CONTRACT #62302 IN ORDER TO MAINTAIN TRAFFIC FLOW.
COMPLETE SHOULDER REHABILITATION FOR AREAS OF DAMAGED PAVEMENT PRIOR TO SHIFTING TRAFFIC.
REMOVE EXISTING PAVEMENT MARKINGS AND REPLACE WITH EPOXY PAVEMENT MARKINGS.
REMOVE LENSES FROM RAISED REFLECTIVE PAVEMENT MARKERS.
INSTALL TEMPORARY CONCRETE BARRIER WALL AND REMAINING TEMPORARY TRAFFIC CONTROL DEVICES FOR STAGE 1 CONSTRUCTION.

COVER PERMANENT AND TEMPORARY SIGNS AS NEEDED.

STAGE 1 CONSTRUCTION (FALL 2006)

STAGE 1 CONSTRUCTS LANES 4, 5, & THE OUTSIDE SHOULDER ALONG THE MAINLINE SB I-94 (DAN RYAN).
MAINLINE SB I-94 (DAN RYAN) TRAFFIC WILL BE SHIFTED LEFT TO THE INSIDE SHOULDER IN 3-11' LANES.

PRE STAGE WINTER LANE CONFIGURATION - NIGHT TIME OPERATIONS

PERFORM TEMPORARY PAVEMENT AND COLD MILLING OPERATIONS ALONG SB I-94 (DAN RYAN) PRIOR TO THE START OF THE WINTER LANE CONFIGURATION.
COORDINATE 4 LANES OF TRAFFIC AT SB I-94 (DAN RYAN) STA. 1313+00 WITH CONTRACT #62593 IN ORDER TO MAINTAIN TRAFFIC FLOW.
COORDINATE MULTI-LANE WEAVE AT SB I-94 (DAN RYAN) STA. 1367+00 WITH CONTRACT #62302 IN ORDER TO MAINTAIN TRAFFIC FLOW.
REMOVE CONFLICTING TEMPORARY PAVEMENT MARKINGS FROM STAGE 1 AND REPLACE WITH EPOXY PAVEMENT MARKINGS.
RELOCATE TEMPORARY CONCRETE BARRIER WALL TO CREATE ADEQUATE SHOULDERS FOR SNOW STORAGE AND RELOCATE REMAINING TEMPORARY TRAFFIC CONTROL DEVICES FOR THE WINTER LANE CONFIGURATION.
COVER & UNCOVER PERMANENT AND TEMPORARY SIGNS AS NEEDED.

PRE STAGE 2 - NIGHT TIME OPERATIONS

COORDINATE 3 LANES OF SPLIT TRAFFIC AT SB I-94 (DAN RYAN) STA. 1313+00 WITH CONTRACT #62593 IN ORDER TO MAINTAIN TRAFFIC FLOW.
COORDINATE MULTI-LANE WEAVE AND TRAFFIC SPLIT AT SB I-94 (DAN RYAN) STA. 1378+90 WITH CONTRACTS #60A63 AND #62303 IN ORDER TO MAINTAIN TRAFFIC FLOW.
REMOVE CONFLICTING TEMPORARY PAVEMENT MARKINGS FROM THE WINTER LANE CONFIGURATION AND REPLACE WITH EPOXY OR PAVEMENT MARKING TAPE DEPENDING IF THE PAVEMENT IS EXISTING, NEWLY BUILT, OR UNLESS DIRECTED OTHERWISE.
RELOCATE TEMPORARY CONCRETE BARRIER WALL AND REMAINING TEMPORARY TRAFFIC CONTROL DEVICES FOR STAGE 2.

COVER & UNCOVER PERMANENT AND TEMPORARY SIGNS AS NEEDED.

STAGE 2 CONSTRUCTION (SPRING 2007)

STAGE 2 CONSTRUCTS LANE 3 ALONG THE MAINLINE SB I-94 (DAN RYAN) FROM STA. 1313+00 TO STA. 1367+00.
MAINLINE SB I-94 (DAN RYAN) TRAFFIC WILL BE SPLIT INTO 2-11' EXPRESS LANES SHIFTED LEFT TO THE INSIDE SHOULDER AND 1-11' LOCAL LANE SHIFTED RIGHT TO THE OUTSIDE SHOULDER.

PRE STAGE 3 - NIGHT TIME OPERATIONS

COORDINATE 3 LANES OF TRAFFIC AT SB I-94 (DAN RYAN) STA. 1313+00 WITH CONTRACT #62593 IN ORDER TO MAINTAIN TRAFFIC FLOW.
COORDINATE MULTI-LANE WEAVE AT SB I-94 (DAN RYAN) STA. 1379+60 WITH CONTRACTS #60A63 AND #62303 IN ORDER TO MAINTAIN TRAFFIC FLOW.
REMOVE CONFLICTING TEMPORARY PAVEMENT MARKINGS FROM STAGE 2 AND REPLACE WITH PAVEMENT MARKING TAPE.
RELOCATE TEMPORARY CONCRETE BARRIER WALL AND REMAINING TEMPORARY TRAFFIC CONTROL DEVICES FOR STAGE 3.

COVER & UNCOVER PERMANENT AND TEMPORARY SIGNS AS NEEDED.

STAGE 3 CONSTRUCTION (SUMMER AND FALL 2007)

STAGE 3 CONSTRUCTS LANES 1, 2, & THE INSIDE SHOULDER ALONG THE MAINLINE SB I-94 (DAN RYAN) FROM STA. 1313+00 TO STA. 1367+00.
MAINLINE SB I-94 (DAN RYAN) TRAFFIC WILL BE SHIFTED RIGHT TO THE OUTSIDE SHOULDER IN 3-11' LANES.

TEMPORARY INFORMATION SIGNING
AREA = 32.0 SF

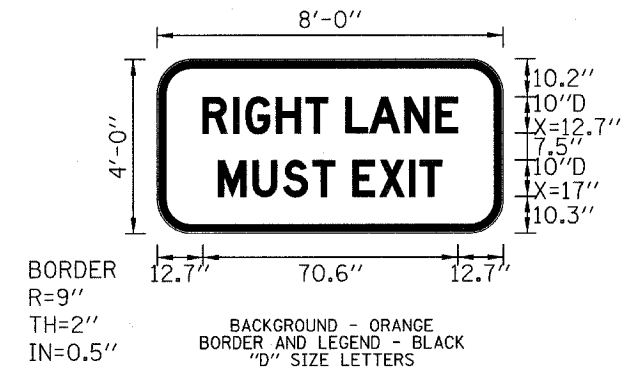

"RIGHT LANE MUST EXIT" SIGN DETAIL

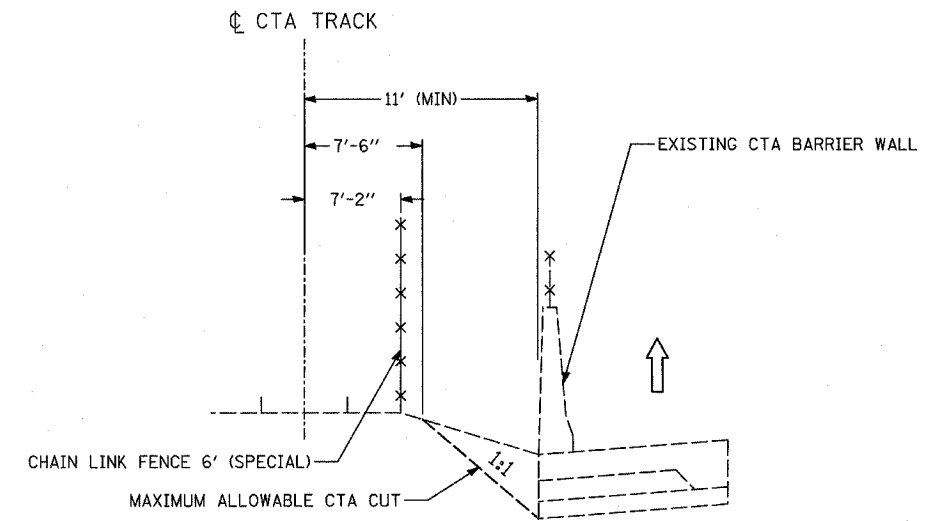

LOCATION OF CHAIN LINK FENCE 6' (SPECIAL)

| REVISIONS | |
|-----------|------|
| NAME | DATE |
| | |
| | |
| | |
| | |
| | |
| | |
| | |
| | |
| | |
| | |
| | |
| | |

ILLINOIS DEPARTMENT OF TRANSPORTATION
F.A.I. 94 (DAN RYAN EXPRESSWAY)
GENERAL NOTES
CONSTRUCTION STAGING NOTES
MAINTENANCE OF TRAFFIC DETAILS
SHEET 1 OF 4

SCALE: NO SCALE
DATE: MARCH 1, 2006
DRAWN BY: RTM
CHECKED BY: TGB

| | | | | |
|---------------------|----------|------------------|--------------|-----------|
| F.A.I. RTE. | SECTION | COUNTY | TOTAL SHEETS | SHEET NO. |
| 94 | 1818 R-6 | COOK | 290 | 119 |
| STA. 1313+00 | | TO STA. 1367+00 | | |
| FED. ROAD DIST. NO. | ILLINOIS | FED. AID PROJECT | | |

60B18

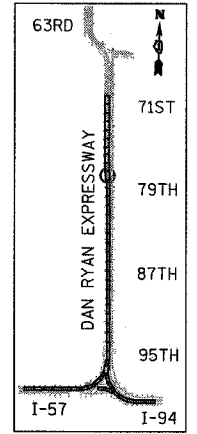
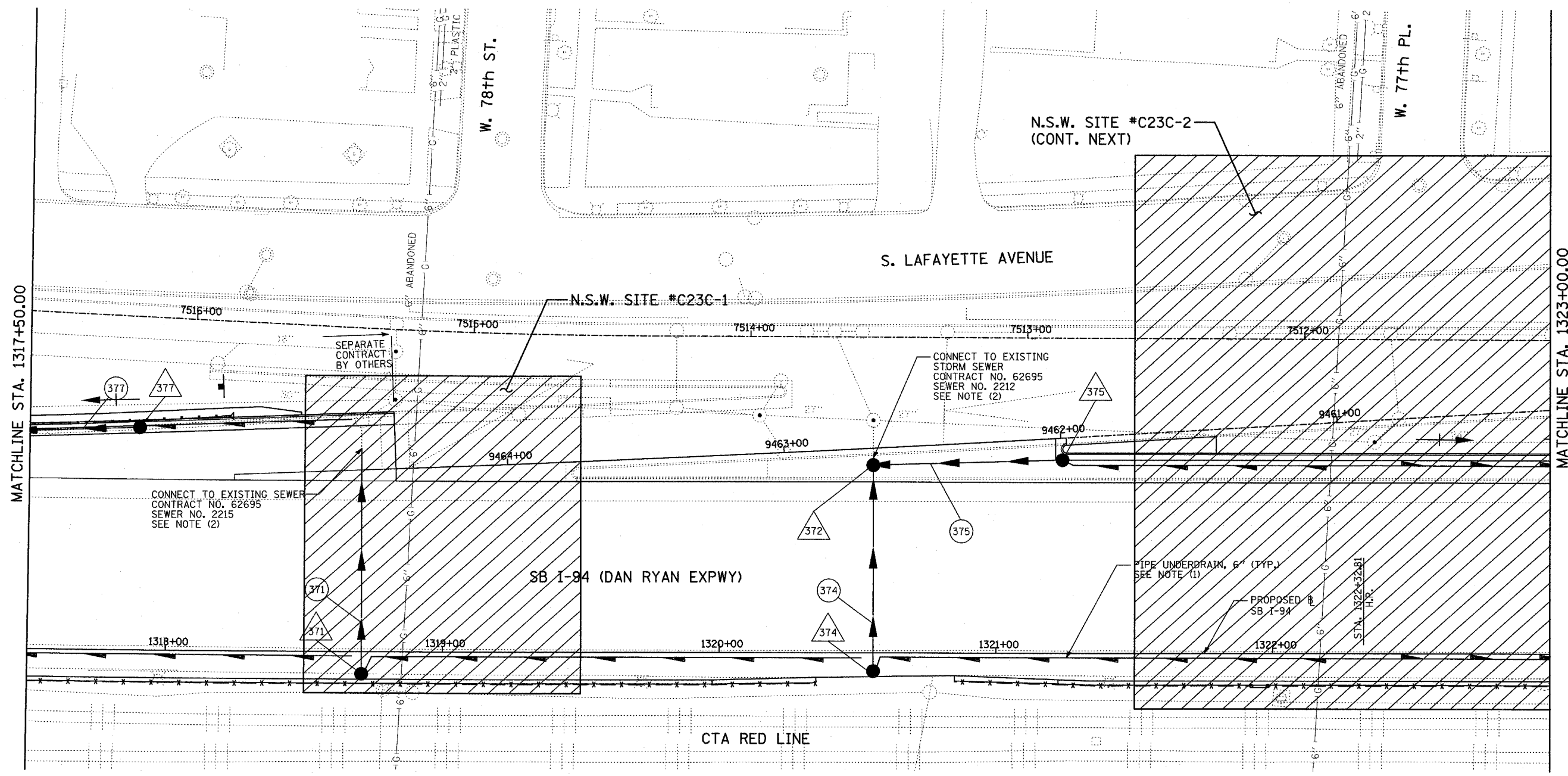
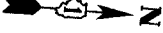

LOCATION MAP

1 NSW - NON SPECIAL WASTE SITES ADDED TO SHEET

LEGEND:

- EXISTING COMBINED SEWER
- (XY) PROPOSED STORM SEWER NUMBER (X=SHEET NO., Y=PIPE NO.)
- (XY) PROPOSED STRUCTURE NUMBER (X=SHEET NO., Y=STRUCTURE NO.)
- S- PIPE STUBOUT TO BE PLUGGED
- P SEWER PLUG
- F.V. FIELD VERIFY
- ////// UTILITY REMOVAL

NOTES:

1. FOR CLARITY, PIPE UNDERDRAINS ARE SHOWN OFFSET FROM THEIR PROPOSED LOCATIONS. FOR DETAILED PLACEMENT, SEE SHEET "PIPE UNDERDRAINS DETAIL."
2. COST SHALL NOT BE PAID FOR SEPARATELY BUT INCLUDED IN COST OF SEWER INSTALLATION.

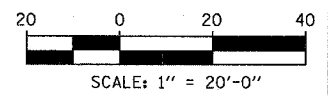

SHEET 37 OF 65

| REVISIONS | |
|-----------|------|
| NAME | DATE |
| | |
| | |
| | |
| | |
| | |
| | |

ILLINOIS DEPARTMENT OF TRANSPORTATION
 F.A.I. 94 (DAN RYAN EXPRESSWAY)
 DRAINAGE AND UTILITY PROPOSED PLAN
 SB I-94 (DAN RYAN EXPRESSWAY)
 DAN RYAN STA. 1317+50.00 TO 1323+00.00

SCALE: 1"=20'
 DATE: MARCH 1, 2006
 DRAWN BY: NSB
 CHECKED BY: DA

ADDENDUM 1 - NSW 05/08/06

TYL INTERNATIONAL

| | | | | |
|---------------------|----------|-----------------|------------------|-----------|
| F.A.I. RTE. | SECTION | COUNTY | TOTAL SHEETS | SHEET NO. |
| 94 | 1818 R-6 | COOK | 290 | 121 |
| STA. 1313+00 | | TO STA. 1367+00 | | |
| FED. ROAD DIST. NO. | | ILLINOIS | FED. AID PROJECT | |

60B18

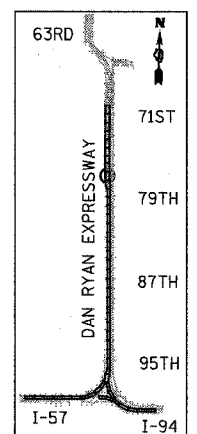
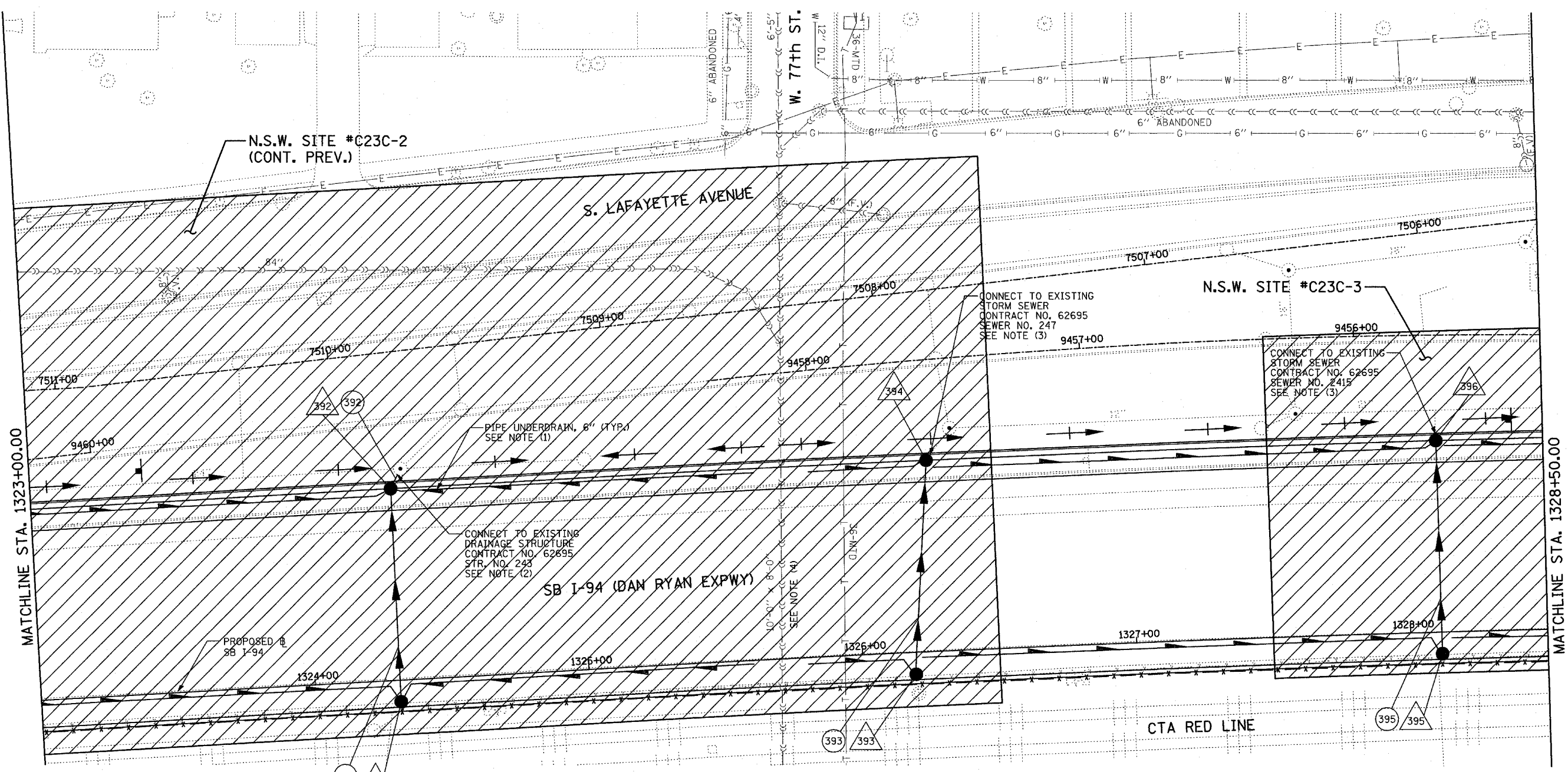

LOCATION MAP

1 NSW - NON SPECIAL WASTE SITES ADDED TO SHEET

NOTES:

- FOR CLARITY, PIPE UNDERDRAINS ARE SHOWN OFFSET FROM THEIR PROPOSED LOCATIONS. FOR DETAILED PLACEMENT, SEE SHEET "PIPE UNDERDRAINS DETAIL."
- CORE DRILL AND CONNECT TO EXISTING DRAINAGE STRUCTURE. CONNECTION COST SHALL BE INCLUDED IN THE COST TO CONSTRUCT THE STORM SEWER.
- COST SHALL NOT BE PAID FOR SEPARATELY BUT INCLUDED IN COST OF SEWER INSTALLATION.
- THE CONTRACTOR SHALL COORDINATE ALL WORK WITH COC-DOWN SEWER SECTION PRIOR TO ANY EXCAVATION. RISER SHAFTS, IF ENCOUNTERED, SHALL BE CONSTRUCTED AND PAID FOR AS PER DETAIL SHOWN ON DRAINAGE DETAIL SHEET 3 OF 3.

LEGEND:

- EXISTING COMBINED SEWER
- (XY) PROPOSED STORM SEWER NUMBER (X=SHEET NO., Y=PIPE NO.)
- (XY) PROPOSED STRUCTURE NUMBER (X=SHEET NO., Y=STRUCTURE NO.)
- S- PIPE STUBOUT TO BE PLUGGED
- P SEWER PLUG
- F.V. FIELD VERIFY
- UTILITY REMOVAL

TYLIN INTERNATIONAL

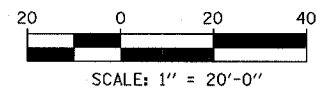

SHEET 39 OF 65

| REVISIONS | |
|-----------|------|
| NAME | DATE |
| | |
| | |
| | |
| | |
| | |
| | |

ILLINOIS DEPARTMENT OF TRANSPORTATION
F.A.I. 94 (DAN RYAN EXPRESSWAY)
DRAINAGE AND UTILITY PROPOSED PLAN
SB I-94 (DAN RYAN EXPRESSWAY)
DAN RYAN STA. 1323+00.00 TO 1328+50.00

SCALE: 1"=20'
 DATE: MARCH 1, 2006

DRAWN BY: NSB
 CHECKED BY: DA

ADDENDUM 1 - NSW 05/08/06

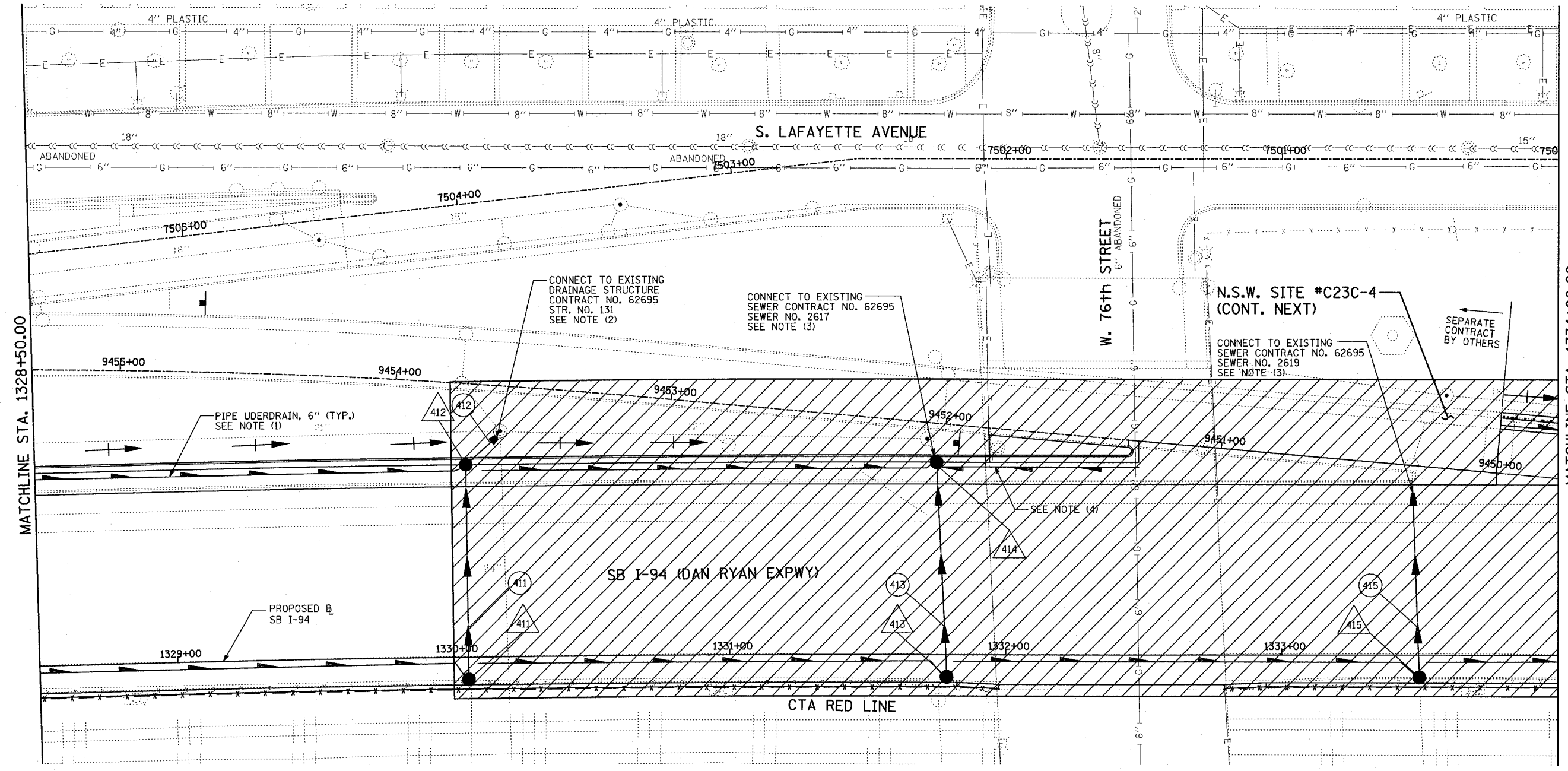

MATCHLINE STA. 1328+50.00

MATCHLINE STA. 1334+00.00

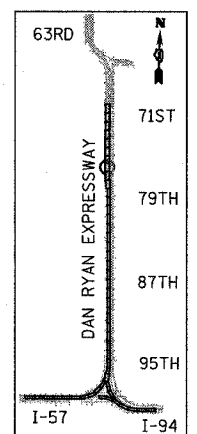

LOCATION MAP

NOTES:

- FOR CLARITY, PIPE UNDERDRAINS ARE SHOWN OFFSET FROM THEIR PROPOSED LOCATIONS. FOR DETAILED PLACEMENT, SEE SHEET "PIPE UNDERDRAINS DETAIL."
- CORE DRILL AND CONNECT TO EXISTING DRAINAGE STRUCTURE. CONNECTION COST SHALL BE INCLUDED IN THE COST TO CONSTRUCT THE STORM SEWER.
- COST SHALL NOT BE PAID FOR SEPARATELY BUT INCLUDED IN COST OF SEWER INSTALLATION.
- PROPOSED PIPE UNDERDRAIN SYSTEM LOCATION SHALL BE COORDINATED WITH PROPOSED ELECTRICAL DUCT BANK AND EXISTING FOOTING. SEE TYPICAL SECTIONS AND DETAILS FOR OVERPASS FOOTINGS.

LEGEND:

- EXISTING COMBINED SEWER
- PROPOSED STORM SEWER NUMBER (X=SHEET NO., Y=PIPE NO.)
- PROPOSED STRUCTURE NUMBER (X=SHEET NO., Y=STRUCTURE NO.)
- PIPE STUBOUT TO BE PLUGGED
- S-P SEWER PLUG
- F.V. FIELD VERIFY
- UTILITY REMOVAL

TYLIN INTERNATIONAL

1 NSW - NON SPECIAL WASTE SITES ADDED TO SHEET

SHEET 41 OF 65

| REVISIONS | |
|-----------|------|
| NAME | DATE |
| | |
| | |
| | |
| | |
| | |
| | |

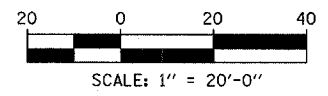

ILLINOIS DEPARTMENT OF TRANSPORTATION
F.A.I. 94 (DAN RYAN EXPRESSWAY)
 DRAINAGE AND UTILITY PROPOSED PLAN
 SB I-94 (DAN RYAN EXPRESSWAY)
 DAN RYAN STA. 1328+50.00 TO 1334+00.00

SCALE: 1"=20'
 DATE: MARCH 1, 2006
 DRAWN BY: NSB
 CHECKED BY: DA

ADDENDUM 1 - NSW 05/08/06

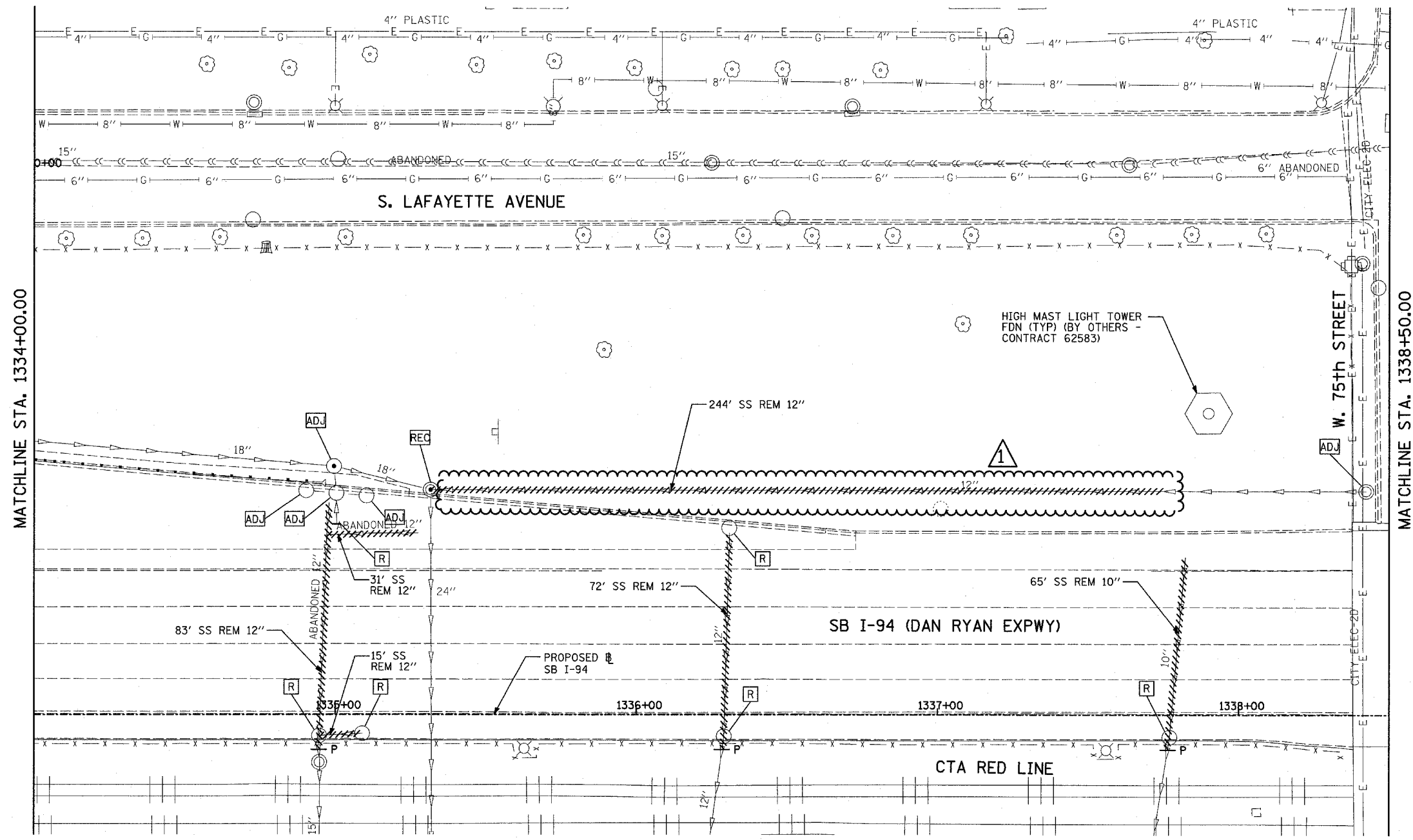

MATCHLINE STA. 1334+00.00

MATCHLINE STA. 1338+50.00

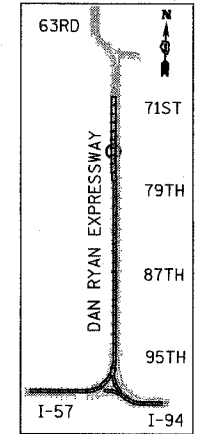

LOCATION MAP

TYLIN INTERNATIONAL

- LEGEND:**
- EXISTING COMBINED SEWER
 - (XY) PROPOSED STORM SEWER NUMBER (X=SHEET NO., Y=PIPE NO.)
 - (XY) PROPOSED STRUCTURE NUMBER (X=SHEET NO., Y=STRUCTURE NO.)
 - S- PIPE STUBOUT TO BE PLUGGED
 - P SEWER PLUG
 - F.V. FIELD VERIFY
 - ////// UTILITY REMOVAL

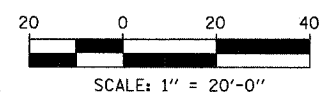

SHEET 42 OF 65

| REVISIONS | |
|-----------|------|
| NAME | DATE |
| | |
| | |
| | |
| | |
| | |
| | |
| | |
| | |
| | |

ILLINOIS DEPARTMENT OF TRANSPORTATION
 F.A.I. 94 (DAN RYAN EXPRESSWAY)
 DRAINAGE AND UTILITY EXISTING PLAN
 SB 76th TO 79th STREET C-D RAMP
 DAN RYAN STA. 1334+00.00 TO 1338+50.00

SCALE: 1"=20'
 DATE: MARCH 1, 2006
 DRAWN BY: NSB
 CHECKED BY: DA

ADDENDUM 1 05/08/06

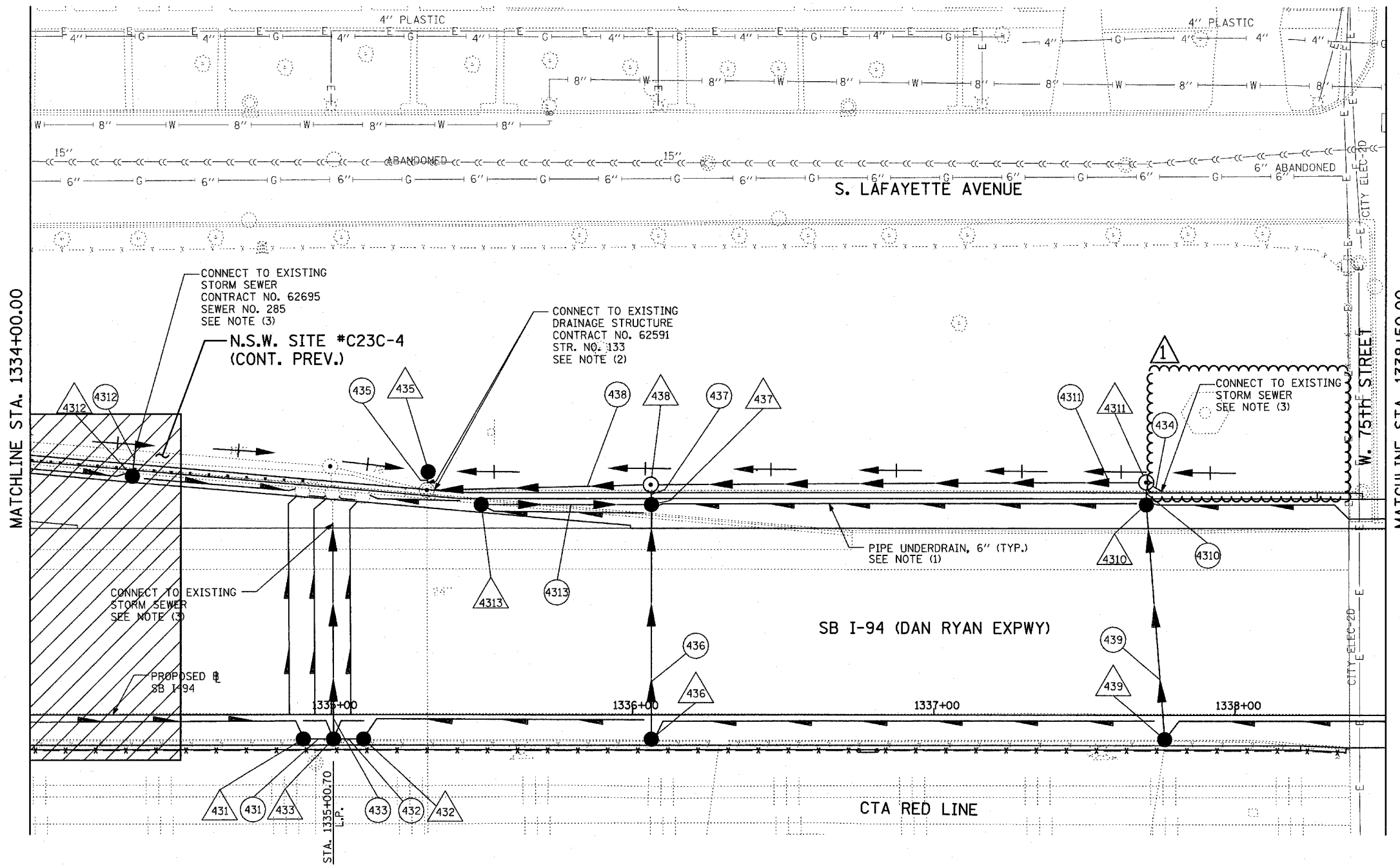

MATCHLINE STA. 1334+00.00

MATCHLINE STA. 1338+50.00

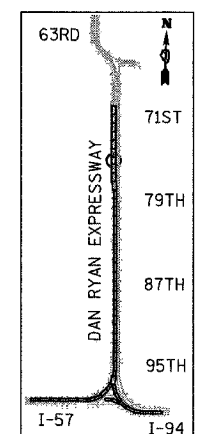

LOCATION MAP

TYLIN INTERNATIONAL

LEGEND:

| | | | |
|--|---|--|-----------------|
| | EXISTING COMBINED SEWER | | SEWER PLUG |
| | PROPOSED STORM SEWER NUMBER (X=SHEET NO., Y=PIPE NO.) | | FIELD VERIFY |
| | PROPOSED STRUCTURE NUMBER (X=SHEET NO., Y=STRUCTURE NO.) | | UTILITY REMOVAL |
| | PIPE STUBOUT TO BE PLUGGED | | |

- NOTES:**
- FOR CLARITY, PIPE UNDERDRAINS ARE SHOWN OFFSET FROM THEIR PROPOSED LOCATIONS. FOR DETAILED PLACEMENT, SEE SHEET "PIPE UNDERDRAINS DETAIL."
 - CORE DRILL AND CONNECT TO EXISTING DRAINAGE STRUCTURE. CONNECTION COST SHALL BE INCLUDED IN THE COST TO CONSTRUCT THE STORM SEWER.
 - COST SHALL NOT BE PAID FOR SEPARATELY BUT INCLUDED IN COST OF SEWER INSTALLATION.

NSW - NON SPECIAL WASTE SITES ADDED TO SHEET

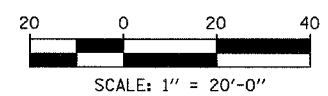

SHEET 43 OF 65

| REVISIONS | |
|-----------|------|
| NAME | DATE |
| | |
| | |
| | |
| | |
| | |
| | |
| | |
| | |
| | |

ADDENDUM 1 05/08/06

ILLINOIS DEPARTMENT OF TRANSPORTATION
F.A.I. 94 (DAN RYAN EXPRESSWAY)
DRAINAGE AND UTILITY PROPOSED PLAN
SB I-94 (DAN RYAN EXPRESSWAY)
DAN RYAN STA. 1334+00.00 TO 1338+50.00

SCALE: 1"=20'
 DATE: MARCH 1, 2006
 DRAWN BY: NSB
 CHECKED BY: DA

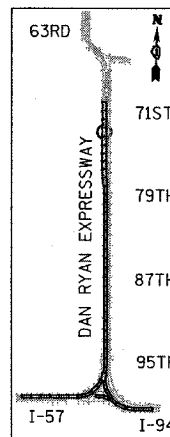
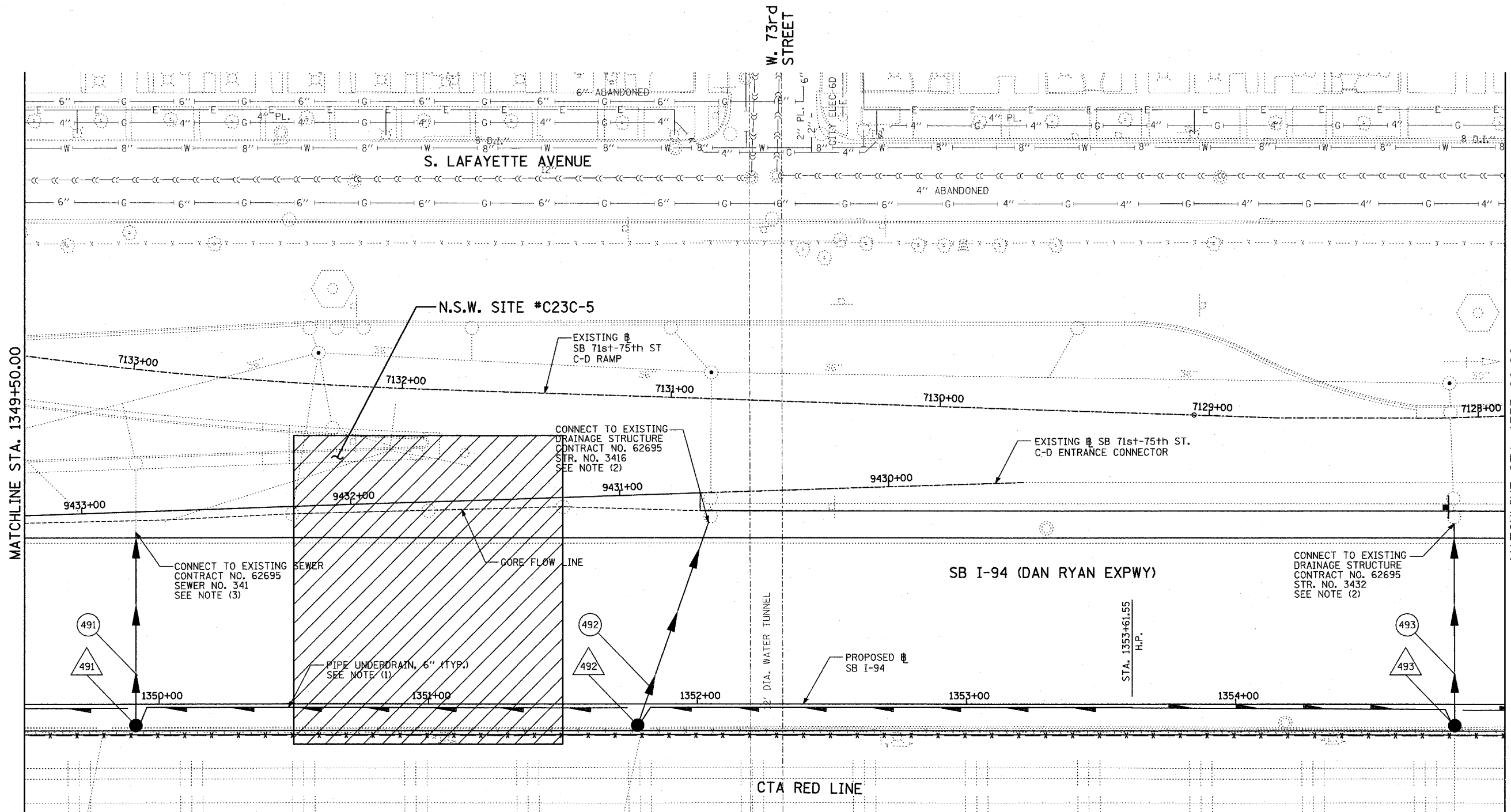

LOCATION MAP

TYLIN INTERNATIONAL

- LEGEND:**
- EXISTING COMBINED SEWER
 - P SEWER PLUG
 - (XY) PROPOSED STORM SEWER NUMBER (X=SHEET NO., Y=PIPE NO.)
 - F.V. FIELD VERIFY
 - (XY) PROPOSED STRUCTURE NUMBER (X=SHEET NO., Y=STRUCTURE NO.)
 - UTILITY REMOVAL
 - S | PIPE STUBOUT TO BE PLUGGED

- NOTES:**
- FOR CLARITY, PIPE UNDERDRAINS ARE SHOWN OFFSET FROM THEIR PROPOSED LOCATIONS. FOR DETAILED PLACEMENT, SEE SHEET "PIPE UNDERDRAINS DETAIL."
 - CORE DRILL AND CONNECT TO EXISTING DRAINAGE STRUCTURE. CONNECTION COST SHALL BE INCLUDED IN THE COST TO CONSTRUCT THE STORM SEWER.
 - COST SHALL NOT BE PAID FOR SEPARATELY BUT INCLUDED IN COST OF SEWER INSTALLATION.

1 NSW - NON SPECIAL WASTE SITES ADDED TO SHEET

SHEET 49 OF 65

| REVISIONS | |
|-----------|------|
| NAME | DATE |
| | |
| | |
| | |
| | |
| | |
| | |
| | |
| | |
| | |

ILLINOIS DEPARTMENT OF TRANSPORTATION
 F.A.I. 94 (DAN RYAN EXPRESSWAY)
 DRAINAGE AND UTILITY PROPOSED PLAN
 SB I-94 (DAN RYAN EXPRESSWAY)
 SB I-94 STA. 1349+50.00 TO 1355+00.00

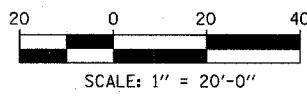

SCALE: 1"=20'
 DATE: MARCH 1, 2006
 DRAWN BY: NSB
 CHECKED BY: DA

ADDENDUM 1 - NSW 05/08/06

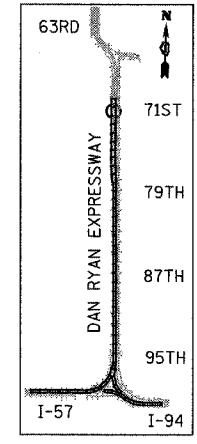
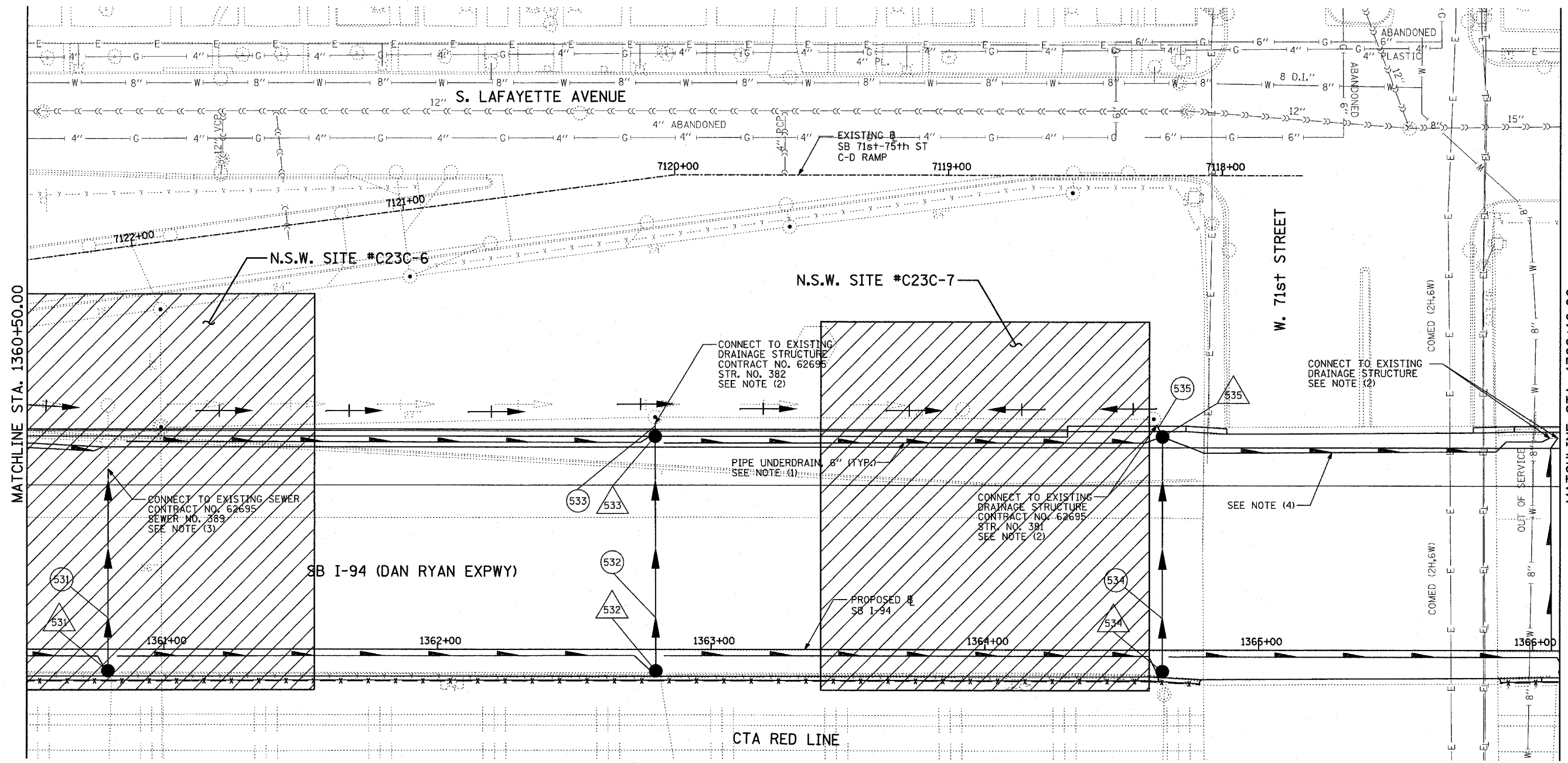

- NOTES:**
1. FOR CLARITY, PIPE UNDERDRAINS ARE SHOWN OFFSET FROM THEIR PROPOSED LOCATIONS. FOR DETAILED PLACEMENT, SEE SHEET "PIPE UNDERDRAINS DETAIL."
 2. CORE DRILL AND CONNECT TO EXISTING DRAINAGE STRUCTURE. CONNECTION COST SHALL BE INCLUDED IN THE COST TO CONSTRUCT THE STORM SEWER.
 3. COST SHALL NOT BE PAID FOR SEPARATELY BUT INCLUDED IN COST OF SEWER INSTALLATION.
 4. PROPOSED PIPE UNDERDRAIN SYSTEM LOCATION SHALL BE COORDINATED WITH PROPOSED ELECTRICAL DUCT BANK AND EXISTING FOOTING. SEE TYPICAL SECTIONS AND DETAILS FOR OVERPASS FOOTINGS.

NSW - NON SPECIAL WASTE SITES ADDED TO SHEET

LEGEND:

| | | | |
|--|--|--|-----------------|
| | EXISTING COMBINED SEWER | | SEWER PLUG |
| | PROPOSED STORM SEWER NUMBER (X=SHEET NO., Y=PIPE NO.) | | FIELD VERIFY |
| | PROPOSED STRUCTURE NUMBER (X=SHEET NO., Y=STRUCTURE NO.) | | UTILITY REMOVAL |
| | PIPE STUBOUT TO BE PLUGGED | | |

SHEET 53 OF 65

| REVISIONS | |
|-----------|------|
| NAME | DATE |
| | |
| | |
| | |
| | |
| | |
| | |
| | |
| | |
| | |

ADDENDUM 1 - NSW 05/08/06

ILLINOIS DEPARTMENT OF TRANSPORTATION
F.A.I. 94 (DAN RYAN EXPRESSWAY)
DRAINAGE AND UTILITY PROPOSED PLAN
SB I-94 (DAN RYAN EXPRESSWAY)
SB I-94 STA. 1360+50.00 TO 1366+10.00

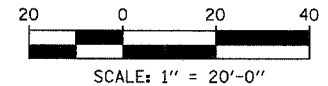

SCALE: 1"=20'
 DATE: MARCH 1, 2006
 DRAWN BY: NSB
 CHECKED BY: DA

TYLIN INTERNATIONAL

DATE: _____
 BY: _____
 SUBMITTED: _____
 PLOTTED: _____
 ALIGNED: _____
 CHECKED: _____
 NOTE BOOK NO.: _____
 CADD FILE NAME: _____

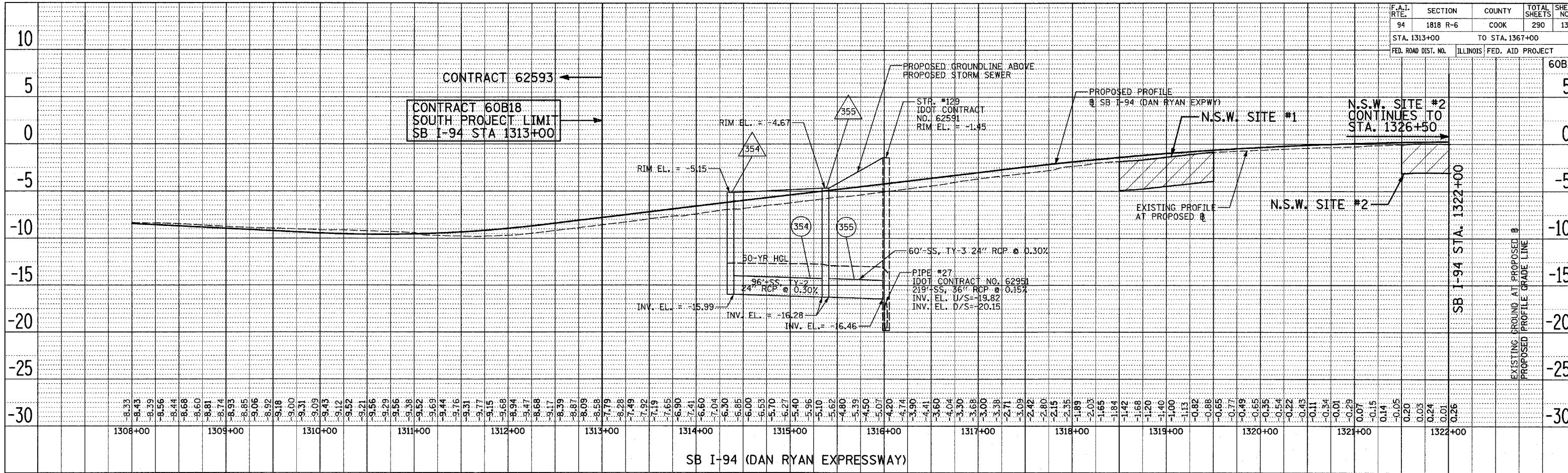

DATE: _____
 BY: _____
 SUBMITTED: _____
 PLOTTED: _____
 ALIGNED: _____
 CHECKED: _____
 NOTE BOOK NO.: _____
 CADD FILE NAME: _____

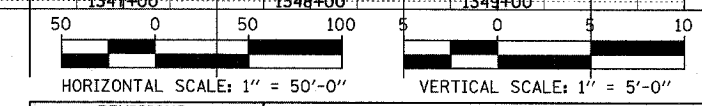
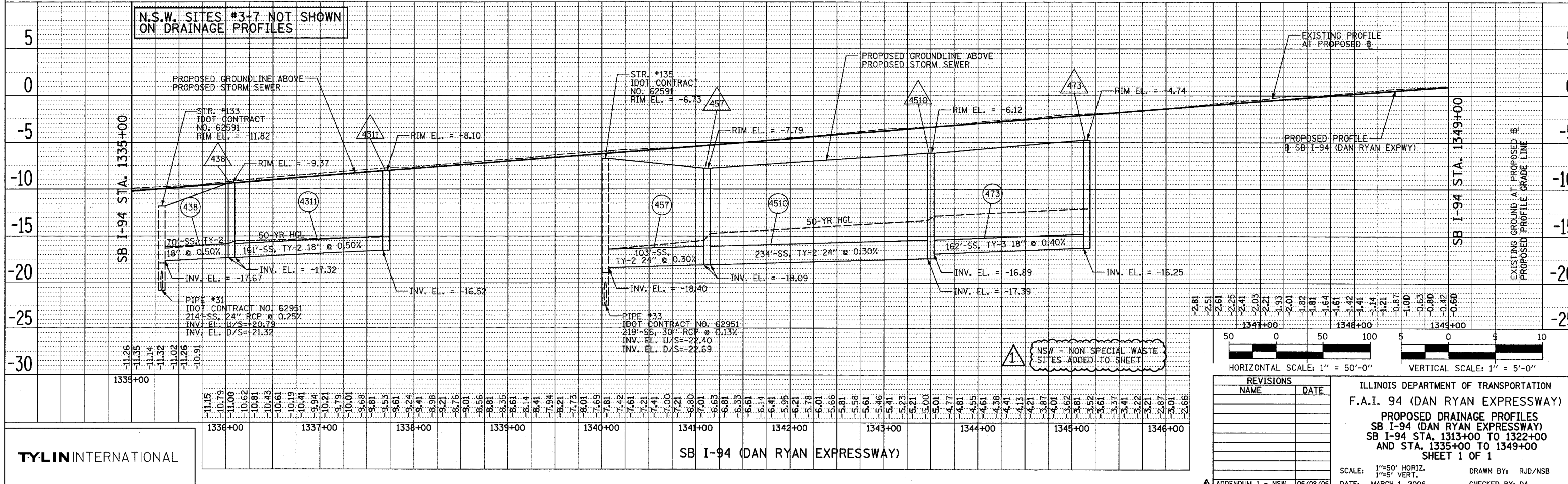

| REVISIONS | |
|-----------|------|
| NAME | DATE |
| | |
| | |
| | |
| | |
| | |

ILLINOIS DEPARTMENT OF TRANSPORTATION
 F.A.I. 94 (DAN RYAN EXPRESSWAY)
 PROPOSED DRAINAGE PROFILES
 SB I-94 (DAN RYAN EXPRESSWAY)
 SB I-94 STA. 1313+00 TO 1322+00
 AND STA. 1335+00 TO 1349+00
 SHEET 1 OF 1

SCALE: 1"=50' HORIZ.
 1"=5' VERT.

DATE: MARCH 1, 2006

DRAWN BY: RJD/NSB
 CHECKED BY: DA

TYLIN INTERNATIONAL

ADDENDUM 1 - NSW 05/08/06

| F.A.I. RTE. | SECTION | COUNTY | TOTAL SHEETS | SHEET NO. |
|-------------|----------|--------|--------------|-----------|
| 94 | 1818 R-6 | COOK | 290 | 139 |

STA. 1313+00 TO STA. 1367+00

FED. ROAD DIST. NO. ILLINOIS FED. AID PROJECT

60B18

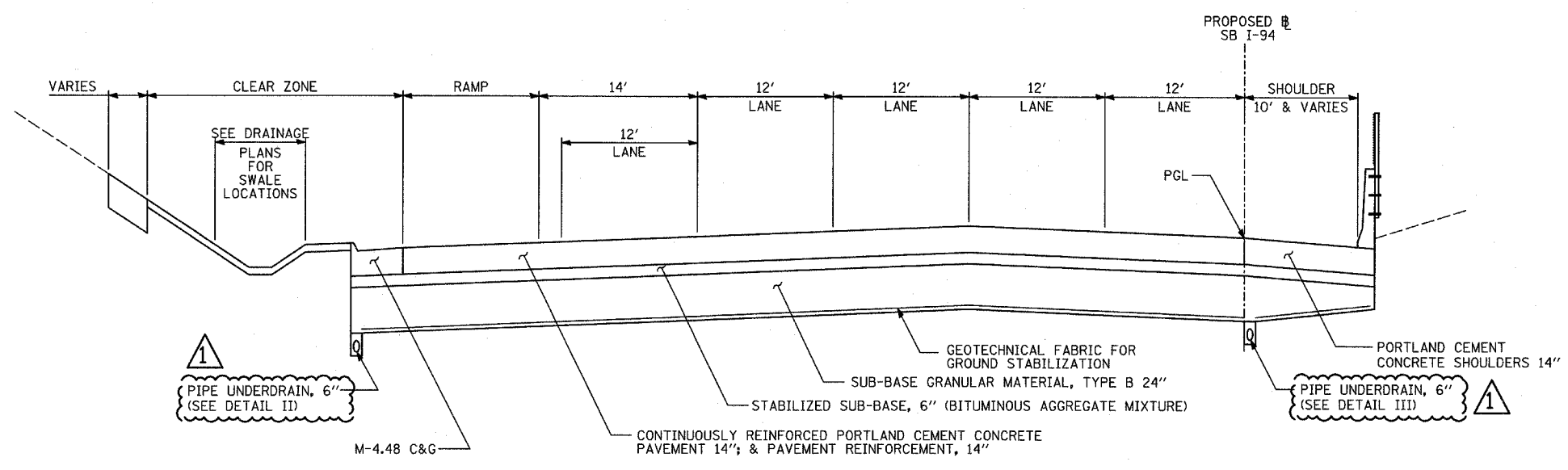

PROPOSED SB I-94 MAINLINE PAVEMENT
 LOCATIONS VARY BETWEEN 76th TO 79th C-D RAMPS AND 71st TO 75th C-D RAMPS

NOTES:

- (1) GEOTECHNICAL FABRIC FOR GROUND STABILIZATION SHALL BE PLACED SUCH THAT IT EXTENDS TO THE EDGE OF THE TRENCH AND OVERLAPS THE FILTER FABRIC BY A MINIMUM OF 6". AT NO TIME SHALL THE GEOTECHNICAL FABRIC FOR GROUND STABILIZATION BE OVER OR COVER THE UNDERDRAIN TRENCH.
- (2) NO CONSTRUCTION TRAFFIC SHALL BE ALLOWED ON THE TRENCH UNTIL A MINIMUM OF 12" OF COMPACTED SUB-BASE IS PROVIDED.
- (3) THE PIPE UNDERDRAIN TRENCH SHALL BE LINED WITH FILTER FABRIC ON THE BOTTOM AND SIDES OF THE TRENCH. THE TOP OF THE TRENCH MUST NOT BE COVERED WITH ANY FABRIC.
- (4) FILTER FABRIC, FABRIC ENVELOPE, AND CA-16 AGGREGATE ARE INCLUDED IN THE UNIT COST OF PIPE UNDERDRAIN, 6".
- (5) CONTRACTOR SHALL FLUSH PIPE UNDERDRAIN WITH WATER TO INSURE UNDERDRAIN IS FUNCTIONING PROPERLY PRIOR TO THE PLACEMENT OF STABILIZED SUB-BASE. PRIOR TO COMMENCING THIS WORK, THE CONTRACTOR SHALL PROVIDE THE ENGINEER WITH HIS APPROACH AND METHODS FOR COMPLETING THIS WORK, FOR THE ENGINEER'S REVIEW AND APPROVAL. THE COST OF FLUSHING THE PIPE IS INCLUDED IN THE UNIT COST OF PIPE UNDERDRAIN, 6".

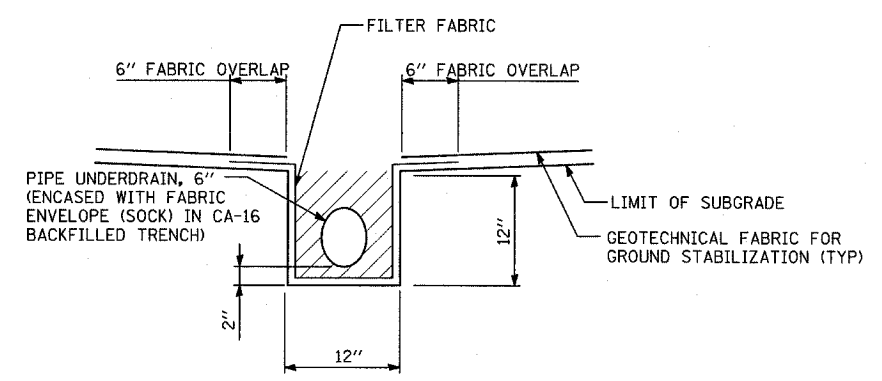
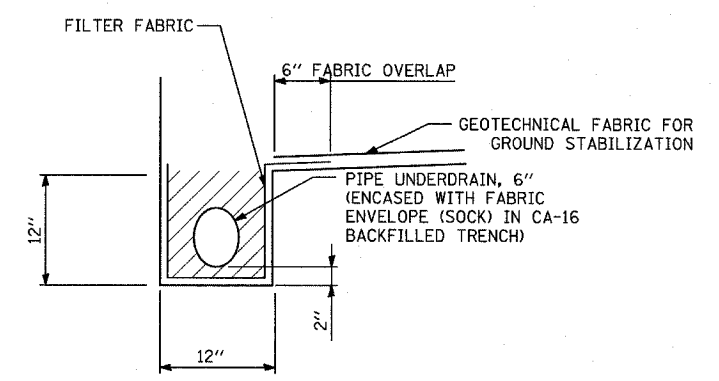

TYLIN INTERNATIONAL

| REVISIONS | |
|-----------|------|
| NAME | DATE |
| | |
| | |
| | |
| | |
| | |
| | |
| | |
| | |
| | |
| | |

ILLINOIS DEPARTMENT OF TRANSPORTATION
 F.A.I. 94 (DAN RYAN EXPRESSWAY)
PIPE UNDERDRAINS ALONG I-94 DETAILS SHEET 1 OF 1
 SCALE: NONE DRAWN BY: BK
 DATE: MARCH 1, 2006 CHECKED BY: DA

ADDENDUM 1 05/08/06

DRAINAGE STRUCTURE SCHEDULE

| STRUCTURE NUMBER | STATION | OFFSET | STRUCTURE TYPE | | DIA. | FRAME & LID | TOP OF FRAME | N INV. | E INV. | S INV. | W INV. |
|------------------|------------|---------|----------------|------|------|-------------|--------------|--------|--------|--------|--------|
| | | | MH | CB | | | | | | | |
| 475 | 1347+79.53 | 10.0 RT | | A(7) | 4' | T20 F&G | -1.97 | | | | -7.53 |
| 491 | 1349+91.33 | 10.0 RT | | A(7) | 4' | T20 F&G | -0.27 | | | | -6.27 |
| 492 | 1351+77.81 | 10.0 RT | | A(7) | 4' | T20 F&G | 0.98 | | | | -4.46 |
| 493 | 1354+81.41 | 10.0 RT | | A(7) | 4' | T20 F&G | 1.22 | | | | -4.52 |
| 516 | 1356+81.57 | 10.0 RT | | A(7) | 4' | T20 F&G | 0.13 | | | | -6.34 |
| 517 | 1358+61.71 | 10.0 RT | | A(7) | 4' | T20 F&G | -1.71 | | | | -8.36 |
| 531 | 1360+79.63 | 10.0 RT | | A(7) | 4' | T20 F&G | -4.30 | | | | -10.15 |
| 532 | 1362+79.80 | 10.0 RT | | A(7) | 4' | T20 F&G | -6.68 | | | | -13.94 |
| 533 | 1362+79.46 | 80.0 LT | | A | 4' | T20 F&G | -7.21 | | -14.30 | | -14.30 |
| 534 | 1364+64.66 | 10.3 RT | | A(7) | 4' | T20 F&G | -8.90 | | | | -14.77 |
| 535 | 1364+64.80 | 80.0 LT | | A | 4' | T20 F&G | -9.38 | | -15.13 | | -15.13 |
| 551 | 1366+11.98 | 10.0 RT | | A(7) | 4' | T20 F&G | -9.79 | -16.60 | | | |
| 552 | 1366+31.98 | 10.0 RT | | A(7) | 4' | T20 F&G | -9.79 | | -16.60 | | |
| 553 | 1366+21.98 | 10.0 RT | | A(7) | 4' | T20 F&G | -9.79 | -16.63 | -16.63 | | -16.63 |
| 554 | 1366+12.32 | 85.0 LT | | C | 2' | T1F OL | -8.11 | -14.55 | | | |

STORM SEWER SCHEDULE

| PIPE NUMBER | UPSTREAM STATION | DOWNSTREAM STATION | TYPE | DIA. (IN) | LENGTH (FT) | SLOPE % | T.B. (CU.YD) |
|-------------|------------------|--------------------|------|-----------|-------------|---------|--------------|
| 491 | 1349+91.33 | 1349+91.33 | 2 | 12 | 70 | 0.44 | 12.9 |
| 492 | 1351+77.81 | 1352+04.92 | 2 | 12 | 79 | 0.44 | 8.8 |
| 493 | 1354+81.41 | 1354+81.13 | 2 | 12 | 74 | 0.44 | 10.5 |
| 516 | 1356+81.57 | 1356+57.85 | 2 | 12 | 78 | 0.44 | 17.6 |
| 517 | 1358+61.71 | 1358+62.30 | 2 | 12 | 70 | 0.44 | 17.3 |
| 531 | 1360+79.63 | 1360+79.64 | 2 | 12 | 72 | 0.44 | 10.9 |
| 532 | 1362+79.80 | 1362+79.46 | 2 | 12 | 82 | 0.44 | 23.7 |
| 533 | 1362+79.46 | 1362+79.43 | 2 | 12 | 3 | 0.44 | 0.8 |
| 534 | 1364+64.66 | 1364+64.80 | 2 | 12 | 82 | 0.44 | 11.6 |
| 535 | 1364+64.80 | 1364+61.61 | 2 | 15 | 3 | 0.44 | 0.4 |
| 551 | 1366+11.98 | 1366+21.98 | 2 | 18 | 6 | 0.44 | 1.5 |
| 552 | 1366+31.98 | 1366+21.98 | 2 | 18 | 6 | 0.44 | 1.5 |
| 553 | 1366+21.98 | 1366+22.22 | 2 | 18 | 85 | 0.44 | 25.0 |
| 554 | 1366+12.32 | 1366+21.43 | 2 | 12 | 6 | 0.44 | 0.0 |

| | | | | |
|---------------------|----------|-----------------|------------------|-----------|
| F.A.I. RTE. | SECTION | COUNTY | TOTAL SHEETS | SHEET NO. |
| 94 | 1818 R-6 | COOK | 290 | 145 |
| STA. 1313+00 | | TO STA. 1367+00 | | |
| FED. ROAD DIST. NO. | | ILLINOIS | FED. AID PROJECT | |

NOTES:

- INDICATES INLET TYPE A, 2' DIAMETER, TYPE 20 FRAME & GRATE.
- INDICATES MANHOLE, TYPE A, 6' DIAMETER, TYPE 1 FRAME, CLOSED LID, RESTRICTOR PLATE.
- INDICATES SEWER LATERAL WITH 45° CONNECTION. SEE SHEET "DETAIL OF STORM SEWER CONNECTIONS TO SEWER."
- INDICATES SEWER LATERAL WITH 30° CONNECTION. SEE SHEET "DETAIL OF STORM SEWER CONNECTIONS TO SEWER."
- INDICATES SEWER LATERAL WITH 60° CONNECTION. SEE SHEET "DETAIL OF STORM SEWER CONNECTIONS TO SEWER."
- INDICATES MANHOLE TYPE A WITH FLAT SLAB TOP, IDOT STANDARD 602601.
- INDICATES CATCH BASIN REQUIRING TEMPORARY SOIL RETENTION SYSTEM WITH INSTALLATION.
- ALL STRUCTURE ELEVATIONS IN RESURFACED AREAS COME FROM AERIAL SURVEY AND SHOULD BE VERIFIED IN THE FIELD AND ADJUSTED TO MATCH EXISTING CONDITIONS.

CASING SIZES

| PIPE SIZE | CASING SIZE (OD)* | CASING WALL THICKNESS |
|-----------|-------------------|-----------------------|
| 12" | 30" | 0.500" |
| 24" | 42" | 0.625" |
| 30" | 48" | 0.688" |
| 36" | 48" | 0.688" |

- *ALL STEEL CASING SHALL MEET OR EXCEED ASTM A-139, GRADE B.
 SEE THE DRAINAGE & UTILITY PLANS FOR LOCATION OF ALL STRUCTURES.
 CATCH BASIN STATIONS ARE MEASURED TO CENTER OF STRUCTURE.
 CATCH BASIN OFFSETS ARE MEASURED TO FLOWLINE OF CASTING. (SEE BELOW)
 FLOWLINE OF CASING IS LOCATED AT C OF STRUCTURE FOR CATCH BASINS LOCATED IN SWALE AND GORE AREAS.

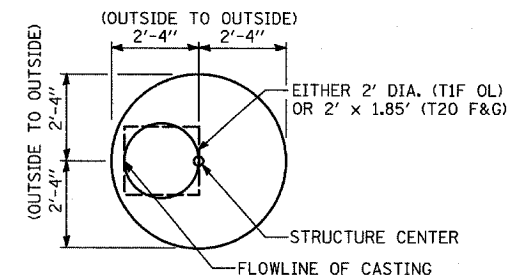

CATCH BASIN

(PRECAST REINFORCED CONCRETE SECTION)

MANHOLE STATIONS AND OFFSETS ARE MEASURED TO CENTER OF STRUCTURE. (SEE BELOW)

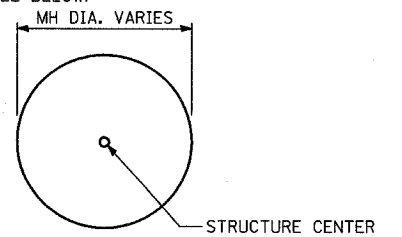

MANHOLE

SHEET 2 OF 2

TYLIN INTERNATIONAL

| REVISIONS | |
|-----------|------|
| NAME | DATE |
| | |
| | |
| | |
| | |
| | |
| | |
| | |
| | |
| | |
| | |
| | |
| | |

ILLINOIS DEPARTMENT OF TRANSPORTATION
 F.A.I. 94 (DAN RYAN EXPRESSWAY)
DRAINAGE STRUCTURE SCHEDULE

SCALE: NONE DRAWN BY: RD
 DATE: MARCH 1, 2006 CHECKED BY: DA

ADDENDUM 1 05/08/06

