

F.A.I. RTE.	SECTION	COUNTY	TOTAL SHEETS	SHEET NO.
94	1818 R-6	COOK	290	100
STA. 1313+00		TO STA. 1367+00		
FED. ROAD DIST. NO.		ILLINOIS FED. AID PROJECT		

60B18

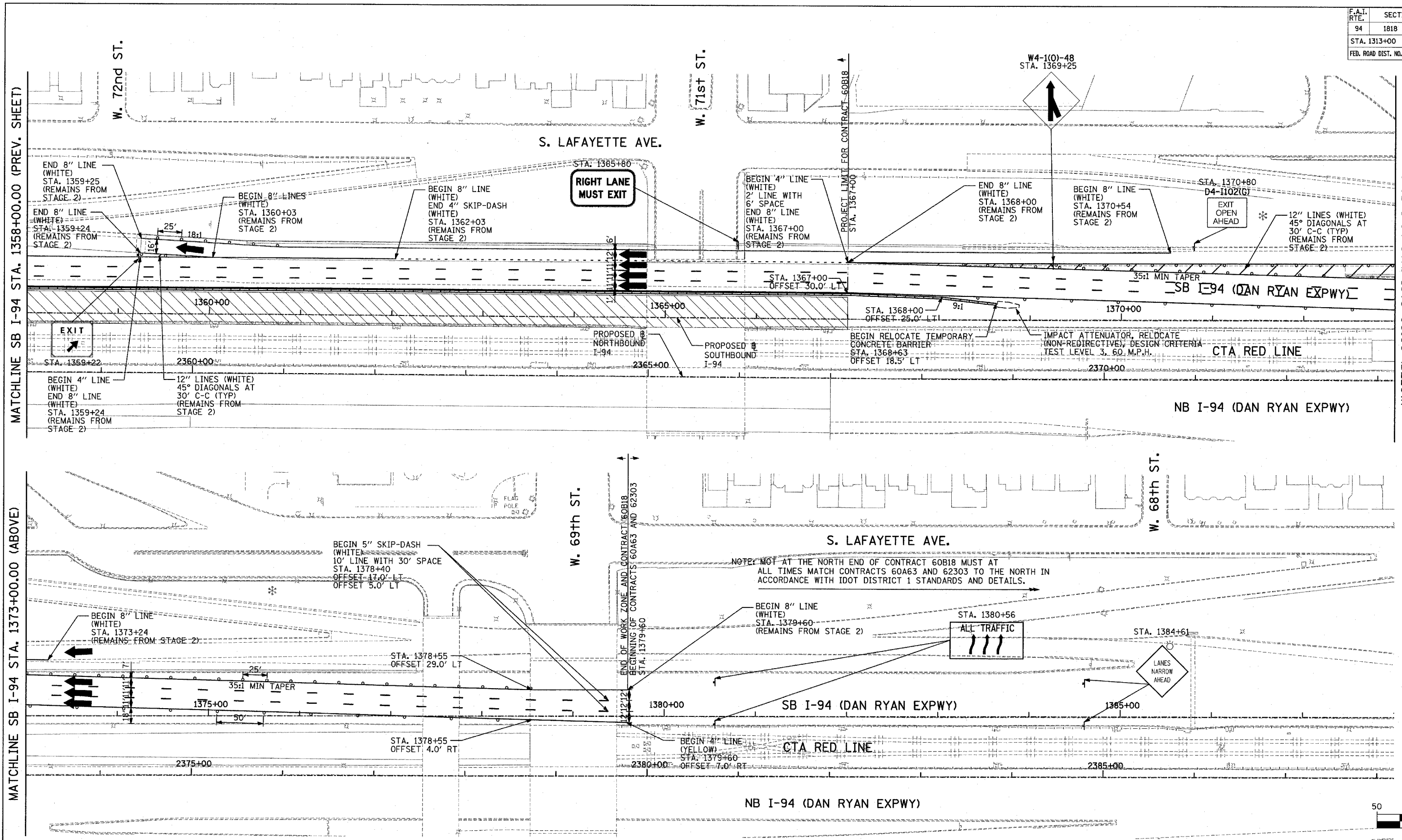

MATCHLINE SB I-94 STA. 1373+00.00 (BELOW)

MATCHLINE SB I-94 STA. 1358+00.00 (PREV. SHEET)

MATCHLINE SB I-94 STA. 1373+00.00 (ABOVE)

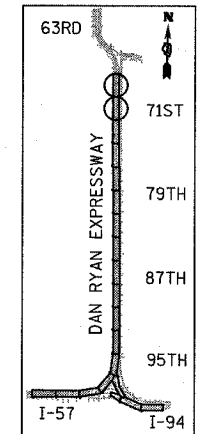

LOCATION MAP

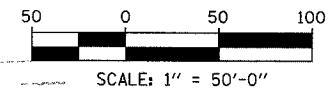

**TYLIN** INTERNATIONAL

**LEGEND:**

- TEMPORARY CONCRETE BARRIER
- TRAFFIC LANE
- WORK ZONE
- BARRICADE, TYPE III
- DRUM WITH MONO-DIRECTIONAL STEADY BURNING LIGHT
- ARROW BOARD
- TEMPORARY PAVEMENT

REVISIONS	
NAME	DATE

ILLINOIS DEPARTMENT OF TRANSPORTATION  
**F.A.I. 94 (DAN RYAN EXPRESSWAY)**  
 MAINTENANCE OF TRAFFIC PLAN  
 STAGE 3 - SB I-94  
 SB I-94 STA. 1358+00 TO 1388+00  
 SHEET 3 OF 3

SCALE: 1"=50'-0"  
 DATE: MARCH 1, 2006  
 DRAWN BY: JDF  
 CHECKED BY: RTM