

PROFILE SURVEYED  
 PLOTTED  
 CHECKED  
 DATE  
 NO. STRUCTURE NOTATIONS CHRD

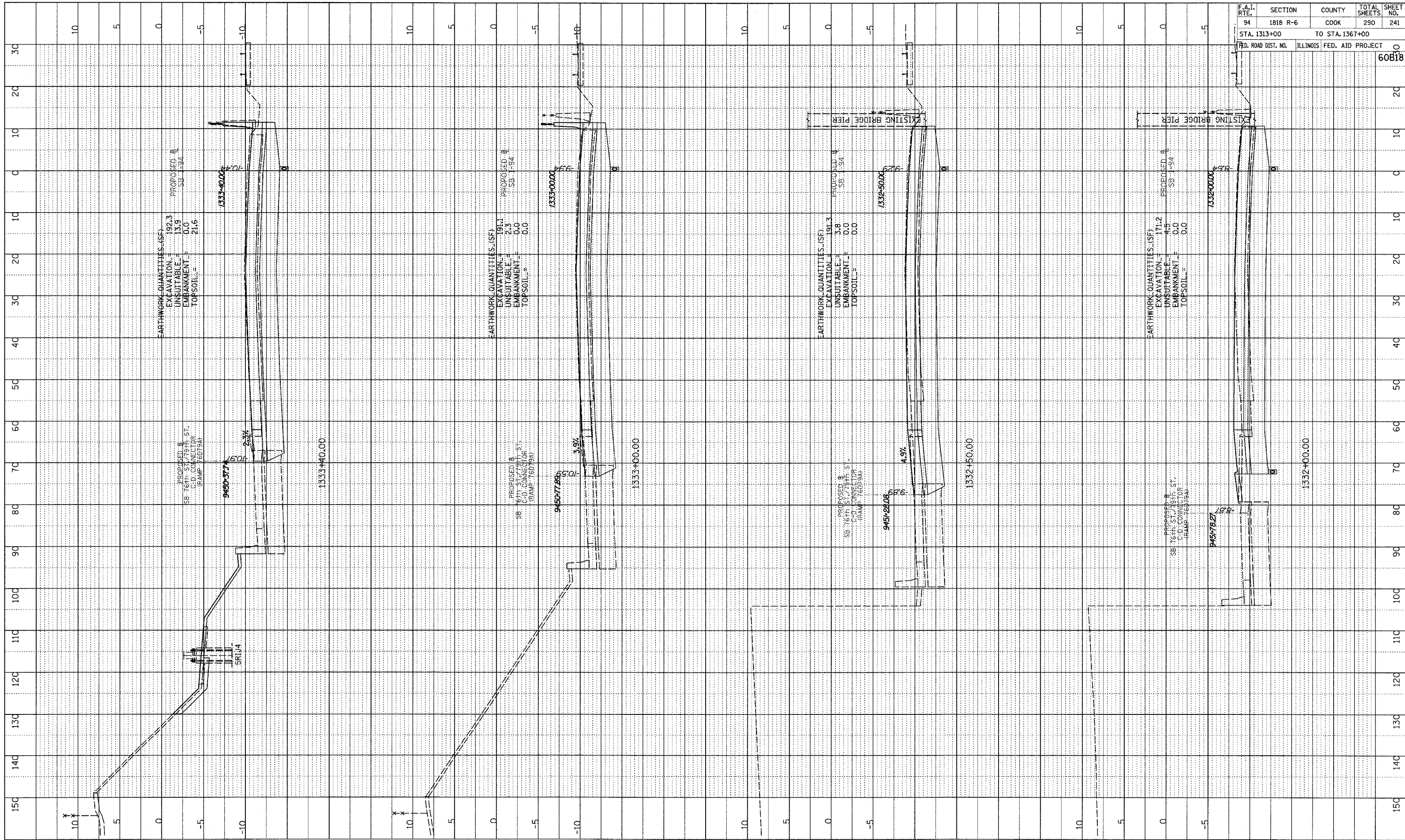

F.A.I. RTE.	SECTION	COUNTY	TOTAL SHEETS	SHEET NO.
94	1818 R-6	COOK	290	241
STA. 1313+00		TO STA. 1367+00		
FED. ROAD DIST. NO.		ILLINOIS FED. AID PROJECT		
				60B18

TYLIN INTERNATIONAL

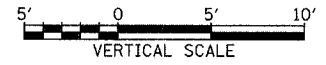

I-94 SOUTHBOUND (DAN RYAN EXPWY)  
 STA. 1332+00 TO STA. 1333+40

02/27/2006 12:50:01 PM