

SURVEYED
 GRADES CHECKED
 E.M. NOTED
 STRUCTURE NOTATIONS DFPD
 NO.

F.A.I. RTE.	SECTION	COUNTY	TOTAL SHEETS	SHEET NO.
94	1818 R-6	COOK	290	243
STA. 1313+00		TO STA. 1367+00		
FED. ROAD DIST. NO.	ILLINOIS FED. AID PROJECT		60B18	

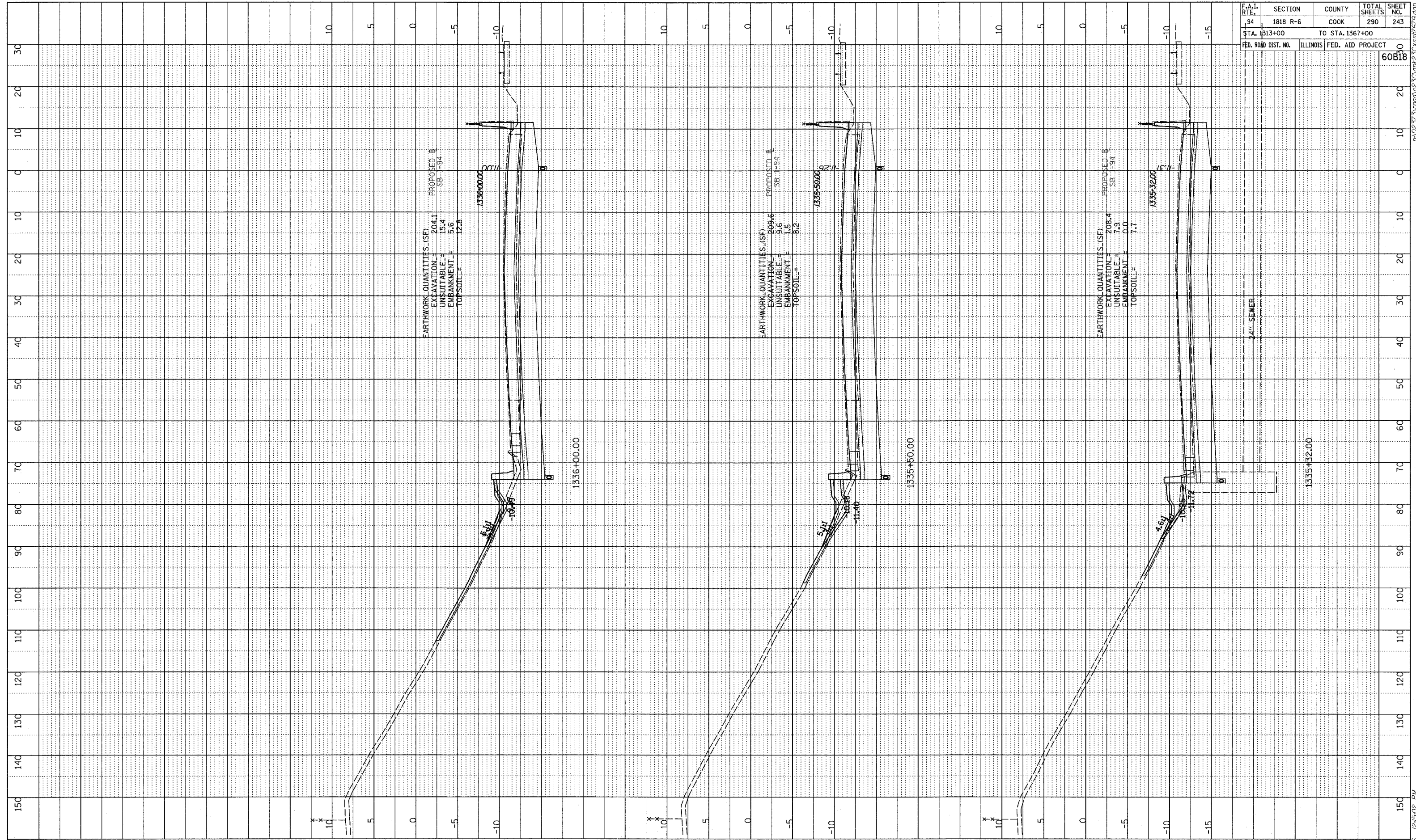

TYLIN INTERNATIONAL

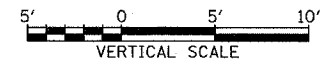
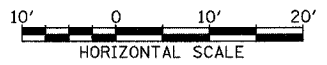

I-94 SOUTHBOUND (DAN RYAN EXPWY)
 STA. 1335+32 TO STA. 1336+00

02/27/2006 12:50:02 PM