

PROFILE SUBMITTED BY: [ ]  
 PLOTTED, CHECKED BY: [ ]  
 DATE: [ ]  
 NO. [ ]  
 STRUCTURE NOTATION: CHRD

F.A.I. RTE.	SECTION	COUNTY	TOTAL SHEETS	SHEET NO.
94	1818 R-6	COOK	290	249
STA. 1313+00 TO STA. 1367+00		ILLINOIS FED. AID PROJECT		
		60818		

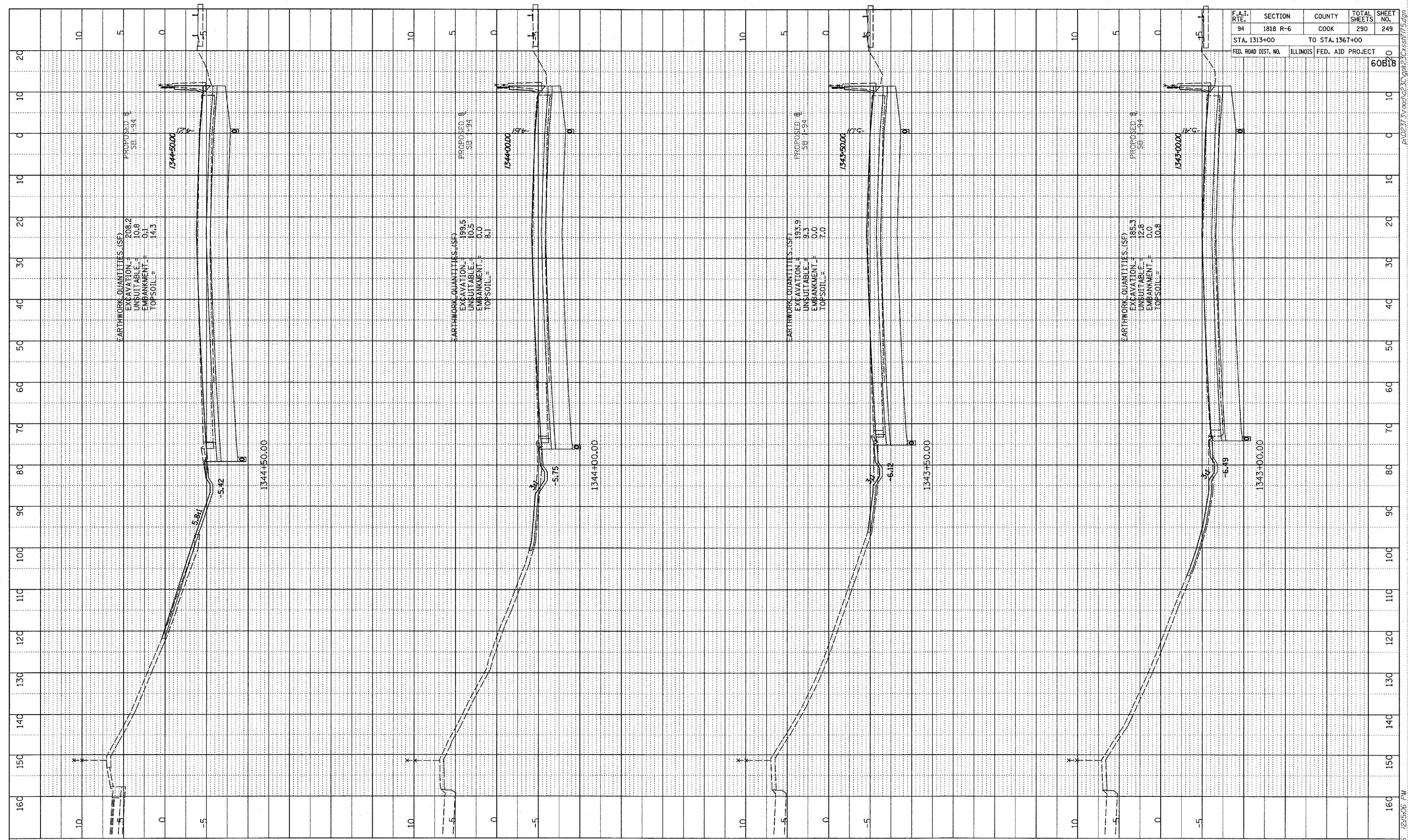

TYLIN INTERNATIONAL

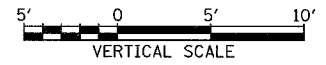

I-94 SOUTHBOUND (DAN RYAN EXPWY)  
 STA. 1343+00 TO STA. 1344+50

02/27/2006 12:50:06 PM P:\0227\3\road\6253\gpk2\3\ssst175.dgn