

SURVEYED  
 GRADES CHECKED  
 B.M. NOTED  
 STRUCTURE NOTATIONS OK'D  
 NO. \_\_\_\_\_  
 DATE \_\_\_\_\_

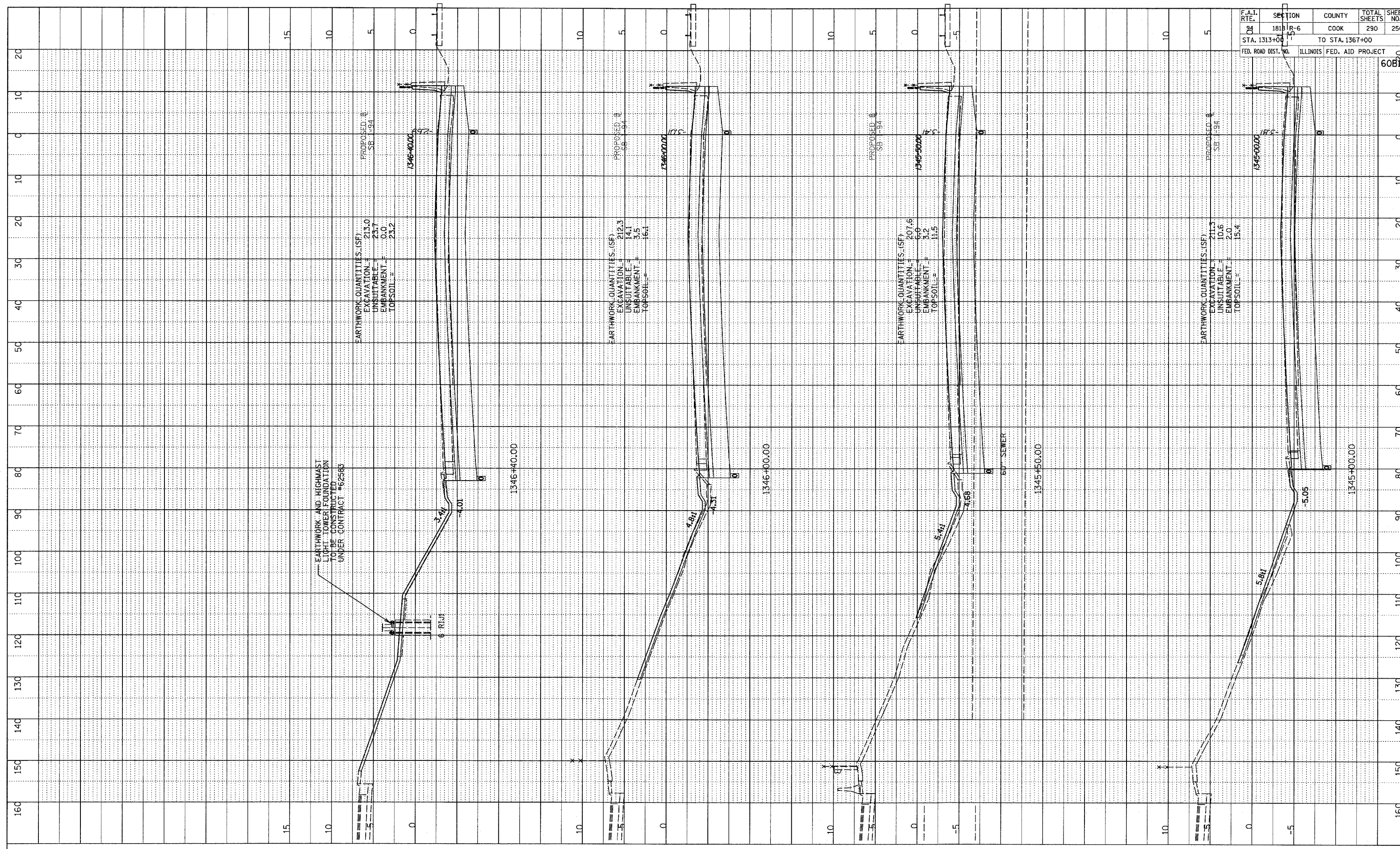

F.A.I. RTE.	SECTION	COUNTY	TOTAL SHEETS	SHEET NO.
94	1818 R-6	COOK	290	250
STA. 1313+00 TO STA. 1367+00				
FED. ROAD DIST. NO. ILLINOIS FED. AID PROJECT				

TYLIN INTERNATIONAL

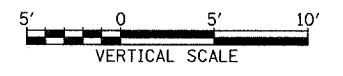
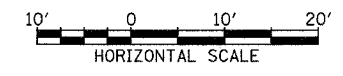

I-94 SOUTHBOUND (DAN RYAN EXPWY)  
 STA. 1345+00 TO STA. 1346+40

02/27/2006 12:54:07 PM