

F.A.I. RTE.	SECTION	COUNTY	TOTAL SHEETS	SHEET NO.
94		COOK	916	86
STA. 190+65 (NB I-57) TO STA. 2316+00 (NB RYAN)				
FED. ROAD DIST. NO. ILLINOIS FED. AID PROJECT				
• (1516.1, 1717, & 1818) R-4 62304				

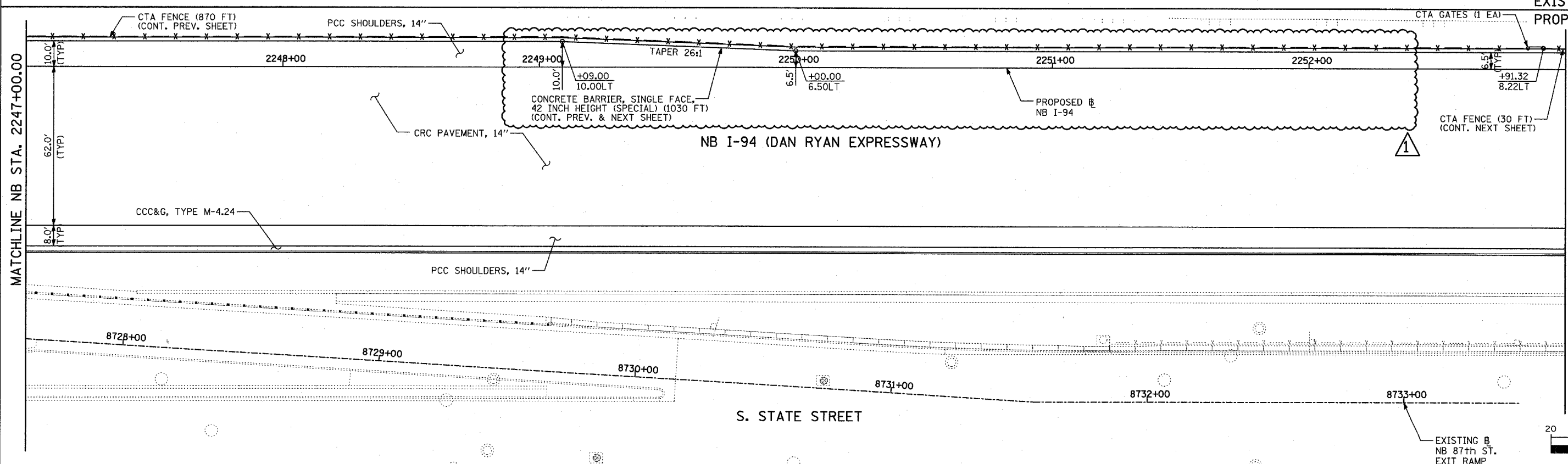

EXISTING CONDITIONS
PROPOSED IMPROVEMENTS

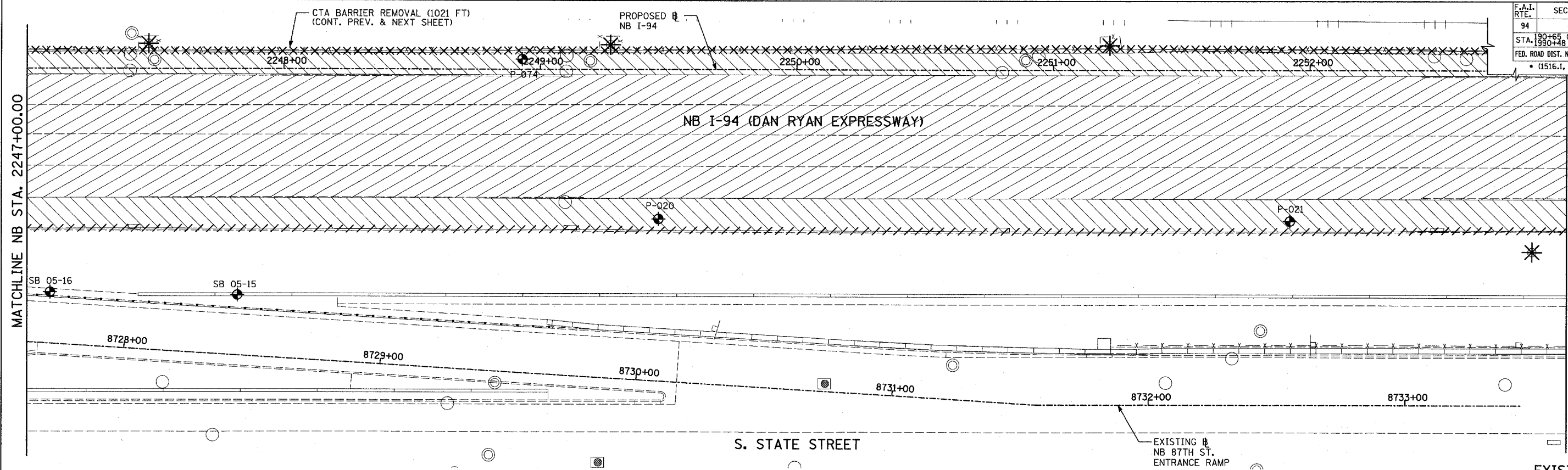
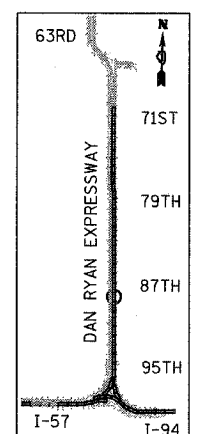
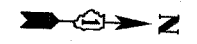

LOCATION MAP

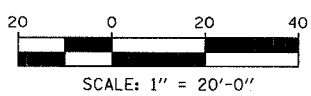

MATCHLINE NB STA. 2247+00.00

MATCHLINE NB STA. 2253+00.00

MATCHLINE NB STA. 2253+00.00

LEGEND:

////	COMB CONC CURB & GUTTER REMOVAL	[Hatched Box]	PAVEMENT REMOVAL
~~~~	CHAIN LINK FENCE REMOVAL	[Diagonal Hatched Box]	PAVED SHOULDER REMOVAL
XXXXXX	CONCRETE BARRIER/GUARDRAIL REMOVAL	[Cross-hatched Box]	PAVEMENT/SHOULDER REMOVAL, SPECIAL
X10	TREE REMOVAL (UNITS) (NO UNIT SHOWN = 6)	[Diagonal Hatched Box]	BITUMINOUS SURFACE REMOVAL, 4"
◆	SOIL BORING LOCATIONS	[Diagonal Hatched Box]	BITUMINOUS SURFACE REMOVAL, 1 1/2" OR 1 3/4" (SEE CALLOUT)

**PLAN NOTES:**

- * LIGHT POLE FOUNDATION REMOVAL (SEE ROADWAY LIGHTING & SURVEILLANCE PLANS)
- +XX.XX MAINLINE #
- XX.XXRT STATION/OFFSET
- ALL STATION/OFFSET/RADIUS CALLOUTS MEASURED TO EDGE OF PAVEMENT UNLESS OTHERWISE NOTED.
- EXACT LOCATIONS OF EXISTING PIERS/ABUTMENTS TO BE FIELD VERIFIED

REVISIONS	
NAME	DATE

ILLINOIS DEPARTMENT OF TRANSPORTATION  
F.A.I. 94 (DAN RYAN EXPRESSWAY)  
EXISTING AND PROPOSED PLAN  
NB I-94 (DAN RYAN EXPRESSWAY)  
NB I-94 STA. 2247+00.00 TO 2253+00.00

SCALE: 1"=20'  
DATE: MARCH 7, 2006

DRAWN BY: RTM  
CHECKED BY: MPG

**TYLIN** INTERNATIONAL