

RUNAROU-1	RUNAROU-2	RUNAROU-3	RUNAROU-4	RUNAROU-5
P.I. STA = 9+50.01	P.I. STA = 12+53.73	P.I. STA = 16+39.40	P.I. STA = 19+48.29	P.I. STA = 23+28.17
N = 1,839,953.56	N = 1,840,169.03	N = 1,840,541.20	N = 1,840,798.47	N = 1,841,175.94
E = 1,177,260.32	E = 1,177,474.40	E = 1,177,604.15	E = 1,177,777.90	E = 1,177,851.07
$\Delta = 2^\circ 38' 14.68''$ (LT)	$\Delta = 25^\circ 35' 42.79''$ (LT)	$\Delta = 14^\circ 48' 53.83''$ (RT)	$\Delta = 23^\circ 03' 52.34''$ (LT)	$\Delta = 12^\circ 39' 15.99''$ (LT)
D = 2° 38' 14.68"	D = 5° 07' 45.96"	D = 5° 18' 18.59"	D = 6° 52' 30.17"	D = 2° 57' 45.19"
R = 2,172.42	R = 1,117.00	R = 1,080.00	R = 833.39	R = 1,934.00
L = 100.00	L = 498.99	L = 279.26	L = 335.48	L = 427.15
E = 0.58	E = 28.45	E = 9.09	E = 17.17	E = 11.85
T = 50.01	T = 253.73	T = 140.41	T = 170.04	T = 214.45
P.C. STA = 9+00.00	P.C. STA = 10+00.00	P.C. STA = 14+98.99	P.C. STA = 17+78.24	P.C. STA = 21+13.72
N = 1,839,919.75	N = 1,839,989.04	N = 1,840,408.61	N = 1,840,657.56	N = 1,840,965.41
E = 1,177,223.48	E = 1,177,295.57	E = 1,177,557.92	E = 1,177,682.73	E = 1,177,810.26
P.T. STA = 10+00.00	P.T. STA = 14+98.99	P.T. STA = 17+78.24	P.T. STA = 21+13.72	P.T. STA = 25+40.87
N = 1,839,989.04	N = 1,840,408.61	N = 1,840,657.56	N = 1,840,965.41	N = 1,841,390.29
E = 1,177,295.57	E = 1,177,557.92	E = 1,177,682.73	E = 1,177,810.26	E = 1,177,844.77

NOTE:
SEE SHEET 13B OF 13 FOR RUNAROUND TYPICAL AND MOT SECTION FF'-FF'.

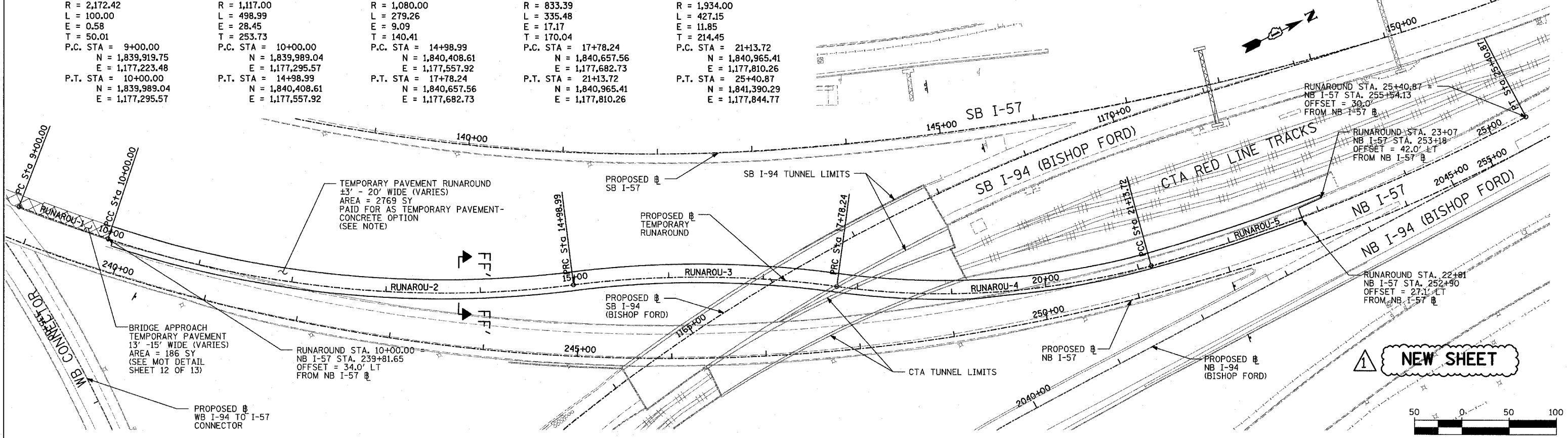

NEW SHEET

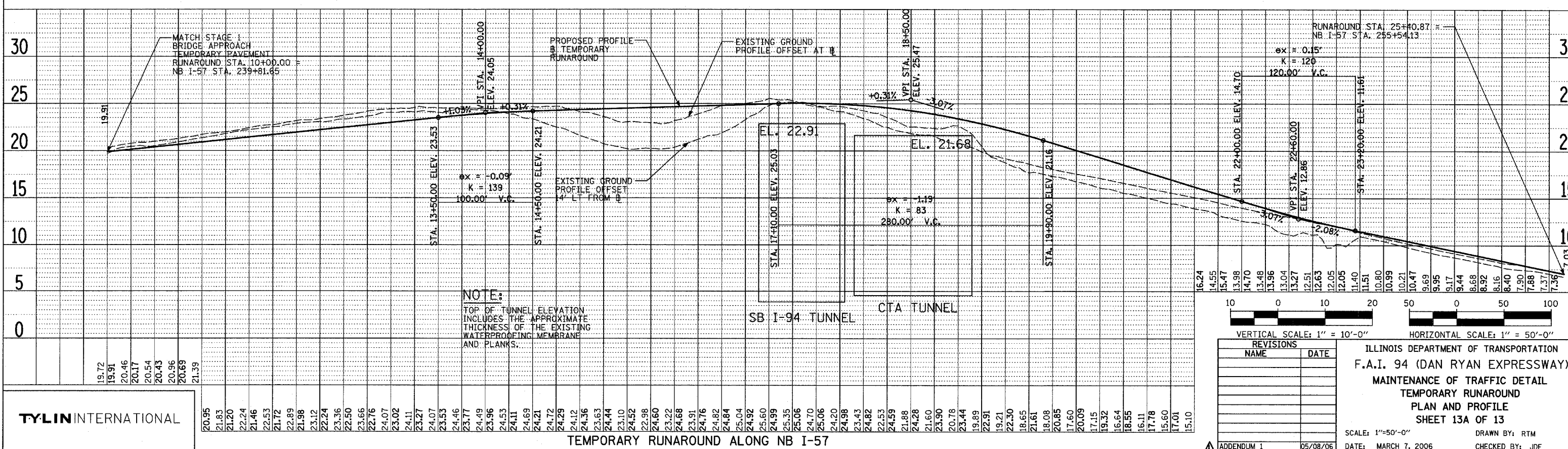

VERTICAL SCALE: 1" = 10'-0"
HORIZONTAL SCALE: 1" = 50'-0"

REVISIONS	
NAME	DATE

ILLINOIS DEPARTMENT OF TRANSPORTATION
F.A.I. 94 (DAN RYAN EXPRESSWAY)
MAINTENANCE OF TRAFFIC DETAIL
TEMPORARY RUNAROUND
PLAN AND PROFILE
SHEET 13A OF 13
SCALE: 1"=50'-0"
DATE: MARCH 7, 2006
DRAWN BY: RTM
CHECKED BY: JDF

TYLIN INTERNATIONAL

TEMPORARY RUNAROUND ALONG NB I-57

DATE: _____
BY: _____
REVISIONS:
NO. DESCRIPTION
1. PLAN
2. PROFILE

DATE: _____
BY: _____
REVISIONS:
NO. DESCRIPTION
1. PROFILE