

FF'-FF'

STAGE 2: RUNAROUND; STA. 10+00 TO STA. 22+81  
 STAGE 2: NB I-57; STA. 239+82 TO STA. 252+90

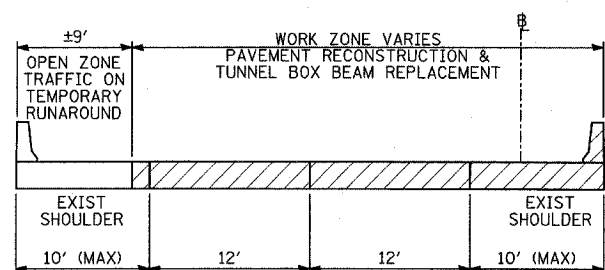

YY-YY

STAGE 2: NB I-57; STA. 242+00 TO STA. 249+70

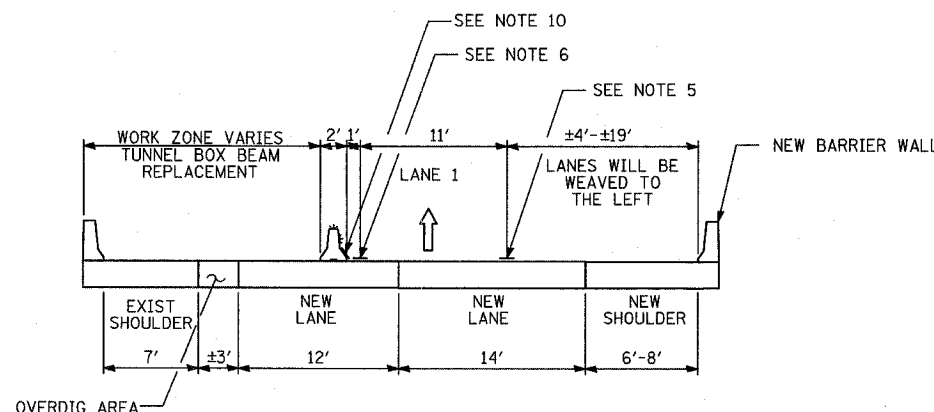

ZZ-ZZ

STAGE 3: NB I-57; STA. 245+43 TO STA. 251+52

- NOTE 1 - EPOXY PAVEMENT MARKING-LINE 4" (WHITE)
- NOTE 2 - EPOXY PAVEMENT MARKING-LINE 4" (YELLOW)
- NOTE 3 - EPOXY PAVEMENT MARKING-SKIP-DASH 5" (WHITE), 10' LINE WITH 30' SPACE
- NOTE 4 - EPOXY PAVEMENT MARKING LINE 8" (WHITE)
- NOTE 5 - PAVEMENT MARKING TAPE, TYPE III 4" LINE (WHITE)
- NOTE 6 - PAVEMENT MARKING TAPE, TYPE III 4" LINE (YELLOW)
- NOTE 7 - PAVEMENT MARKING TAPE, TYPE III 5" SKIP-DASH (WHITE), 10' LINE WITH 30' SPACE
- NOTE 8 - PAVEMENT MARKING TAPE, TYPE III 8" LINE (WHITE)
- NOTE 9 - TEMPORARY PAVEMENT MARKING-LINE 6" (WHITE)
- NOTE 10 - TEMPORARY PAVEMENT MARKING-LINE 6" (YELLOW)

LEGEND:

- TEMPORARY CONCRETE BARRIER (WITH REFLECTORS ON TOP AND SIDE FACING TRAFFIC)
- TRAFFIC MOVEMENT
- DRUM WITH MONO-DIRECTIONAL STEADY BURNING LIGHT
- SINGLE-FACE CONCRETE BARRIER, 32"
- SINGLE-FACE CONCRETE BARRIER, 32" (WITH REFLECTORS ON TOP AND SIDE FACING TRAFFIC)
- PAVEMENT REMOVAL AREA
- TEMPORARY PAVEMENT

\* ALL MOT TYPICAL SECTIONS ARE DRAWN IN THE DIRECTION OF TRAFFIC

NEW SHEET

REVISIONS		ILLINOIS DEPARTMENT OF TRANSPORTATION F.A.I. 94 (DAN RYAN EXPRESSWAY) GENERAL NOTES CONSTRUCTION STAGING NOTES MAINTENANCE OF TRAFFIC DETAILS SHEET 13B OF 13
NAME	DATE	
ADDENDUM 1	05/08/06	SCALE: NO SCALE DATE: MARCH 7, 2006 DRAWN BY: RTM CHECKED BY: TGB