

MATCHLINE NB I-57 STA. 240+00.00
(SHEET 46 OF 47)

MATCHLINE NB STA. 246+00.00

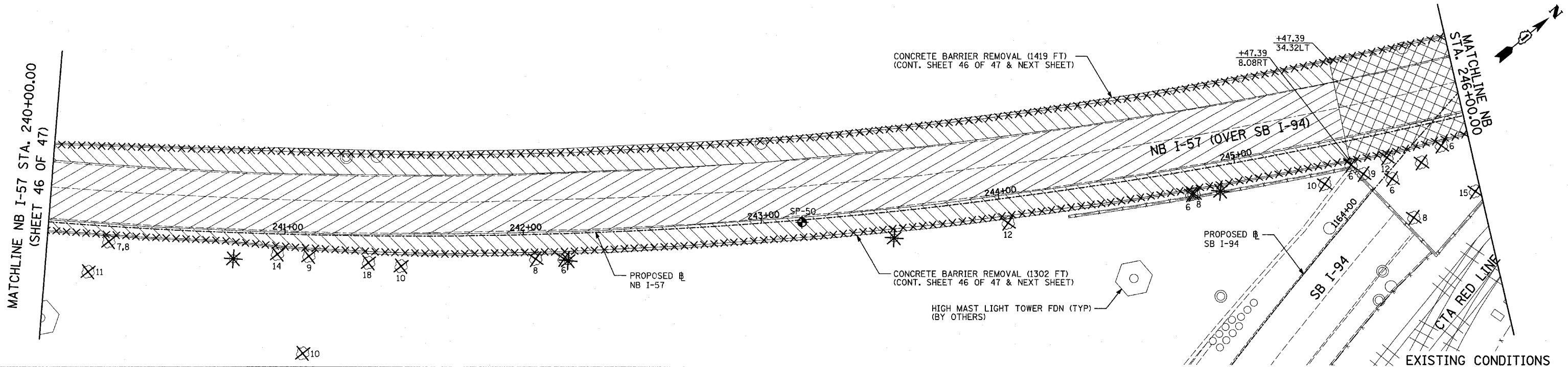

EXISTING CONDITIONS
PROPOSED IMPROVEMENTS

MATCHLINE NB I-57 STA. 240+00.00
(SHEET 46 OF 47)

MATCHLINE RAMP STA. 246+00.00

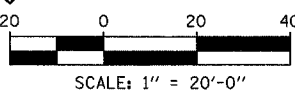
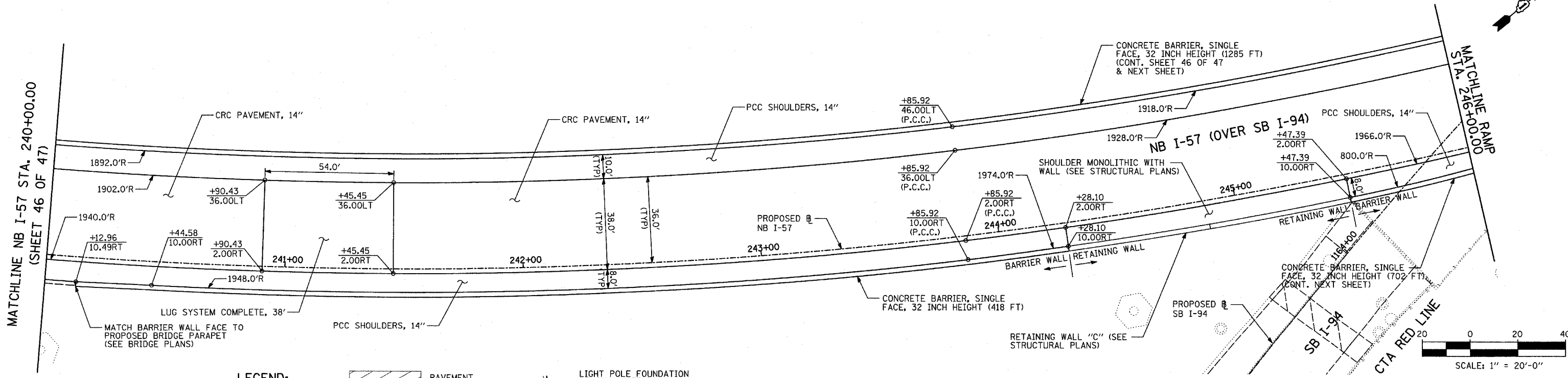

LEGEND:

- ===== COMB CONC CURB & GUTTER REMOVAL
- ~~~~~ CHAIN LINK FENCE REMOVAL
- XXXXXX CONCRETE BARRIER/GUARDRAIL REMOVAL
- ⊗10 TREE REMOVAL (UNITS) (NO UNIT SHOWN = <6)
- ⊕ SOIL BORING LOCATIONS
- ▨ PAVEMENT REMOVAL
- ▧ PAVED SHOULDER REMOVAL
- ▩ PAVEMENT/SHOULDER REMOVAL, SPECIAL
- ▦ BITUMINOUS SURFACE REMOVAL, 4"
- ▤ BITUMINOUS SURFACE REMOVAL, 1 1/2" OR 1 3/4" (SEE CALLOUT)

- * LIGHT POLE FOUNDATION REMOVAL (SEE ROADWAY LIGHTING & SURVEILLANCE PLANS)
- +XX.XX MAINLINE B
- XX.XXRT STATION/OFFSET

PLAN NOTES:

- ALL STATION/OFFSET/RADIUS CALLOUTS MEASURED TO EDGE OF PAVEMENT UNLESS OTHERWISE NOTED.
- EXACT LOCATIONS OF EXISTING PIERS/ABUTMENTS TO BE FIELD VERIFIED

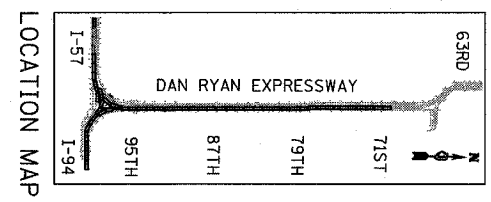

REVISIONS	
NAME	DATE

ILLINOIS DEPARTMENT OF TRANSPORTATION
 F.A.I. 94 (DAN RYAN EXPRESSWAY)
 EXISTING AND PROPOSED PLAN
 NB I-57
 NB STA. 240+00.00 TO 246+00.00

SCALE: 1"=20'
 DATE: MARCH 7, 2006

DRAWN BY: RTM
 CHECKED BY: MPG

TYLIN INTERNATIONAL