

F.A.I. RTE. 94	SECTION	COUNTY	TOTAL SHEETS	SHEET NO.
STA. 190+65 (NB I-57) TO STA. 2316+00 (NB RYAN)		COOK	916	338
FED. ROAD DIST. NO. ILLINOIS	FED. AID PROJECT			
(1516.1, 1717, & 1818) R-4			62304	

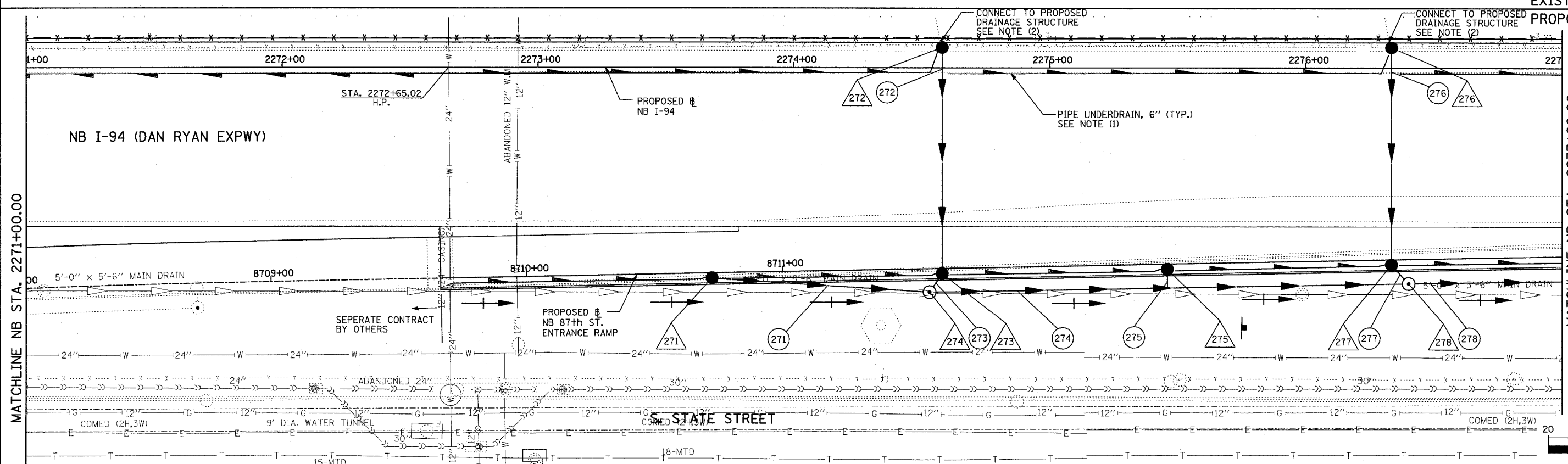
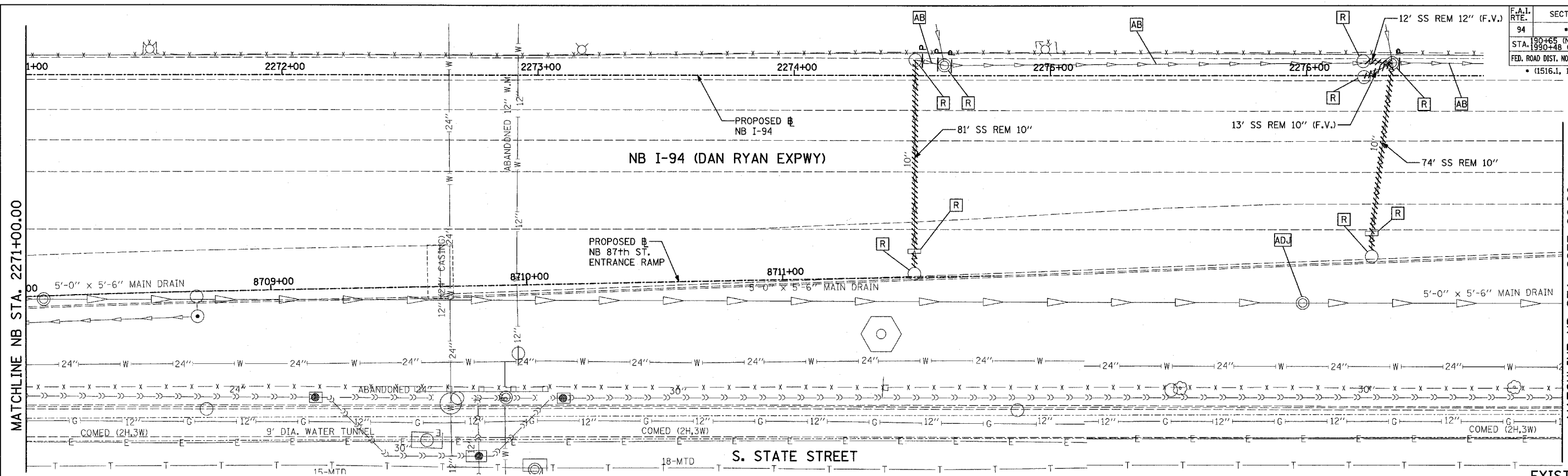

MATCHLINE NB STA. 2271+00.00

MATCHLINE NB STA. 2277+00.00

EXISTING CONDITIONS

PROPOSED IMPROVEMENTS

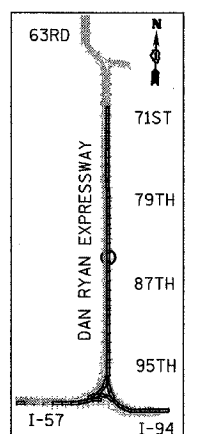

LOCATION MAP

SCALE: 1" = 20'-0"

LEGEND:

	EXISTING COMBINED SEWER		SEWER PLUG
	PROPOSED STORM SEWER NUMBER (X=SHEET NO., Y=PIPE NO.)		FIELD VERIFY
	PROPOSED STRUCTURE NUMBER (X=SHEET NO., Y=STRUCTURE NO.)		UTILITY REMOVAL
	PIPE STUBOUT TO BE PLUGGED		PROPOSED CATCH BASIN CONSTRUCTED IN CONCURRENT CONTRACT 62593
			PROPOSED STORM SEWER CONSTRUCTED IN CONCURRENT CONTRACT 62593

NOTES:

- FOR CLARITY, PIPE UNDERDRAINS ARE SHOWN OFFSET FROM THEIR PROPOSED LOCATIONS. FOR DETAILED PLACEMENT, SEE SHEET "PIPE UNDERDRAINS DETAIL."
- ALL CONNECTIONS TO EXISTING SEWER OR STRUCTURE ALONG CTA SHALL BE FIELD VERIFIED PRIOR TO INSTALLATION AND COORDINATED WITH CTA CONSTRUCTION. COST SHALL BE INCLUDED IN THE COST TO CONSTRUCT THE DRAINAGE STRUCTURE.

REVISIONS	
NAME	DATE

ILLINOIS DEPARTMENT OF TRANSPORTATION
 F.A.I. 94 (DAN RYAN EXPRESSWAY)
 DRAINAGE AND UTILITY PLAN
 NB I-94 (DAN RYAN EXPRESSWAY)
 NB I-94 STA. 2271+00.00 TO 2277+00.00

SCALE: 1"=20'
 DATE: MARCH 7, 2006

DRAWN BY: MB
 CHECKED BY: DA

TYLIN INTERNATIONAL