

F.A.I. RTE.	SECTION	COUNTY	TOTAL SHEETS	SHEET NO.
94		COOK	916	515
STA. 2295+18		TO STA. 2308+18		
FED. ROAD DIST. NO.		ILLINOIS FED. AID PROJECT		
		• (1516.1, 1717, & 1818) R-4		
				62304

NOTES:

1. REFER TO SHEET EI-106 AND EI-110 FOR HANDHOLE DETAILS.
2. TIE INTO EXISTING CONDUIT PROVIDED UNDER SEPARATE CONTRACT 62594.
3. REFER TO SHEET EI-115 FOR DETECTOR STATION LAYOUT.

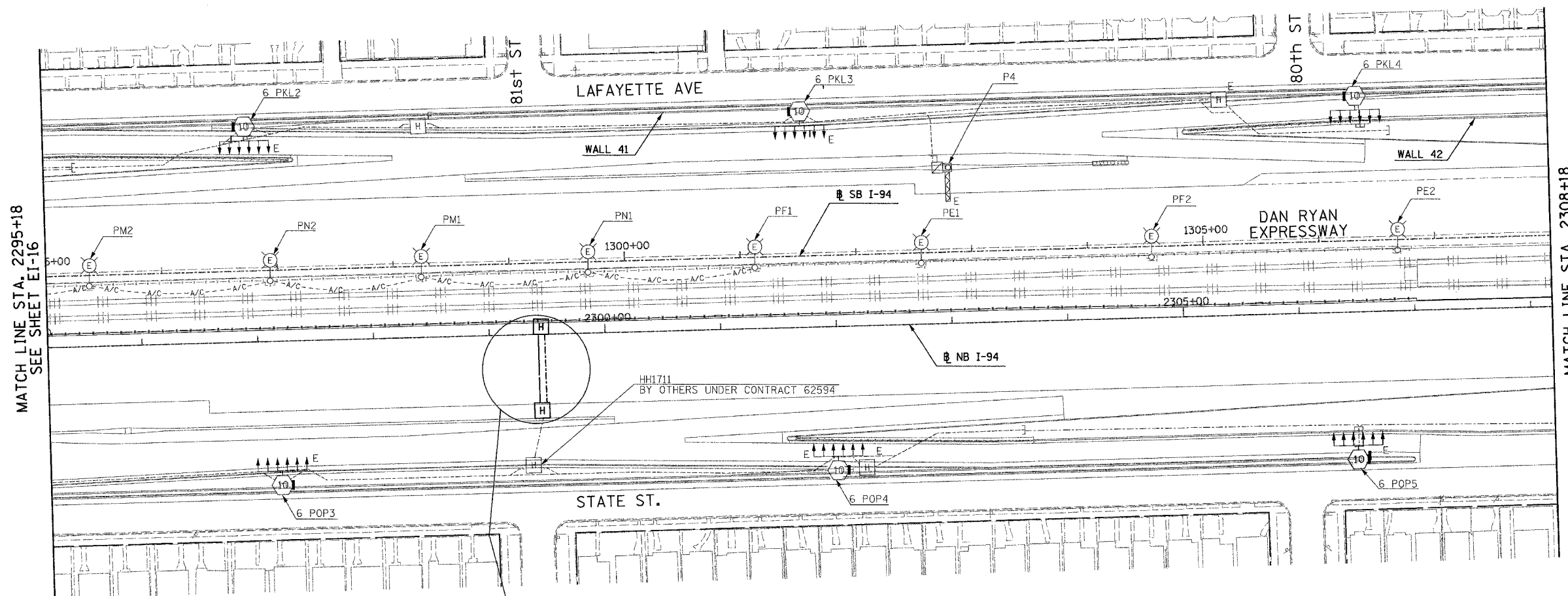

MATCH LINE STA. 2295+18
SEE SHEET EI-16

MATCH LINE STA. 2308+18
SEE SHEET EI-18

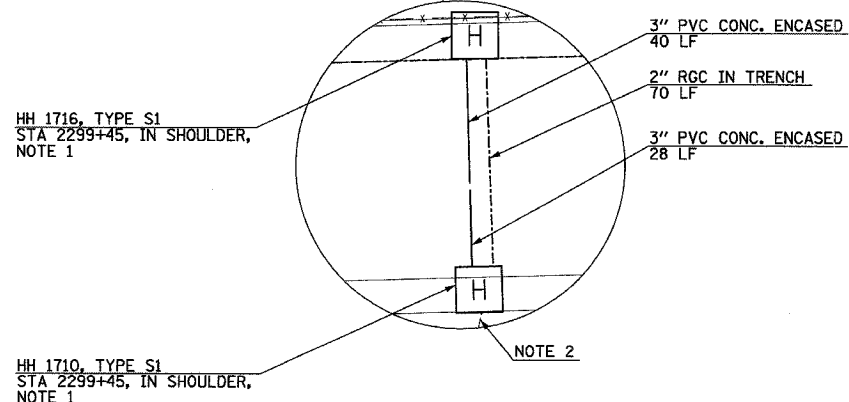

HH 1716, TYPE S1
STA 2299+45, IN SHOULDER,
NOTE 1

HH 1710, TYPE S1
STA 2299+45, IN SHOULDER,
NOTE 1

NOTE 2

SINGH
SINGH & ASSOCIATES, INC.
CONSULTING ENGINEERS

300 W. ADAMS ST.
CHICAGO, IL 60606
TEL: (312) 629-0240
FAX: (312) 629-8448

20/EI-17

REVISIONS	
NAME	DATE

ILLINOIS DEPARTMENT OF TRANSPORTATION
F.A.I. 94 (DAN RYAN EXPRESSWAY)

ELECTRICAL INFRASTRUCTURE PLANS
PROPOSED IMPROVEMENTS
STA. 2295+18 TO STA. 2308+18

SCALE: 1"=50' DRAWN BY: VK
DATE: MARCH 7, 2006 CHECKED BY: TM

JAN 20 2006 3:51:08 PM