

PROFILE SURVEYED
 GRADES CHECKED
 NOTE BOOK NO. _____
 STRUCTURE NOTATIONS BRG
 DATE _____
 BY _____

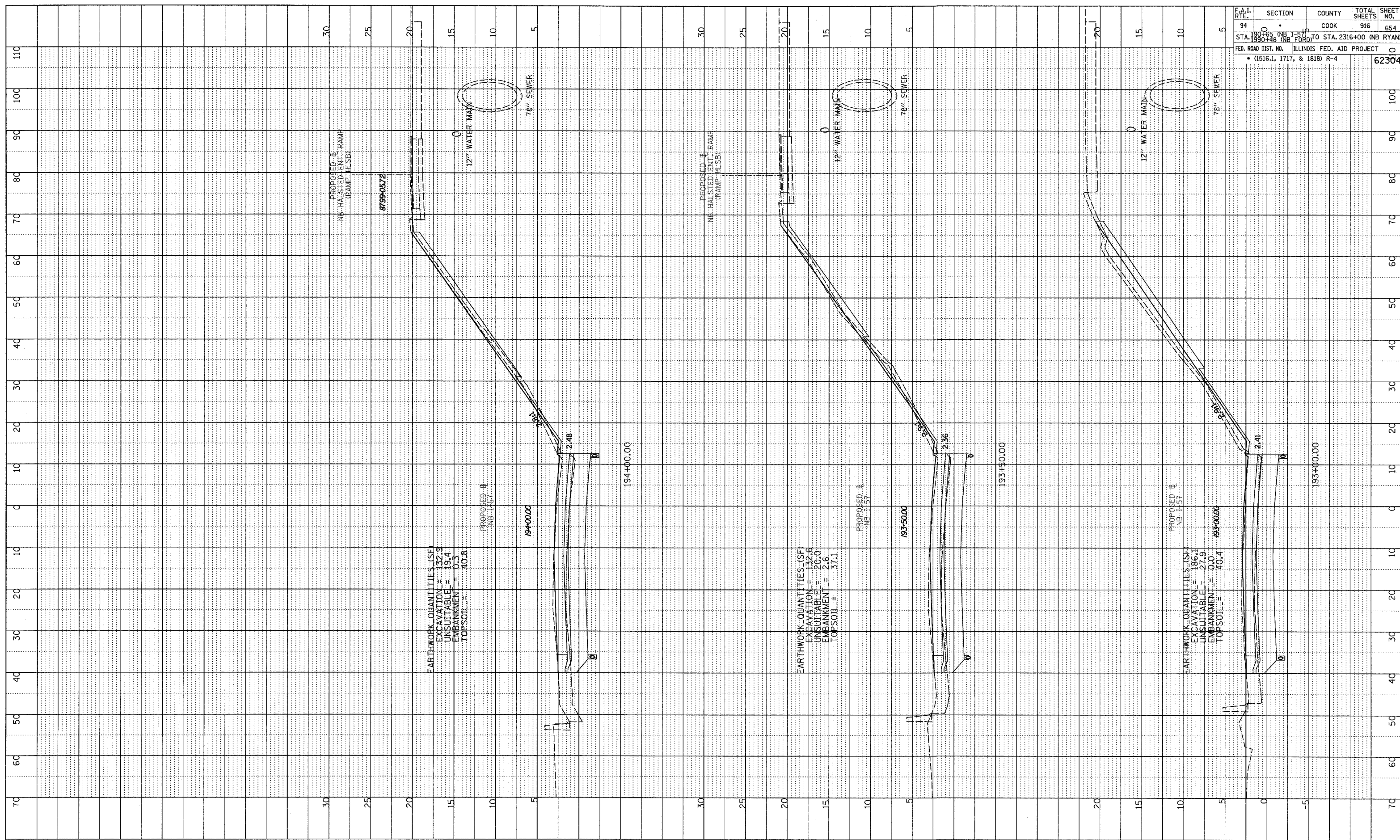

F.A.I. RTE.	SECTION	COUNTY	TOTAL SHEETS	SHEET NO.
94	0	COOK	916	654
STA. 190+65 (NB I-57) TO STA. 2316+00 (NB RYAN)				
FED. ROAD DIST. NO. ILLINOIS FED. AID PROJECT				
• (1516.1, 1717, & 1818) R-4				
				62304

TYLIN INTERNATIONAL

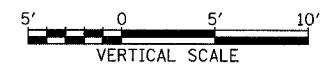

NORTHBOUND I-57
 STA. 193+00 TO STA. 194+00

03/03/2006 04:00:20 PM