

PROFILE SURVEYED BY: _____
 GRADES CHECKED BY: _____
 DATE: _____
 NO. _____
 PROJECT: _____

F.A.I. RTE.	SECTION	COUNTY	TOTAL SHEETS	SHEET NO.
94	190+00	COOK	916	669
STA. 190+00 (NB I-57) TO STA. 2316+00 (NB RYAN) STA. 190+00 (NB I-57) TO STA. 2316+00 (NB RYAN) FED. ROAD DIST. NO. ILLINOIS FED. AID PROJECT (1516.1, 1717, & 1818) R-4				
				62304

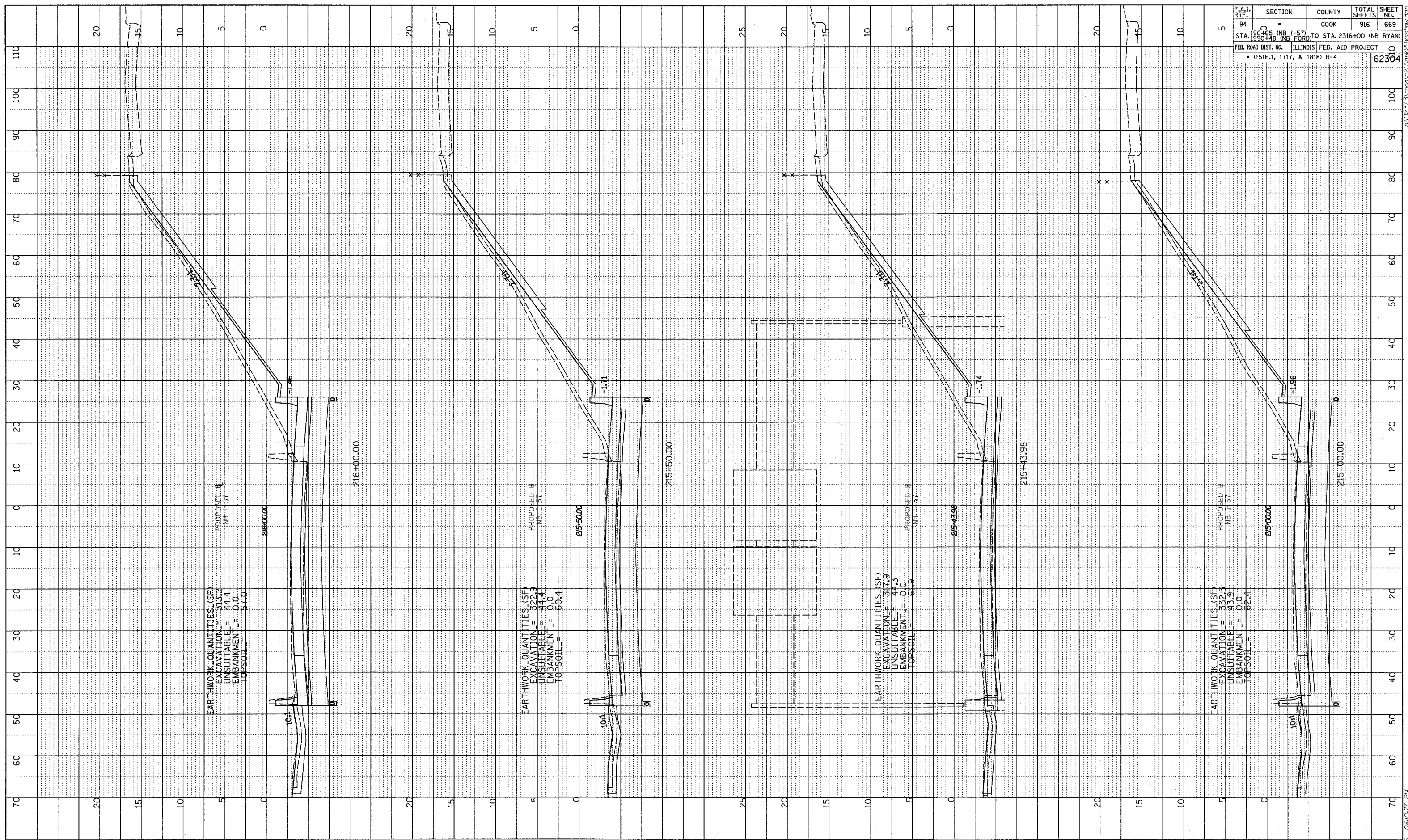

TYLIN INTERNATIONAL



NORTHBOUND I-57
 STA. 215+00 TO STA. 216+00

03/03/2006 04:02:27 PM