

PROFILE SURVEYED
 NOTE BOOK GRADES CHECKED
 NO. DATE
 STRUCTURE NOTATION: 670

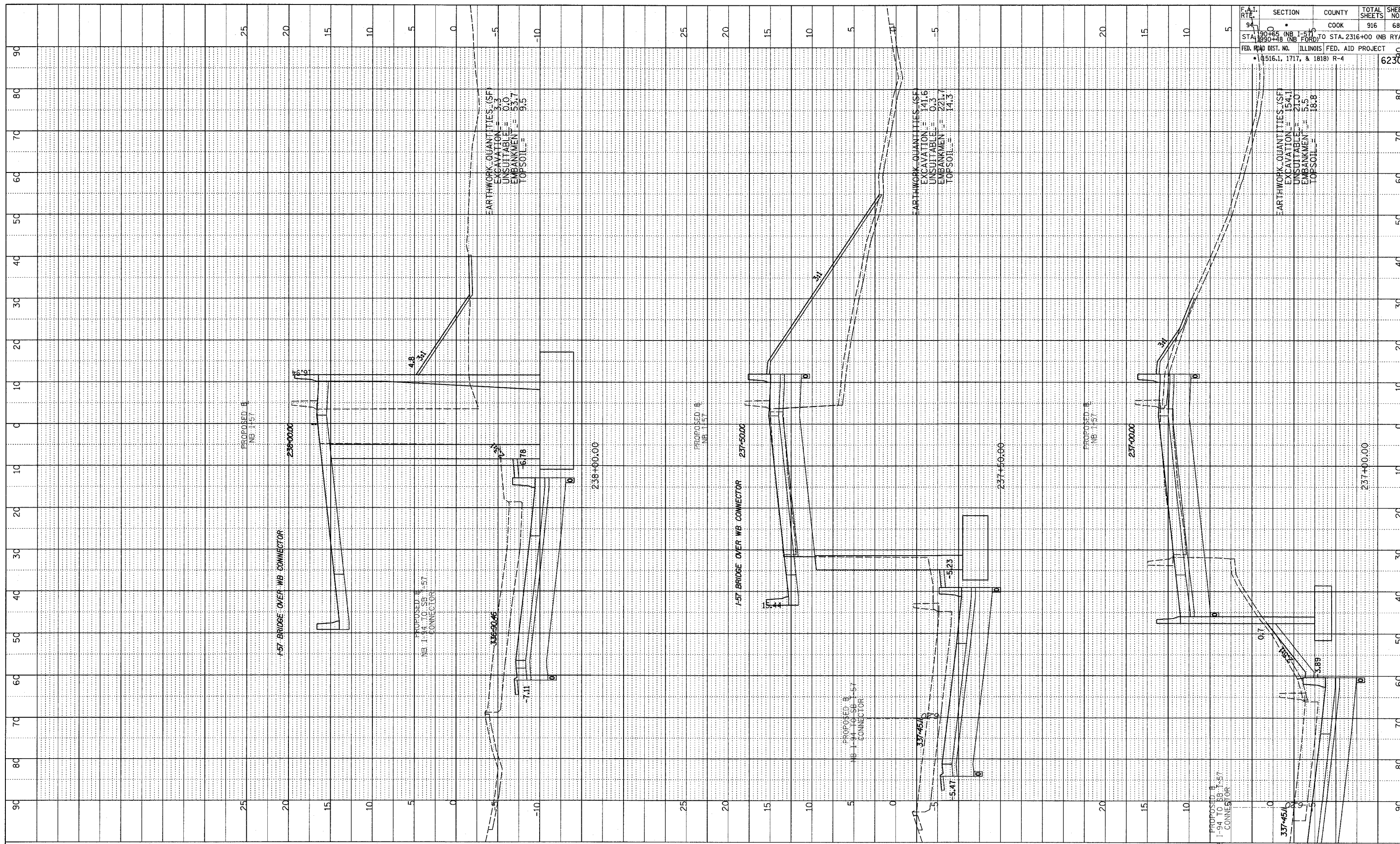

F.A.T. RTE.	SECTION	COUNTY	TOTAL SHEETS	SHEET NO.
94	157	COOK	916	681
STA. 237+00 (NB I-57) TO STA. 238+00 (NB I-57)				
FED. ROAD DIST. NO. ILLINOIS FED. AID PROJECT				
1516.1, 1717, & 1818) R-4				
				62304

EARTHWORK QUANTITIES (SF)
 EXCAVATION = 3.3
 UNSUITABLE = 0.0
 EMBANKMENT = 53.7
 TOPSOIL = 9.5

EARTHWORK QUANTITIES (SF)
 EXCAVATION = 141.6
 UNSUITABLE = 0.3
 EMBANKMENT = 221.7
 TOPSOIL = 14.3

EARTHWORK QUANTITIES (SF)
 EXCAVATION = 154.1
 UNSUITABLE = 21.0
 EMBANKMENT = 5.5
 TOPSOIL = 18.8

TYLIN INTERNATIONAL

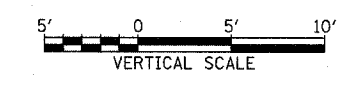
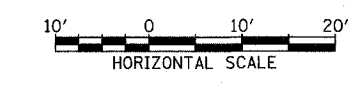

NORTHBOUND I-57
 STA. 237+00 TO STA. 238+00

03/03/2005 04:40:54 PM