

PROFILE SURVEYED BY: _____ DATE: _____
 NOTE BOOK NO. _____ GRADES CHECKED _____
 P.M. NOTED _____
 STRUCTURE NOTATION CHKD: _____

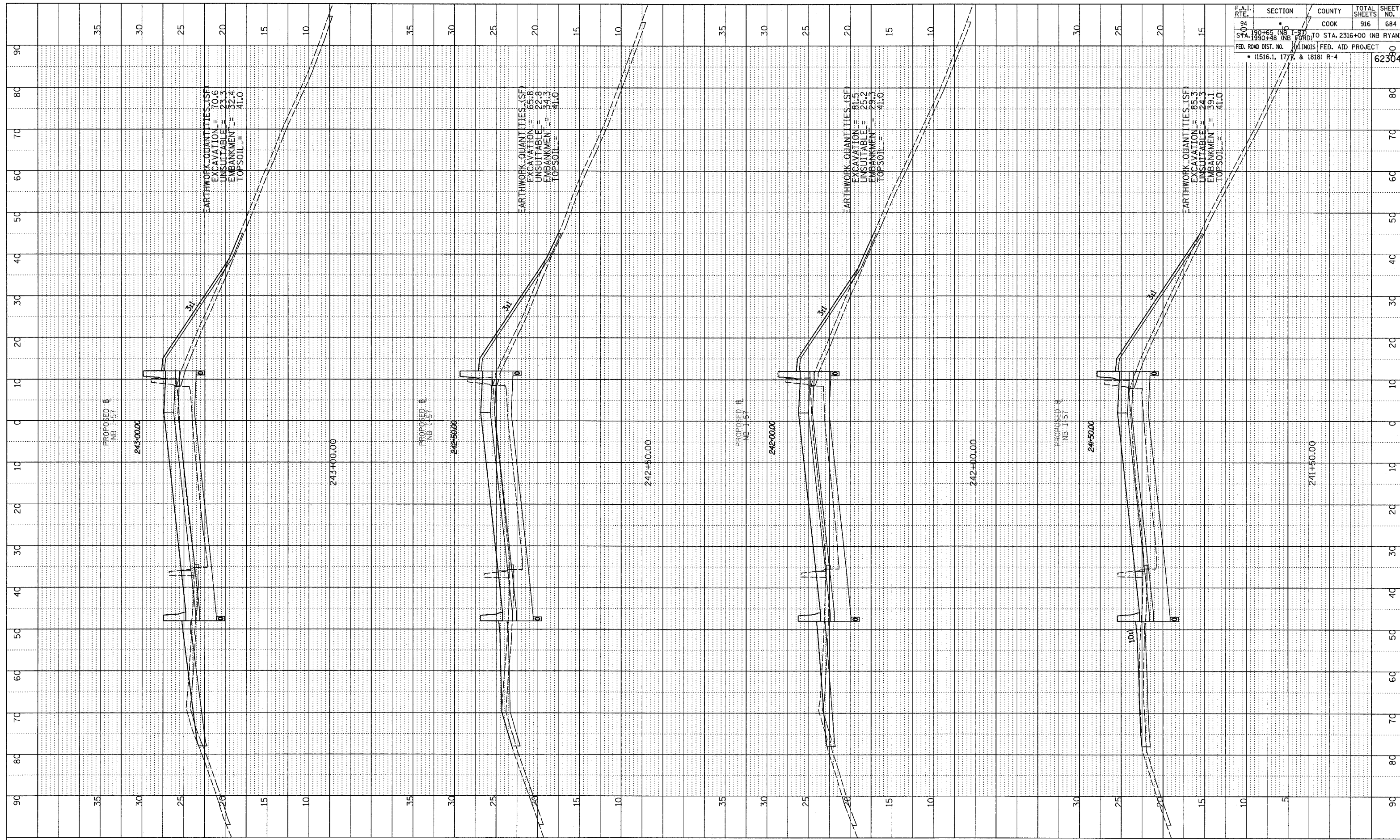

F.A.T. RTE.	SECTION	COUNTY	TOTAL SHEETS	SHEET NO.
94	190+65 (NB I-57) TO STA. 2316+00 (NB RYAN)	COOK	916	684
STA. 190+48 (NB I-57) TO STA. 2316+00 (NB RYAN) FED. ROAD DIST. NO. 1516.1, 1777, & 1818 R-4 ILLINOIS FED. AID PROJECT 62304				

TYLIN INTERNATIONAL

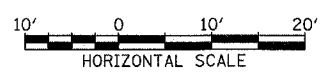

NORTHBOUND I-57
 STA. 241+50 TO STA. 243+00

03/03/2006 04:00:40 PM