

PROFILE REQUESTED _____ BY _____ DATE _____
 PLOTTED _____
 GRADINGS CHECKED _____
 STRUCTURE NOTATIONS CHECKED _____
 NO. _____

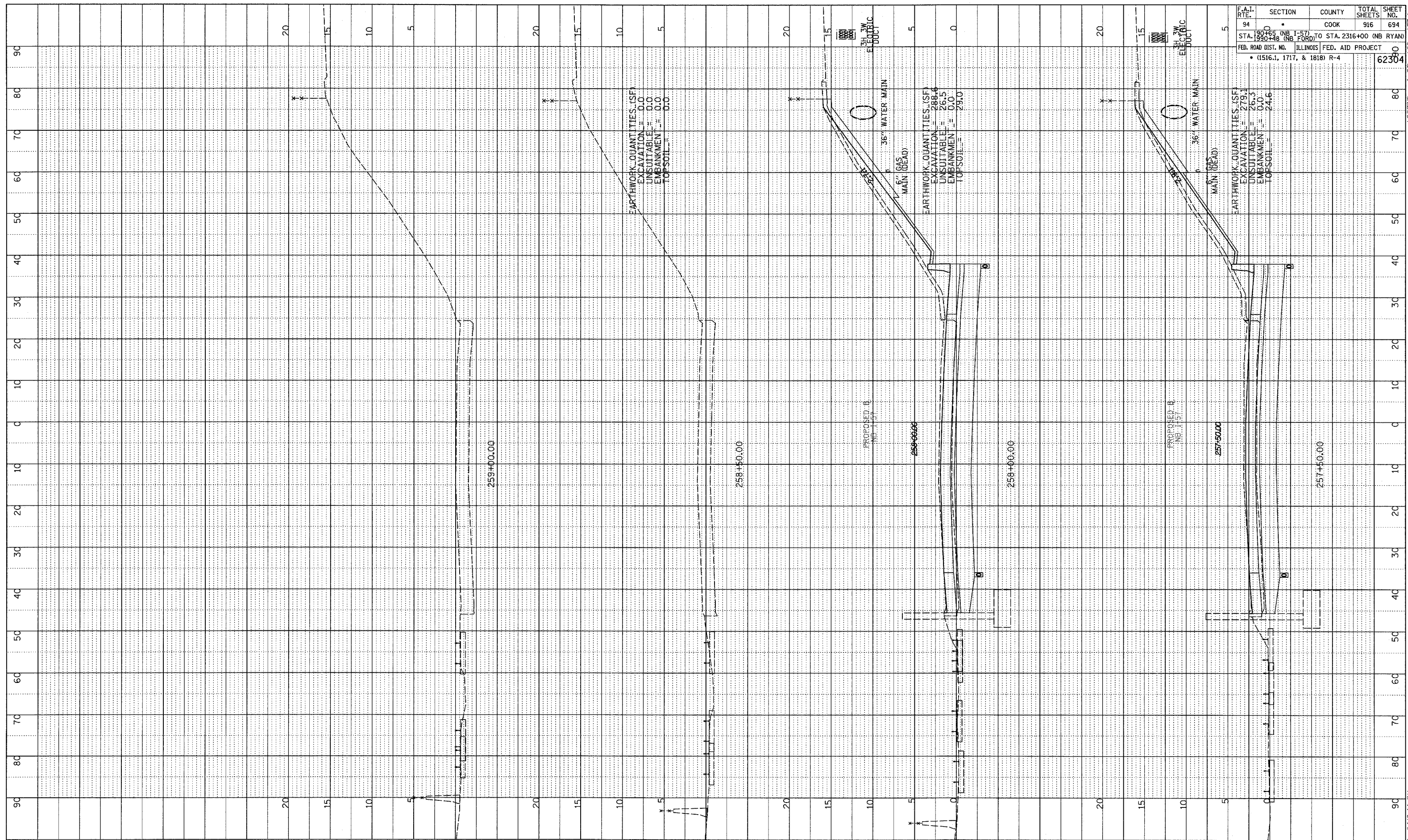

F.A.I. RTE.	SECTION	COUNTY	TOTAL SHEETS	SHEET NO.
94	D	COOK	916	694
STA. 190+45 (NB I-57) TO STA. 2316+00 (NB RYAN) FED. ROAD DIST. NO. ILLINOIS FED. AID PROJECT • (1516.1, 1717, & 1818) R-4				
				62304

TYLIN INTERNATIONAL

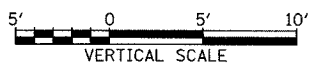

NORTHBOUND I-57
 STA. 257+50 TO STA. 259+00

03/03/2006 04:00:44 PM
 P:\0237\3\road\20\gpk\20\asht51.dgn