

PROFILE SURVEYED BY \_\_\_\_\_ DATE \_\_\_\_\_  
 GRADES CHECKED BY \_\_\_\_\_  
 E.M. NOTED BY \_\_\_\_\_  
 NO. \_\_\_\_\_ DATE \_\_\_\_\_ NOTATION GRID \_\_\_\_\_

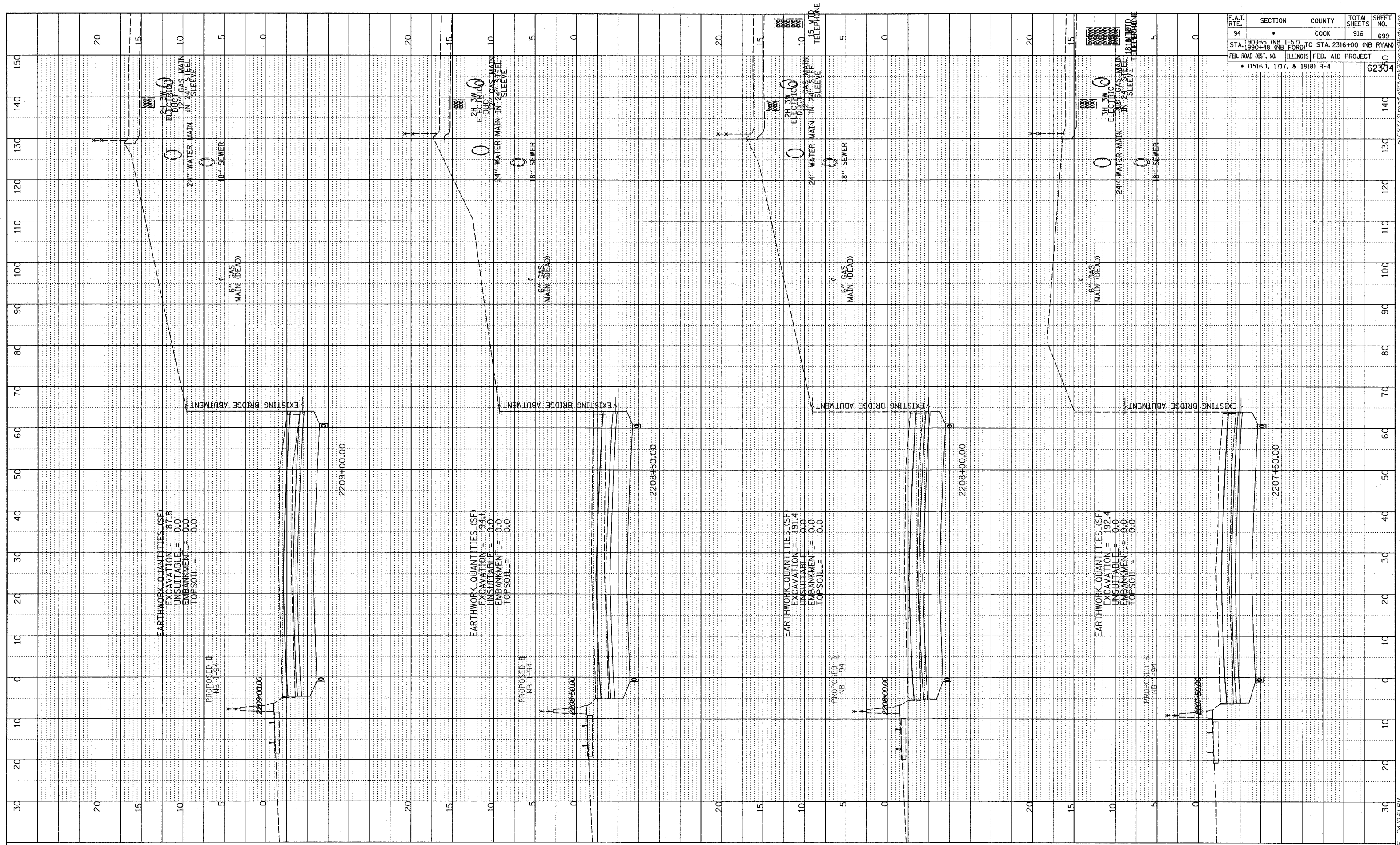

F.A.I. RTE.	SECTION	COUNTY	TOTAL SHEETS	SHEET NO.
94	190+65 (NB I-57) TO STA. 2316+00 (NB RYAN)	COOK	916	699
STA. 190+48 (NB FORD) TO STA. 2316+00 (NB RYAN) FED. ROAD DIST. NO. ILLINOIS FED. AID PROJECT • (1516.1, 1717, & 1818) R-4				

TYLIN INTERNATIONAL



NORTHBOUND I-94 (DAN RYAN EXPWY)  
 STA. 2207+50 TO STA. 2209+00

03/03/2006 04:00:51 PM